

The copyright of this drawing is vested with Corstorphine + Wright Ltd and must not be copied or reproduced without the consent of the company.
Figured dimensions only to be taken from this drawing. DO NOT SCALE.
All dimensions and notations are subject to any discrepancies prior to any manufacture or construction work.

NOTES

WALL DETAIL

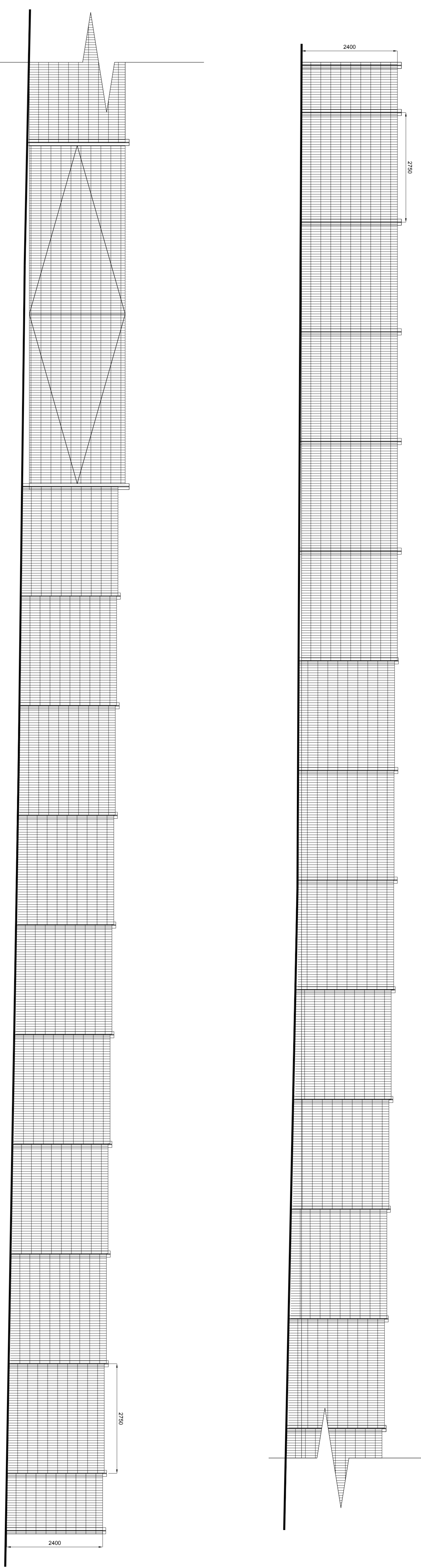

External wall detail @ 1:50

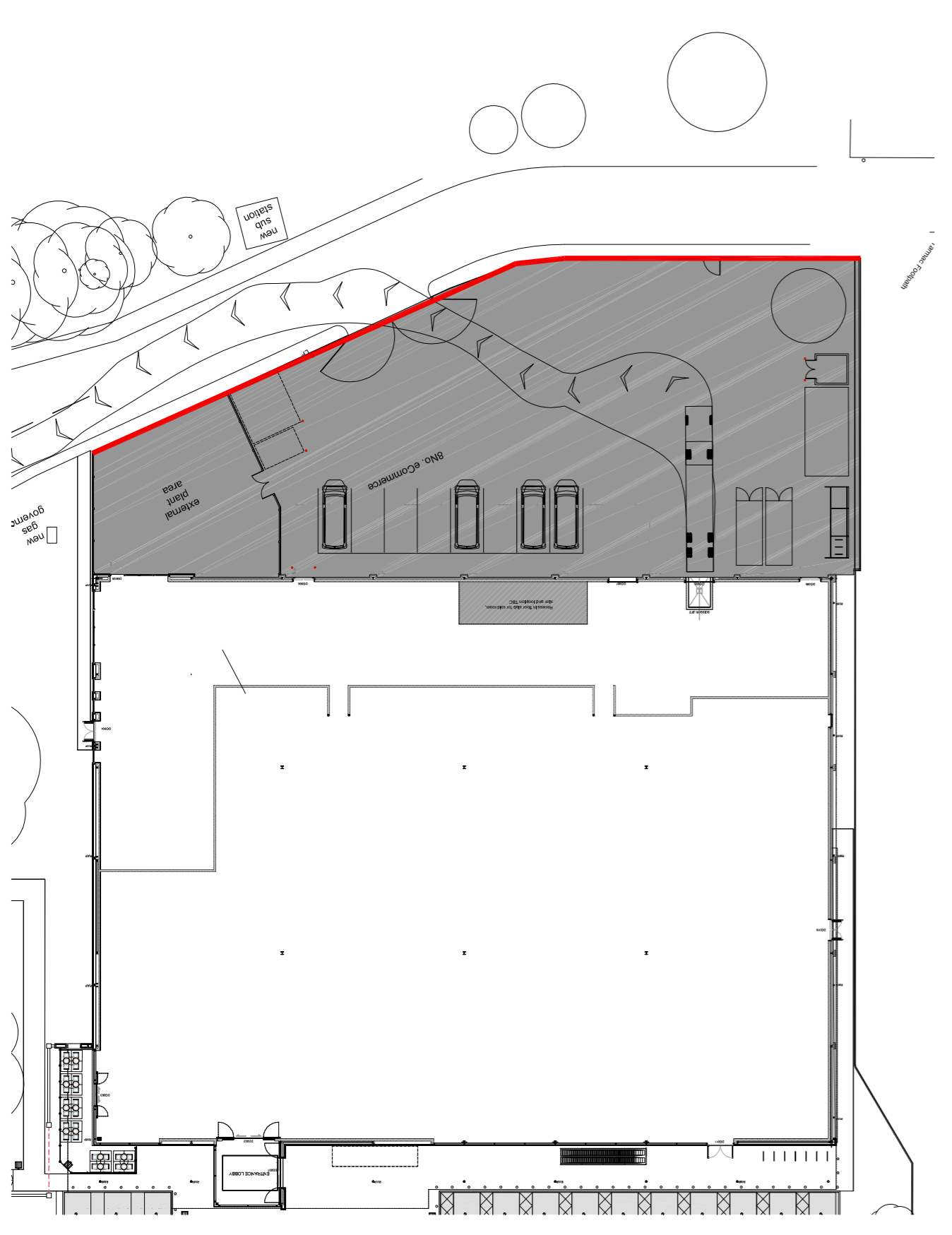

Site plan @ 1:500

REV	DATE	NOTES	CHK
A	27.04.18	TENDER ISSUE T1	CHK

Client: BARWOOD CAPITAL and MONDELEZ INTERNATIONAL
Project: NEW WAITROSE STORE SOUTHAM ROAD BANBURY
Drawing Title: PROPOSED EXTERNAL WALL DETAIL 4

Drawn	Checked	Paper Size	Scale	Date
DS	WC	A1	1:50 / 1:500	APRIL 16

Project No: 14334
Drawing No: 6014
Revision: A

CORSTORPHINE + WRIGHT ARCHITECTS
Warwick
Birmingham
Manchester
Newcastle
Canterbury
Dublin
Brook Hall, Brook Street, Warwick, CV34 4BL
Tel: 01925 665444 www.corstorphine-wright.com