

- Constructed or approved FW drainage
- Constructed or approved SW drainage
- - - Proposed village centre FW drainage
- - - Proposed village centre SW drainage
- - - Proposed change to eastern diversion SW drainage

1. CONTRACTORS MUST CHECK ALL DIMENSIONS ON SITE. ONLY FIGURED DIMENSIONS ARE TO BE WORKED FROM. DISCREPANCIES MUST BE REPORTED TO THE ARCHITECT OR ENGINEER BEFORE PROCEEDING. © THIS DRAWING IS COPYRIGHT.
2. REPRODUCED FROM OS SITEMAP © BY PERMISSION OF ORDNANCE SURVEY® ON BEHALF OF THE CONTROLLER OF HER MAJESTY'S STATIONERY OFFICE. © CROWN COPYRIGHT 2008. ALL RIGHTS RESERVED. LICENCE NUMBER 100007126.
3. UNTIL TECHNICAL APPROVAL HAS BEEN OBTAINED FROM THE RELEVANT AUTHORITIES, ALL DRAWINGS ARE ISSUED AS PRELIMINARY AND NOT FOR CONSTRUCTION. SHOULD THE CONTRACTOR COMMENCE SITE WORK PRIOR TO APPROVAL BEING GIVEN IT IS ENTIRELY AT HIS OWN RISK.

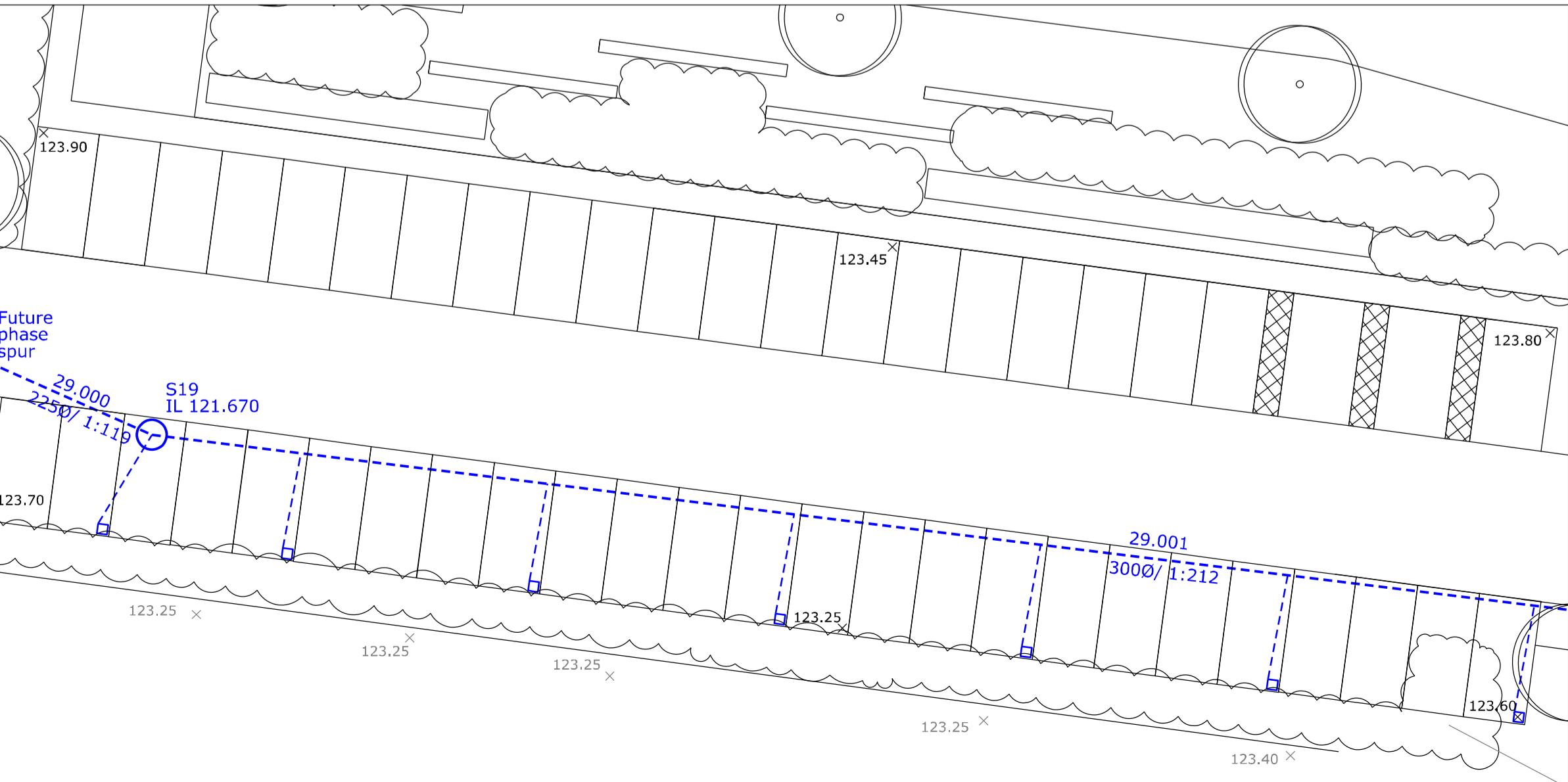
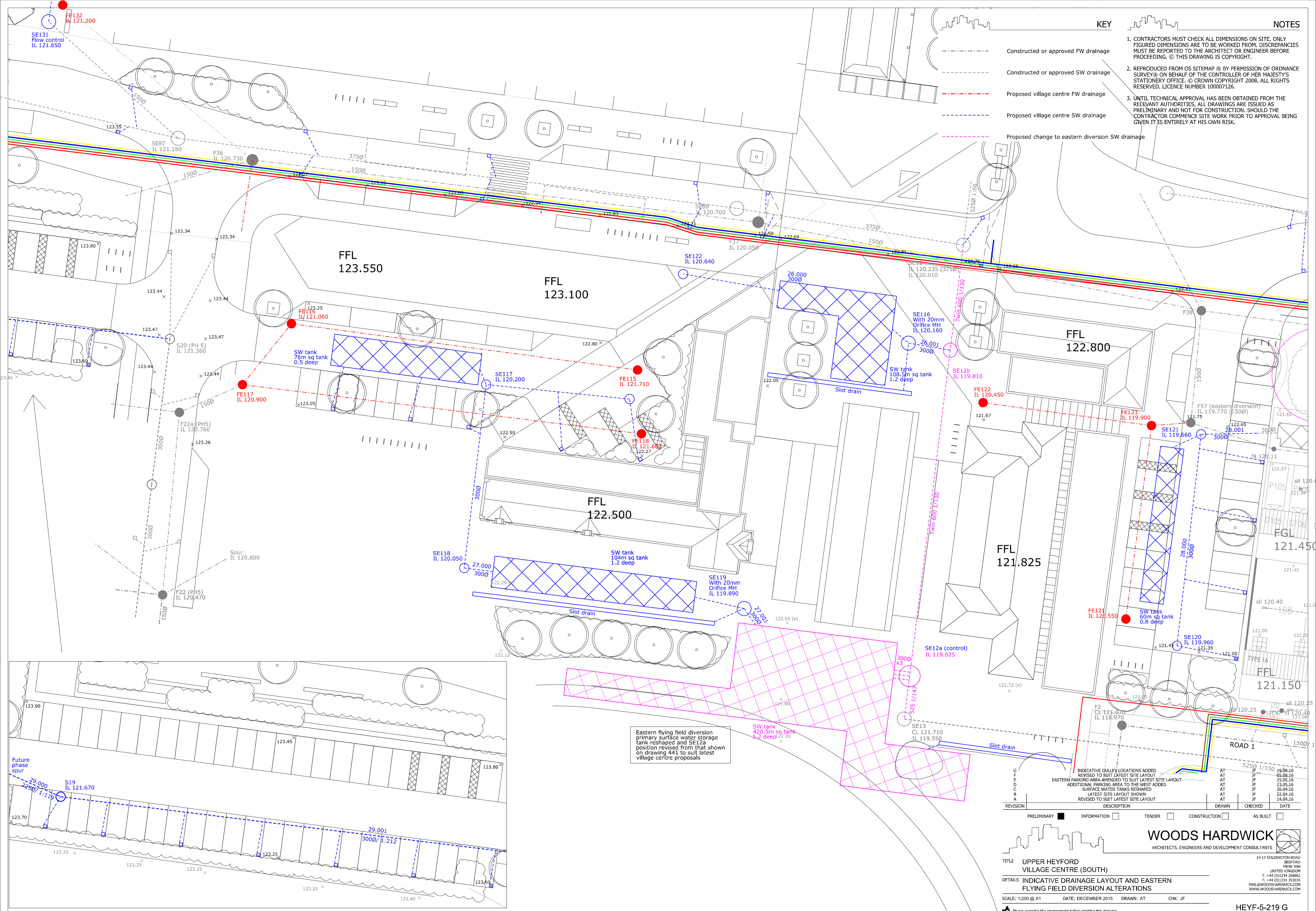

Eastern flying field diversion primary surface water storage tank reshaped and SE12a position revised from that shown on drawing 441 to suit latest village centre proposals

REVISION	DESCRIPTION	DRAWN	CHECKED	DATE
G	INDICATIVE GUILLEY LOCATIONS ADDED	AT	JF	19.08.16
F	REVISED TO SUIT LATEST SITE LAYOUT	AT	JF	05.08.16
F	EASTERN PARKING AREA AMENDED TO SUIT LATEST SITE LAYOUT	AT	JF	25.05.16
D	ADDITIONAL PARKING AREA TO THE WEST ADDED	AT	JF	23.05.16
C	SURFACE WATER TANKS RESHAPED	AT	JF	26.04.16
B	LATEST SITE LAYOUT SHOWN	AT	JF	22.04.16
A	REVISED TO SUIT LATEST SITE LAYOUT	AT	JF	14.04.16

PRELIMINARY
 INFORMATION
 TENDER
 CONSTRUCTION
 AS BUILT

WOODS HARDWICK
 ARCHITECTS, ENGINEERS AND DEVELOPMENT CONSULTANTS

TITLE: UPPER HEYFORD VILLAGE CENTRE (SOUTH)
 DETAILS: INDICATIVE DRAINAGE LAYOUT AND EASTERN FLYING FIELD DIVERSION ALTERATIONS

SCALE: 1:200 @ A1 DATE: DECEMBER 2015 DRAWN: AT CHK: JF

Please consider the environment before printing this drawing
 Filepath: F:\Engineer

15-17 GOLDINGTON ROAD
 BEDFORD
 MK40 3JH
 UNITED KINGDOM
 T. +44 (0)1234 268862
 F. +44 (0)1234 353034
 MAIL@WOODSHARDWICK.COM
 WWW.WOODSHARDWICK.COM

HEYF-5-219 G