

NOTES:  
 Based upon the Ordnance Survey map with permission of The Controller of Her Majesty's Stationery Office. © Crown Copyright.  
 Aspect Landscape Planning Ltd, West Court, Hardwick Business Park, Neal Way, Barbury OX16 2AF  
 Licence 100045345  
 Copyright reserved

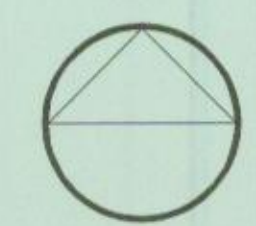

- KEY:**
- Proposed Trees
  - Proposed Hedge
  - Proposed Shrubs
  - Proposed Park Sign
  - Proposed No Dog Sign
  - Proposed Amenity Grass / Turf
  - Proposed Wet Pour
  - Proposed Macadam Footpath
  - Proposed Timber Knee Rail

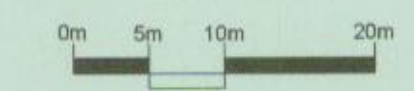
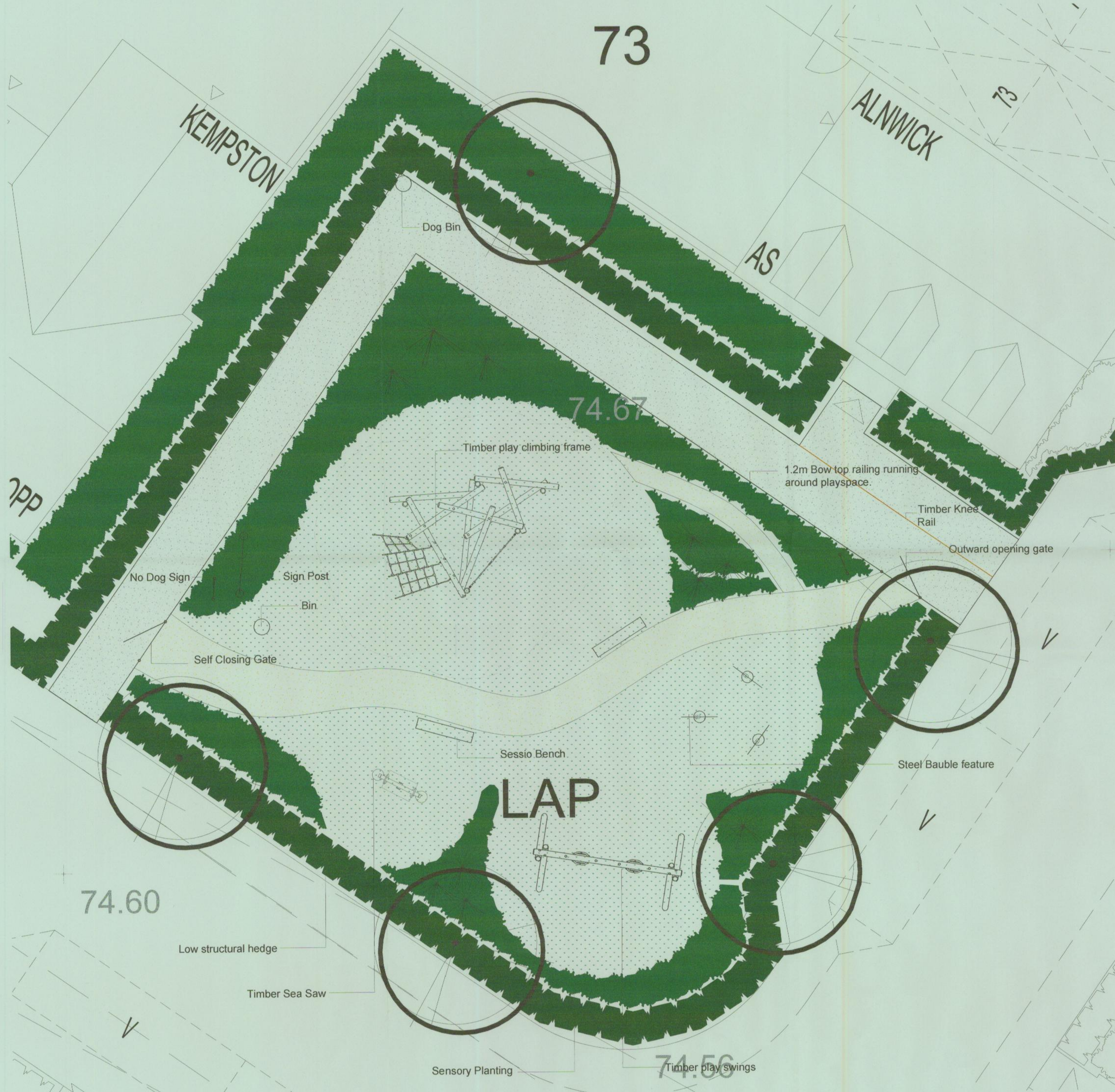

1. 1.8m Log Swing Cradle Seats  
 Company: Wicksteed  
 Range: Timber Swings  
 Product Code: LSW18C



2. Small Sea Saw  
 Company: Timber Play  
 Range: Very Young  
 Product Code: 611700



Product: Sessio Bench  
 Supplier: Russel Play  
 Size: 2110 x 555mm  
 Product Code: SF-02-0020



8. Stainless Steel Bauble  
 Company: Russell Play  
 Range: Timber Balancing  
 Product Code: CP-01-2110



Product: Monmoth Bin  
 Supplier: Wicksteed  
 Product Code: 6120-038

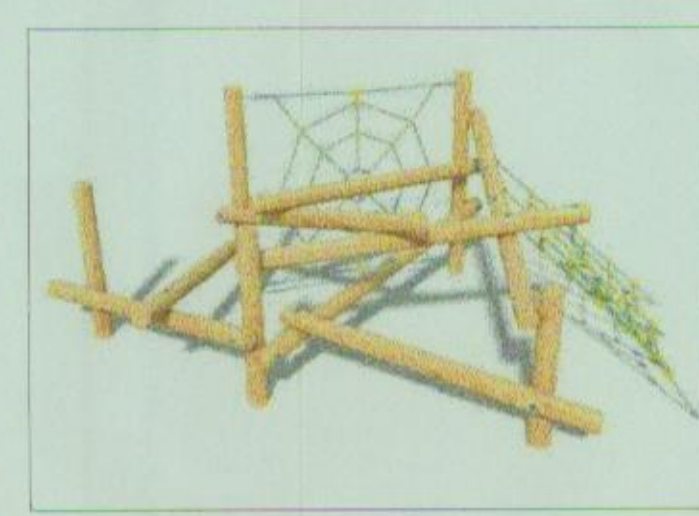

4. Product: Pick up Sticks 4  
 Supplier: Wicksteed  
 Product Code: PICUS4

**Example of Playground Plant Species**

Variety of child friendly plant species provides a sensory experience to users with strong scents, colours and textures.

1. Brachyglottis 'Sunshine
2. Buxus sepervirens
3. Lavandula angustifolia
4. Potentilla fruticosa 'Elizabeth'
5. Rosmarinus officinalis
6. Spiraea japonica 'Candle Light'
7. Miscanthus sinensis 'Silberfeder'

REV	DATE	NOTE	CW	AM
A	20.1.16	Updated to clients comments	CW	AM
REVISIONS				



TITLE  
**Kingsmere  
 Playspace Detail Design - LAP**

CLIENT  
**Bellway Homes**

SCALE	DATE	DRAWN	CHKD
1:500@A1	JAN 2016	CW	AM
DRAWING NUMBER	REVISION		
5797/ ASP4.0	A		