

APPROVED	TITLE	NETWORK RAIL	TITLE
SIGNED	DATE	SIGNED	DATE
NAME	G.E.M (DESIGN PHASE)	NAME	DESIGNATED PROJECT ENGINEER
NAME	DATE	NAME	DATE
NETWORK RAIL ASSET ENGINEER	PRINCIPAL CONTRACTOR		
SIGNED	SIGNED		
TITLE	TITLE		
NAME	NAME		
DATE	DATE	C.A.E (CP/RS)	
NETWORK RAIL CIVIL ENGINEER	PRINCIPAL DESIGNER		
SIGNED	SIGNED		
TITLE	TITLE		
NAME	NAME		
DATE	DATE	C.A.E (CP/RS)	

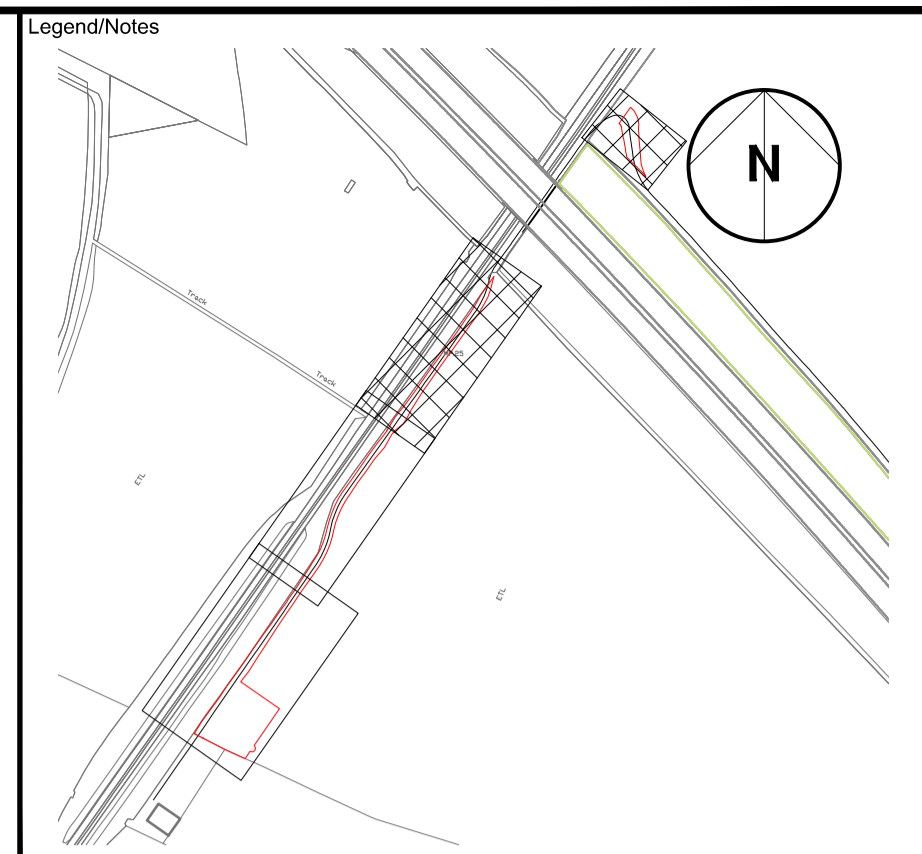
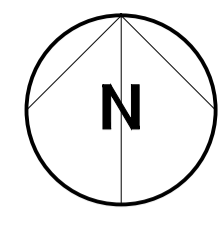
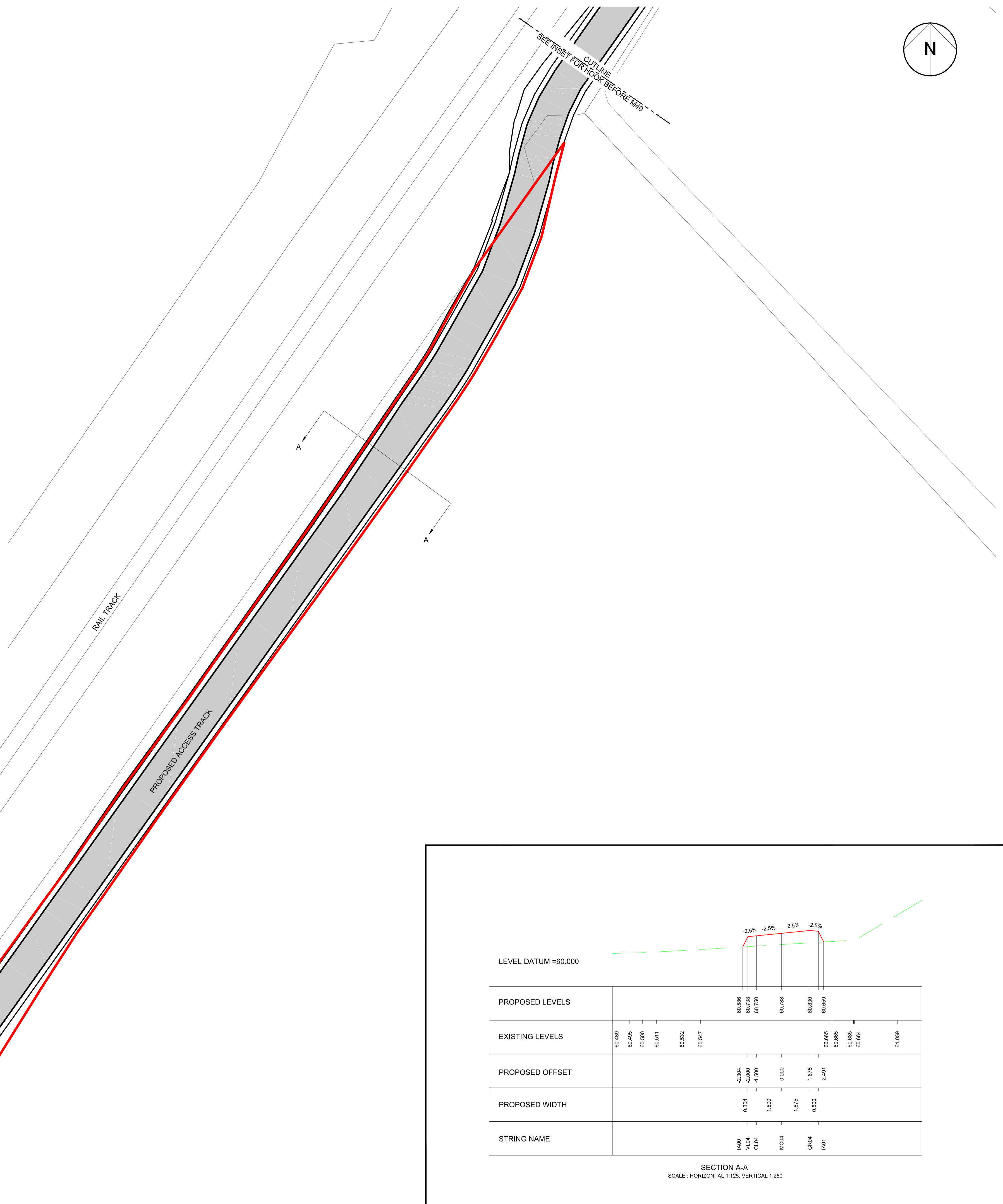
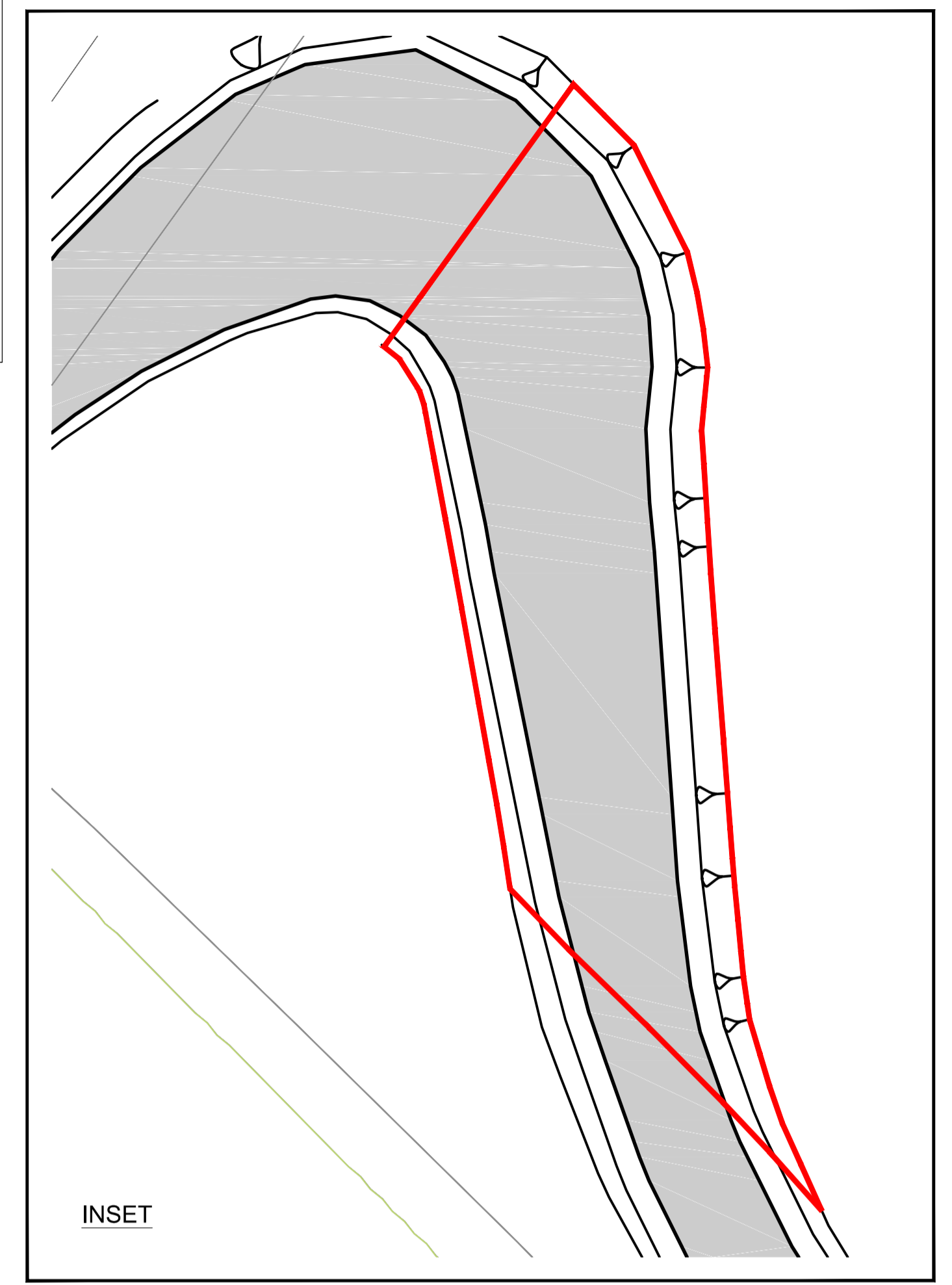

- KEY:**
- BOUNDARY LINE - EXTENTS OF PLANNING APPLICATION
 - CONCRETE SURFACE FINISH
 - PROPOSED DESIGN
 - EXISTING GROUND

- NOTES:**
- LAYOUT IS BASED UPON OS TILE DATA PROVIDED BY NETWORK RAIL (© CROWN COPYRIGHT AND DATABASE RIGHTS 2013 ORDNANCE SURVEY 0100040692), AERIAL SURVEY UNDERTAKEN BY ATKINS IN AUGUST 2009 AND TOPOGRAPHICAL SURVEY UNDERTAKEN BY ATKINS IN MAY 2013. ALL DIMENSIONS TO BE CHECKED AND VERIFIED ON SITE.

Rev	Date	Description of Revisions	Drawn	Chkd	Appr
P04	13/10/15	FLOOD COMPENSATION AREA REMOVED	NJB	KW	KW
P03	30/09/15	AMENDMENTS AS PER PLANNING COMMENTS	NJB	KW	KW
P02	21/08/15	BOUNDARY LINE AMENDED	NJB	DPS	KW
P01	23/02/15	FIRST ISSUE	NJB	DPS	KW

FOR INFORMATION

Contractor(s)

ATKINS

The Axis
10 Holliday Street
Birmingham
West Midlands
B1 1TF

Tel: +44 (0)121 483 5000
Fax: +44 (0)121 483 6333

Project
EAST WEST RAIL PHASE 1

Drawing Title
**HOME FARM
AGRICULTURAL BUILDING
AND ACCESS TRACK
SHEET 1 OF 3**

Designed	NICHOLA BUTLER	Signed		Date	12/02/2015
Drawn	NICHOLA BUTLER	Signed		Date	12/02/2015
Checked	DARREN SALMONS	Signed		Date	12/02/2015
Approved	KAREN WOOD	Signed		Date	12/02/2015

Scale(s)
1:200 @ A1
ELR & Mileage
OXD

Alternative Reference
Sheet 1 of 3
Revision 1 of 3

Drawing Number
5114534-ATK-SKT-HW-000097
P04

