

BUS STOP

BUS STOP

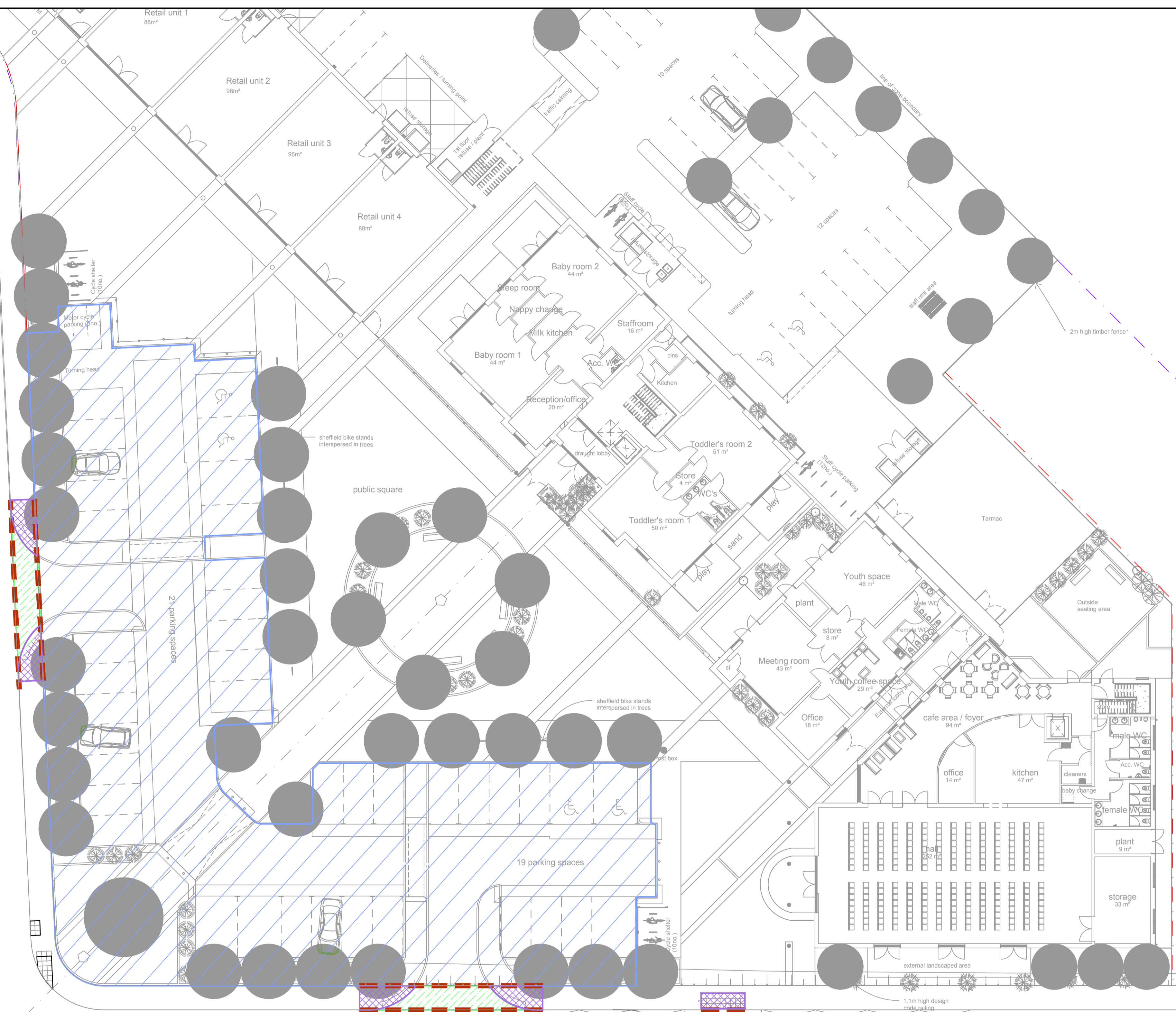

DO NOT SCALE

- NOTES
1. ALL DIMENSIONS ARE IN METRES UNLESS OTHERWISE STATED.
 2. THIS DRAWING IS TO BE READ IN CONJUNCTION WITH ALL DRAWINGS AND NOTES FROM THE WSP DESIGN PACK LCP. THE CONTRACTOR IS TO SATISFY THEMSELVES THAT THERE ARE NO DISCREPANCIES WITHIN THE DESIGN PACK BEFORE COMMENCING ON SITE. IF IN DOUBT ASK.
 3. ALL WORKS TO BE UNDERTAKEN IN COMPLIANCE WITH PROJECT SPECIFICATION & TO OCC APPROVAL.
 4. ANY DISCREPANCIES BETWEEN PROJECT SPECIFICATION & OCC REQUIREMENTS TO BE REPORTED IMMEDIATELY TO THE ENGINEER.
 5. EXISTING ROAD MARKINGS THROUGHOUT EXTENT OF WORKS TO BE REMOVED WITH HYDRO BLASTING.
 6. CARRIAGEWAY TO BE SAW CUT ALONG PROPOSED CHANNEL LINE 600mm FROM EDGE WHERE KERBS ARE TO BE REMOVED TO ALLOW FOR NEAT KEYING IN.
 7. ALL MATERIAL MARKED TO BE REMOVED/ EXCAVATED/ BROKEN OUT/ CUT, UNLESS OTHERWISE NOTED, TO BE TAKEN TO A LICENSED TIP OFF SITE.
 8. FOR EXTENT OF CAR PARK CONSTRUCTION DETAILS, REFER TO WSP DRAWINGS NO.1903-LCP-300
 9. CONTRACTOR TO LOCATE UTILITIES PRIOR TO EXCAVATIONS. REFER TO WSP DRAWING No. 210 FOR HAZARD IDENTIFICATION.
 10. WHERE PROPOSED KERBS ARE TO BE LAID, CARRIAGEWAY, FOOTWAY OR VERGE TO BE EXCAVATED 400mm FOR KERB BRACE.

- KEY
- PROPOSED SITE BOUNDARY
 - PROPOSED KERB LINE. REFER TO NOTE 10
 - EXISTING FOOTWAY TO BE BROKEN OUT AND EXCAVATED TO DROPPED TACTILE CROSSING CONSTRUCTION FORMATION LEVEL.
 - EXCAVATION OF EXISTING GROUND (TO CAR PARK FORMATION LEVEL) IS TO BE REGRADED TO A REQUIRED DEPTH.
 - EXISTING FOOTWAY TO BE BROKEN OUT AND EXCAVATED TO PROPOSED FULL DEPTH CARRIAGEWAY CONSTRUCTION FORMATION LEVEL.
 - BREAK OUT AND REMOVE TO TIP OFF SITE EXISTING KERB, CHANNEL KERBS, EF EDGING AND HAUNCHING.

REV	DATE	BY	DESCRIPTION	CHK	APD
H	06/05/16	TRK	MASTERPLAN REVISED	JH	JH
G	04/05/16	TRK	HATCHING UPDATED	JH	JH
F	10/02/16	TRK	HATCHING UPDATED	JH	JH
E	09/02/16	TRK	HATCHING UPDATED	JH	JH
D	12/11/15	TRK	LAYOUT AND KEY UPDATED	JH	JH
C	07/10/15	TRK	KEY UPDATED	AC	AC
B	29/09/15	FI	LAYOUT UPDATED	AC	AC
A	06/08/15	SMR	FIRST ISSUE	AC	AC

DRAWING STATUS: FOR INFORMATION ONLY

Mountbatten House, Basing View, Basingstoke, Hampshire RG21 4HJ
 Tel: +44 (0)1256 318800 Fax: +44 (0)1256 318700
<http://www.wspgroup.com>

CLIENT: COUNTRYSIDE PROPERTIES (BICESTER) LTD

ARCHITECT:

PROJECT: SOUTH WEST BICESTER BICESTER, OXFORDSHIRE

TITLE: LOCAL CENTRE CAR PARK SITE CLEARANCE

SCALE @ A1: 1:200 @ A1 CHECKED: AD APPROVED: AD

CAD FILE: 1903-PSA-100 DESIGN/DRAWN: SMR DATE: October 2015

PROJECT No: 11011903 DRAWING No: 1903-LCP-200 REV: H

© WSP Group Ltd

S:\BICESTER NEW TOWN\DRAWINGS\AUTOCAD\LOCAL CENTRE CAR PARK\1903-LCP-200 SITE CLEARANCE REV G.DWG 06/05/2016 12:05:10 Killingback, Tim