

DO NOT SCALE

- NOTES:
- THIS DRAWING IS TO BE READ IN CONJUNCTION WITH ALL DRAWINGS AND NOTES FROM THE WSP LOCAL CENTRE CAR PARK DESIGN PACK. THE CONTRACTOR IS TO SATISFY THEMSELVES THAT THERE ARE NO DISCREPANCIES WITHIN THE DESIGN PACK BEFORE COMMENCING ON SITE.
  - ALL DIMENSIONS ARE IN METRES UNLESS OTHERWISE STATED, SIMILARLY ALL LEVELS ABOVE DATUM ARE ALSO IN METRES.
  - PRIOR TO THE COMMENCEMENT OF CONSTRUCTION WORKS, EXISTING LEVELS AND DIMENSIONS ARE TO BE CHECKED AND CONFIRMED ON SITE.
  - ANY DISCREPANCIES SHOULD BE REPORTED TO THE ARCHITECT/ENGINEER IMMEDIATELY SO THAT CLARIFICATION CAN BE SOUGHT PRIOR TO THE COMMENCEMENT OF WORK.
  - PRIOR TO CONSTRUCTION WORKS COMMENCING ON SITE, THE LOCATION OF ALL EXISTING SERVICES ARE TO BE CHECKED AND THEIR LOCATION CONFIRMED BY THE CONTRACTOR.
  - WORKS LIMIT TO ONLY INCLUDE CAR PARK, ACCESS AND CROSSING ELEMENTS. ANYTHING OUTSIDE OF THIS AREA IS NOT WSP'S RESPONSIBILITY
  - FOR CAR PARK CONSTRUCTION DETAILS, REFER TO WSP DRAWING NO.1903-LCP-700
  - FOR CAR PARK DRAINAGE DETAILS, REFER TO WSP DRAWING NO.1903-LCP-500

- KEY
- PROPOSED SITE BOUNDARY
  - EXISTING SURFACE WATER DRAINAGE
  - EXISTING GULLY AND CONNECTION
  - PROPOSED NEW CAR PARK SURFACE WATER SEWER
  - PROPOSED GULLY AND CONNECTION
  - PROPOSED TACTILE PAVING
  - PROPOSED 2.4m X 45m JUNCTION VISIBILITY
  - EXISTING STREET LIGHTING
  - PROPOSED BELISHA BEACON WITH LANTERN
  - PROPOSED CAR PARK STREET LIGHTING
  - PROPOSED BOLLARD TO BE LOCATED 450mm CLEAR FROM FACE OF KERB
  - PROPOSED SIGN

REV	DATE	BY	DESCRIPTION	CHK	APD
K	06/05/16	TRK	MASTERPLAN REVISED	JFB	JFB
J	04/05/16	TRK	CAR PARK LAYOUT REVISED	JFB	JFB
H	10/02/16	TRK	PARKING BAYS REVISED	JFB	JFB
G	09/02/16	TRK	PARKING BAYS REVISED	JFB	JFB
F	12/11/15	TRK	LAYOUT UPDATED	JFB	JFB
E	23/10/15	TRK	LAYOUT UPDATED	AC	AC
D	08/10/15	MB	LAYOUT UPDATED	AC	AC
C	29/09/15	FI	LAYOUT UPDATED	AC	AC
B	21/09/15	SMR	AMENDED TO RSA COMMENTS	AC	AC
A	06/08/15	SMR	FIRST ISSUE	AC	AC

DRAWING STATUS: FOR INFORMATION ONLY



Mountbatten House, Basing View, Basingstoke, Hampshire RG21 4JU  
Tel: +44 (0)1256 318800 Fax: +44 (0)1256 318700  
http://www.wspgroup.com

CLIENT: COUNTRYSIDE PROPERTIES (BICESTER) LTD

ARCHITECT:

PROJECT: SOUTH WEST BICESTER BICESTER, OXFORDSHIRE

TITLE: LOCAL CENTRE CAR PARK GENERAL ARRANGEMENT

SCALE @ A1: 1:200 @ A1	CHECKED: AD	APPROVED: AD
CAD FILE: 1903-LCP-100	DESIGN/DRAWN: SMR	DATE: September 2015

PROJECT No: 11011903	DRAWING No: 1903-LCP-100	REV: K
----------------------	--------------------------	--------

© WSP Group Ltd

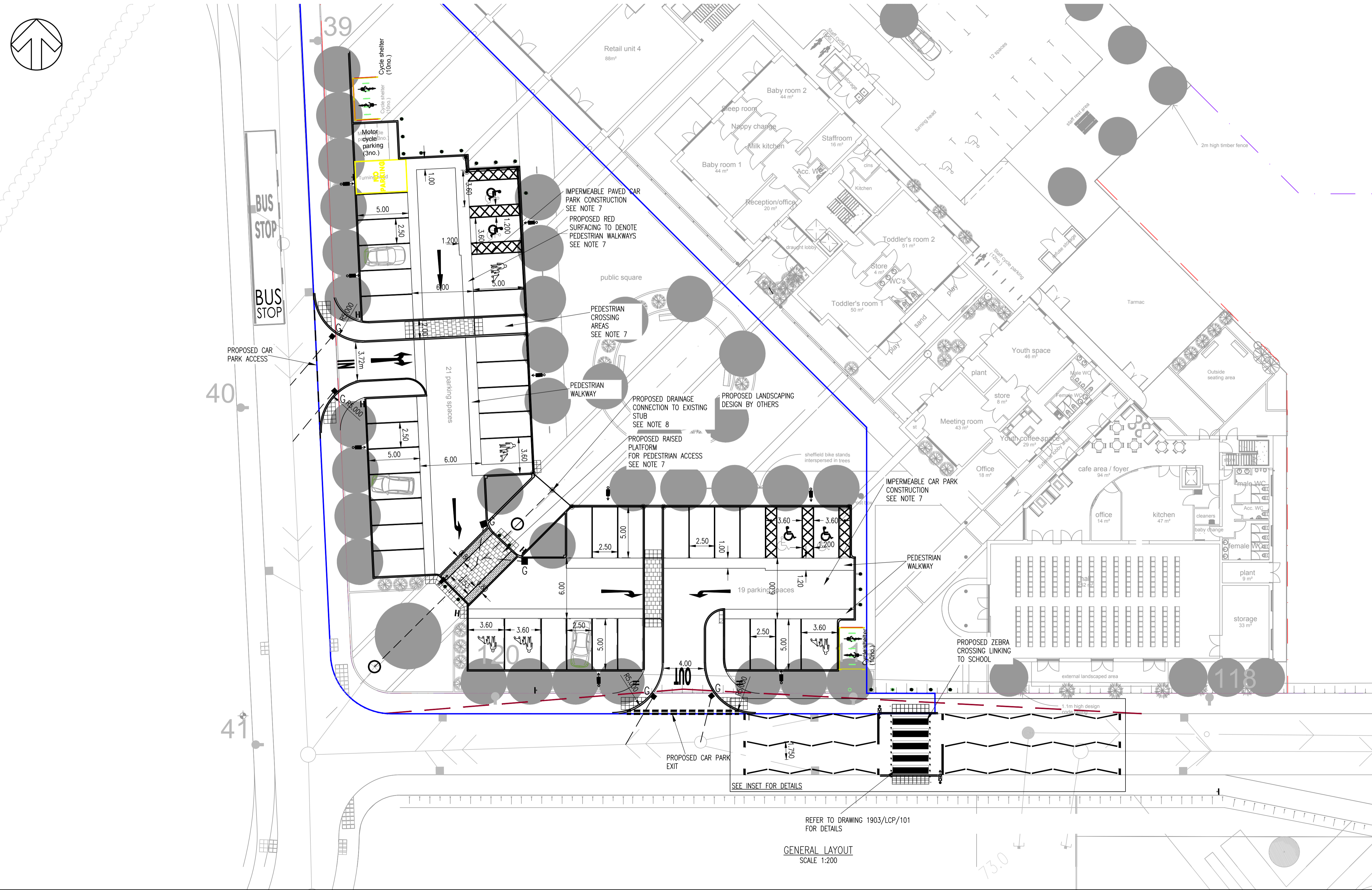
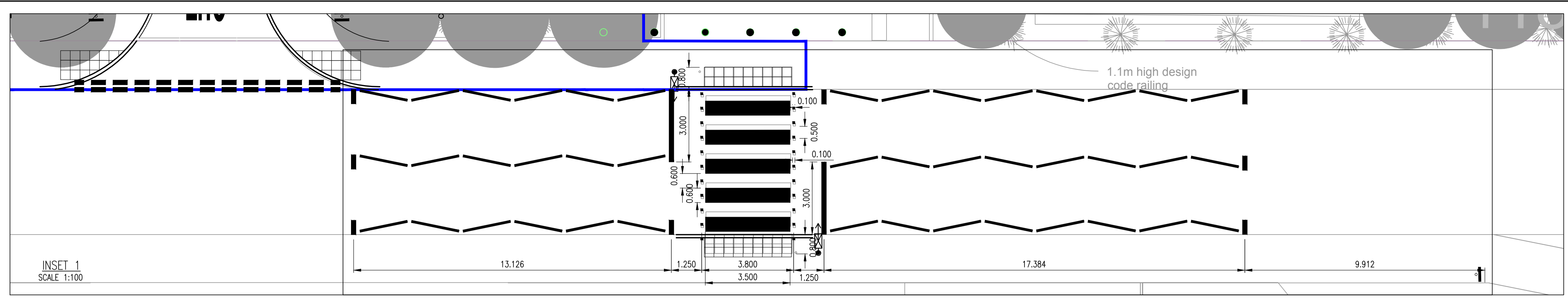

REFER TO DRAWING 1903/LCP/101 FOR DETAILS  
GENERAL LAYOUT  
SCALE 1:200

S:\BICESTER NEW TOWN\DRAWINGS\AUTOCAD\LOCAL CENTRE CAR PARK\1903-LCP-100 CA REV J.DWG 06/05/2016 11:56:41 Killingbeck, Tim