

PARCELS KMA & KMB, KINGSMERE, BICESTER

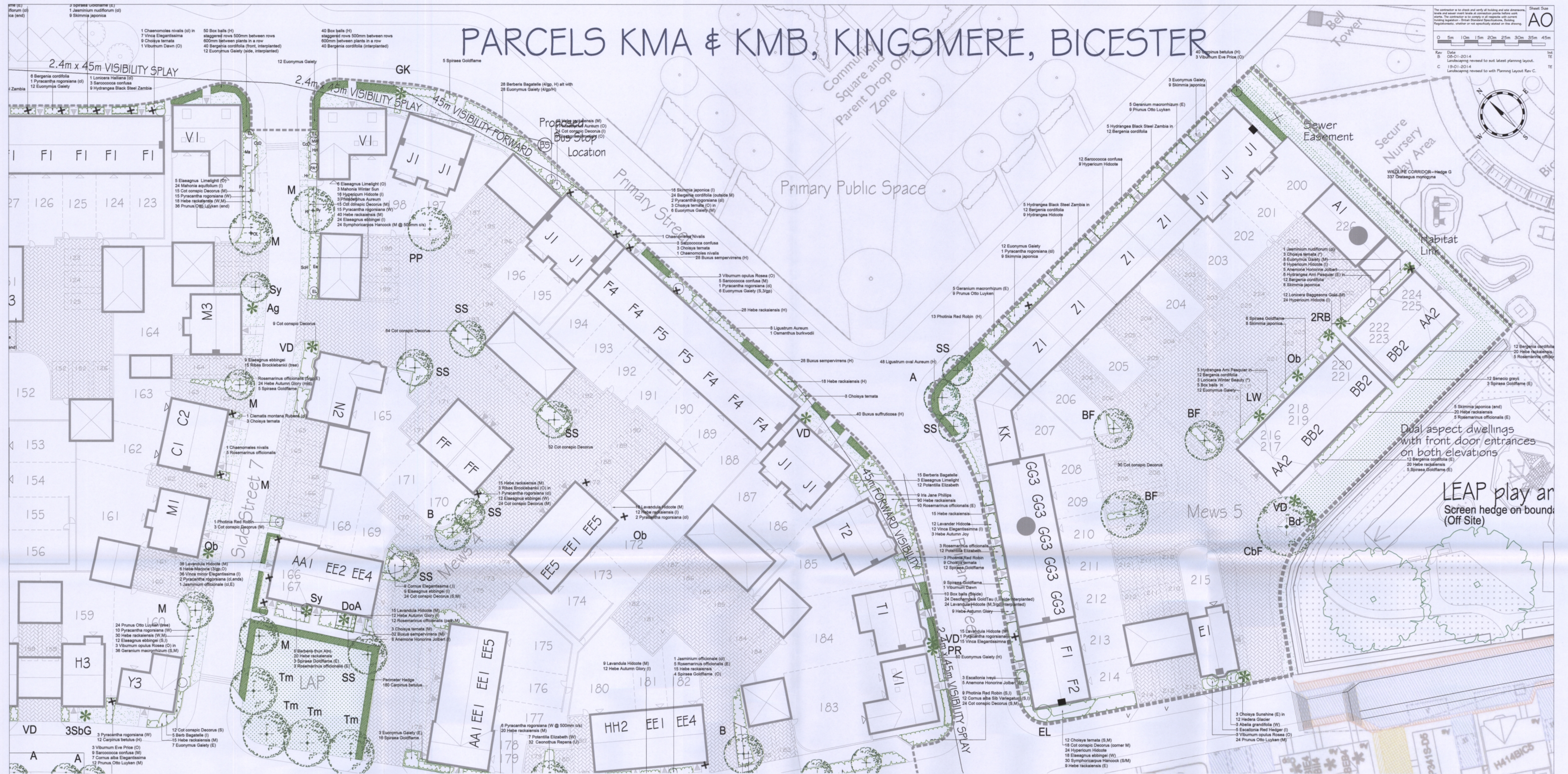

GENERAL PLANTING SPECIFICATION

GENERAL: All work to be undertaken in accordance with BS4428:1989 and BS7370:1993. No trees to be planted within 3 meters of existing or proposed buildings. Trees to be planted within 3 meters of existing or proposed buildings. Trees to be planted within 3 meters of existing or proposed buildings.

WILDFLOWER SEED FOR REAR GARDENS, COMMUNAL AREAS AND POND

GENERAL: All work to be undertaken in accordance with BS4428:1989 and BS7370:1993. No trees to be planted within 3 meters of existing or proposed buildings. Trees to be planted within 3 meters of existing or proposed buildings.

LANDSCAPE MANAGEMENT PLAN: 15 YEAR SUMMARY SHEET

Operation	Time in years	1	2	3	4	5	15yr
Grass - Close mown, Open areas							
Grass - Wildflowering grass areas							
Establish to suppliers recommendations							
2 cuts September and April/May							
Fertiliser (March-May, Oct, Nov, 4x year)							
Hedgehog margins: 1 cut per year to control snails (September)							
Weedkilling (light duty, twice a year)							
Annual soft landscaping (14 days annually)							
Edge adjacent to hard surfaces and siting areas (10x a year)							
Tree Pruning							
Replacement of Defects (Communal areas)							
Replacement of Defects (Private areas)							
Replacement of Defects (Communal areas)							
Replacement of Defects (Private areas)							
Grass - Close mown, Open areas							
Grass - Wildflowering grass areas							
Establish to suppliers recommendations							
2 cuts September and April/May							
Fertiliser (March-May, Oct, Nov, 4x year)							
Hedgehog margins: 1 cut per year to control snails (September)							
Weedkilling (light duty, twice a year)							
Annual soft landscaping (14 days annually)							
Edge adjacent to hard surfaces and siting areas (10x a year)							
Tree Pruning							
Replacement of Defects (Communal areas)							
Replacement of Defects (Private areas)							
Grass - Close mown, Open areas							
Grass - Wildflowering grass areas							
Establish to suppliers recommendations							
2 cuts September and April/May							
Fertiliser (March-May, Oct, Nov, 4x year)							
Hedgehog margins: 1 cut per year to control snails (September)							
Weedkilling (light duty, twice a year)							
Annual soft landscaping (14 days annually)							
Edge adjacent to hard surfaces and siting areas (10x a year)							
Tree Pruning							
Replacement of Defects (Communal areas)							
Replacement of Defects (Private areas)							

PLANT SCHEDULE: All to BS9308 Part 1:

Common Name	Size	Quantity	Notes
Acacia saligna	(Field maple)	18 12-14cm 3-5M	
Acacia saligna	(Field maple)	18 12-14cm 3-5M	
Acacia saligna	(Field maple)	18 12-14cm 3-5M	
Acacia saligna	(Field maple)	18 12-14cm 3-5M	
Acacia saligna	(Field maple)	18 12-14cm 3-5M	

ORNAMENTAL SHRUBS

Common Name	Size	Quantity	Notes
Acacia saligna	(Field maple)	18 12-14cm 3-5M	
Acacia saligna	(Field maple)	18 12-14cm 3-5M	
Acacia saligna	(Field maple)	18 12-14cm 3-5M	
Acacia saligna	(Field maple)	18 12-14cm 3-5M	
Acacia saligna	(Field maple)	18 12-14cm 3-5M	

NATIVE HEDGE

Common Name	Size	Quantity	Notes
Acacia saligna	(Field maple)	18 12-14cm 3-5M	
Acacia saligna	(Field maple)	18 12-14cm 3-5M	
Acacia saligna	(Field maple)	18 12-14cm 3-5M	
Acacia saligna	(Field maple)	18 12-14cm 3-5M	
Acacia saligna	(Field maple)	18 12-14cm 3-5M	

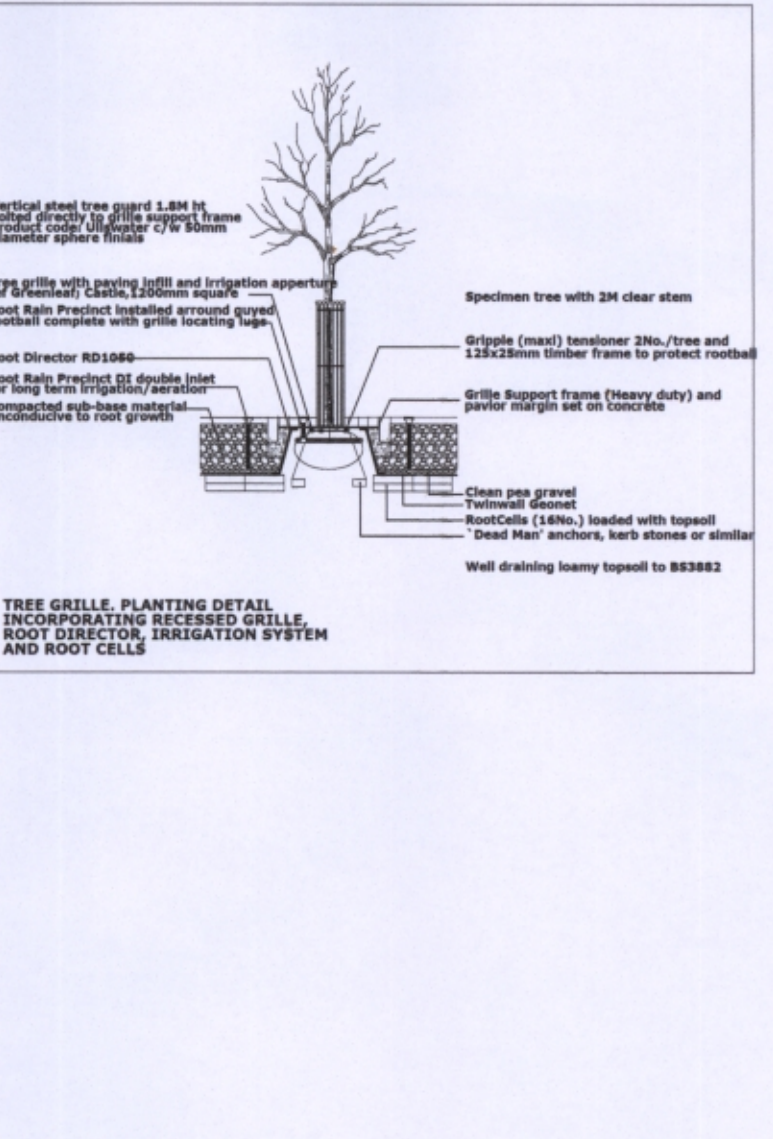

Linden HOMES

PROJECT: PARCELS KMA & KMB, KINGSMERE, BICESTER

DRG TITLE: LANDSCAPING LAYOUT SHEET G OF 6

JOB NO: 1186 | DRG NO: 101-6 | REV: C

SCALE: 1:200 | DRN BY: MD

DATE: 09/14 | CHK BY: TCE

The NOBLE Consultancy
 • Architecture • Planning • Urban Design • Landscaping
 • The Studios, Sage Court Farm, Badminton Road, Badminton, Stroud, Gloucestershire, GL53 2NY
 • T: 01454 745203
 • E: design@noble-consultancy.co.uk
 • W: www.noble-consultancy.co.uk