

DO NOT SCALE

NOTES:

- THIS DRAWING SHALL BE READ IN CONJUNCTION WITH ALL RELATED DOCUMENTATION, DRAWINGS AND STANDARD DETAILS.
- CONFLICTING INFORMATION SHOWN ON THE ENGINEER'S DRAWINGS OR DISCREPANCIES BETWEEN THE INFORMATION GIVEN BY THE ENGINEER AND THAT PROVIDED BY OTHERS MUST BE REFERRED TO THE ENGINEER BEFORE THE WORKS COMMENCE.

KEY:

- INDICATIVE SERVICE CORRIDOR
- PERMEABLE PAVING
- CATCHMENT AREA 1 (100% IMPERMEABLE)
- CATCHMENT AREA 2 (100% IMPERMEABLE)
- IMPERMEABLE ASPHALT SURFACE WITH OPEN GRADED SUB-BASE FOR SURFACE WATER ATTENUATION
- INDICATIVE SURFACE WATER DRAINAGE ROUTE
- INDICATIVE SURFACE WATER DRAINAGE
- INDICATIVE FOUL WATER DRAINAGE

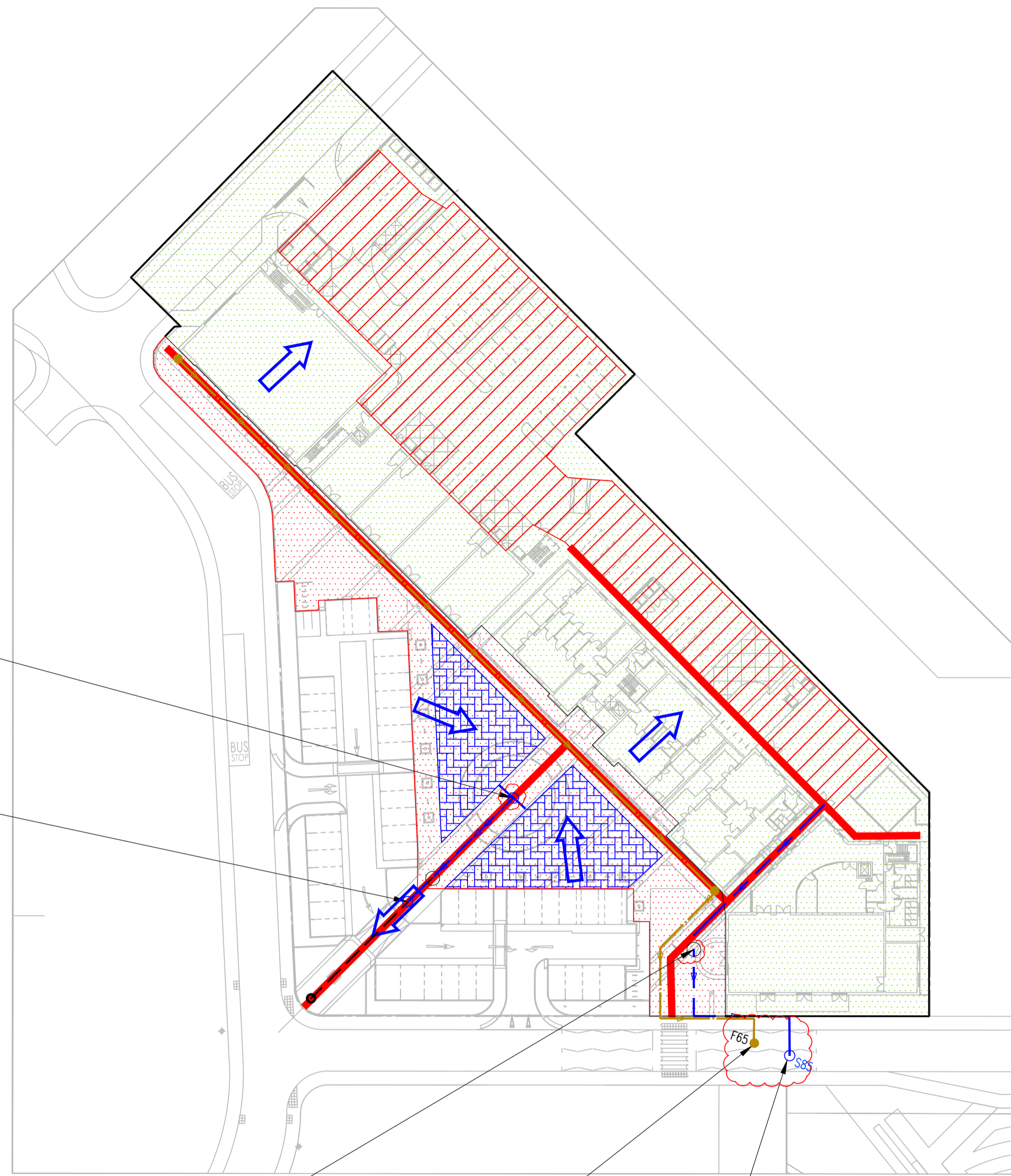

INDICATIVE LOCATION OF PROPOSED ORIFICE PLACE / HYDROBRAKE FLOW CONTROL WITH WEIR OVERFLOW

AREA 1 DISCHARGES TO UPSTREAM MANHOLE SHOWN ON 1903-I-CP-500-J I/L AT CONNECTION 71.950m AOD. DISCHARGE RATE= 5L/S

INDICATIVE LOCATION OF PROPOSED ORIFICE PLACE / HYDROBRAKE FLOW CONTROL WITH WEIR OVERFLOW

FOUL NETWORK DISCHARGES TO MH F65 AT 70.613m AOD SHOWN ON DRAWING 1903-D-108-W. DISCHARGE RATE= 1.8L/S

AREA 2 DISCHARGES TO MH S85 AT 70.740m AOD I/L SHOWN ON 1903-D-108-W. DISCHARGE RATE= 6L/S

SUDS PROVISION ESTIMATE SUMMARY			
	AREA 1	AREA 2	TOTAL
SOURCE CONTROL (m ²)	28	126	154
IMPERMEABLE AREA (ha)	0.547	0.169	0.716
ATTENUATION REQUIRED, 10 YR RAINFALL EVENT (m ²)	18-30	90-133	108-163
ATTENUATION PROVIDED (m ²)	115	303	141

REV	DATE	BY	DESCRIPTION	CHK	APD
B	18/02/16	LB	DISCHARGE RATES AND INDICATIVE FLOW CONTROL LOCATIONS ADDED.	JW	JP
A	15/02/16	LB	FIRST ISSUE	JW	JP

DRAWING STATUS: FOR INFORMATION ONLY



Mountbatten House, Basing View, Basingstoke, Hampshire RG21 4HJ
Tel: +44 (0)1256 318800 Fax: +44 (0)1256 318700
http://www.wspgroup.com

CLIENT: COUNTRYSIDE PROPERTIES

ARCHITECT:

PROJECT: BICESTER NEW TOWN

TITLE: INDICATIVE SURFACE WATER DRAINAGE STRATEGY

SCALE @ A1: 1:500 CHECKED: JW APPROVED: JB

CAD FILE: 1903-D-122 DESIGN/DRAWN: LB DATE: February 2016

PROJECT No: 11012779 DRAWING No: 1903-D-122 REV: B

© WSP Group Ltd

S:\BICESTER NEW TOWN\DRAWINGS\AUTOCAD\DRAINAGE\1903-D-122.DWG 18/02/2016 14:19:21 Bacon, Luke

Reproduced from the Ordnance Survey map with the permission of the Controller of Her Majesty's Stationery Office. Licence no. 100048755. Crown copyright reserved.

0 25 metres