

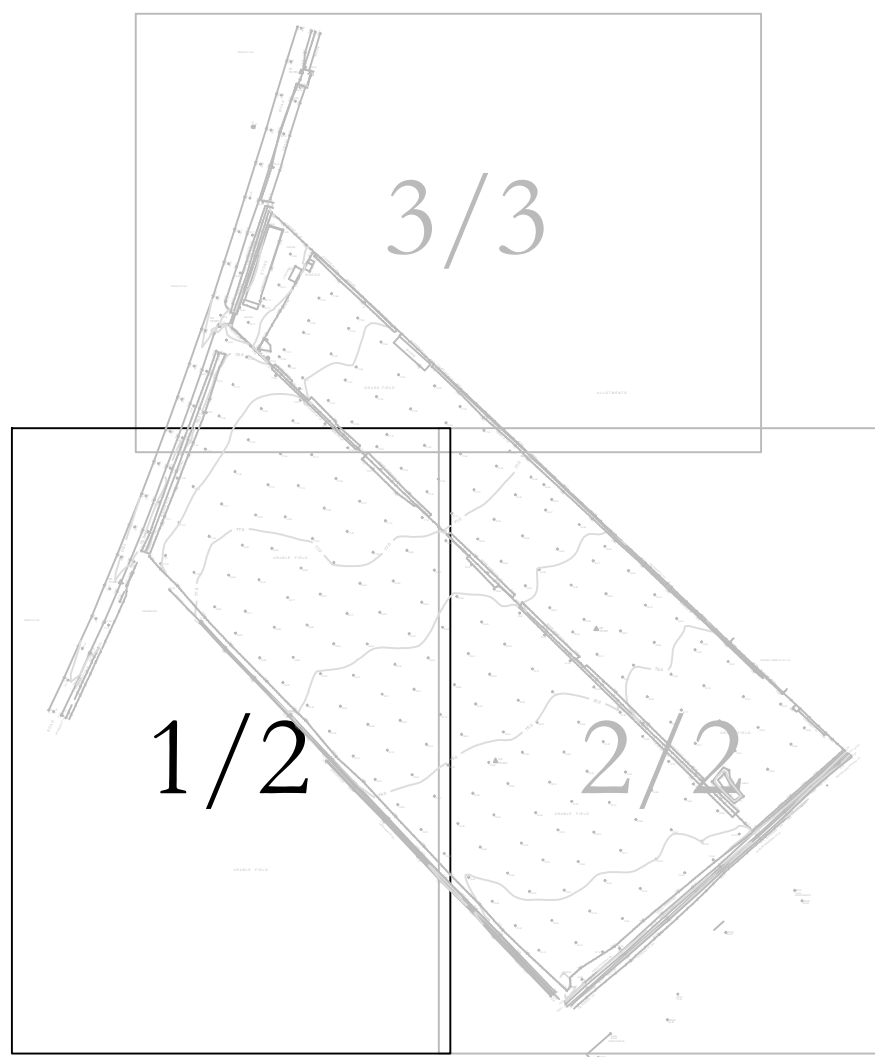

TREES HT 12m

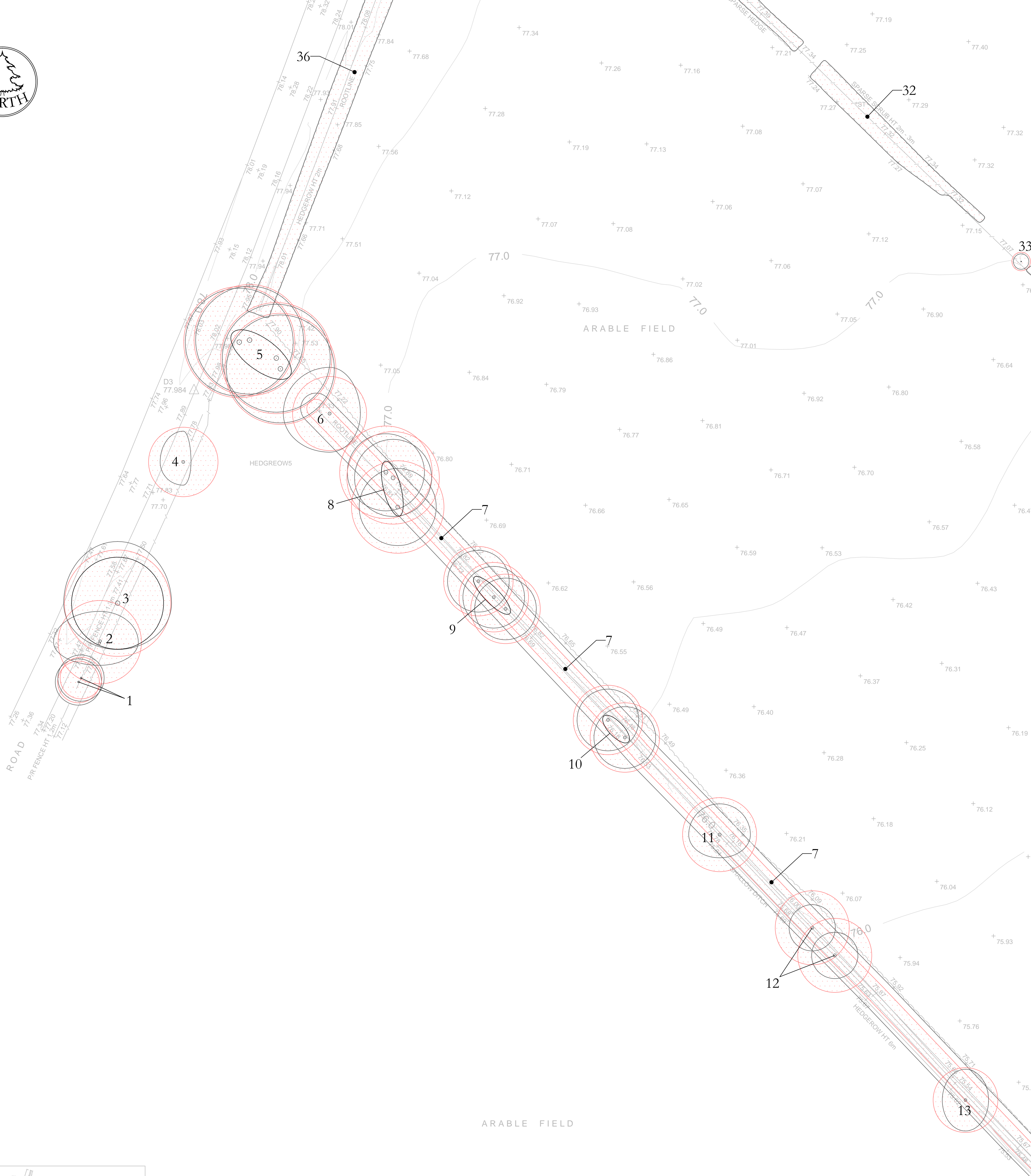

Sheet Layout

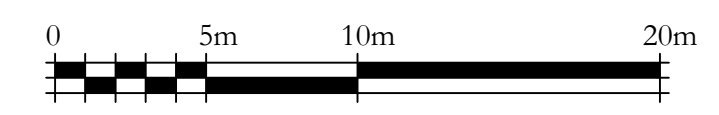

Key:

1. Trees to be considered for retention:

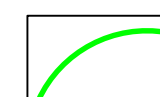
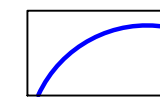
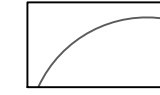
-  Tree Category A 1,2 or 3
- trees of high quality
-  Tree Category B 1,2 or 3
- trees of moderate quality
-  Tree Category C 1,2 or 3
- trees of low quality

2. Trees unsuitable for retention:

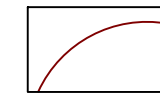
-  Tree Category U
- trees that cannot realistically be retained due to their condition

3. Protected areas:

-  Root Protection Area (RPA)

4. Tree numbering

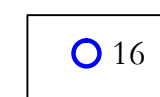
-  16 Tree number
- refer to schedule for information

CLIENT: CSA Environmental Planning	
PROJECT: Land at Green Lane, Chesterton	
TITLE: Tree Constraints Plan	
DRAWING NUMBER: 8364/01 1/3	
STATUS: For Information	
DATE: April 2014	SCALE: 1:250 @ A1
DRAWN BY: ML	CHECKED BY: JTK
<p>Do not scale from this drawing: All dimensions to be checked on site</p> <p>The copyright of this document resides with Ian Keen Limited unless assigned in writing by the company</p>	
<p>IAN KEEN LIMITED</p> <p>Consultants for Trees, Landscapes and Nature Conservation</p> <p>Rollands Farm, Rollands Lane, Epsom, Epsom, Surrey GU10 5AS Telephone: 01252 85096 Facsimile: 01252 851702 Email: mail@iceekings.co.uk</p>	

Note:
The original of this drawing was produced in colour - a monochrome copy should not be relied upon.

Tree survey based on RPS drawing number JKK8123_1 Rev A.

For tree schedule see drawing number 8364/01 3/3.