

DO NOT SCALE

- NOTES:
1. THIS DRAWING SHOULD BE READ IN CONJUNCTION WITH ALL OTHER RELEVANT ENGINEERING DETAILS, DRAWINGS & SPECIFICATIONS.
  2. ALL DIMENSIONS ARE IN METRES UNLESS OTHERWISE STATED. SIMILARLY ALL LEVELS ABOVE DATUM ARE ALSO IN METRES.
  3. PRIOR TO THE COMMENCEMENT OF CONSTRUCTION WORKS, CONTRACTOR TO LOCATE AND PROBE THE POSITION/DEPTH OF ALL SERVICES WHICH WILL AFFECT THE WORKS PRIOR TO COMMENCING ANY CONSTRUCTION.
  4. ANY PROPOSED WORKS TO BE INSTALLED TO THE EXISTING/PROPOSED INFRASTRUCTURE SHALL BE CHECKED AND APPROVED BY THE LOCAL AUTHORITY PRIOR TO COMMENCING ANY CONSTRUCTION.
  5. PRIOR TO CONSTRUCTION WORKS COMMENCING ON SITE, THE LOCATION OF ALL EXISTING SERVICES ARE TO BE CHECKED AND THEIR LOCATION CONFIRMED.
  6. THE LOCATION OF ANY SERVICES SHOWN ON THIS DRAWING IS FOR INFORMATION ONLY. CONTRACTOR TO VERIFY THE LOCATION OF ALL SERVICES WHICH WILL AFFECT THE WORKS PRIOR TO COMMENCING ANY CONSTRUCTION.
  7. ANY RELOCATION/REPAIR WORKS REQUIRED ARE TO BE ACCORDING TO THE RELEVANT STANDARDS AND SPECIFICATIONS IN ACCORDANCE WITH THE RELEVANT STATUTORY INSTRUMENTS/REQUIREMENTS.
  8. ALL HIGHWAY DRAINAGE TO BE ADOPTED BY OGC WHO REQUIRE THAT ALL DRAINS BE CONSTRUCTED TO THE STANDARDS LAD DOWN IN 'SERIES FOR ADOPTION EDITION 3'.
  9. ALL SERVICES TO BE LAD TO CLASS 5 BEDDING CLASSIFICATION UNLESS SPECIFIED OTHERWISE.

- BS2:
- 1. CARBONSTEEL CONSTRUCTION TYPE 1, REFER TO DRAWING 1903/SJ/001
  - 2. CARBONSTEEL CONSTRUCTION TYPE 2, REFER TO DRAWING 1903/SJ/001
  - 3. CARBONSTEEL CONSTRUCTION TYPE 3, BITUMENOUS MATERIAL OVERLAYING EXISTING CARBONSTEEL, FOR MATERIALS REFER TO 1903/SJ/001 AND 1903/SJ/002
  - 4. FOOTING CONSTRUCTION, REFER TO DRAWING 1903/SJ/001
  - 5. FOOTING CONSTRUCTION, REFER TO DRAWING 1903/SJ/001
  - 6. FOOTING WEENING, REFER TO 1903/SJ/002
  - 7. REINFORCED CONCRETE AND BUTT JOINTS TO BE CONSTRUCTED TO 1903/SJ/002
  - 8. INTERLOCKING BLOCK PAVING L400/150/50/20/6 PAVING CONSTRUCTION TO DRAWING 1903/SJ/008
  - 9. ASPHALT WITH DARK GREY AGGREGATE, REFER TO 1903/SJ/001
  - 10. MARKET PENETRABLE BLOCK PAVING, AS PEDESTRIAN CROSSING CONSTRUCTION ON DRAWING 1903/SJ/008
  - 11. PEDESTRIAN CROSSING CONSTRUCTION, REFER TO DRAWING 1903/SJ/008
  - 12. TACTILE PAVING, REFER TO DRAWING 1903/SJ/013
  - 13. GRASSED AREA, REFER TO LANDSCAPING DESIGN DETAILS
  - 14. KERB/CURB, REFER TO DRAWING 1903/SJ/001
  - 15. HALF BATTERED KERB (DRAWING 1903/SJ/010)
  - 16. KERB DRAIN (DRAWING 1903/SJ/009)
  - 17. CONSERVATION KERB (DRAWING 1903/SJ/011)
  - 18. CONSERVATION CHANNEL (DRAWING 1903/SJ/011)
  - 19. CONSERVATION KERB AND CHANNEL (DRAWING 1903/SJ/011)
  - 20. CONSERVATION KERB FLAT TOP EDGING (DRAWING 1903/SJ/014)
  - 21. FOOTWAY EDGING (DRAWING 1903/SJ/001 AND SJ/001)
  - 22. PEDESTRIAN STOPPED CROSSING (DRAWING 1903/SJ/008)
  - 23. PEDESTRIAN STOPPED CROSSING ON SITE (DRAWING 1903/SJ/014)

SECTION

NO.	DATE	BY	DESCRIPTION
1	19/07/10	SM	ISSUE FOR PERMIT
2	19/07/10	SM	ISSUE FOR PERMIT
3	19/07/10	SM	ISSUE FOR PERMIT
4	19/07/10	SM	ISSUE FOR PERMIT
5	19/07/10	SM	ISSUE FOR PERMIT
6	19/07/10	SM	ISSUE FOR PERMIT
7	19/07/10	SM	ISSUE FOR PERMIT
8	19/07/10	SM	ISSUE FOR PERMIT
9	19/07/10	SM	ISSUE FOR PERMIT
10	19/07/10	SM	ISSUE FOR PERMIT
11	19/07/10	SM	ISSUE FOR PERMIT
12	19/07/10	SM	ISSUE FOR PERMIT
13	19/07/10	SM	ISSUE FOR PERMIT
14	19/07/10	SM	ISSUE FOR PERMIT
15	19/07/10	SM	ISSUE FOR PERMIT
16	19/07/10	SM	ISSUE FOR PERMIT
17	19/07/10	SM	ISSUE FOR PERMIT
18	19/07/10	SM	ISSUE FOR PERMIT
19	19/07/10	SM	ISSUE FOR PERMIT
20	19/07/10	SM	ISSUE FOR PERMIT
21	19/07/10	SM	ISSUE FOR PERMIT
22	19/07/10	SM	ISSUE FOR PERMIT
23	19/07/10	SM	ISSUE FOR PERMIT
24	19/07/10	SM	ISSUE FOR PERMIT
25	19/07/10	SM	ISSUE FOR PERMIT
26	19/07/10	SM	ISSUE FOR PERMIT
27	19/07/10	SM	ISSUE FOR PERMIT
28	19/07/10	SM	ISSUE FOR PERMIT
29	19/07/10	SM	ISSUE FOR PERMIT
30	19/07/10	SM	ISSUE FOR PERMIT
31	19/07/10	SM	ISSUE FOR PERMIT
32	19/07/10	SM	ISSUE FOR PERMIT
33	19/07/10	SM	ISSUE FOR PERMIT
34	19/07/10	SM	ISSUE FOR PERMIT
35	19/07/10	SM	ISSUE FOR PERMIT
36	19/07/10	SM	ISSUE FOR PERMIT
37	19/07/10	SM	ISSUE FOR PERMIT
38	19/07/10	SM	ISSUE FOR PERMIT
39	19/07/10	SM	ISSUE FOR PERMIT
40	19/07/10	SM	ISSUE FOR PERMIT
41	19/07/10	SM	ISSUE FOR PERMIT
42	19/07/10	SM	ISSUE FOR PERMIT
43	19/07/10	SM	ISSUE FOR PERMIT
44	19/07/10	SM	ISSUE FOR PERMIT
45	19/07/10	SM	ISSUE FOR PERMIT
46	19/07/10	SM	ISSUE FOR PERMIT
47	19/07/10	SM	ISSUE FOR PERMIT
48	19/07/10	SM	ISSUE FOR PERMIT
49	19/07/10	SM	ISSUE FOR PERMIT
50	19/07/10	SM	ISSUE FOR PERMIT

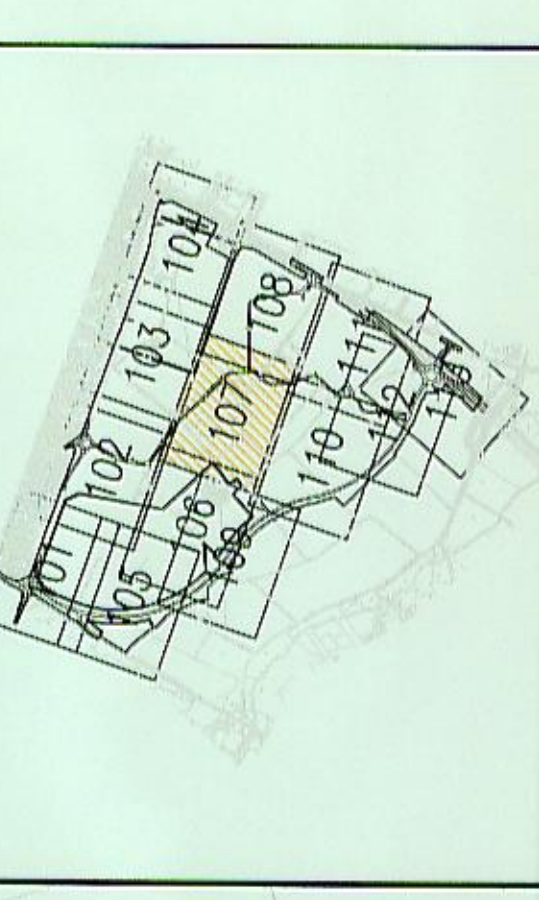

FOR TECHNICAL APPROVAL

NO.	DATE	BY	DESCRIPTION
1	19/07/10	SM	ISSUE FOR PERMIT
2	19/07/10	SM	ISSUE FOR PERMIT
3	19/07/10	SM	ISSUE FOR PERMIT
4	19/07/10	SM	ISSUE FOR PERMIT
5	19/07/10	SM	ISSUE FOR PERMIT
6	19/07/10	SM	ISSUE FOR PERMIT
7	19/07/10	SM	ISSUE FOR PERMIT
8	19/07/10	SM	ISSUE FOR PERMIT
9	19/07/10	SM	ISSUE FOR PERMIT
10	19/07/10	SM	ISSUE FOR PERMIT
11	19/07/10	SM	ISSUE FOR PERMIT
12	19/07/10	SM	ISSUE FOR PERMIT
13	19/07/10	SM	ISSUE FOR PERMIT
14	19/07/10	SM	ISSUE FOR PERMIT
15	19/07/10	SM	ISSUE FOR PERMIT
16	19/07/10	SM	ISSUE FOR PERMIT
17	19/07/10	SM	ISSUE FOR PERMIT
18	19/07/10	SM	ISSUE FOR PERMIT
19	19/07/10	SM	ISSUE FOR PERMIT
20	19/07/10	SM	ISSUE FOR PERMIT
21	19/07/10	SM	ISSUE FOR PERMIT
22	19/07/10	SM	ISSUE FOR PERMIT
23	19/07/10	SM	ISSUE FOR PERMIT
24	19/07/10	SM	ISSUE FOR PERMIT
25	19/07/10	SM	ISSUE FOR PERMIT
26	19/07/10	SM	ISSUE FOR PERMIT
27	19/07/10	SM	ISSUE FOR PERMIT
28	19/07/10	SM	ISSUE FOR PERMIT
29	19/07/10	SM	ISSUE FOR PERMIT
30	19/07/10	SM	ISSUE FOR PERMIT
31	19/07/10	SM	ISSUE FOR PERMIT
32	19/07/10	SM	ISSUE FOR PERMIT
33	19/07/10	SM	ISSUE FOR PERMIT
34	19/07/10	SM	ISSUE FOR PERMIT
35	19/07/10	SM	ISSUE FOR PERMIT
36	19/07/10	SM	ISSUE FOR PERMIT
37	19/07/10	SM	ISSUE FOR PERMIT
38	19/07/10	SM	ISSUE FOR PERMIT
39	19/07/10	SM	ISSUE FOR PERMIT
40	19/07/10	SM	ISSUE FOR PERMIT
41	19/07/10	SM	ISSUE FOR PERMIT
42	19/07/10	SM	ISSUE FOR PERMIT
43	19/07/10	SM	ISSUE FOR PERMIT
44	19/07/10	SM	ISSUE FOR PERMIT
45	19/07/10	SM	ISSUE FOR PERMIT
46	19/07/10	SM	ISSUE FOR PERMIT
47	19/07/10	SM	ISSUE FOR PERMIT
48	19/07/10	SM	ISSUE FOR PERMIT
49	19/07/10	SM	ISSUE FOR PERMIT
50	19/07/10	SM	ISSUE FOR PERMIT

**WSP**  
 WSP Group plc  
 Moorfield House, Billing View, Billingstone, Herefordshire HR23 4HU  
 Tel: +44 (0)1298 318000 Fax: +44 (0)1298 318700  
 http://www.wspgroup.com

COUNTRYSIDE PROPERTIES

SOUTH WEST BICESTER  
 BICESTER, OXFORDSHIRE

FINISHES RESIDUAL HAZARDS  
 AND EARTHWORKS

PROJECT NO: 11011903  
 DRAWING NO: 1903RPP047  
 DATE: JUN 2008  
 SCALE: 1:500  
 SHEET NO: 1 OF 1  
 PROJECT: 1903RPP047  
 DRAWING: 11011903  
 H

© WSP Group plc



CHEWEL DISTRICT COUNCIL  
 Plan No. 09/001/14/047  
 Approved: [Signature]  
 24.2.10  
 23.2.10

FOR CONTINUATION REFER TO  
 1903/SJ/001

INTRODUCED FROM THE OFFICE  
 OF THE COMMISSIONER OF  
 THE ENVIRONMENT BY THE  
 ACTING CHIEF OFFICER  
 OF THE ENVIRONMENT  
 OFFICE OF THE COMMISSIONER  
 OF THE ENVIRONMENT