

DO NOT SCALE

- NOTES:**
- THIS DRAWING SHOULD BE READ IN CONJUNCTION WITH ALL OTHER RELEVANT ENGINEERING DETAILS, DRAWINGS & SPECIFICATIONS.
 - ALL DIMENSIONS ARE IN METRES UNLESS OTHERWISE STATED. SIMILARLY ALL LEVELS ABOVE D.A.M ARE ALSO IN METRES.
 - PRIOR TO THE COMMENCEMENT OF CONSTRUCTION WORKS, THE CONTRACTOR SHALL BE RESPONSIBLE FOR CHECKING AND CONFIRMING ALL DIMENSIONS ARE TO BE CHECKED AND CONFIRMED ON SITE.
 - ANY DISCREPANCIES SHOULD BE REPORTED TO THE ARCHITECT/ENGINEER IMMEDIATELY SO THAT CLARIFICATION CAN BE SOUGHT PRIOR TO THE COMMENCEMENT OF WORK.
 - PRIOR TO CONSTRUCTION WORKS COMMENCING ON SITE, THE LOCATION OF ALL EXISTING SERVICES ARE TO BE CHECKED AND THEIR LOCATION CONFIRMED.
 - THE LOCATION OF ANY SERVICES SHOWN ON THIS DRAWING IS FOR INFORMATION ONLY. THE CONTRACTOR SHALL BE RESPONSIBLE FOR VERIFYING THE LOCATION AND DEPTH OF ALL SERVICES WHICH WILL AFFECT THE WORKS PRIOR TO COMMENCING ANY CONSTRUCTION.
 - ANY RELOCATION/REPAIRS WORKS ASSIGNED ARE TO BE IN ACCORDANCE WITH THE RELEVANT STATUTORY REQUIREMENTS AND RECOMMENDATIONS.
 - ALL HIGHWAY DRAINAGE TO BE ADOPTED BY OCC WHO REQUIRE THAT ALL WORKS BE CONSTRUCTED TO OCC STANDARDS.
 - ALL SERVICES TO BE LAID TO CLASS 3 BEDDING CLASSIFICATION UNLESS SPECIFIED OTHERWISE.
 - FOUL WATER SERVICES TO BE ADOPTED BY THAMES WATER UTILITIES UNDER SECTION 104 OF THE WATER INDUSTRY ACT.

- KEY:**
- SITE BOUNDARY
 - DAILY POT AND CONNECTION
 - HIGHWAY DRAINAGE CONNECTIONS
 - HIGHWAY DRAINAGE
 - HIGHWAY DRAINAGE MANHOLE
 - FOUL WATER MANHOLE
 - FOUL WATER MANHOLE
 - EXISTING SURFACE WATER SENSER
 - FILTER DRAIN AS DRAWING NO. 1903/09/116
 - SN DITCH AND FILTER DRAIN AS Dwg. NO 1903/09/028 AND 039
 - SN DITCH AS Dwg. NO 1903/09/028
 - PARCEL BOUNDARIES
 - SURFACE DRAINAGE STUB
 - FOUL DRAINAGE STUB
 - WER WALL AND OFFICE CONTROL STRUCTURE
 - RENOWNAL TYPE 2, AS DRAWING 1903/09/116
 - SINGLE PIPE CONCRETE BACKWATER RENOWNAL, AS DRAWING 1903/09/116
 - RENOWNAL TYPE 2, AS DRAWING 1903/09/116
 - TRIAL PIT LOCATIONS (REF. FRESHMAN 2001)
 - TRIAL PIT LOCATIONS (REF. FRESHMAN 2004)
 - BT DUCT AND CHAMBER
 - KEEP BED (AS DRAWING 1903/09/110)
 - EXISTING WATER COURSE TO BE FILLED IN
 - EXISTING DITCH TO BE REGRABBED
 - INDICATES A RESIDUAL RISK AS A WARNING.

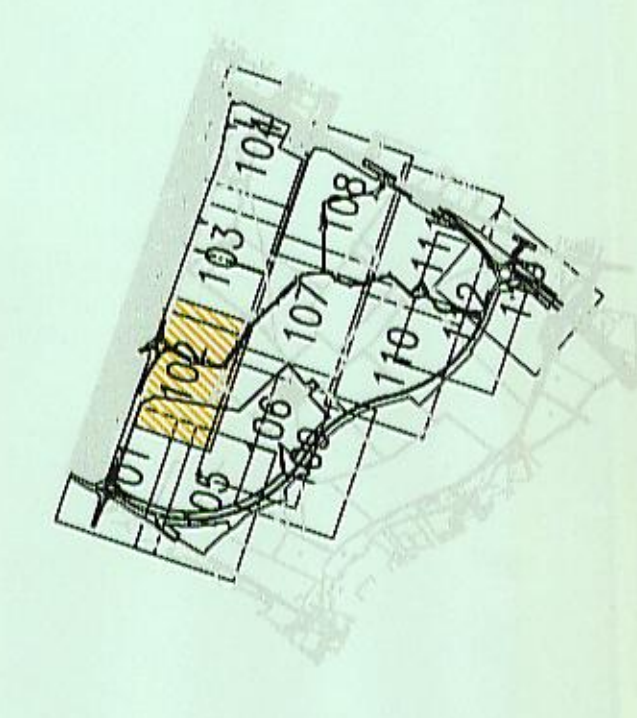

REV. ELEM.

NO.	DATE	BY	DESCRIPTION	CHK.	APP.
1	19/03/20	JM	ISSUED FOR PERMIT	JM	JM
2	19/03/20	JM	REVISED TO ADD DRAINAGE	JM	JM
3	19/03/20	JM	REVISED TO ADD DRAINAGE	JM	JM
4	19/03/20	JM	REVISED TO ADD DRAINAGE	JM	JM
5	19/03/20	JM	REVISED TO ADD DRAINAGE	JM	JM
6	19/03/20	JM	REVISED TO ADD DRAINAGE	JM	JM
7	19/03/20	JM	REVISED TO ADD DRAINAGE	JM	JM
8	19/03/20	JM	REVISED TO ADD DRAINAGE	JM	JM
9	19/03/20	JM	REVISED TO ADD DRAINAGE	JM	JM
10	19/03/20	JM	REVISED TO ADD DRAINAGE	JM	JM
11	19/03/20	JM	REVISED TO ADD DRAINAGE	JM	JM
12	19/03/20	JM	REVISED TO ADD DRAINAGE	JM	JM
13	19/03/20	JM	REVISED TO ADD DRAINAGE	JM	JM
14	19/03/20	JM	REVISED TO ADD DRAINAGE	JM	JM
15	19/03/20	JM	REVISED TO ADD DRAINAGE	JM	JM
16	19/03/20	JM	REVISED TO ADD DRAINAGE	JM	JM
17	19/03/20	JM	REVISED TO ADD DRAINAGE	JM	JM
18	19/03/20	JM	REVISED TO ADD DRAINAGE	JM	JM
19	19/03/20	JM	REVISED TO ADD DRAINAGE	JM	JM
20	19/03/20	JM	REVISED TO ADD DRAINAGE	JM	JM

FOR TECHNICAL APPROVAL

WSP

Mountbatten House, Basing View, Basingstoke, Hampshire RG21 4HU
 Tel: +44 (0)1256 316800 Fax: +44 (0)1256 316700
<http://www.wspgroup.com>

COUNTRYSIDE PROPERTIES

SOUTH WEST BICESTER
BICESTER, OXFORDSHIRE

DRAINAGE LAYOUT

SCALE: 1:500	DATE: JAN 2020
PROJECT NO: 1903-042	CLIENT: WSP
PROJECT REF: 11011903	DATE: 19/03/2020
REV: R	

© WSP Group plc

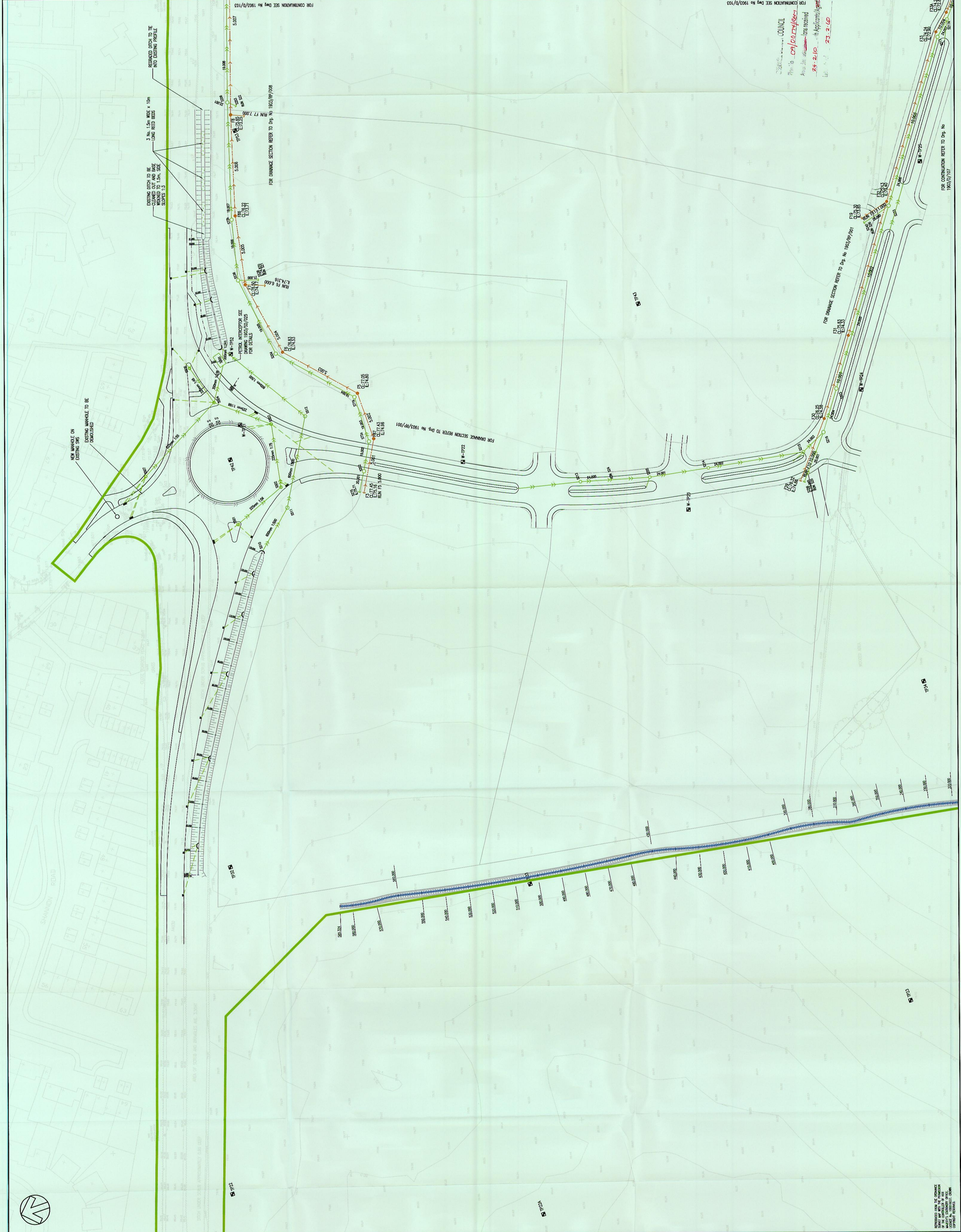

COUNTRYSIDE PROPERTIES COUNCIL
 09/03/2024
 24.2.10 - In Applications
 23.2.20