

DO NOT SCALE

- NOTES:**
- THIS DRAWING SHOULD BE READ IN CONJUNCTION WITH ALL SPECIFICATIONS, DRAWINGS, AND NOTICES.
 - ALL DIMENSIONS ARE IN METRES UNLESS OTHERWISE STATED. DIMENSIONS ABOVE DUTIM ARE ALSO IN METRES.
 - PROVIDE TO THE COMPETENT PERSON OF CONSTRUCTION WORKS, EXISTING LEVELS AND DIMENSIONS ARE TO BE CHECKED AND CONFIRMED ON SITE.
 - ANY DISCREPANCIES SHOULD BE REPORTED TO THE COMPETENT PERSON OF CONSTRUCTION WORKS IMMEDIATELY. THE COMPETENT PERSON OF CONSTRUCTION WORKS SHALL BE RESPONSIBLE FOR THE COMPLETION OF WORK.
 - REFER TO CONSTRUCTION WORKS DRAWINGS FOR THE LOCATION OF ALL EXISTING SERVICES ARE TO BE CHECKED AND THEIR LOCATION CONFIRMED.
 - THE LOCATION OF ANY SERVICES SHOWN ON THIS DRAWING ARE INDICATIVE ONLY. IT WILL BE THE RESPONSIBILITY OF THE COMPETENT PERSON OF CONSTRUCTION WORKS TO VERIFY THE LOCATION OF ALL SERVICES WHICH WILL AFFECT THE WORKS PRIOR TO COMMENCING ANY CONSTRUCTION.
 - ANY RELOCATION/REPAIRS WORKS REQUIRED ARE TO BE COMPLETED IN ADVANCE OF THE PROPOSED WORKS AND IN ACCORDANCE WITH THE RELEVANT STATUTORY REQUIREMENTS.
 - REFER TO FINISHED DIMENSIONS AND SIGN AND LINE DIMENSIONS.
 - FOR CROSSFALLS SEE CROSS SECTION DRAWINGS 1903/09/014.
 - STEEL FIELD GATES TO BE IN ACCORDANCE WITH MANUAL OF CONTRACT DOCUMENTS FOR HIGHWAY WORKS, HIGHWAY CONSTRUCTION DETAIL H17 (STEEL SINGLE FIELD GATE)

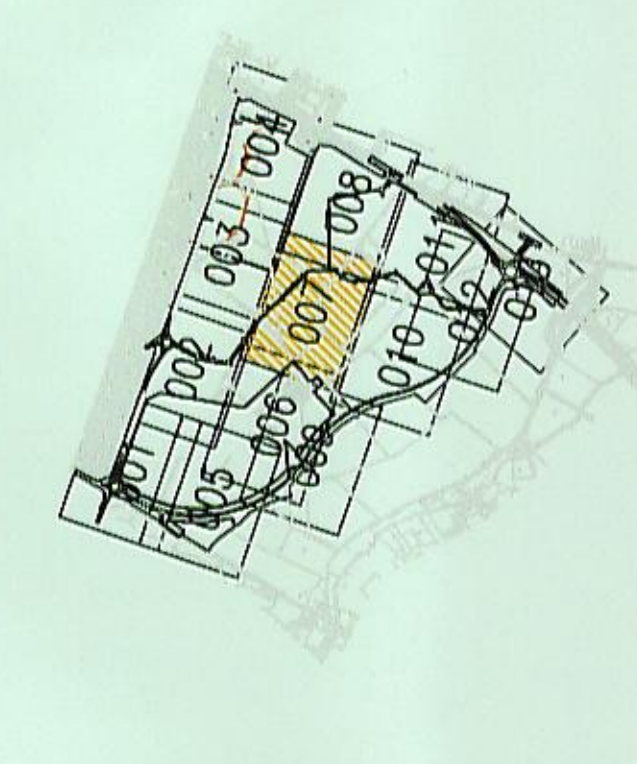
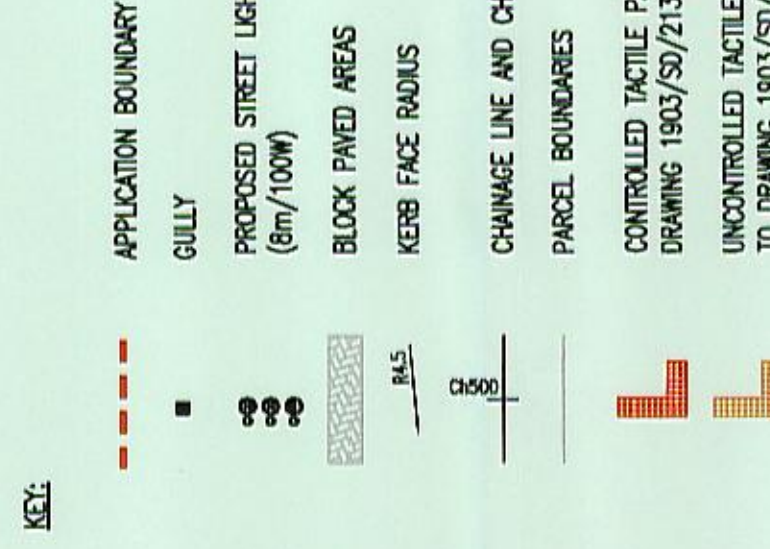

NO.	DATE	DESCRIPTION	BY	CHECKED
1	19/03/09	ISSUED FOR TENDER
2	24/03/09	REVISED FOR PHASE 1
3	24/03/09	REVISED FOR PHASE 2
4	24/03/09	REVISED FOR PHASE 3
5	24/03/09	REVISED FOR PHASE 4
6	24/03/09	REVISED FOR PHASE 5
7	24/03/09	REVISED FOR PHASE 6
8	24/03/09	REVISED FOR PHASE 7
9	24/03/09	REVISED FOR PHASE 8
10	24/03/09	REVISED FOR PHASE 9
11	24/03/09	REVISED FOR PHASE 10
12	24/03/09	REVISED FOR PHASE 11
13	24/03/09	REVISED FOR PHASE 12
14	24/03/09	REVISED FOR PHASE 13
15	24/03/09	REVISED FOR PHASE 14
16	24/03/09	REVISED FOR PHASE 15
17	24/03/09	REVISED FOR PHASE 16
18	24/03/09	REVISED FOR PHASE 17
19	24/03/09	REVISED FOR PHASE 18
20	24/03/09	REVISED FOR PHASE 19
21	24/03/09	REVISED FOR PHASE 20
22	24/03/09	REVISED FOR PHASE 21
23	24/03/09	REVISED FOR PHASE 22
24	24/03/09	REVISED FOR PHASE 23
25	24/03/09	REVISED FOR PHASE 24
26	24/03/09	REVISED FOR PHASE 25
27	24/03/09	REVISED FOR PHASE 26
28	24/03/09	REVISED FOR PHASE 27
29	24/03/09	REVISED FOR PHASE 28
30	24/03/09	REVISED FOR PHASE 29
31	24/03/09	REVISED FOR PHASE 30
32	24/03/09	REVISED FOR PHASE 31
33	24/03/09	REVISED FOR PHASE 32
34	24/03/09	REVISED FOR PHASE 33
35	24/03/09	REVISED FOR PHASE 34
36	24/03/09	REVISED FOR PHASE 35
37	24/03/09	REVISED FOR PHASE 36
38	24/03/09	REVISED FOR PHASE 37
39	24/03/09	REVISED FOR PHASE 38
40	24/03/09	REVISED FOR PHASE 39
41	24/03/09	REVISED FOR PHASE 40
42	24/03/09	REVISED FOR PHASE 41
43	24/03/09	REVISED FOR PHASE 42
44	24/03/09	REVISED FOR PHASE 43
45	24/03/09	REVISED FOR PHASE 44
46	24/03/09	REVISED FOR PHASE 45
47	24/03/09	REVISED FOR PHASE 46
48	24/03/09	REVISED FOR PHASE 47
49	24/03/09	REVISED FOR PHASE 48
50	24/03/09	REVISED FOR PHASE 49
51	24/03/09	REVISED FOR PHASE 50
52	24/03/09	REVISED FOR PHASE 51
53	24/03/09	REVISED FOR PHASE 52
54	24/03/09	REVISED FOR PHASE 53
55	24/03/09	REVISED FOR PHASE 54
56	24/03/09	REVISED FOR PHASE 55
57	24/03/09	REVISED FOR PHASE 56
58	24/03/09	REVISED FOR PHASE 57
59	24/03/09	REVISED FOR PHASE 58
60	24/03/09	REVISED FOR PHASE 59
61	24/03/09	REVISED FOR PHASE 60
62	24/03/09	REVISED FOR PHASE 61
63	24/03/09	REVISED FOR PHASE 62
64	24/03/09	REVISED FOR PHASE 63
65	24/03/09	REVISED FOR PHASE 64
66	24/03/09	REVISED FOR PHASE 65
67	24/03/09	REVISED FOR PHASE 66
68	24/03/09	REVISED FOR PHASE 67
69	24/03/09	REVISED FOR PHASE 68
70	24/03/09	REVISED FOR PHASE 69
71	24/03/09	REVISED FOR PHASE 70
72	24/03/09	REVISED FOR PHASE 71
73	24/03/09	REVISED FOR PHASE 72
74	24/03/09	REVISED FOR PHASE 73
75	24/03/09	REVISED FOR PHASE 74
76	24/03/09	REVISED FOR PHASE 75
77	24/03/09	REVISED FOR PHASE 76
78	24/03/09	REVISED FOR PHASE 77
79	24/03/09	REVISED FOR PHASE 78
80	24/03/09	REVISED FOR PHASE 79
81	24/03/09	REVISED FOR PHASE 80
82	24/03/09	REVISED FOR PHASE 81
83	24/03/09	REVISED FOR PHASE 82
84	24/03/09	REVISED FOR PHASE 83
85	24/03/09	REVISED FOR PHASE 84
86	24/03/09	REVISED FOR PHASE 85
87	24/03/09	REVISED FOR PHASE 86
88	24/03/09	REVISED FOR PHASE 87
89	24/03/09	REVISED FOR PHASE 88
90	24/03/09	REVISED FOR PHASE 89
91	24/03/09	REVISED FOR PHASE 90
92	24/03/09	REVISED FOR PHASE 91
93	24/03/09	REVISED FOR PHASE 92
94	24/03/09	REVISED FOR PHASE 93
95	24/03/09	REVISED FOR PHASE 94
96	24/03/09	REVISED FOR PHASE 95
97	24/03/09	REVISED FOR PHASE 96
98	24/03/09	REVISED FOR PHASE 97
99	24/03/09	REVISED FOR PHASE 98
100	24/03/09	REVISED FOR PHASE 99
101	24/03/09	REVISED FOR PHASE 100

FOR TECHNICAL APPROVAL

WSP

WSP Group plc
 11011903
 1903/04/027
 11/01/2007
 J

COUNTRYSIDE PROPERTIES

SOUTH WEST BICESTER BICESTER, OXFORDSHIRE

GENERAL ARRANGMENT SITE LAYOUT

11011903
 1903/04/027
 11/01/2007
 J

FOR CONTINUATION REFER TO Dwg No. 1903/04/022

FOR CONTINUATION REFER TO Dwg No. 1903/04/022

FOR CONTINUATION REFER TO Dwg No. 1903/04/022

FOR CONTINUATION REFER TO Dwg No. 1903/04/022