

SHEET ONE

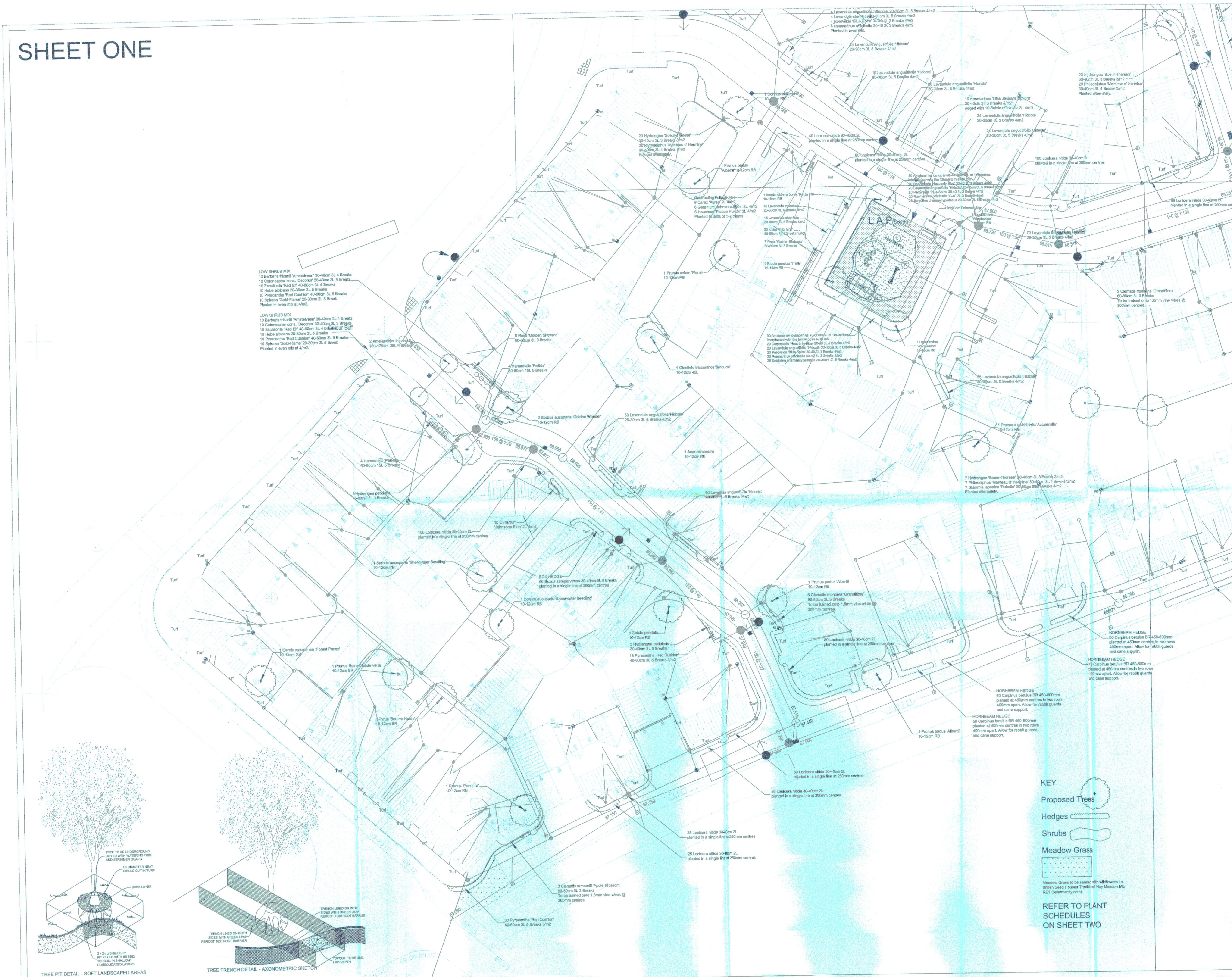

LOW SHRUB MIX
 10 Berberis 'Elegantissima' 30-40cm SL 4 Breaks
 10 Cotoneaster cuneatus 'Decorum' 30-40cm SL 3 Breaks
 10 Escallonia 'Red Elf' 40-50cm SL 4 Breaks
 10 Hebe albertiana 20-30cm SL 5 Breaks
 10 Pycnanthemum 'Red Cushion' 40-50cm SL 5 Breaks
 10 Solanum 'Gold Flame' 20-30cm SL 5 Breaks
 Planted in even mix at 4m².

LOW SHRUB MIX
 10 Berberis 'Elegantissima' 30-40cm SL 4 Breaks
 10 Cotoneaster cuneatus 'Decorum' 30-40cm SL 3 Breaks
 10 Escallonia 'Red Elf' 40-50cm SL 4 Breaks
 10 Hebe albertiana 20-30cm SL 5 Breaks
 10 Pycnanthemum 'Red Cushion' 40-50cm SL 5 Breaks
 10 Solanum 'Gold Flame' 20-30cm SL 5 Breaks
 Planted in even mix at 4m².

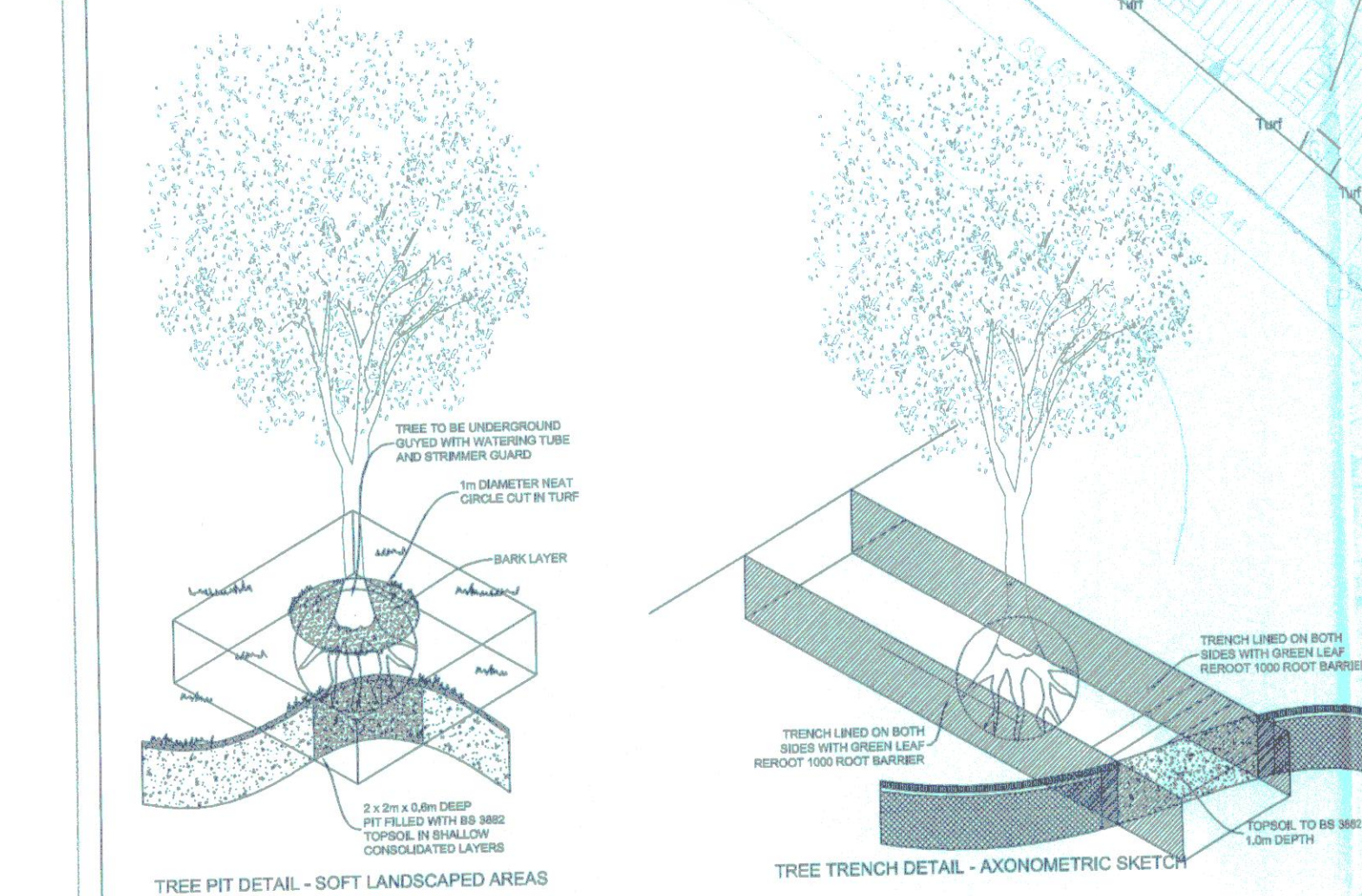

SPECIFICATION
 Plant Material and Workmanship to be in accordance with MCA Landscape Specification and the following British Standards:
 a) All trees, shrubs and hedge plants supplied shall comply with the requirements of British Standard 3938: Specification for Nursery Stock.
 b) All pre-ordered site preparation, planting and post-planting maintenance works shall be carried out in accordance with the requirements of British Standard 4428:1989 Code of Practice for General Landscaping Operations (including hard surfacing).
 c) The use of chemical herbicides, insecticides, fungicides and slug pellets etc. is discouraged and all substances used shall be biodegradable and non-residual.
 d) Chemical fertilisers are discouraged and well-rotted manure will be used instead.
 e) Soil conditioners, mulches etc. shall be peat free.

REVISIONS
 REV A 18-01-13
 Mobile Cooper Site Layout Plan AR 58234-101 Revision F incorporated and minor amendments made to planting to suit.
 REV B 28-05-13
 Mobile Cooper Site Layout Plan AR 58234-101 Revision L incorporated and amendments made to planting to suit.
 REV C 08-09-13
 Drainage layout incorporated and planting adjusted to suit.
 Tree pit details added.
 Rev D 30-09-13
 Three around underground water storage tanks moved to edges of spaces.
 Rev E 08-10-13
 LAP furniture and equipment included.
 Amendments required by Linda Brindley/CCDC 07-10-13 and actions:
 1) Native hedge along the eastern school boundary replaced with turf to avoid excessive maintenance requirements.
 2) Habitat Link
 Meadow grass shown.
 Species mix of ornamentals altered to include Hawthorn, Blackthorn and Holly, Quince-Rose and Dogwood deleted. Hawthorn (HIGH WATER DEMAND).
 Oak too large for the area (BHC Guidelines) but has been indicated where recommended.
 Field Maps added where recommended.
 Trees rearranged to create more consistent habitat link.
 Post and Wire Fencing added.
 3) Fowey Lane boundary hedge deleted as recommended.
 4) Native Box hedges changed to non-native Lonicera nitida.
 5) Vehicle access to Fowey Lane will be prevented.
 6) LAP trees altered as specified.
 7) Trees adjacent plot 9 and 20 altered as recommended.
 8) Prunus across site are pleasant wildlife friendly trees and have not been retained.
 9) Felling full but not a nuisance and Malva have been retained.
 10) Field Maps in much too large to space next to plot 30 and Prunus has been retained.
 11) Tree specifications will be detailed in the landscape specification.

Rev F: 25-11-13 MC
 Tim Soren's comments (04/11/13) and MCA actions:
 LAP opposite plots 63 & 64
 Available space maintained by deletion of planted bed including Rose gravelled area which can cause skin issues.
 Oak tree in the focus of this village green and its removal from the scheme is resisted as this is one of the very few positions that an English oak tree of scale can be accommodated.
 LAP is a single grass area as agreed previously.
LANDSCAPING
 South-eastern school boundary hedged with Hornbeam and a grass margin.
 Planting adjacent plot 15 deleted on earlier revision.
 Tree sizes have been amended to include 4m to 20-25cm girth. Limes opposite plots 65-70, 16-18cm girth trees to streets, LAP, POS & Habitat Link.
 Tree pit details indicated.
LAPS
 Additional play equipment has been added to the northern and southern LAPS.
PLANT SCHEDULES
 The plan is annotated with full details of plant sizes, details and stock type. Full numbers schedules are on sheet ten.
 Jon Brindley's comments (30/11/13) and MCA actions:
 Tree species comprehensively altered in accordance with Mr Brindley's recommendations.
 Habitat Corridors - All amended in full accordance with Mr Brindley's recommendations.
 Rev G: 12-05-14 MC
 Current engineering layout inserted and landscape scheme adjusted to suit.
 North and South LAPS updated to LPA requirements.

CHERWELL DISTRICT COUNCIL
 Plan No MCA1412-01 G
 Amended/additional plans received
 19-5-14 with Applicants/Agents
 Letter dated 19-5-14

MCA
 Chartered Landscape Architects

138 The Moors Kidlington Oxford OX5 2AG
 Tel: (01993) 811888 Fax: (01993) 811508

PROJECT
BELLWAY HOMES
 KINGSMERE KM7 - KM9
 BICESTER, OXFORDSHIRE

DRAWING TITLE
LANDSCAPE DETAILS
SHEET ONE OF FOUR

Scale	Date	Drawn
1:250	09-12-12	MC
Drawing No.	MCA1412-01 G	

DO NOT SCALE
 COPYRIGHT RESERVED

KEY
 Proposed Trees
 Hedges
 Shrubs
 Meadow Grass
 REFER TO PLANT SCHEDULES ON SHEET TWO