

EXISTING PLAN

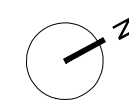

Note:
shopfront glazing system to be designed & located to accommodate use of, & access to, the existing roller shutters, controls & o/h gear etc.

shopfronts to be double glazed painted hardwood

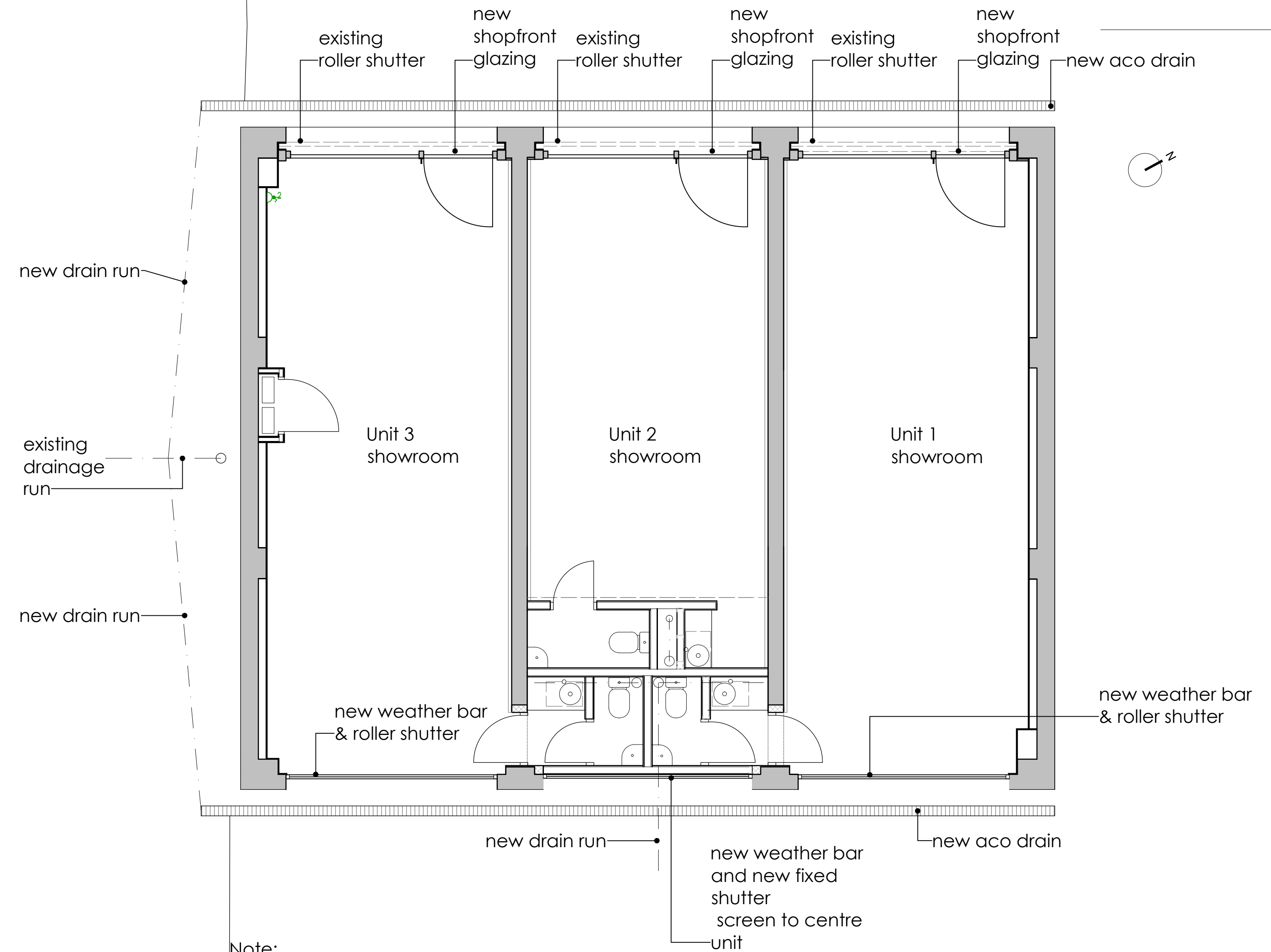

Note:
Henderson Automatic insulated aluminium roller shutters
Colour of roller shutters to match front shutters

PROPOSED PLAN

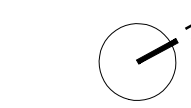

This drawing is copyright. All rights described in Chapter IV of the Copyright, Designs and Patents Act 1988 have generally been copied. All drawings are the property of GFA. No part of this drawing may be reproduced without the prior written permission of GFA.

Client
Bicester Heritage

Project
Bicester Heritage

Building 94

Title
Building 94
Planning
Existing and Proposed Plan

Drawing No	Rev	Drawn	Date	Scale
12068 /94 PL800	*	SC	12/02/2015	1:50 @A1