

SECTION.
SCALE 1:10

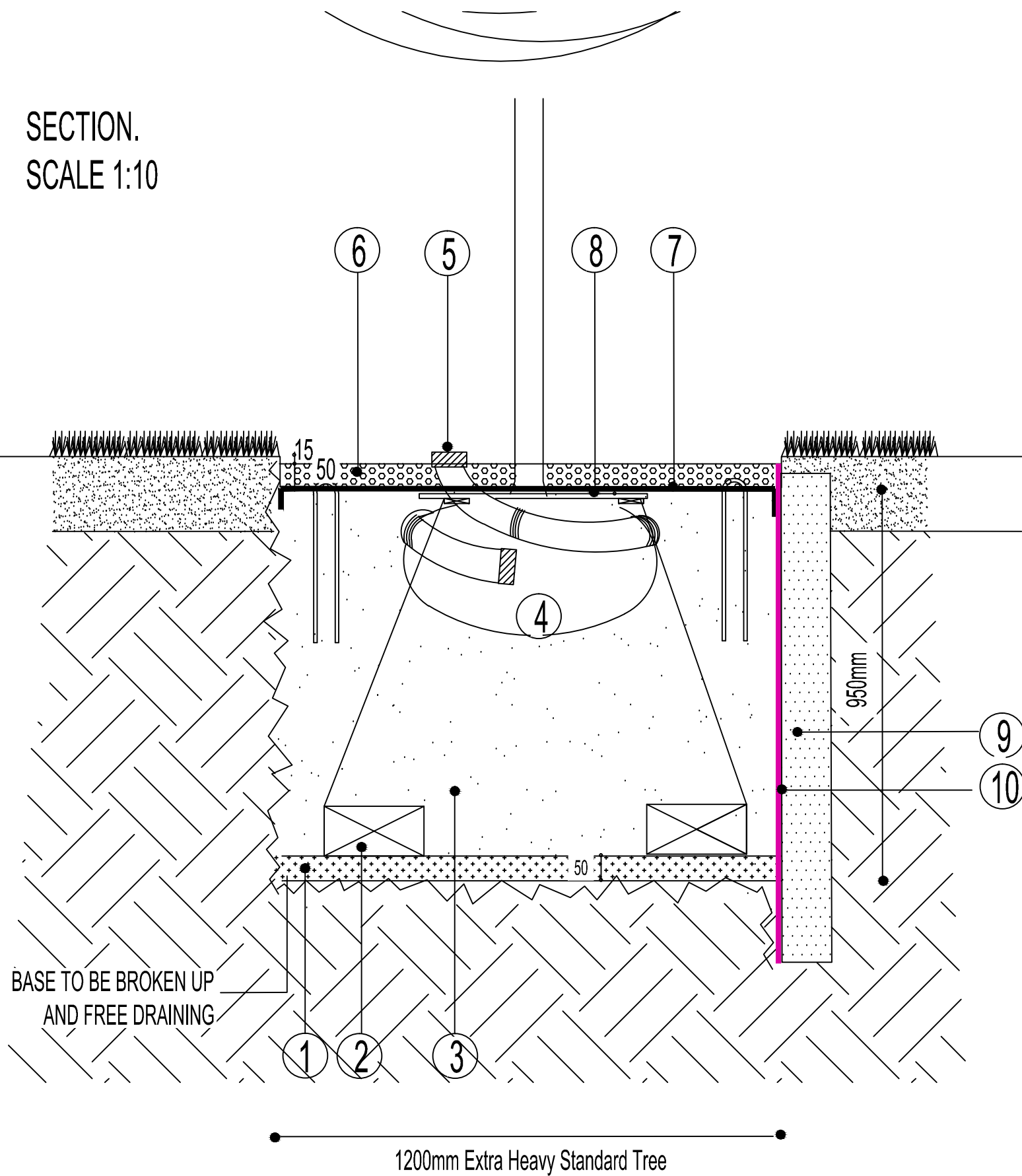

NOTES:-

- ① DRAINAGE LAYER, 50mm DEPTH, OF GRADED WASHED SHINGLE (20mm GAUGE).
- ② DEAD MEN TO BE 2No. CONCRETE KERB SECTIONS OR SIMILAR.
- ③ TREE PIT: 1200 x 1200 x 950mm FOR A EXTRA HEAVY STANDARD TREE
TREE PIT TO BE FILLED WITH "AMSTERDAM TREE SOIL" SUPPLIED BY URBAN SOILS TEL: (01925) 757800.
TREE SOIL TO BE BACKFILLED IN 300mm LAYERS, COMPACTED TO 1.5-2.0 MEGA PASCELS. ADDED 30L OF
NON-PEAT BASED COMPOST. INCORPORATED FERTILIZER TO BE HORTIBASE CFR 16-8-12 SLOW
RELEASE FROM HORTIFEEDS TEL. (01530) 510060. .ALL IN ACCORDANCE WITH SUPPLIERS
INSTRUCTIONS.
- ④ PROPOSED TREE (REFER TO PLANT SCHEDULES ON MAIN DRAWINGS FOR SPECIES AND SIZE).
- ⑤ PERFORATED PVC WATERING PIPE (60mm DIAMETER) INCLUDING END CAP. TO BE WRAPPED IN
"HY-TEX" AGROTEXTILE WOVEN PLASTIC FABRIC AVAILABLE FROM HY-TEX LTD. TEL (01233) 720097
OR EQUAL AND APPROVED. TO BE COILED AROUND TOP OF ROOTBALL, WITH OPEN END AS
CLOSE AS POSSIBLE TO TRUNK.
- ⑥ EDWARDS OF BRANDON BARK MULCH (TEL. 01842 813555) TO A DEPTH OF 50mm
- ⑦ "HY-TEX COVERTEX" AVAILABLE FROM HY-TEX UK LTD (TEL.
01422-720097). 2.2m SQUARE CUT AROUND TREE STEM AND WATER PIPE. TO
BE PEGGED IN AT 300mm CENTRES WITH HYTEX METAL HOOPS, 300mm
LONG, OR WITH WOODEN PEGS DEPENDING UPON GROUND CONDITIONS
OR SIMILAR AND APPROVED.
- ⑧ ROOTBALL TO BE SECURED WITH TIMBER FRAME OF 4No. 75 x 25 x 600mm PRESSURE TREATED
BOARDS ATTACHED TO THE DEAD MEN WITH MILD STEEL WIRE (6-10mm DIAMETER). TO BE TIGHTENED
WITH TURNBUCKLES AT TOP.
- ⑨ SUB-SOIL EXCAVATED FROM THE PIT
- ⑩ ROOT PROTECTION BARRIER TO BE APPLY TO TREES IN CLOSE PROXIMITY TO UTILITIES OR
HIGHWAYS. ROOT BARRIER TO BE REROOT 2000: THICKNESS 2mm, DEPTH 1000mm, AVAILABLE
FROM GREENBLUE URBAN, HAYWOOD WAY, HASTINGS, EAST SUSSEX, TEL: 01424 717797

GENERAL NOTES:-

- ALL VEGETATIVE MATERIAL, LITTER AND OTHER DEBRIS IS TO BE REMOVED AND THE BOTTOM AND SIDES OF THE TREE PIT MUST BE FORKED OVER TO ENSURE ADEQUATE DRAINAGE BEFORE BACKFILLING WITH SOIL.
- WATER IN WITH 50 LITRES OF WATER PER TREE WITHIN FOUR HOURS OF PLANTING.
- DO NOT SCALE FROM THIS DRAWING.
- ALL DIMENSIONS ARE IN MILLIMETRES.
- ALL DIMENSIONS ARE TO BE CHECKED ON SITE.
- (C)JBA CONSULTANCY SERVICES LTD 2015

REV.	DATE	INITIALS	DETAILS

CLIENT LINDEN HOMES		DWG. TITLE TREE PIT DETAIL FOR EXTRA HEAVY STANDARD TREE IN SOFT LANDSCAPING			
PURPOSE OF ISSUE PLANNING					
SITE KINGSMERE, BICESTER					
DRG BY WD	CHECKED JBA	AUTH'D JBA	SCALE 1:10@A3	DATE MAR 2015	DWG NO. JBA 14/42-DT2
					REV.

HEAD OFFICE
The Black Barn, Hall Road, Lavenham, Suffolk, CO10 9QX
Tel: (01787) 248216 Fax: (01787) 247264
jamesblake@jba-landmarc.com
www.jba-landmarc.com



LANDSCAPE ARCHITECTURE
ARBORICULTURE o ECOLOGY