

SPECIFICATION NOTES - REFER TO THE MEASURED WORKS SCHEDULE

- A) Setting out
1. Planting shall be set out exactly as shown on the drawings...
2. All planting beds shall be a minimum of 1 metre wide...
3. Pre-planting herbicide application...

- B) Ground work
1. Soil levels: soil levels for shrub beds and grass areas should have any...
2. Top soil spread from on site should be by the contractor...
3. Existing topsoil and imported soil shall conform to BS 3882:2007...

- C) Planting
1. All planting must be carried out in accordance to the specification...
2. No substitutions will be accepted without the prior agreement...
3. Hard surfaces shall be constructed after suitable base courses have been laid...

- D) Mulch
1. All mulch shall be specified by the additional specification notes on this plan...
2. Following planting supply and spread mulch to a depth of 50mm...
3. All meshwork shall be finished to BS 2037...

- E) Handwork
1. Hard works, unless otherwise agreed shall be carried out by the developer...
2. All paths and edgings shall be set out properly to lines and rods...
3. All shrubs, hardworking plants, which are not to be planted in situ...
4. Pruned trees shall be planted in accordance to the specification...

GENERAL NOTES
ALL DIMENSIONS IN MILLIMETRES
DO NOT SCALE OFF THIS DRAWING
ICBA CONSULTANCY SERVICES LTD 2015

KEY

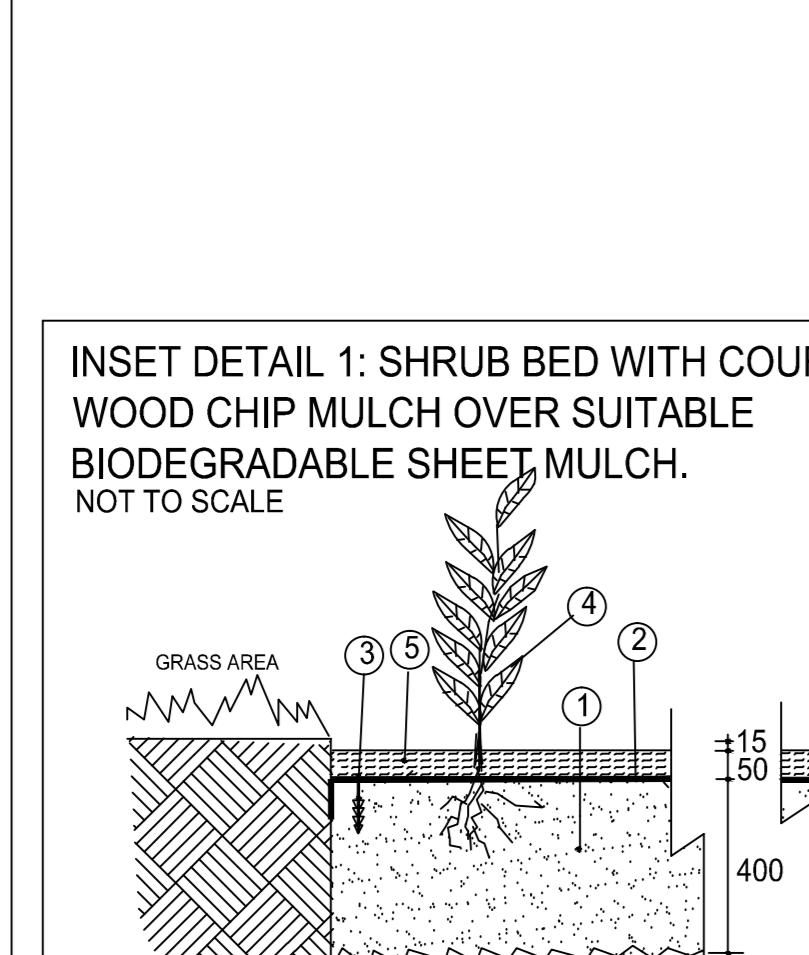
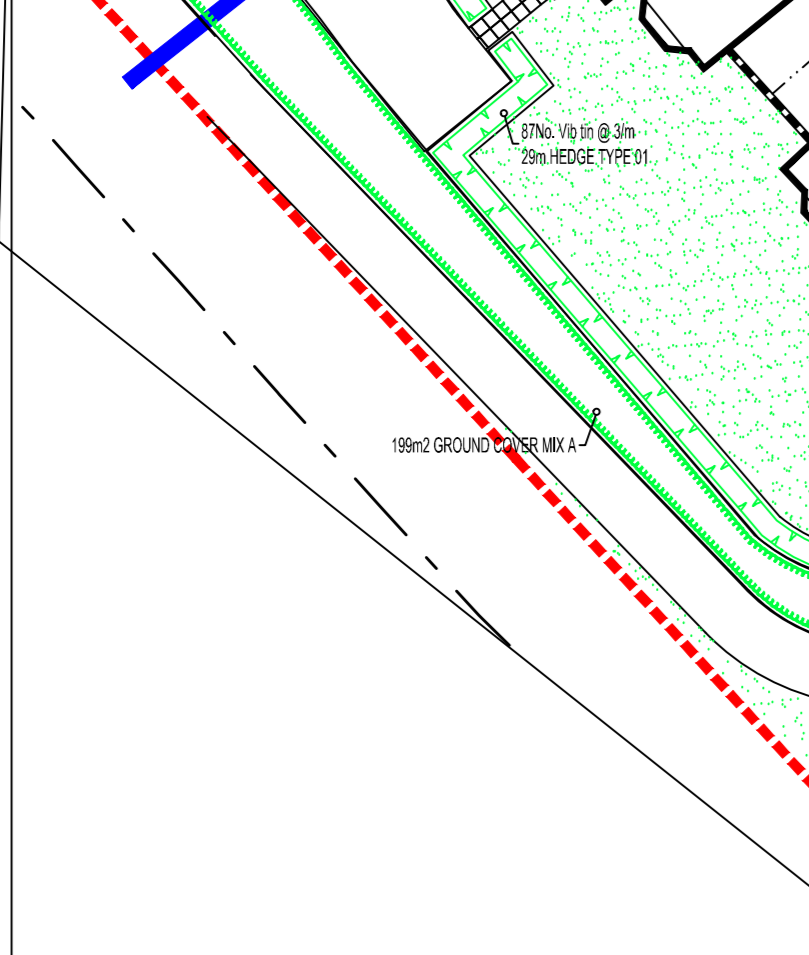
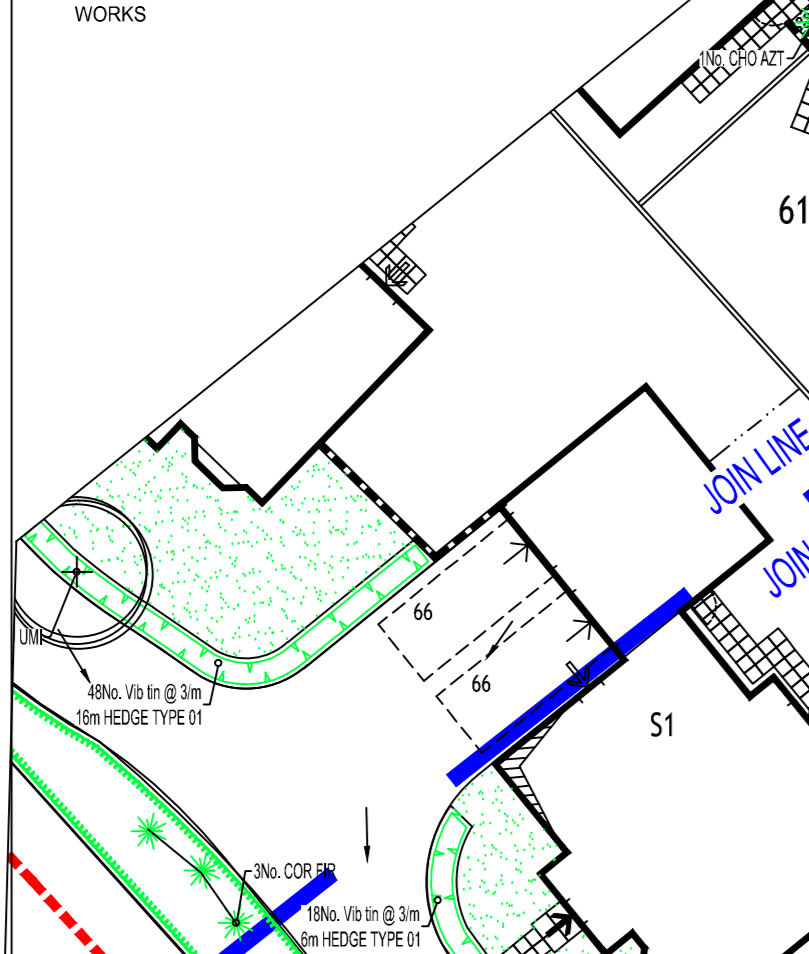
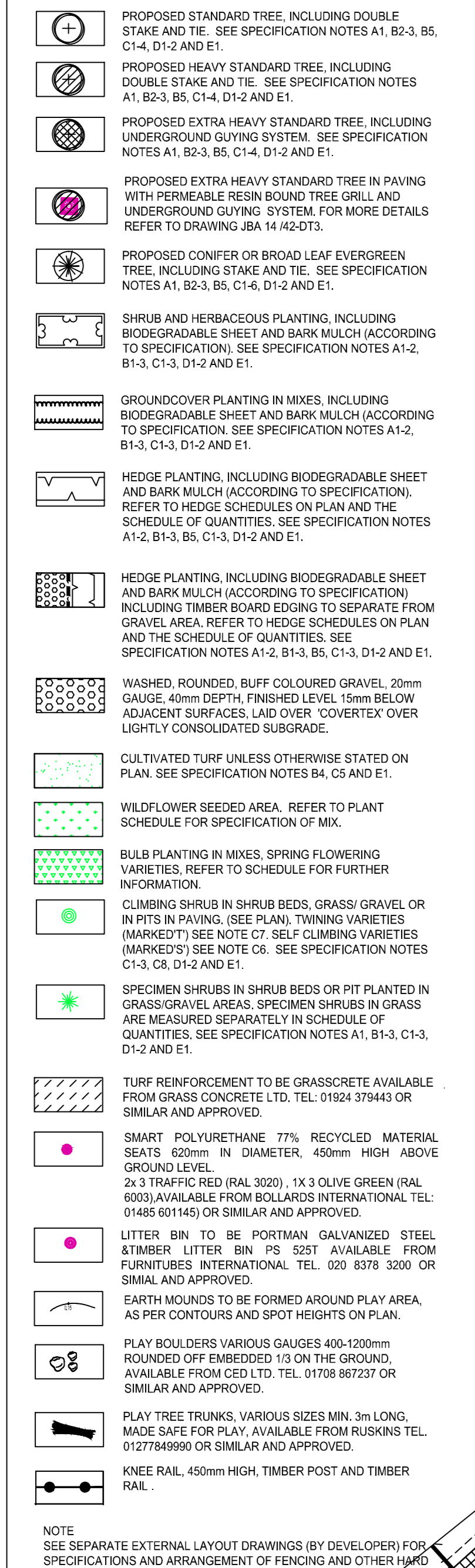

HEALTH AND SAFETY RISK ASSESSMENT

Table with 3 columns: ITEM, RISK LEVEL, HAZARD/RISK. Lists various site activities and their associated risks.

GENERAL NOTES FOR THE DEVELOPER
A) Tree protection
1. Any existing trees to be retained, are the responsibility of the main contractor...

GENERAL NOTES FOR THE DEVELOPER
B) Ground work
1. Soil levels: soil levels for shrub beds and grass areas should have any...

GENERAL NOTES FOR THE DEVELOPER
C) Planting
1. All planting must be carried out in accordance to the specification...

GENERAL NOTES FOR THE DEVELOPER
D) Mulch
1. All mulch shall be specified by the additional specification notes on this plan...

GENERAL NOTES
ALL DIMENSIONS IN MILLIMETRES
DO NOT SCALE OFF THIS DRAWING
ICBA CONSULTANCY SERVICES LTD 2015

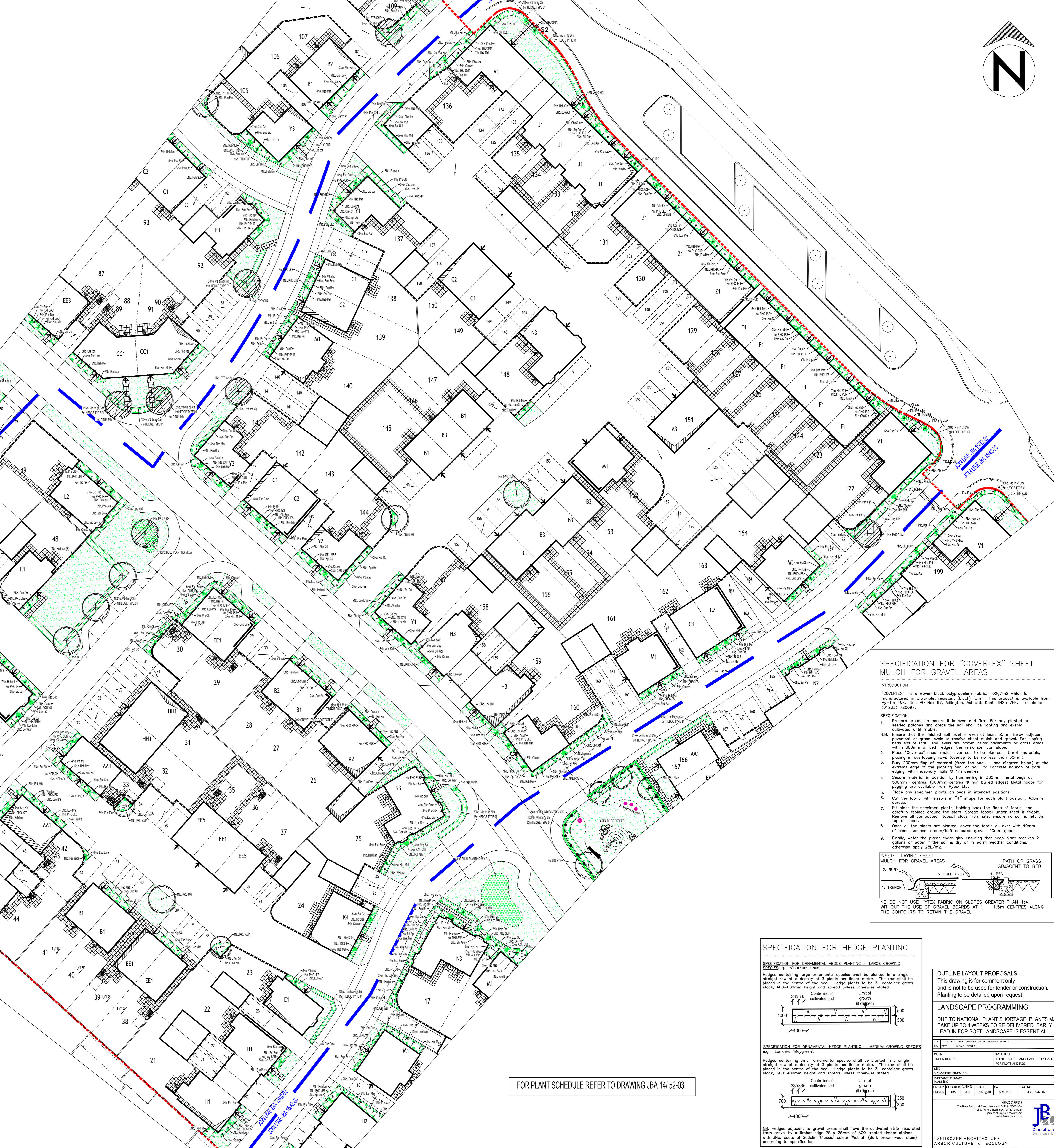

SPECIFICATION FOR "COVERTEX" SHEET MULCH FOR GRAVEL AREAS
INTRODUCTION
"COVERTEX" is a woven black polypropylene fabric, 102g/m2 which is manufactured in ultraviolet resistant (black) form...

SPECIFICATION FOR HEDGE PLANTING - LARGE GROWING SPECIES
SPECIFICATION FOR ORNAMENTAL HEDGE PLANTING - LARGE GROWING SPECIES
SPECIFICATION FOR ORNAMENTAL HEDGE PLANTING - MEDIUM GROWING SPECIES
OUTLINE LAYOUT PROPOSALS
LANDSCAPE PROGRAMMING
DUO TO NATIONAL PLANT SHORTAGE: PLANTS MAY TAKE UP TO 4 WEEKS TO BE DELIVERED. EARLY LEAD-IN FOR SOFT LANDSCAPE IS ESSENTIAL.

FOR PLANT SCHEDULE REFER TO DRAWING JBA 14/ 52-03

