

| APPROVED | | NETWORK RAIL | |
|-----------------------------|-------------------------|----------------------|-------------------------|
| SIGNED | TITLE | SIGNED | TITLE |
| | C.E.M. GIBSON (PHASE) | | DEPUTY PROJECT ENGINEER |
| NETWORK RAIL ASSET ENGINEER | | PRINCIPAL CONTRACTOR | |
| SIGNED | TITLE | SIGNED | TITLE |
| | | | C.A.E. (CVLS) |
| NETWORK RAIL CIVIL ENGINEER | | PRINCIPAL DESIGNER | |
| SIGNED | TITLE | SIGNED | TITLE |
| | SENIOR PROJECT ENGINEER | | C.A.E. (CVLS) |

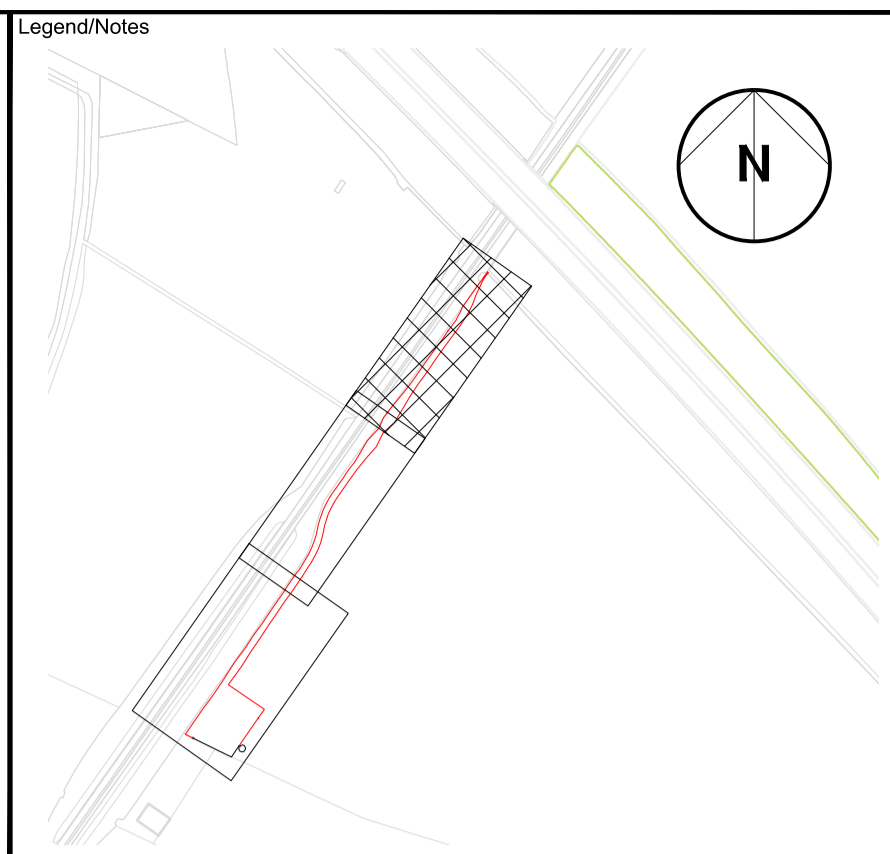
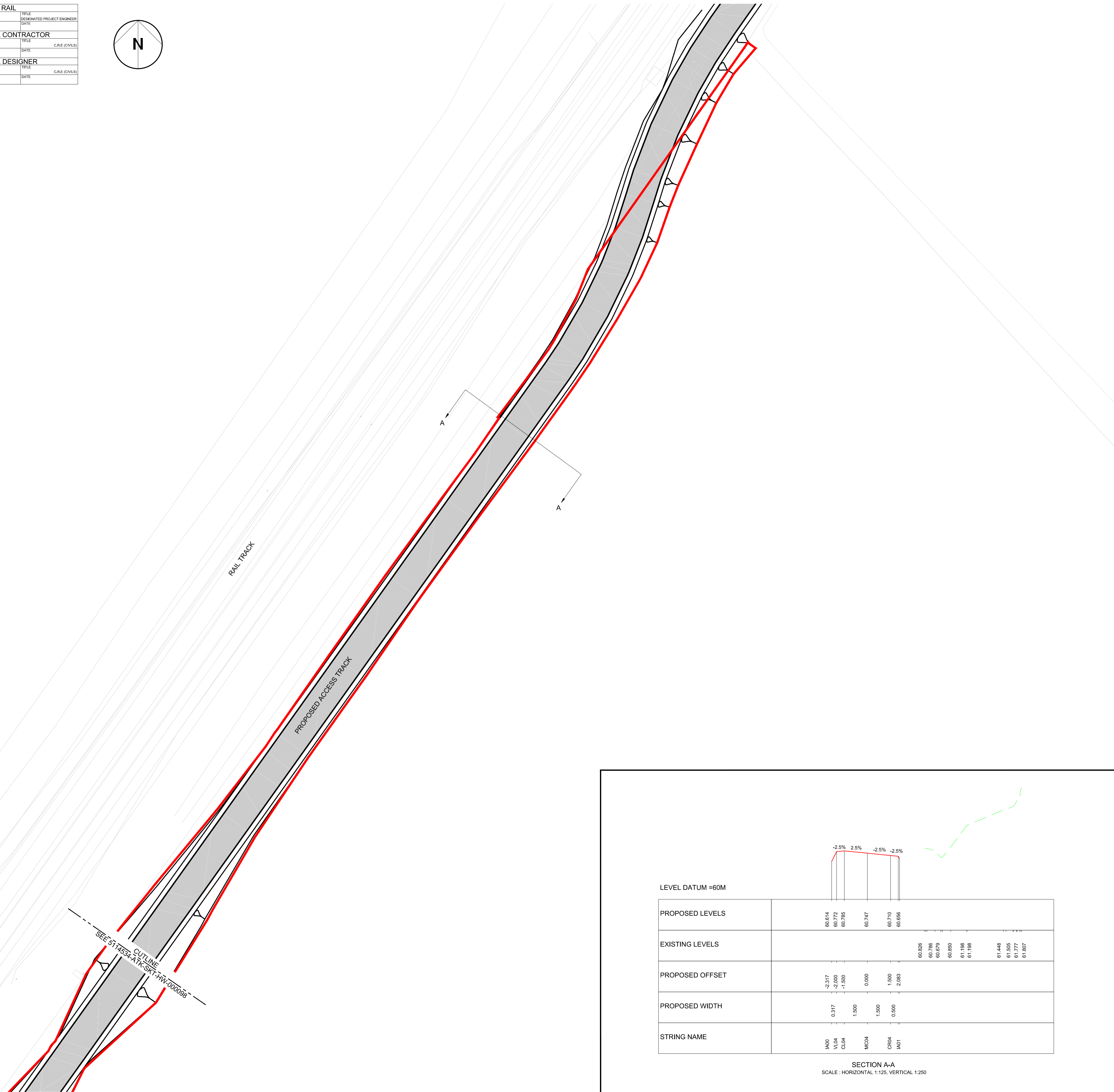
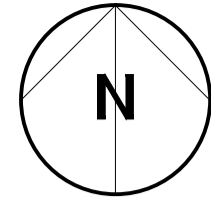

- KEY:**
- BOUNDARY LINE - EXTENTS OF PLANNING APPLICATION
 - CONCRETE SURFACE FINISH
 - PROPOSED DESIGN
 - - - EXISTING GROUND

- NOTES:**
- LAYOUT IS BASED UPON OS TILE DATA PROVIDED BY NETWORK RAIL (© CROWN COPYRIGHT AND DATABASE RIGHTS 2013 ORDNANCE SURVEY 0100040692), AERIAL SURVEY UNDERTAKEN BY ATKINS IN AUGUST 2009 AND TOPOGRAPHICAL SURVEY UNDERTAKEN BY ATKINS IN MAY 2013. ALL DIMENSIONS TO BE CHECKED AND VERIFIED ON SITE.

| Rev | Date | Description of Revisions | Drawn | Chkd | Appr |
|--------|------|--------------------------|-------|------|------|
| Status | | | | | |

FOR INFORMATION



Contractor(s)

ATKINS

The Axis
10 Holiday Street
Birmingham
West Midlands
B1 1TF

Tel: +44 (0)121 483 5000
Fax: +44 (0)121 483 6333

Project

EAST WEST RAIL PHASE 1

Drawing Title

HOME FARM
AGRICULTURAL BUILDING
AND ACCESS TRACK
SHEET 1 OF 3

| | | | | | |
|----------|----------------|--------|--|------|------------|
| Designed | NICHOLA BUTLER | Signed | | Date | 12/02/2015 |
| Drawn | NICHOLA BUTLER | Signed | | Date | 12/02/2015 |
| Checked | DARREN SALMONS | Signed | | Date | 12/02/2015 |
| Approved | KAREN WOOD | Signed | | Date | 12/02/2015 |

Scale(s) 1:200 @ A1 ELR & Mileage OXD

Alternative Reference Sheet 1 of 3

