





OS MAP DATA REPRODUCED BY PERMISSION OF ORDNANCE SURVEY ON BEHALF OF HMSO. © CROWN COPYRIGHT 2004. ALL RIGHTS RESERVED. ORDNANCE SURVEY LICENCE NUMBER 0100040692.

Key:

	Boundary Line - Extents of Planning Application (Red line is drawn to extent of earthworks for proposed access track)
	Hardcore Surface Finish
	Concrete Base
	Existing Barn to be Retained

Rail Track

Rail Track

Rail Track

Proposed Access Road

Proposed Access Road

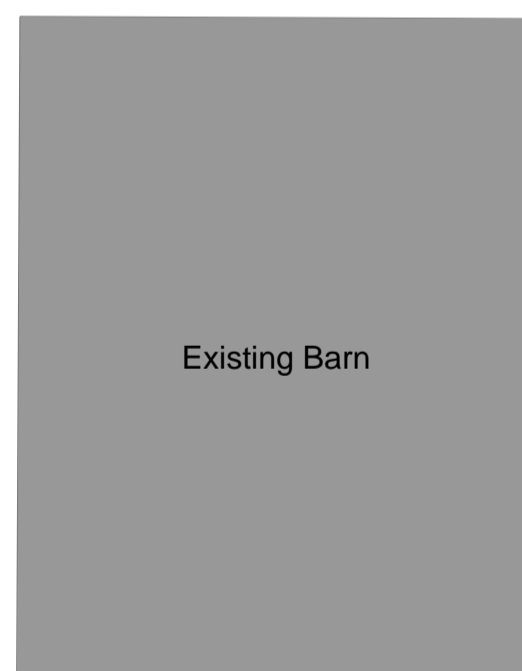

Existing Barn

Relocated Storage Container

Hardcore to abut proposed access track

Portacabin Office

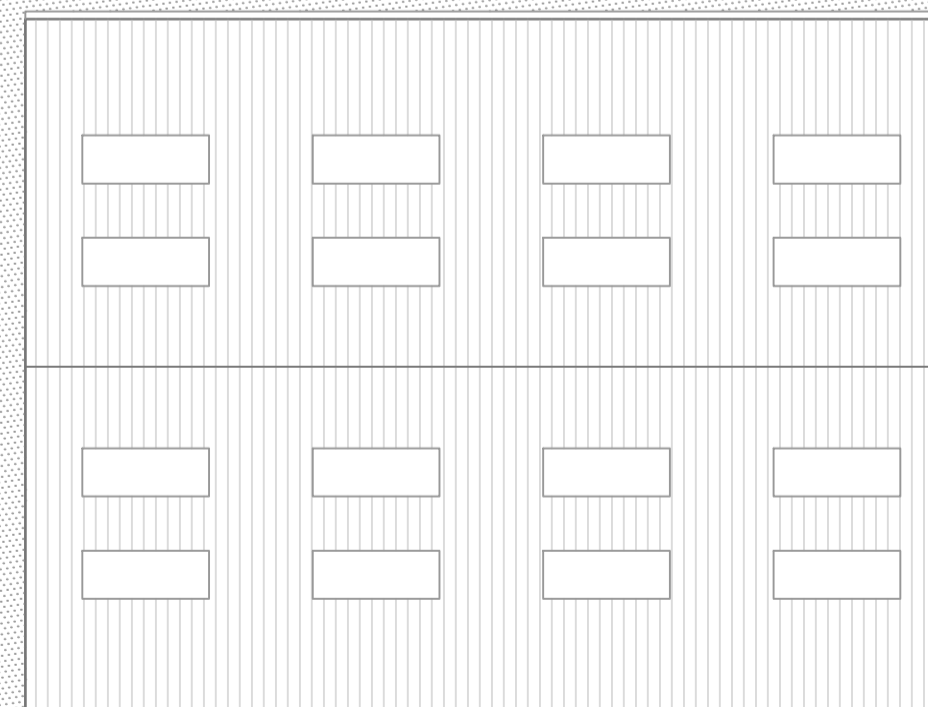

Cattle Handling Facility

Rainwater Harvesting Tank

Rev	Date	Description of Revisions	Drawn	Chkd	Appr
P08	24/02/15	TREES REMOVED AND hardcore ADDED	CB	JW	GN
P07	20/02/15	BUILDING AND YARD LOCATION AMENDED	CB	JW	GN
P06	16/02/15	TITLE BLOCK AND KEY AMENDED	CB	JW	GN
P05	11/02/15	ISSUED FOR PLANNING - AND SIZE/SCALE CHANGED	CB	JW	GN
P04	06/01/15	ISSUE	CB	JW	GN
P03	12/12/14	ISSUE	CB	JW	GN
P02	23/06/14	TITLE BLOCK AMENDMENT	CB	JW	GN
P01	23/06/14	ISSUE	CB	JW	GN

Status

S2 FOR INFORMATION



Contractor(s)

ATKINS

The Axis
10 Holliday Street
Birmingham
West Midlands
B1 1TF
Tel: +44 (0)121 483 5000
Fax: +44 (0)121 483 6333

Project

HOME FARM AGRICULTURAL BUILDING AND ACCESS TRACK

Drawing Title

SITE PLAN

Designed	CB	Signed	Date	24/02/15
Drawn	CB	Signed	Date	24/02/15
Checked	JW	Signed	Date	24/02/15
Approved	GN	Signed	Date	24/02/15

Scale(s) 1:200 at A1 ELR & Mileage

Alternative Reference Sheet 1 of 1