

# PARCELS KMA & KMB, KINGSMERE, BICESTER GARAGES

The contractor is to check and verify all building and site dimensions, levels and sewer invert levels at connection points before work starts. The contractor is to comply in all respects with current building legislation - British Standard Specifications, Building Regulations etc, whether or not specifically stated on the drawing.

Sheet Size  
**A1**

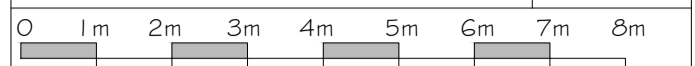

Rev	Date	Init
A	08-10-14	TE
B	21-11-14	KF
C	05-1-15	KF

Plot numbers and optional door positions amended.  
 Brick detailing removed.  
 Materials revised and Plot numbers revised.  
 Garages added and revised.  
 Personnel doors revised.  
 all as planners comments.  
 Plot numbers amended to suit layout revisions.  
 Garages added for Plots 123, 124 & 125 and 213, 214 & 215

FRONT ELEVATION  
TRIPLE GARAGE - RENDER

SIDE ELEVATION

REAR ELEVATION

PLOTS:- 195, 196 & 197

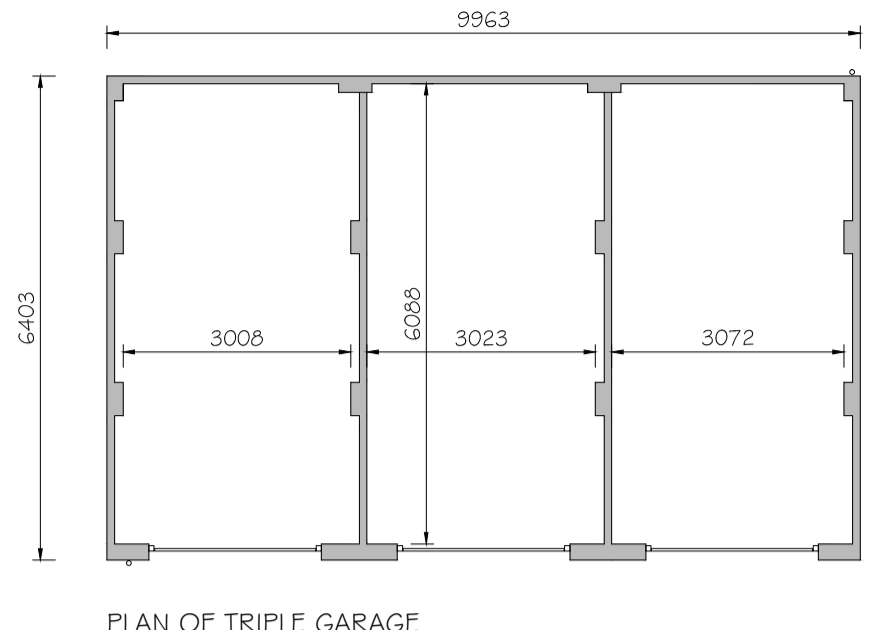

FRONT ELEVATION  
COMBINED DOUBLE & SINGLE GARAGE - RENDER

SIDE ELEVATION

REAR ELEVATION

PLOTS:- 4 & 5

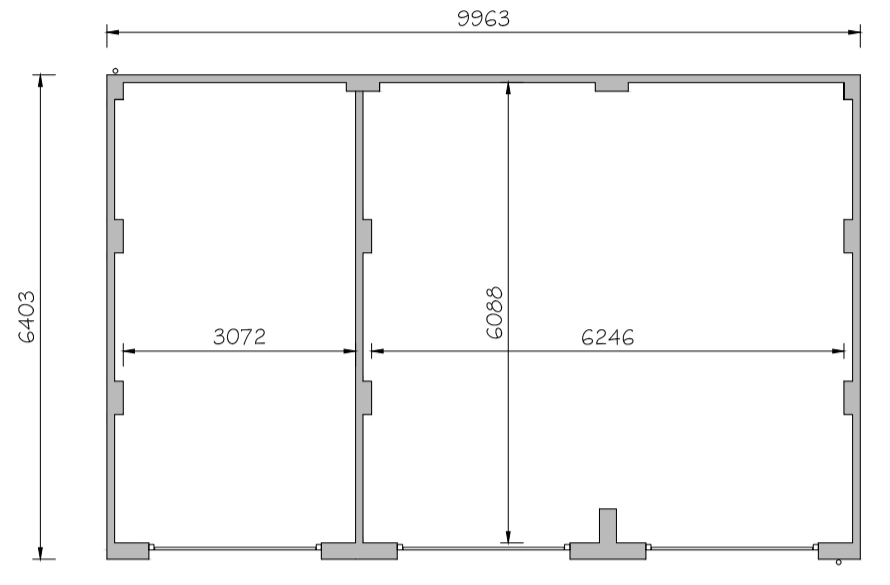

FRONT ELEVATION  
TRIPLE HIPPED ONE END GARAGE - RENDER

SIDE ELEVATION

REAR ELEVATION

PLOTS:- 213, 214 & 215

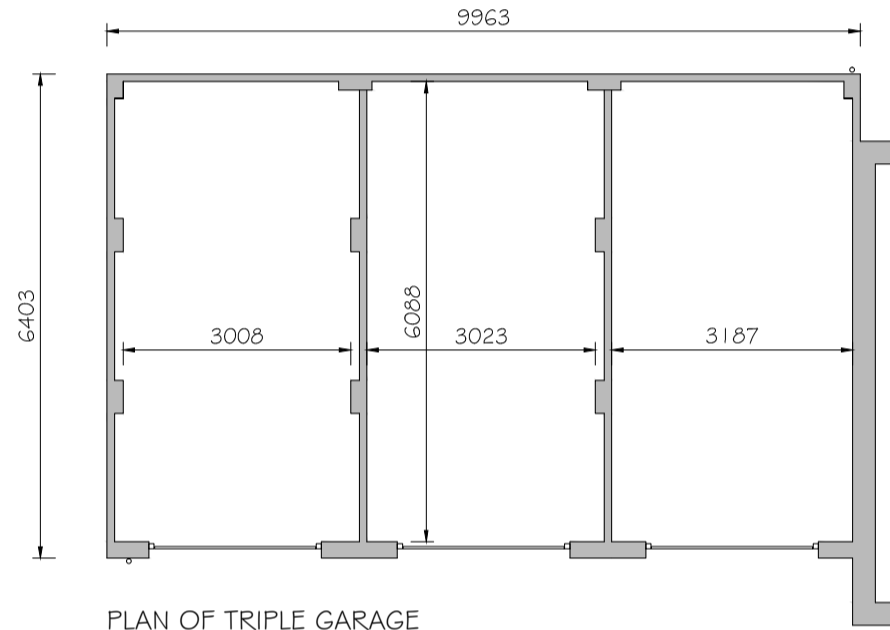

FRONT ELEVATION  
TRIPLE HIPPED GARAGE - BRICK

SIDE ELEVATION

REAR ELEVATION

PLOTS:- 188, 189 & 190

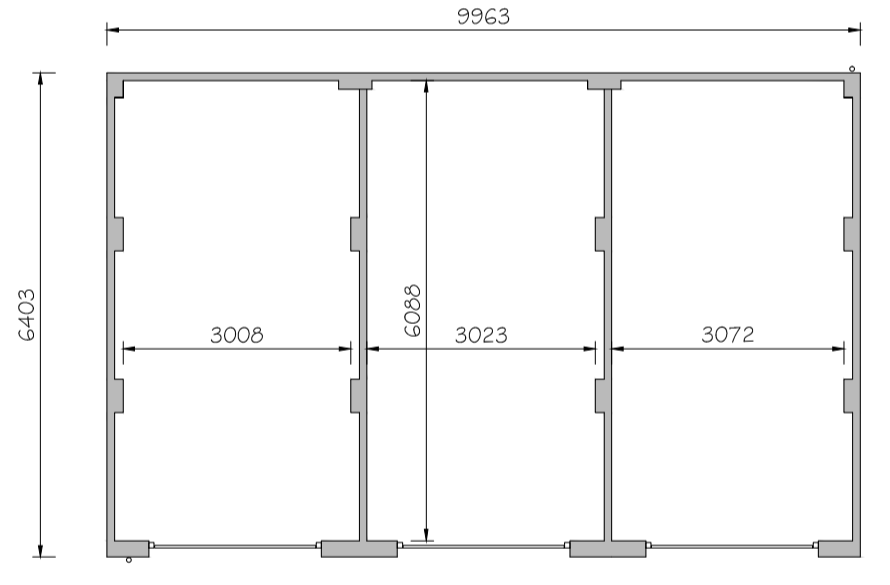

FRONT ELEVATION  
TRIPLE HIPPED GARAGE - RENDER

SIDE ELEVATION

REAR ELEVATION

PLOTS:- 123, 124 & 125

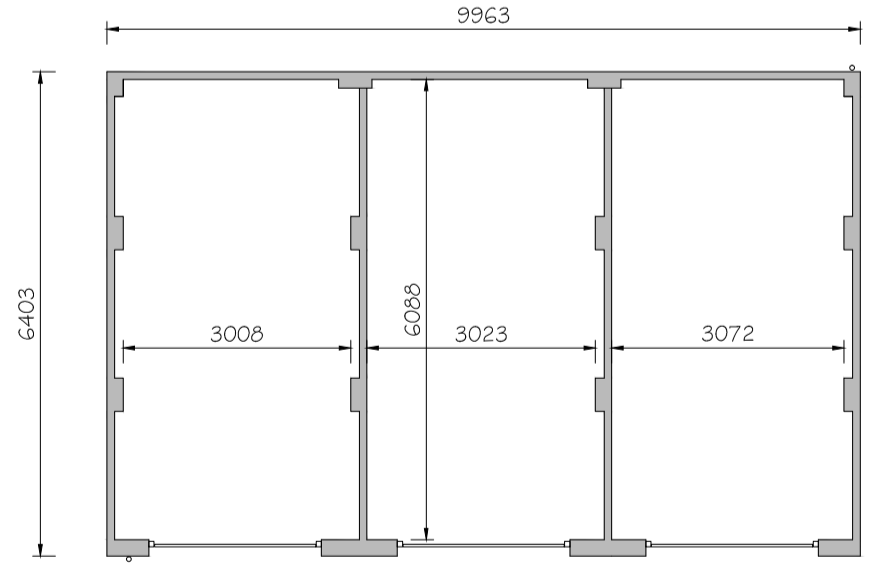

FRONT ELEVATION  
COMBINED HIPPED DOUBLE & SINGLE GARAGE - RENDER

SIDE ELEVATION

REAR ELEVATION

PLOTS:- 198 & 199

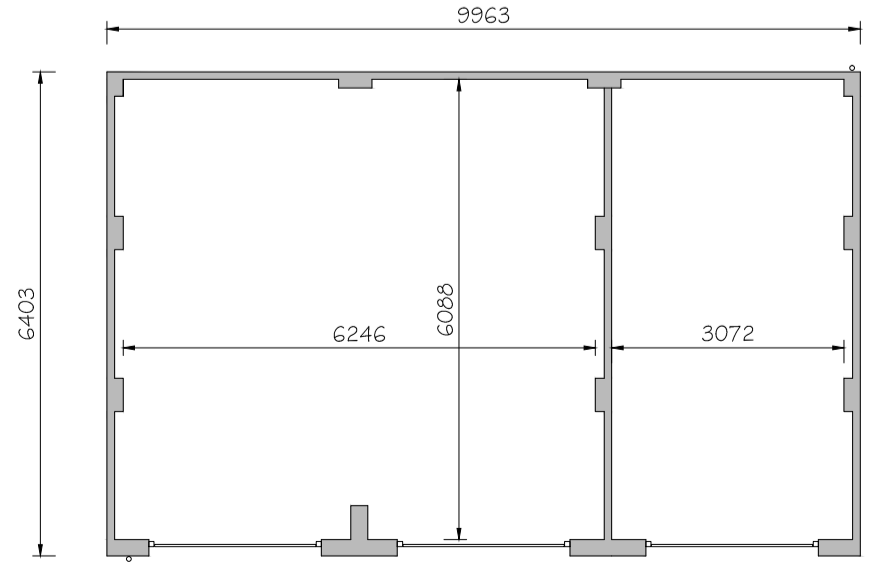

PROJECT:  
PARCELS KMA & KMB,  
KINGSMERE, BICESTER

DRG TITLE:  
GARAGES

JOB NO:	DRG NO:	REV:
1186	56-2	C
SCALE:	DRN BY:	PK
1:100	CKD BY:	TE
DATE:		
09/14		

**The NOBLE Consultancy**  
 ■ Architectural ■ Planning ■ Urban Design ■ Landscaping ■  
 The Stables, Says Court Farm, Badminton Road  
 Frampton Cotterell, South Gloucestershire, BS36 2NY  
 T: 0844 7452033  
 E: design@noble-consultancy.co.uk  
 W: www.noble-consultancy.co.uk