

05.4 Himley Park

5.4.3 Landscape Character

Neighbourhood parks continue the green network through the residential neighbourhoods. Rich in colour and texture these gardens offer play and recreational opportunities close to your doorstep whilst being an integral part of the overall green infrastructure. Small squares and areas for petanque, kite flying, play and relaxation are all nestled outside the surrounding houses creating a community focused feel where neighbourhood specific events can happen eg. summer parties or birthday parties.

MOVEMENT CORRIDOR

- A wide neighbourhood park with broad open space for movement of cyclists and pedestrians as part of the wider circulation.
- Orchards and allotments intersperse swaths of wildflower meadow, allotments and play zones.
- Hammocks and benches provide space to sit, reflect and contemplate.
- Access from private gardens is through low hedges with garden gates and mown grass paths linking to the central path.
- Where the paths meet the roads, safe crossing points enable smooth cycle journeys.

NEIGHBOURHOOD PARKS

- Neighbourhood parks provide public space between houses and a safe green setting for residents.
- Semi private and communal recreational spaces for the residents to the rear of the houses.
- Shared extension to the back gardens encouraging community interaction, space for play and growing areas.



05.4 Himley Park



View across southern residential park

05.4 Himley Park



Dwellings focused around neighbourhood parks

Southern residential parkland

Non-residential uses on Middleton Stoney Road serving both Himley Village and the wider community



Seamless integration of play and growing spaces, allowing children to play whilst adults can focus on growing veg



Swathes of wildflowers with spots to sit, relax and soak up the sun



Espalier fruit trees as boundary edge to dwellings



High quality play elements for all ages

05

5.5 Himley Edge

- 5.5.1 Developing the Place
- 5.5.2 Neighbourhood Character
- 5.5.3 Landscape Character

05.5 Himley Edge

5.5.1 Developing the Place

Himley Edge forms the porous border to the Site, where settlement meets the rolling agricultural landscape.

Here we have sought to achieve a neighbourhood which reflects this condition, with a looser density and urban grain.

We have looked at variety of ways of achieving this - in common to all is a desire for a single unified neighbourhood, with connections between the three fields.

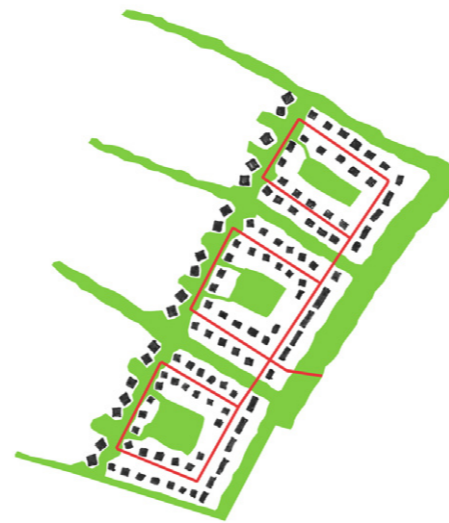

Option 01
Low density loops
with GI courtyards



Option 02
Maximized the rural edge
and small tertiary roads loops

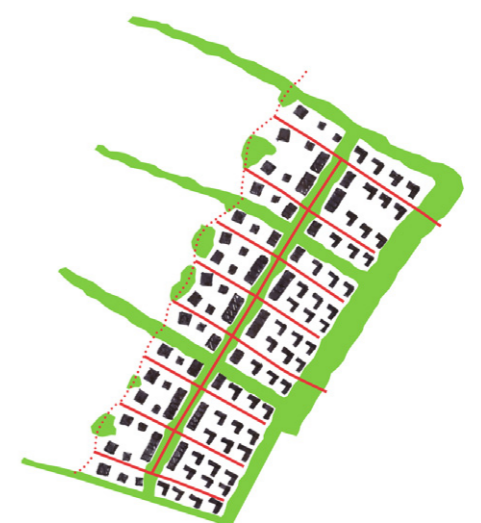

Option 03
North-south GI boulevard
with cul-de-sac accesses



Option 04
Three cluster/villages
with access route in open fields



Option 05
Private gardens clusters
with three tertiary loops

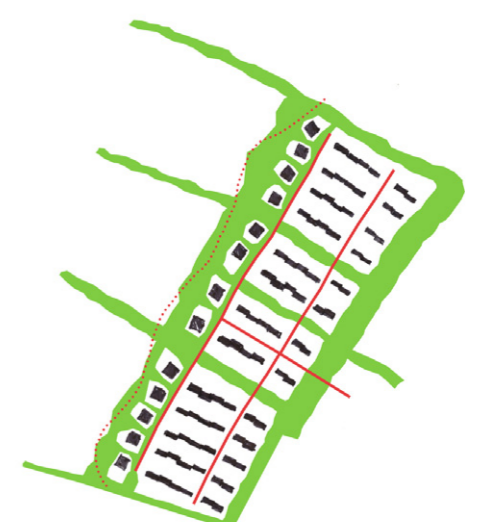

Option 06
Maximized sun-orientation
and buildings contiguity

05.5 Himley Edge

5.5.2 Neighbourhood Character

A relaxed quiet neighbourhood set out over three linked fields, making the transition from settlement to the east to the rolling landscape to the west.

The main north-south hedgerow acts a threshold between the intricate character of Himley Park and this quieter rural edge character.

Dwellings arranged in small groups, within the narrower field structure.

The dominant house typology here is the detached house, leading to a more open green and loose urban character.

Footpaths and cyclepaths along the hedgerows link through to those at Himley Park, providing pleasant green corridors encouraging greater interaction and movement with the fertile rural edge.

Moving towards the rural edge, clusters of woodland provide for a bio-diverse rich habitat.

A series of distinct individual houses nestled under the clustered wooded tree canopy that forms the blurred edge to the development .

KEY PRINCIPLES

- A neighbourhood characterised by individual dwellings set amongst open landscape.
- Hedgerows providing good though connections to Himley Park and the rest of the Village, encouraging greater interaction with the rural wooded edge.
- Leisure routes along the rural wooded edge, promoting a healthy active lifestyle.



Dwellings arranged in small groups within the narrower field structure

Movement corridors along hedgerows

Distinct individual houses amongst woodland

05.5 Himley Edge

5.5.3 Landscape Character

Nestled between clusters of woodland planting a peaceful edge with glimpses over the adjoining paddocks invites for leisurely walks, foraging and informal play / fitness trails.

Weaving in and out of the woodlands a bridleway interspersed with small allotment gardens and play/ fitness trails forms a quiet backdrop to this site of the development. Hedgerow corridors link back into the woodland providing additional food growing and dinner/ lunch foraging opportunities whilst going for a walk or to pick an apple on your way to work. Small tree houses, zip wires and tree trunks as play and wildlife watching elements could form part of the woodland.

The woodland extends into the proposed development as green irregular fingers that slowly disappear and merge with the existing hedgerows.



Cycle and footpath through proposed woodland with play and trim trails

Enhanced hedgerows with allotments and footpath

Bridleway

Bat corridor