

05.2 Himley Fields

5.2.2 Neighbourhood Character

Himley Fields is characterised by the large expanse of playing fields along the northern boundary and acts as a threshold to wider NW Bicester development to the north and Bicester to the east.

On the southern side of Himley Fields, 2 and 3 storey terraced and semi-detached houses are proposed. On the northern side there is scope for well spaced taller individual apartment buildings or larger dwellings lining the edge of the playing fields, allowing views to and from this open landscape.

The primary vehicle route runs along the western edge of the playing fields and the new school, linking the Himley Village to the wider NW Bicester development to the north.

A secondary route, running east-west connects through to the new boulevard.

Landscaped corridors, formed of communal gardens, informal play areas and allotments ensure that strong green connections are made between the facilities of the playing fields to the north and the community of Himley Village to the south.

KEY PRINCIPLES

- Maximise the opportunities afforded by the wide open spaces of the playing fields.
- Where appropriate, increase density adjacent to main routes and landscape features
- Green corridors ensuring good connection between the Village and the playing fields.

Well spaced larger dwellings / apartments lining the large open space of the playing fields

Landscaped corridors linking the playing fields to the rest of Himley Village

Well spaced larger dwellings / apartments set amongst woodland



05.2 Himley Fields

5.2.3 Landscape Character

1 - Generous space between apartments or larger dwellings, safe for children to play

2 - Rich planting and play

3 - Informal areas for play and as buffer between apartment buildings or larger dwellings

4 - Quiet community areas for bbq, play and relaxation



1



2



3



4

05.2 Himley Fields

5.2.3 Landscape Character

Communal courtyards and green spaces with informal play elements and seating areas will create a friendly and sociable character whilst green fingers with allotment gardens allow for generous spacing in between.

KEY PRINCIPLES

- Larger dwellings or apartments set within generous community spaces allowing for informal play and social interaction with seating and tables at regular intervals.
- Growing areas along the existing hedgerows will create a natural buffer to the playing fields whilst linear tree planting delineates the pitches and provide wind breaks and screening.
- Loosely scattered trees create screening and define social and private areas around the blocks.



05.2 Himley Fields



View across playing fields

05.2 Himley Fields

Primary School

Well spaced
apartments or larger
dwellings overlooking
the playing fields

Green connections
along hedgerow
corridors

Playing fields





05

5.3 Himley Woods

- 5.3.1 Developing the Place
- 5.3.2 Neighbourhood Character
- 5.3.3 Landscape Character

05.3 Himley Woods

5.3.1 Developing the Place

The character of Himley Wood is derived from significant landscape features to be found here as well as its location on the western edge of the Application Site, adjacent to the local facilities of the new boulevard.

Various options have been explored here, focused around an idea of a more formal, more dense character reflecting both the more intense broader nature of the landscape spaces and the proximity to local facilities and Bicester beyond.

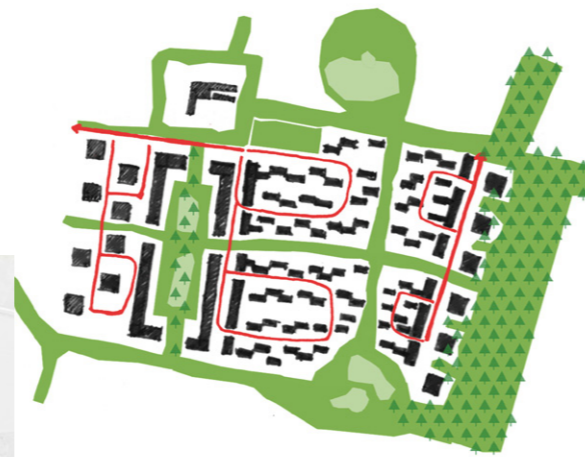

Option 01
Three density textures
and farm street courtyard

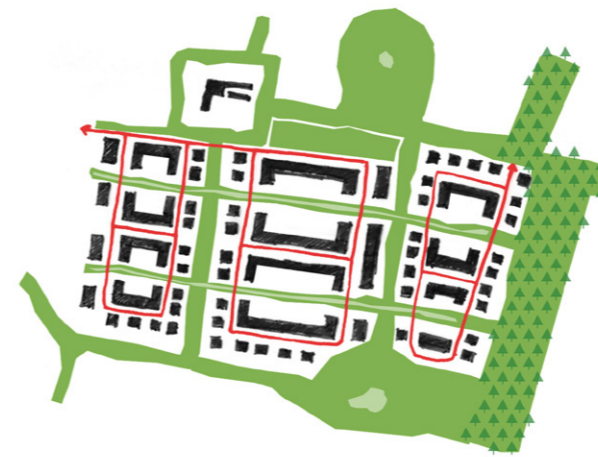

Option 02
Two east-west
GI connections

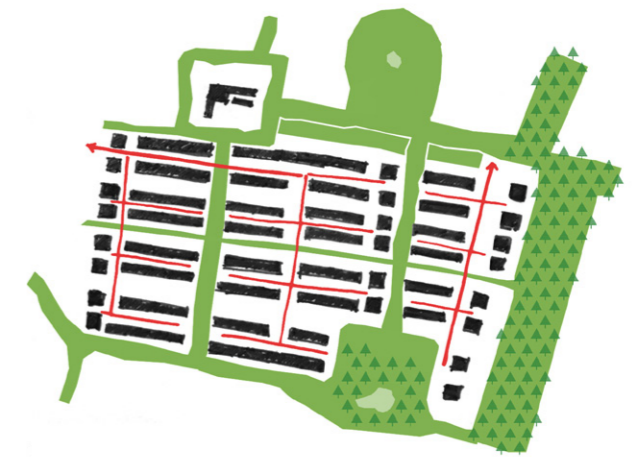

Option 03
Maximized sun-orientation
and reducing cars routes

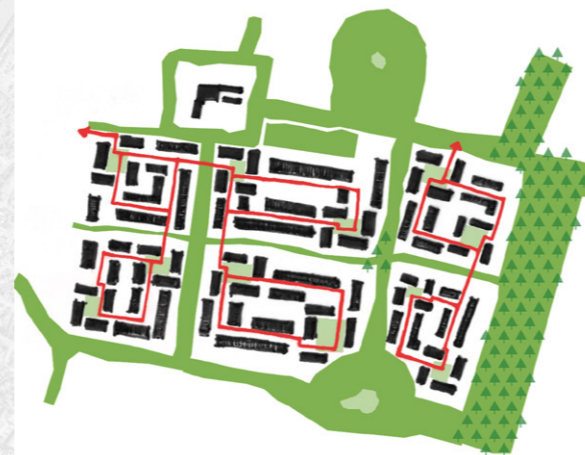

Option 04
Strategic courts arrangement
with six streets loops

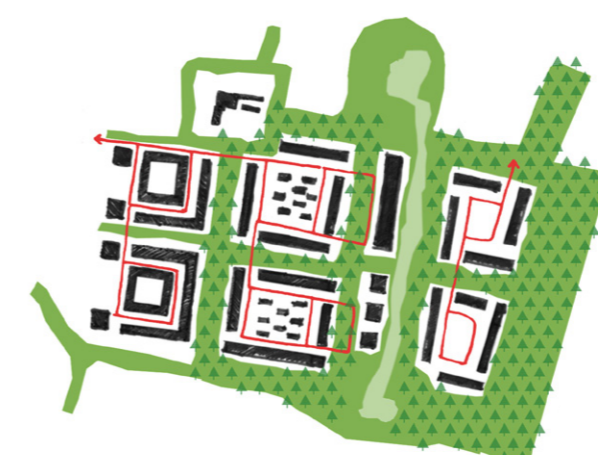

Option 05
Maximized wood character
and wet connection between ponds



Option 06
Orchards courts
on hedges routes

05.3 Himley Woods

5.3.2 Neighbourhood Character

A neighbourhood characterised by large expanses of rich natural habitats, balanced by a more formal dwelling typology.

Dwellings typically clustered into larger groups. The extent and location of these groups are defined by key landscape features such as woodlands, hedgerows, ponds and swales.

Dwelling typology presents a more uniform and consistent frontage to the streets, with groups of dwellings set amongst larger landscaped areas.

Reflecting the topography of the Site, the central strip of the is dominated by a large of expanse of attenuation ponds and planted area. This east-west corridor also encourages off-road connections between the Himley Green and Bicester beyond.

Perpendicular to this, the ponds linked by the habitat corridor provides for a lush and mature landscape within which connections can be made to sports fields and wider eco-town development to the north.

KEY PRINCIPLES

- Maximise the opportunities offered by existing landscape features such as the ponds and woodland buffer.
- An east-west corridor promoting off-road connections between Himley Village and the boulevard and Bicester beyond.



Lush habitat corridor providing links to the playing fields to the north

Groups of dwellings set around key landscape features

Key east-west movement corridor

Larger dwellings or apartments set amongst woodland

05.3 Himley Woods

5.3.3 Landscape Character

This area is characterized by the existing newt ponds and a natural green ecology corridor linking the two ponds with areas of mown pathways and timber walkways.

A series of swales and ditches creates a pleasant walking environment within areas of dense tree planting, long grass and meadow islands and incidental play opportunities.

Rocks, tree trunks and reeds along the edges of the swales and ditches form a natural landscape where walking, play and family activities invite to linger, explore and study wildlife.

Groups of tree planting allow glimpses to the surrounding buildings but the overall feeling of this area will merge with the rich green tapestry of the habitat and ecology park creating quiet and hidden pockets.

Arriving at the junction of the Newt corridor and the residential parkland play and social areas are nestled within the trees allowing glimpses along the linear nature park to the village green, the pond or the existing woodland.

A series of interweaving swales meanders through the park with islands of natural play forming a rich playable experience outside the surrounding houses alongside a more formal linear planting arrangement of tree lines and ornamental planting to add colour throughout the seasons. Benches, rocks and tree trunks invite to rest and play whilst going for a walk, a pint or down to the HFLT.

