

- ALL CLADDING IS BASED UPON THE MANUFACTURERS STANDARD COLOURS

- ARCHITECTURAL WALL PANELS (HOT DIP ZINC/ ALUMINIUM COATED STEEL)

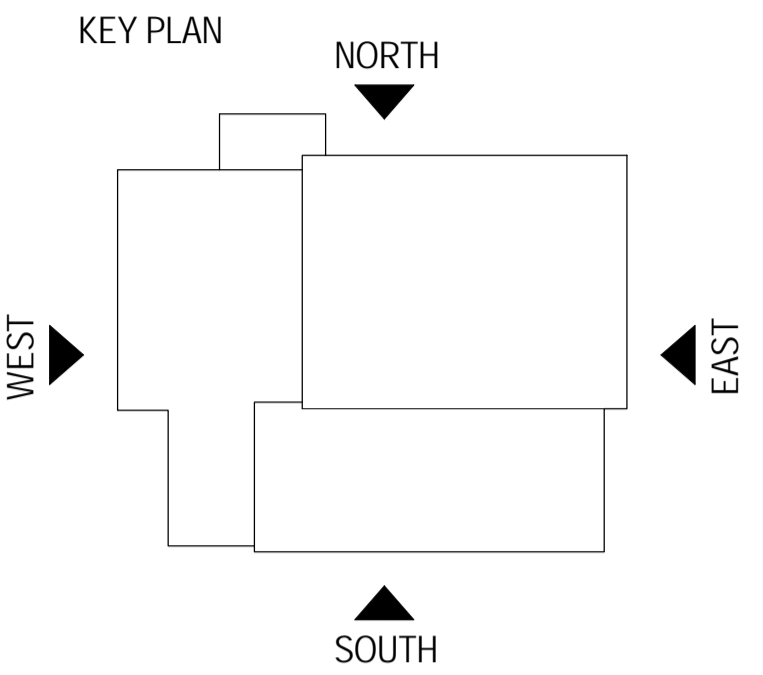

1 L-SH-2151 - South Elevation
1 : 100

PLANNING

Revision	Date	Revision Description	Issued By
A	25.10.13	Changes made in line with Kier comments	TW
B	28.03.14	General revisions per Kier comments received 03.03.14	TW
C	25.04.14	General revisions per Kier comments received 23.04.14	TW
D	02.07.14	Planning Issue	TW



2 L-SH-2151 - West Elevation
1 : 100

Job Title
Heyford Park Free School
Sports Centre

Drawing Title
Elevations South and West

Check all dimensions and verify on site. Report any errors or omissions

First Issued	23.09.13
Drawing Sheet Size	A1
Scale	As Indicated
Project Partner	NW
Project Architect	TW
Job Code	HFSK
Drawing Number	L-SH-2151
Revision	D



ADP Birmingham
33a Victoria Street
Birmingham
B1 3ND
T +44(0) 121 234 6440
F +44(0) 121 234 6450
adam@adp-architecture.com
www.adp-architecture.com