

PARCEL KMA & KMB, KINGSMERE, BICESTER

HOUSE TYPE GG3 : URBAN VILLAGE

© This drawing and works depicted are copyright of The Noble Consultancy Ltd. and may not be reproduced or amended except by written permission. No liability will be accepted for amendments made by other persons.

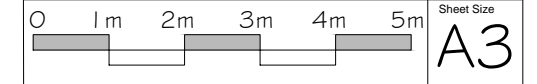

Rev	Date	Init
A	12/11/14	PK
Handings amended. - as planners comments		

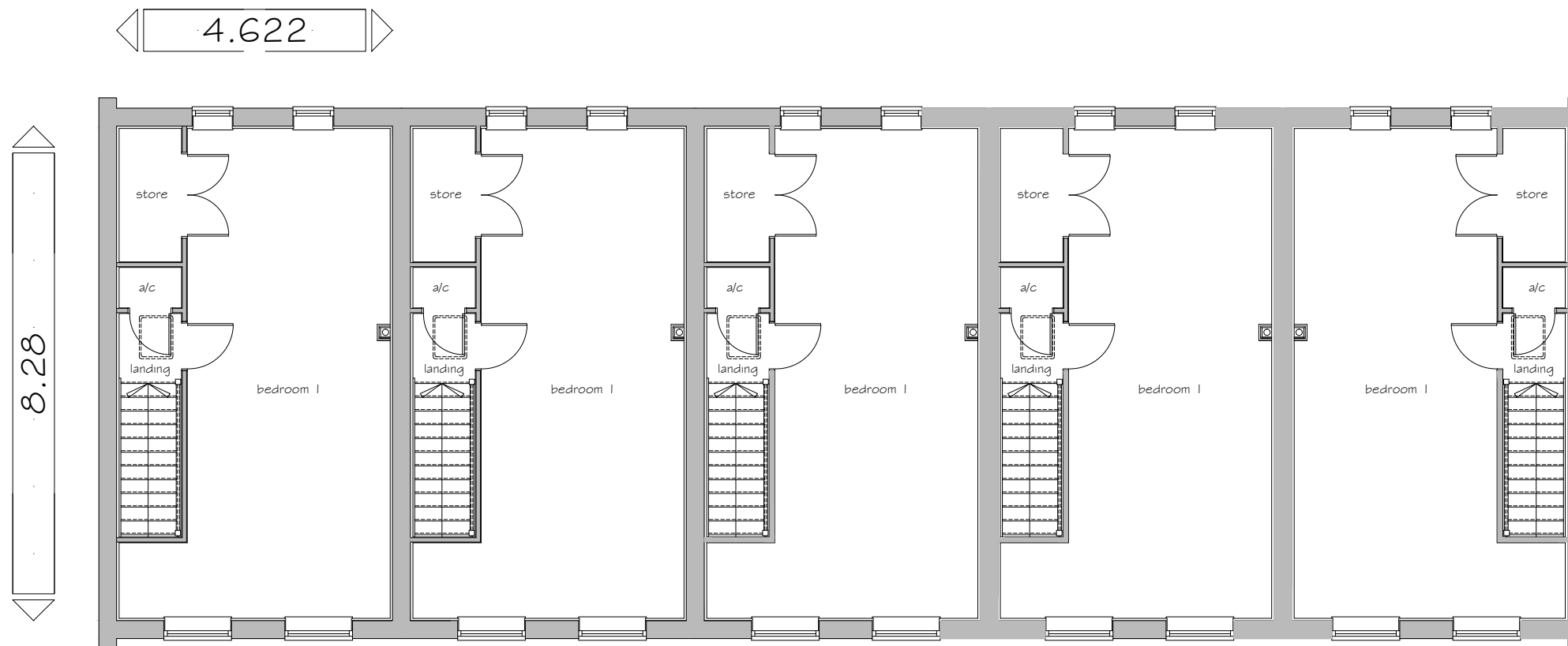

SECOND FLOOR PLAN

Plots: (as) 209, 210, 211 & 212

Plots: (opp) 213



PROJECT:
PARCEL KMA & KMB, KINGSMERE
BICESTER

DRG TITLE:
HOUSE TYPE GG3 (1 236)
SECOND FLOOR PLAN

JOB NO: 1186 DRG NO: HT - U - GG3 - 4

SCALE: 1:100 DRN BY: NFH REV: A

DATE: 09/14 CKD BY: NN

Gross Area (structural)
114.81 m²
1236 sq ft

▪ **The NOBLE Consultancy** ▪
 ▪ Architectural ▪ Planning ▪ Urban Design ▪ Landscaping ▪
 The Stables, Says Court Farm, Badminton Road
 Frampton Cotterell, South Gloucestershire, BS36 2NY
 □ T: 0844 7452033 □
 E: design@noble-consultancy.co.uk
 W: www.noble-consultancy.co.uk