



NOTES:

1. Do not scale from this drawing.
2. All dimensions in metres unless otherwise stated.

KEY:

-  Adoptable Highway
-  2.4m x 25m Visibility Splay
-  2.0m x 2.0m Pedestrian Visibility Splay

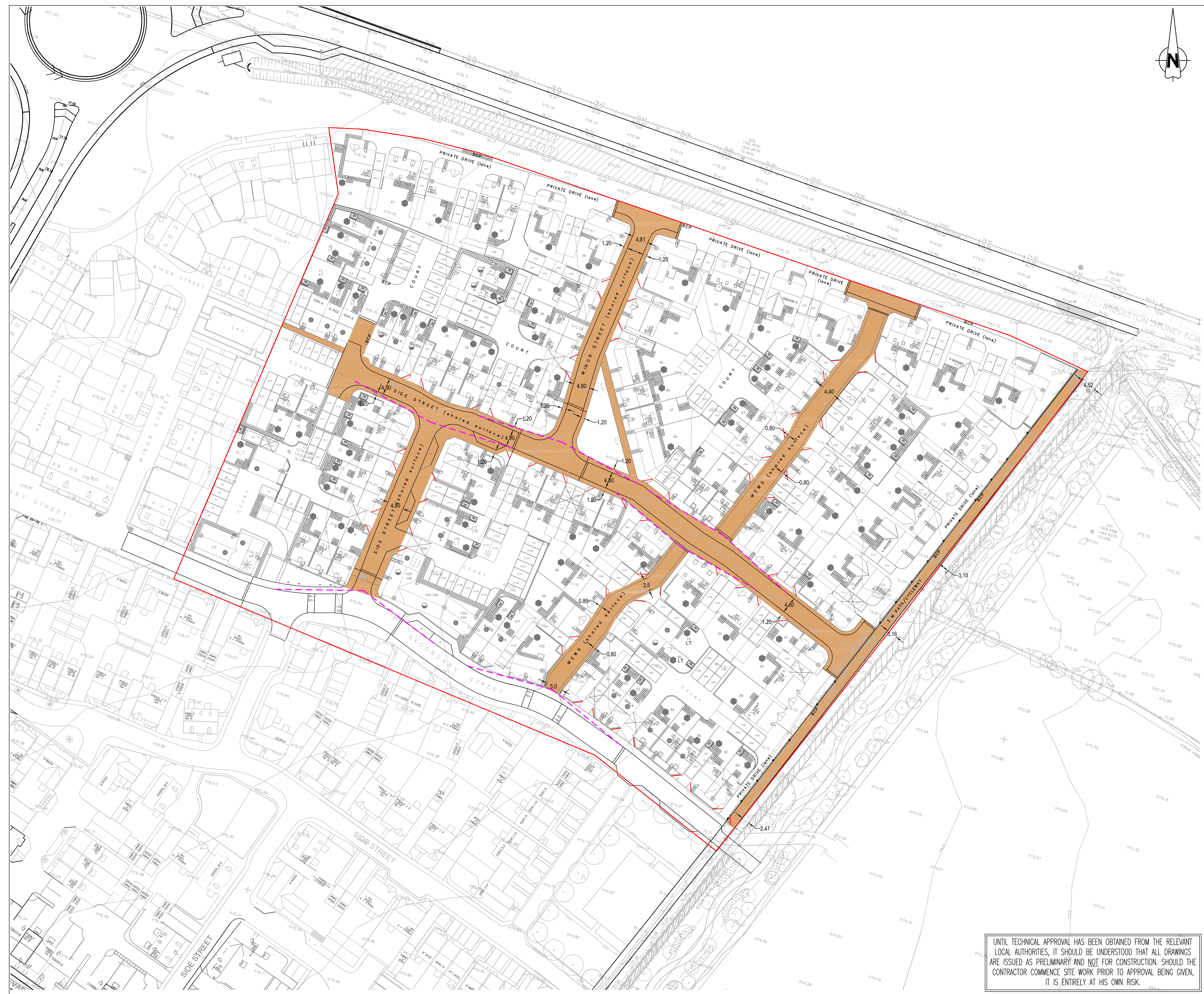
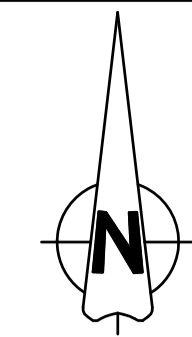

Rev	Date	Details	By
F	24.10.2014	Footway fronting plots 17-19 added to adoptable areas.	SM
E	11.09.2014	New masterplan layout added.	SM
D	29.08.2014	Layout updated following comments.	SM
C	24.07.2014	Layout updated following comments.	SM
B	20.02.2014	New masterplan layout added.	SM
A	17.06.2014	Adoptable extents amended on turning head.	SM

Drainage Authority Approval Date

Highway Authority Approval Date

Do not scale from this drawing. Use written dimensions only. When shown relationships between spot levels and ground levels are to be checked on site. Any discrepancy or suggested modification to be reported to Design and Engineering Director.
 Note: This drawing is the copyright of Bovis Homes Ltd.

BOVIS HOMES
 Bovis Homes Central Region
 Bromwich Court
 Highway Point
 Gorsey Lane
 Coleshill
 B46 1JU
 Tel: 01675 437 000
 Fax: 01675 437 094
 DX: 728340 Coleshill 2

Brookbanks Consulting

6150 Knights Court Solihull Parkway Birmingham B37 7WY
 Tel (0121) 329 4330 Fax (0121) 329 4331
 www.brookbanks.com

SITE: **KINGSMERE, BICESTER KM4**

DRAWING TITLE: **HIGHWAY ADOPTION PLAN**

DRAWN BY	DATE	DRAWING NO.	REV
SD	04.06.14	10109-HL-10	F
SCALE:	CHECKED/DATE		
1:500 @ A1	RH		

UNTIL TECHNICAL APPROVAL HAS BEEN OBTAINED FROM THE RELEVANT LOCAL AUTHORITIES, IT SHOULD BE UNDERSTOOD THAT ALL DRAWINGS ARE ISSUED AS PRELIMINARY AND NOT FOR CONSTRUCTION. SHOULD THE CONTRACTOR COMMENCE SITE WORK PRIOR TO APPROVAL BEING GIVEN, IT IS ENTIRELY AT HIS OWN RISK.