

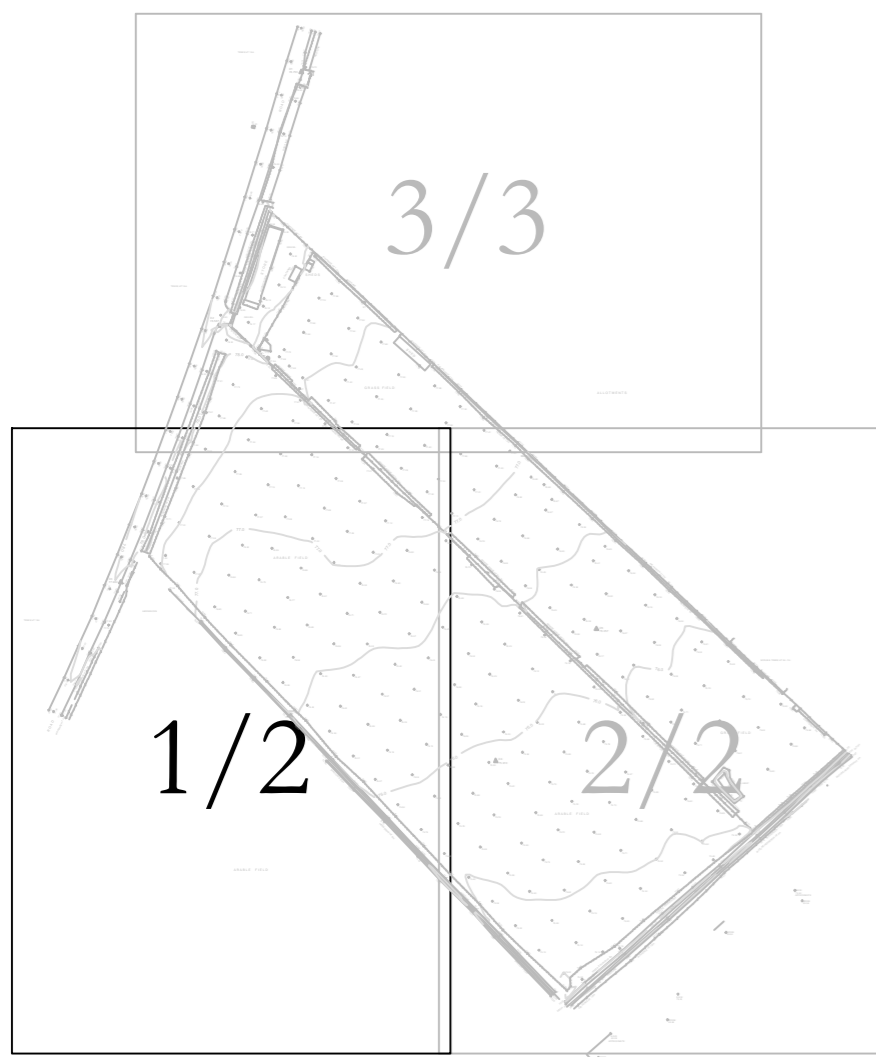

TREES HT 12m

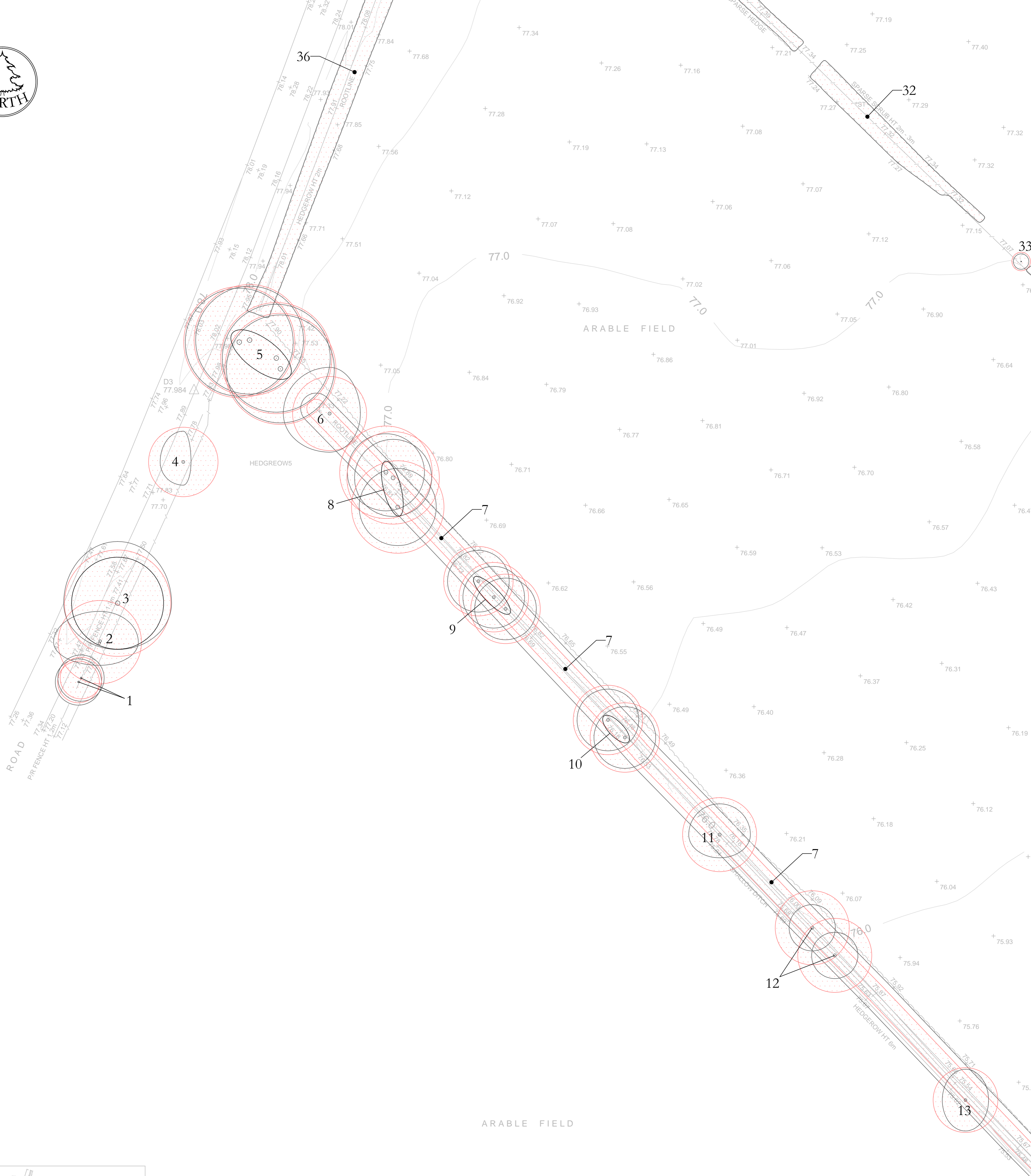

Sheet Layout



Key:

- Trees to be considered for retention:
  - Tree Category A 1,2 or 3 - trees of high quality
  - Tree Category B 1,2 or 3 - trees of moderate quality
  - Tree Category C 1,2 or 3 - trees of low quality
- Trees unsuitable for retention:
  - Tree Category U - trees that cannot realistically be retained due to their condition
- Protected areas:
  - Root Protection Area (RPA)
- Tree numbering
  - Tree number - refer to schedule for information

CLIENT: <b>CSA Environmental Planning</b>	
PROJECT: Land at Green Lane, Chesterton	
TITLE: Tree Constraints Plan	
DRAWING NUMBER: 8364/01 1/3	
STATUS: For Information	
DATE: April 2014	SCALE: 1:250 @ A1
DRAWN BY: ML	CHECKED BY: JTK
<small>Do not scale from this drawing: All dimensions to be checked on site</small> The copyright of this document resides with Ian Keen Limited unless assigned in writing by the company	
<b>IAN KEEN</b> LIMITED <small>Consultants for Trees, Landscapes          and Nature Conservation</small> <small>Rollands Farm, Rollands Lane, Epsom, Epsom, Surrey GU10 5AS          Telephone: 01252 85096 Facsimile: 01252 851702 Email: mail@iceekings.co.uk</small>	

Note:  
The original of this drawing was produced in colour - a monochrome copy should not be relied upon.

Tree survey based on RPS drawing number JKK8123\_1 Rev A.

For tree schedule see drawing number 8364/01 3/3.