

Drawings must be printed/reproduced in colour.

- A 05.11.13 General drawing update: LH JN
Chestnut pale fencing removed where clouded.
References to tarmac resurfacing removed.
Change of material to raised performance space.
Benching removed. Drawing number changed
from L1900 to L1920.
- B 03.12.13 Landscape amended to suit SN CH
marked up drawings. Area of paving slabs
changed to tarmac. area of grass increased.

CP ISSUE

Heyford Park Free School
Sports Hall

Proposed Landscape Plan

01.11.13
LH
1:200
JN
HFSK-SH
L
1920
B

- LEGEND**
- Standard Pin Kerb Q10.110
 - Standard Concrete Kerb Q10.111
 - Existing Concrete Kerb to be Retained
 - Drop Kerb Q10.111
 - 1800mm High timber hit and miss fencing Q40.28/28A
 - 1800mm High wild mesh fence Q40.27B
 - Chestnut Pale Fencing Q40.23
 - Tarmacadam, standard vehicular to be retained.
 - Tarmacadam, standard vehicular Q22.10
 - Proposed Pedestrian Tarmacadam Q22.15
 - Paving Slabs Q25.315
 - Bark mulch to nursery soft play Q.31.485A
 - Gravel Q25.305
 - Existing level
 - Proposed levels to.k. = top of kerb to.w. = top of wall Proposed coordinates

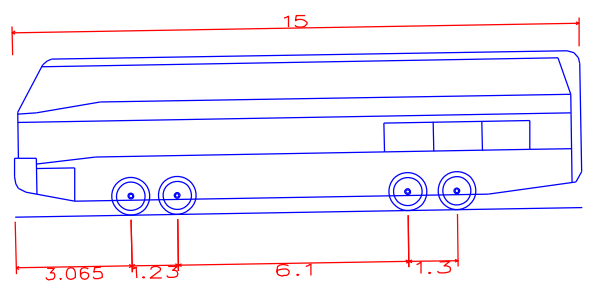
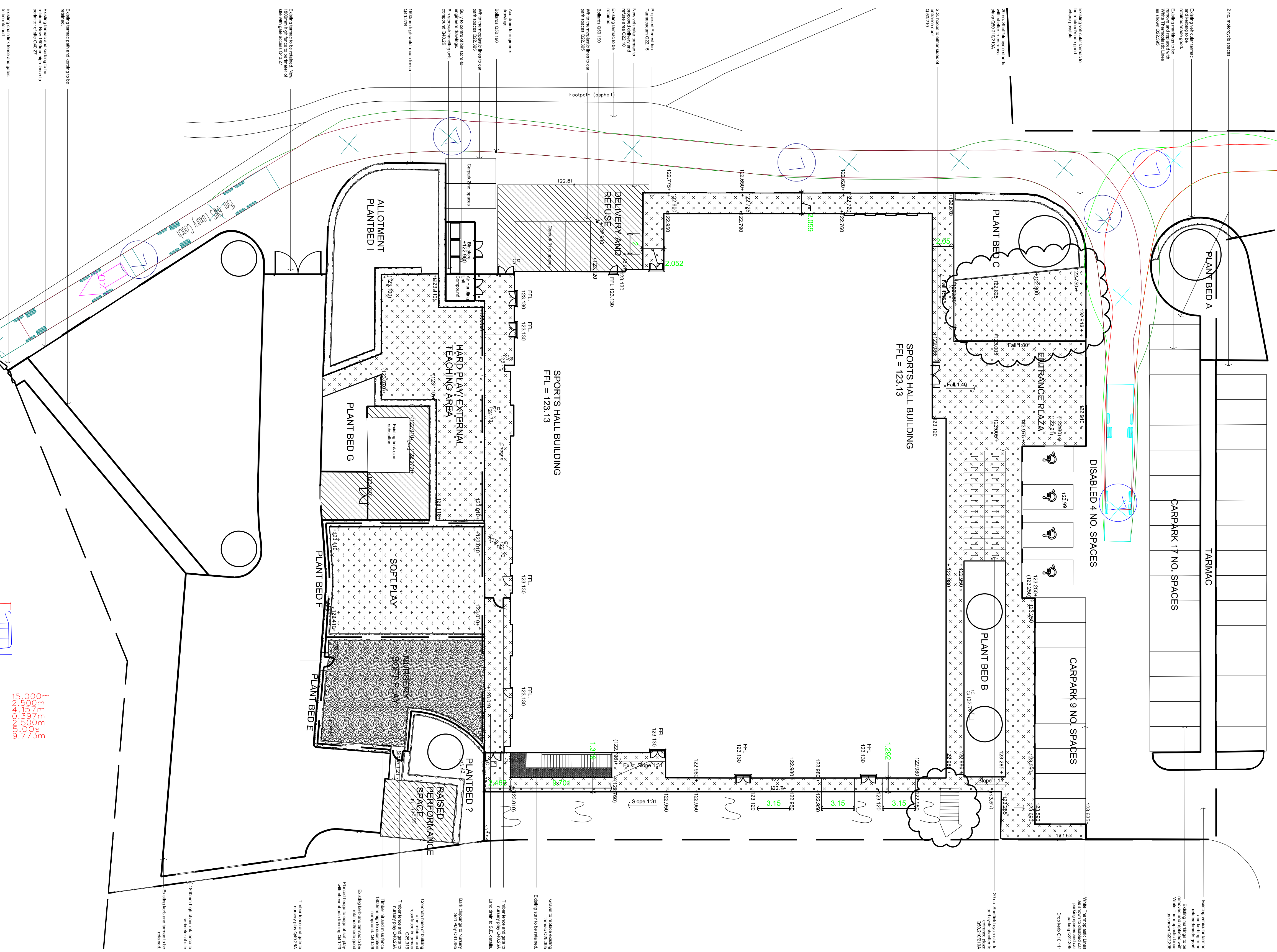

15m 6WS Luxury Coach
Overall Length 15.000m
Overall Width 3.065m
Overall Body Height 1.25m
Min Body Ground Clearance 1.3m
Track Width 6.1m
Lock to Lock Time 0.9s
Kerb to Kerb Turning Radius 11.3m

Existing tarmac to be retained and resurfaced to be retained.
Existing tarmac to be retained and resurfaced to be retained.
Existing tarmac to be retained and resurfaced to be retained.
Existing tarmac to be retained and resurfaced to be retained.

Existing tarmac to be retained and resurfaced to be retained.
Existing tarmac to be retained and resurfaced to be retained.
Existing tarmac to be retained and resurfaced to be retained.
Existing tarmac to be retained and resurfaced to be retained.

Existing tarmac to be retained and resurfaced to be retained.
Existing tarmac to be retained and resurfaced to be retained.
Existing tarmac to be retained and resurfaced to be retained.
Existing tarmac to be retained and resurfaced to be retained.

Existing tarmac to be retained and resurfaced to be retained.
Existing tarmac to be retained and resurfaced to be retained.
Existing tarmac to be retained and resurfaced to be retained.
Existing tarmac to be retained and resurfaced to be retained.

Existing tarmac to be retained and resurfaced to be retained.
Existing tarmac to be retained and resurfaced to be retained.
Existing tarmac to be retained and resurfaced to be retained.
Existing tarmac to be retained and resurfaced to be retained.

Existing tarmac to be retained and resurfaced to be retained.
Existing tarmac to be retained and resurfaced to be retained.
Existing tarmac to be retained and resurfaced to be retained.
Existing tarmac to be retained and resurfaced to be retained.

Existing tarmac to be retained and resurfaced to be retained.
Existing tarmac to be retained and resurfaced to be retained.
Existing tarmac to be retained and resurfaced to be retained.
Existing tarmac to be retained and resurfaced to be retained.

Existing tarmac to be retained and resurfaced to be retained.
Existing tarmac to be retained and resurfaced to be retained.
Existing tarmac to be retained and resurfaced to be retained.
Existing tarmac to be retained and resurfaced to be retained.

Existing tarmac to be retained and resurfaced to be retained.
Existing tarmac to be retained and resurfaced to be retained.
Existing tarmac to be retained and resurfaced to be retained.
Existing tarmac to be retained and resurfaced to be retained.

Existing tarmac to be retained and resurfaced to be retained.
Existing tarmac to be retained and resurfaced to be retained.
Existing tarmac to be retained and resurfaced to be retained.
Existing tarmac to be retained and resurfaced to be retained.

Existing tarmac to be retained and resurfaced to be retained.
Existing tarmac to be retained and resurfaced to be retained.
Existing tarmac to be retained and resurfaced to be retained.
Existing tarmac to be retained and resurfaced to be retained.

Existing tarmac to be retained and resurfaced to be retained.
Existing tarmac to be retained and resurfaced to be retained.
Existing tarmac to be retained and resurfaced to be retained.
Existing tarmac to be retained and resurfaced to be retained.

Existing tarmac to be retained and resurfaced to be retained.
Existing tarmac to be retained and resurfaced to be retained.
Existing tarmac to be retained and resurfaced to be retained.
Existing tarmac to be retained and resurfaced to be retained.