

Inset 1:  
Alternative layout -  
with articulated HGV access to yard.

Proposed Accommodation - Local Centre Parcel		revision A 08.01.2013
<b>Local Centre:</b>		
Convenience Store		390 sq.m / 4,200 sq.ft
Retail Units	5 @ 68 sq.m / 730 sq.ft	340 sq.m / 3,660 sq.ft
Community Centre		640 sq.m / 6,890 sq.ft
<b>Total:</b>		<b>1,370 sq.m / 14,750 sq.ft</b>
<b>Parking:</b>	Commercial Units	12 No.
	Shared / public	27 No.
<b>Residential Units:</b>		
Above local centre:	2 bed flats	20 No.
	(Allocated parking spaces)	20 No.
Elsewhere within parcel:	Mews houses, 2 & 3 bedroom houses	20 No.

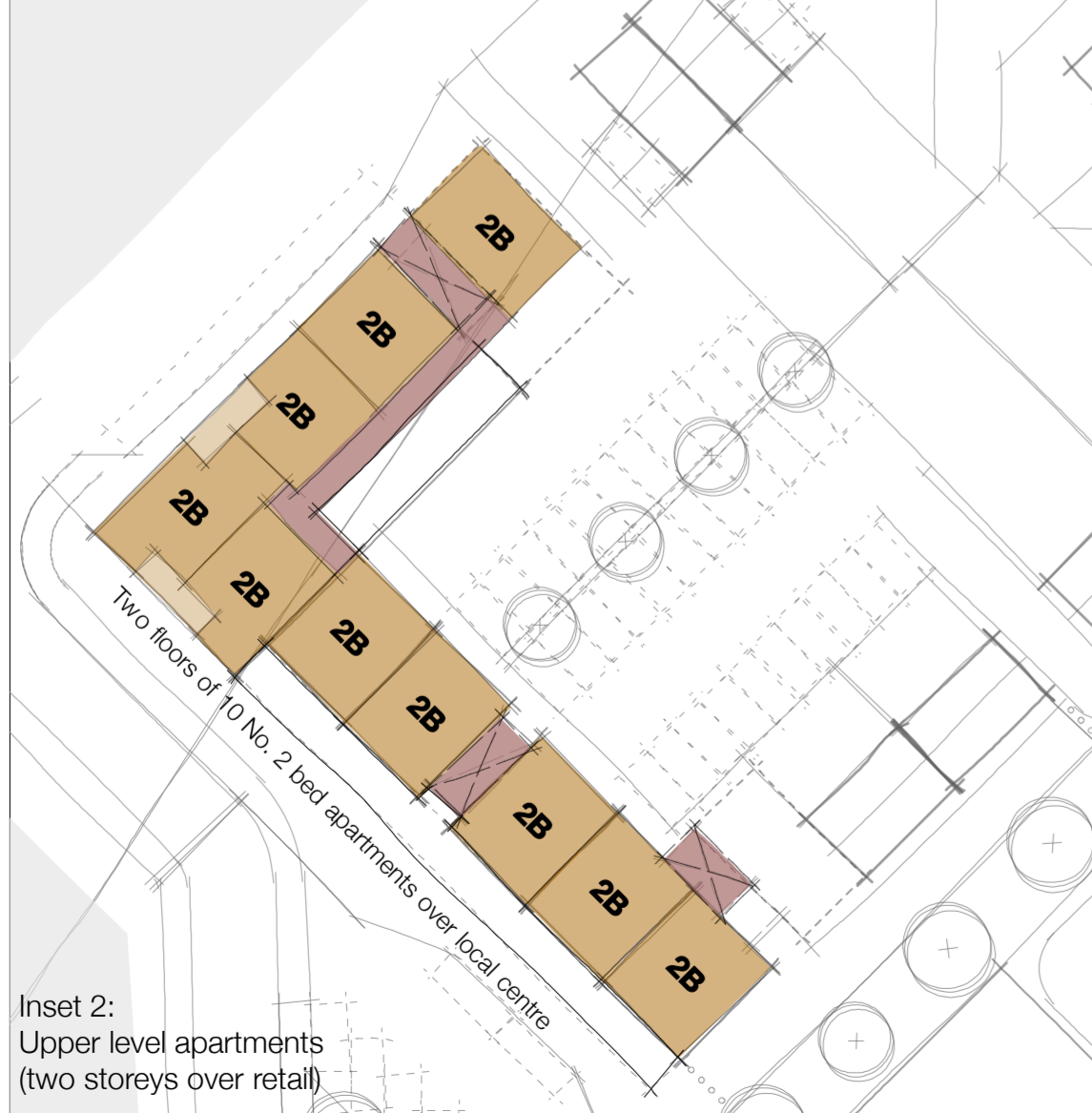

Inset 2:  
Upper level apartments  
(two storeys over retail)

