

**NOTE**  
 All dimensions to be checked on site and any discrepancies to be notified prior to the commencement of work.  
 Do not scale from this drawing.  
 If in doubt ask  
 © arch-e-tech design limited

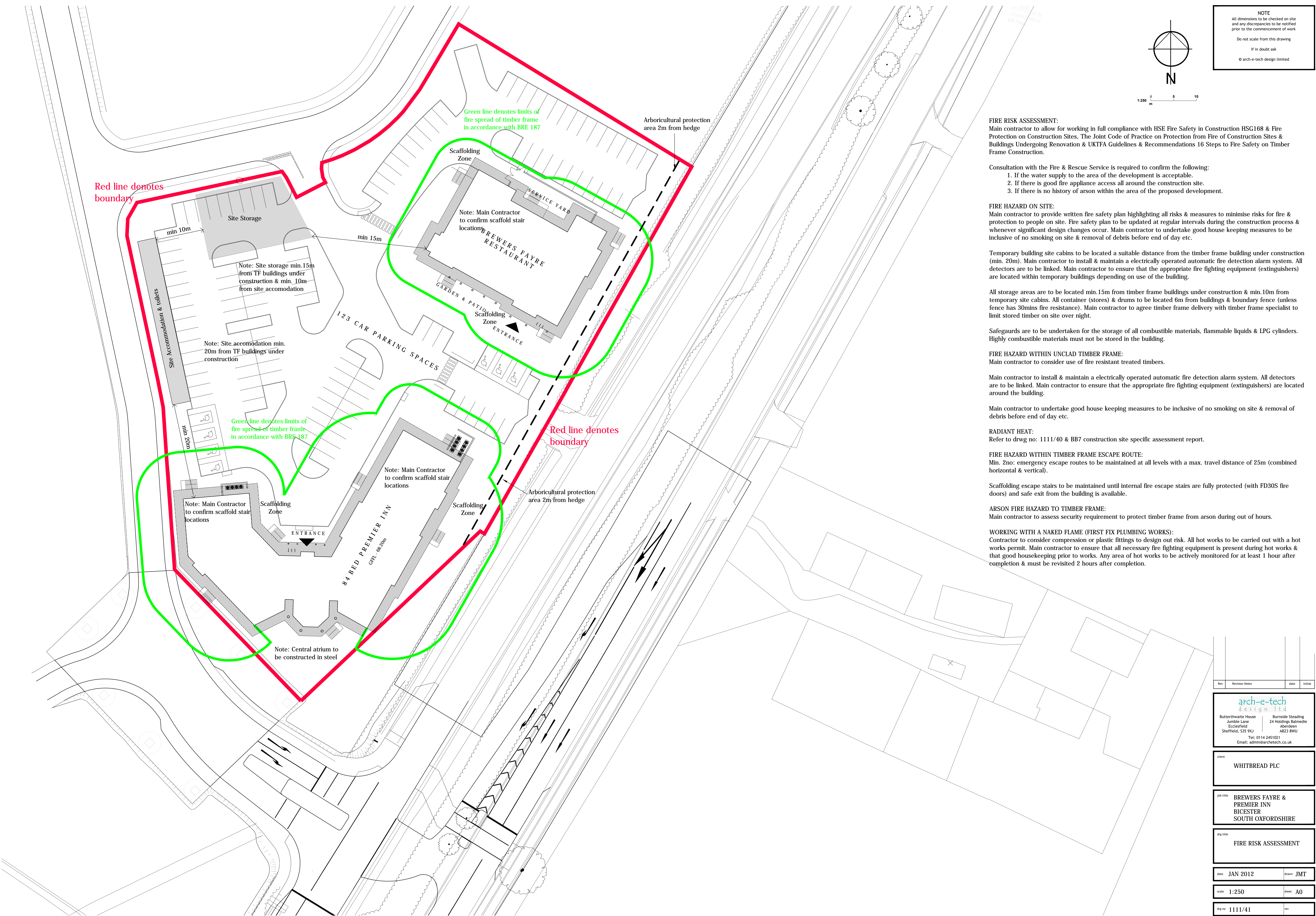

**FIRE RISK ASSESSMENT:**  
 Main contractor to allow for working in full compliance with HSE Fire Safety in Construction HSG168 & Fire Protection on Construction Sites, The Joint Code of Practice on Protection from Fire of Construction Sites & Buildings Undergoing Renovation & UKFA Guidelines & Recommendations 16 Steps to Fire Safety on Timber Frame Construction.

Consultation with the Fire & Rescue Service is required to confirm the following:  
 1. If the water supply to the area of the development is acceptable.  
 2. If there is good fire appliance access all around the construction site.  
 3. If there is no history of arson within the area of the proposed development.

**FIRE HAZARD ON SITE:**  
 Main contractor to provide written fire safety plan highlighting all risks & measures to minimise risks for fire & protection to people on site. Fire safety plan to be updated at regular intervals during the construction process & whenever significant design changes occur. Main contractor to undertake good house keeping measures to be inclusive of no smoking on site & removal of debris before end of day etc.

Temporary building site cabins to be located a suitable distance from the timber frame building under construction (min. 20m). Main contractor to install & maintain a electrically operated automatic fire detection alarm system. All detectors are to be linked. Main contractor to ensure that the appropriate fire fighting equipment (extinguishers) are located within temporary buildings depending on use of the building.

All storage areas are to be located min. 15m from timber frame buildings under construction & min. 10m from temporary site cabins. All container (stores) & drums to be located 6m from buildings & boundary fence (unless fence has 30mins fire resistance). Main contractor to agree timber frame delivery with timber frame specialist to limit stored timber on site over night.

Safeguards are to be undertaken for the storage of all combustible materials, flammable liquids & LPG cylinders. Highly combustible materials must not be stored in the building.

**FIRE HAZARD WITHIN UNCLAD TIMBER FRAME:**  
 Main contractor to consider use of fire resistant treated timbers.

Main contractor to install & maintain a electrically operated automatic fire detection alarm system. All detectors are to be linked. Main contractor to ensure that the appropriate fire fighting equipment (extinguishers) are located around the building.

Main contractor to undertake good house keeping measures to be inclusive of no smoking on site & removal of debris before end of day etc.

**RADIANT HEAT:**  
 Refer to drwg no: 1111/40 & BB7 construction site specific assessment report.

**FIRE HAZARD WITHIN TIMBER FRAME ESCAPE ROUTE:**  
 Min. 2no: emergency escape routes to be maintained at all levels with a max. travel distance of 25m (combined horizontal & vertical).

Scaffolding escape stairs to be maintained until internal fire escape stairs are fully protected (with FD30S fire doors) and safe exit from the building is available.

**ARSON FIRE HAZARD TO TIMBER FRAME:**  
 Main contractor to assess security requirement to protect timber frame from arson during out of hours.

**WORKING WITH A NAKED FLAME (FIRST FIX PLUMBING WORKS):**  
 Contractor to consider compression or plastic fittings to design out risk. All hot works to be carried out with a hot works permit. Main contractor to ensure that all necessary fire fighting equipment is present during hot works & that good housekeeping prior to works. Any area of hot works to be actively monitored for at least 1 hour after completion & must be revisited 2 hours after completion.

Rev	Revision Notes	date	initial

**arch-e-tech design ltd**  
 Butterthwaite House  
 Jumble Lane  
 Ecclesfield  
 Sheffield, S35 9WJ  
 Email: admin@archetech.co.uk  
 Burnside Steading  
 24 Holdings Balmorie  
 Aberdeen  
 AB23 8WU  
 Tel: 0114 2451021

client  
**WHITBREAD PLC**

job title  
**BREWERS FAYRE & PREMIER INN BICESTER SOUTH OXFORDSHIRE**

diag title  
**FIRE RISK ASSESSMENT**

date  
**JAN 2012**      drawn  
**JMT**

scale  
**1:250**      sheet  
**A0**

diag no  
**1111/41**      rev