

NOTES

- ANY highway or drainage works constructed prior to issue of Technical Approval is entirely at the risk of the Contractor/Clients.
- At the commencement of works on site the contractor is to carry out trial pits and liaise with Utility Companies in order to establish the exact position of all existing statutory utility plant in the vicinity of works and take adequate precautions for their protection.
- All manhole covers/inspection covers in existing carriageway/verges to be adjusted where necessary to suit design levels.
- Where the works involve the obstruction of a footway, the Contractor shall provide an alternative safe footway properly signed, guarded and lit.
- All highway works to be carried out in accordance with Oxfordshire County Council's document 'Transport Requirements for Development', to the satisfaction of the Highway Authority Section 38 Inspector and in accordance with the Specification for Highway Works.
- All excavation and backfilling work in the existing highway to be in accordance with the provisions of the New Street Works Act 1991 or that specified within the Working Drawings.
- The Contractor is to comply fully with the CDM Regulations in the course of constructing the works.
- The Contractor shall ascertain the CBR of the subgrade in order to determine the required sub-base/capping thickness.
- Prior to laying any material the subgrade must be inspected and any soft spots removed and filled with 6F2 capping material.
- Prior to construction of any drainage works, the Contractor is to confirm the invert levels of existing manholes and sewers. Any variations from the designed levels shown on the drawings shall be reported to the Engineer in advance of construction works commencing.
- All adoptable foul sewer drainage works must comply with 'Sewers for Adoption, 6th Edition' and to Thames Water Addendum and to the satisfaction of Thames Water.
- All adoptable drainage pipes shall have 360° Class S granular bed and surround. However, any pipes below the adoptable carriageway with less than 1.2m of cover (900mm in verge and untravellable areas), shall be Class Z surrounded with 150mm of S14 concrete with flexible joints.
- All drain and sewer pipes to be laid soffit to soffit, unless shown otherwise.
- Sewer trench backfill to be in accordance with the Adoptable Drainage Details (Drg No. 6008/116).
- Contractor to refer to Health & Safety Executive 'Note 47 - Avoiding Danger from Underground Services' and 'Document C56 - Avoiding Danger from Overhead Electric Lines'.
- Where one-way traffic is unavoidable, traffic shall be controlled by a proper system of vehicle actuated traffic signals or manual Stop/Go signs and during the hours of darkness by a proper system of vehicle-actuated traffic signals, all to the approval of the Highway Authority.
- Traffic signs and carriageway markings shall comply with the 'Traffic Signs Regulations and General Directions' (2002). Any plates removed as part of the works to be mounted on new poles where appropriate.
- Where existing junctions and accesses remain in operation within the works during the construction process, the Contractor shall ensure that access to these units remains available at all times.
- Highways in the vicinity of the works must be kept free from mud, debris and dust falling from vehicles or the wheels of vehicles connected with the works.
- Where the deposits of debris and mud are unavoidable, warning signs must be exhibited whilst work is in progress and affected carriageways/footways must be regularly cleaned.
- Do not scale from this drawing. Work only from stated dimensions or setting out details.
- The Contractor shall be responsible for the traffic safety and management associated with the construction of the works. The Contractor shall not commence any works on the existing highway until his traffic management proposals have been agreed with Oxfordshire County Council.
- Works on or adjacent to existing public highway shall be executed in accordance with the Traffic Safety Code for Roadworks and Chapter 8 of the Traffic Signs Manual.
- All levels are in metres above Ordnance Datum.
- Gullies, gully connections, drains, manholes, catchpits, soakaways, headwalls, and other drainage structures intended to convey only highway water are to be constructed in accordance with the specifications of Oxfordshire County Council and to the satisfaction of the Highway Inspector.
- All foul and storm water drains which are not subject to adoption as public sewers under a Section 104 Agreement must be constructed in accordance with the latest Building Regulations, BS8301, and, where appropriate, the relevant agreement certificates.
- All private lateral connections to public sewers shall be 150mmØ unless shown otherwise.
- Where grass service strips are present a requirement is to be placed on the owner/occupier to maintain the grassed areas and to ensure that no planting is carried out which is injurious to the underlying services. Vehicle crossings and personnel paths to be constructed to adoptable standards.
- There is to be no demarcation of service strips for the grassed area.
- 65mm minimum thickness tactile paving, coloured buff, shall be incorporated at all pedestrian crossing locations in accordance with the Department of Transport and Regions document 'Guidance On The Use Of Tactile Paving Surfaces' (DETR Nov.1998).
- Private drainage pipework to be 100mmØ unless shown otherwise on Engineering Layout Plans.
- 100mmØ private foul water & storm water drainage shall be laid no flatter than 1 in 80. 150mmØ pipework shall be laid no flatter than 1 in 150.
- Depths given for exposed brickwork, retaining walls & tanking represent maximum depths to proposed ground level.
- All covers within the Highway shall be in accordance with BS EN 124, stamped to indicate accreditation by BSI, LRQA, or SGSY. Covers shall be Class D400 in carriageways and parking areas. Where covers are positioned on bends or at road junctions D400 Saint Gobain with grip top coating or similar approved are to be used. Covers shall be Class B125 in footways.
- Root protection barriers to be used where trees are within 5m of a highway.

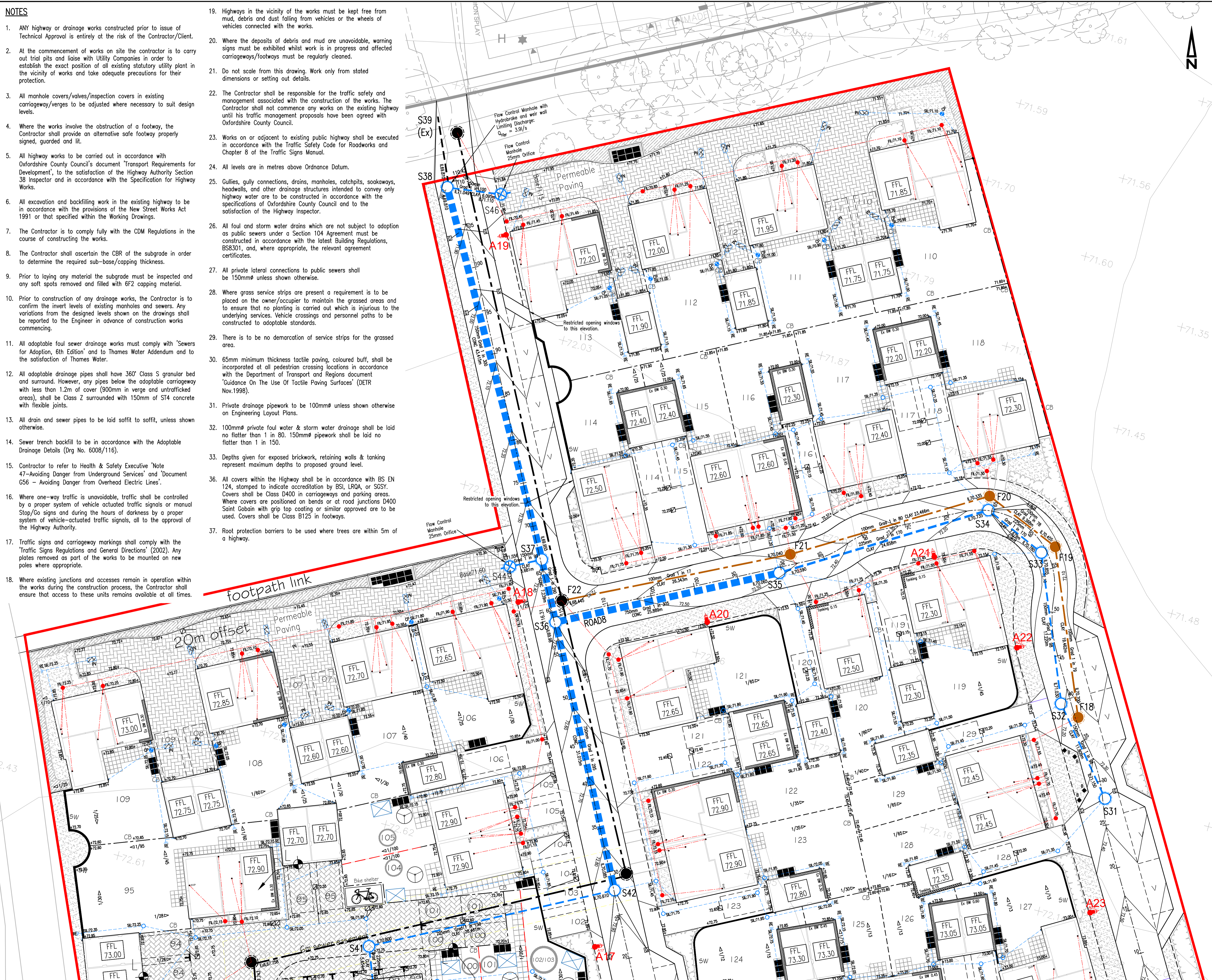

KEY:

- FFL 70.45
- +108.05
- 0.00
- 0.15
- 0.30
- 0.45
- 0.60
- 0.75
- 0.90
- 1.05
- 1.20
- 1.35
- 1.50
- 1.65
- 1.80
- 1.95
- 2.10
- 2.25
- 2.40
- 2.55
- 2.70
- 2.85
- 3.00
- 3.15
- 3.30
- 3.45
- 3.60
- 3.75
- 3.90
- 4.05
- 4.20
- 4.35
- 4.50
- 4.65
- 4.80
- 4.95
- 5.10
- 5.25
- 5.40
- 5.55
- 5.70
- 5.85
- 6.00
- 6.15
- 6.30
- 6.45
- 6.60
- 6.75
- 6.90
- 7.05
- 7.20
- 7.35
- 7.50
- 7.65
- 7.80
- 7.95
- 8.10
- 8.25
- 8.40
- 8.55
- 8.70
- 8.85
- 9.00
- 9.15
- 9.30
- 9.45
- 9.60
- 9.75
- 9.90
- 10.05
- 10.20
- 10.35
- 10.50
- 10.65
- 10.80
- 10.95
- 11.10
- 11.25
- 11.40
- 11.55
- 11.70
- 11.85
- 12.00
- 12.15
- 12.30
- 12.45
- 12.60
- 12.75
- 12.90
- 13.05
- 13.20
- 13.35
- 13.50
- 13.65
- 13.80
- 13.95
- 14.10
- 14.25
- 14.40
- 14.55
- 14.70
- 14.85
- 15.00
- 15.15
- 15.30
- 15.45
- 15.60
- 15.75
- 15.90
- 16.05
- 16.20
- 16.35
- 16.50
- 16.65
- 16.80
- 16.95
- 17.10
- 17.25
- 17.40
- 17.55
- 17.70
- 17.85
- 18.00
- 18.15
- 18.30
- 18.45
- 18.60
- 18.75
- 18.90
- 19.05
- 19.20
- 19.35
- 19.50
- 19.65
- 19.80
- 19.95
- 20.10
- 20.25
- 20.40
- 20.55
- 20.70
- 20.85
- 21.00
- 21.15
- 21.30
- 21.45
- 21.60
- 21.75
- 21.90
- 22.05
- 22.20
- 22.35
- 22.50
- 22.65
- 22.80
- 22.95
- 23.10
- 23.25
- 23.40
- 23.55
- 23.70
- 23.85
- 24.00
- 24.15
- 24.30
- 24.45
- 24.60
- 24.75
- 24.90
- 25.05
- 25.20
- 25.35
- 25.50
- 25.65
- 25.80
- 25.95
- 26.10
- 26.25
- 26.40
- 26.55
- 26.70
- 26.85
- 27.00
- 27.15
- 27.30
- 27.45
- 27.60
- 27.75
- 27.90
- 28.05
- 28.20
- 28.35
- 28.50
- 28.65
- 28.80
- 28.95
- 29.10
- 29.25
- 29.40
- 29.55
- 29.70
- 29.85
- 30.00
- 30.15
- 30.30
- 30.45
- 30.60
- 30.75
- 30.90
- 31.05
- 31.20
- 31.35
- 31.50
- 31.65
- 31.80
- 31.95
- 32.10
- 32.25
- 32.40
- 32.55
- 32.70
- 32.85
- 33.00
- 33.15
- 33.30
- 33.45
- 33.60
- 33.75
- 33.90
- 34.05
- 34.20
- 34.35
- 34.50
- 34.65
- 34.80
- 34.95
- 35.10
- 35.25
- 35.40
- 35.55
- 35.70
- 35.85
- 36.00
- 36.15
- 36.30
- 36.45
- 36.60
- 36.75
- 36.90
- 37.05
- 37.20
- 37.35
- 37.50
- 37.65
- 37.80
- 37.95
- 38.10
- 38.25
- 38.40
- 38.55
- 38.70
- 38.85
- 39.00
- 39.15
- 39.30
- 39.45
- 39.60
- 39.75
- 39.90
- 40.05
- 40.20
- 40.35
- 40.50
- 40.65
- 40.80
- 40.95
- 41.10
- 41.25
- 41.40
- 41.55
- 41.70
- 41.85
- 42.00
- 42.15
- 42.30
- 42.45
- 42.60
- 42.75
- 42.90
- 43.05
- 43.20
- 43.35
- 43.50
- 43.65
- 43.80
- 43.95
- 44.10
- 44.25
- 44.40
- 44.55
- 44.70
- 44.85
- 45.00
- 45.15
- 45.30
- 45.45
- 45.60
- 45.75
- 45.90
- 46.05
- 46.20
- 46.35
- 46.50
- 46.65
- 46.80
- 46.95
- 47.10
- 47.25
- 47.40
- 47.55
- 47.70
- 47.85
- 48.00
- 48.15
- 48.30
- 48.45
- 48.60
- 48.75
- 48.90
- 49.05
- 49.20
- 49.35
- 49.50
- 49.65
- 49.80
- 50.00

Type CLAY 225mm
 Type CLAY 150mm
 1 in 60 IL70.42
 1 in 80 IL70.42
 1 in 100 IL70.42
 1 in 120 IL70.42
 1 in 150 IL70.42
 1 in 200 IL70.42
 1 in 250 IL70.42
 1 in 300 IL70.42
 1 in 400 IL70.42
 1 in 500 IL70.42
 1 in 600 IL70.42
 1 in 800 IL70.42
 1 in 1000 IL70.42
 1 in 1200 IL70.42
 1 in 1500 IL70.42
 1 in 2000 IL70.42
 1 in 2500 IL70.42
 1 in 3000 IL70.42
 1 in 4000 IL70.42
 1 in 5000 IL70.42
 1 in 6000 IL70.42
 1 in 8000 IL70.42
 1 in 10000 IL70.42
 1 in 12000 IL70.42
 1 in 15000 IL70.42
 1 in 20000 IL70.42
 1 in 25000 IL70.42
 1 in 30000 IL70.42
 1 in 40000 IL70.42
 1 in 50000 IL70.42
 1 in 60000 IL70.42
 1 in 80000 IL70.42
 1 in 100000 IL70.42
 1 in 120000 IL70.42
 1 in 150000 IL70.42
 1 in 200000 IL70.42
 1 in 250000 IL70.42
 1 in 300000 IL70.42
 1 in 400000 IL70.42
 1 in 500000 IL70.42
 1 in 600000 IL70.42
 1 in 800000 IL70.42
 1 in 1000000 IL70.42
 1 in 1200000 IL70.42
 1 in 1500000 IL70.42
 1 in 2000000 IL70.42
 1 in 2500000 IL70.42
 1 in 3000000 IL70.42
 1 in 4000000 IL70.42
 1 in 5000000 IL70.42
 1 in 6000000 IL70.42
 1 in 8000000 IL70.42
 1 in 10000000 IL70.42
 1 in 12000000 IL70.42
 1 in 15000000 IL70.42
 1 in 20000000 IL70.42
 1 in 25000000 IL70.42
 1 in 30000000 IL70.42
 1 in 40000000 IL70.42
 1 in 50000000 IL70.42
 1 in 60000000 IL70.42
 1 in 80000000 IL70.42
 1 in 100000000 IL70.42
 1 in 120000000 IL70.42
 1 in 150000000 IL70.42
 1 in 200000000 IL70.42
 1 in 250000000 IL70.42
 1 in 300000000 IL70.42
 1 in 400000000 IL70.42
 1 in 500000000 IL70.42
 1 in 600000000 IL70.42
 1 in 800000000 IL70.42
 1 in 1000000000 IL70.42
 1 in 1200000000 IL70.42
 1 in 1500000000 IL70.42
 1 in 2000000000 IL70.42
 1 in 2500000000 IL70.42
 1 in 3000000000 IL70.42
 1 in 4000000000 IL70.42
 1 in 5000000000 IL70.42
 1 in 6000000000 IL70.42
 1 in 8000000000 IL70.42
 1 in 10000000000 IL70.42
 1 in 12000000000 IL70.42
 1 in 15000000000 IL70.42
 1 in 20000000000 IL70.42
 1 in 25000000000 IL70.42
 1 in 30000000000 IL70.42
 1 in 40000000000 IL70.42
 1 in 50000000000 IL70.42
 1 in 60000000000 IL70.42
 1 in 80000000000 IL70.42
 1 in 100000000000 IL70.42
 1 in 120000000000 IL70.42
 1 in 150000000000 IL70.42
 1 in 200000000000 IL70.42
 1 in 250000000000 IL70.42
 1 in 300000000000 IL70.42
 1 in 400000000000 IL70.42
 1 in 500000000000 IL70.42
 1 in 600000000000 IL70.42
 1 in 800000000000 IL70.42
 1 in 1000000000000 IL70.42
 1 in 1200000000000 IL70.42
 1 in 1500000000000 IL70.42
 1 in 2000000000000 IL70.42
 1 in 2500000000000 IL70.42
 1 in 3000000000000 IL70.42
 1 in 4000000000000 IL70.42
 1 in 5000000000000 IL70.42
 1 in 6000000000000 IL70.42
 1 in 8000000000000 IL70.42
 1 in 10000000000000 IL70.42
 1 in 12000000000000 IL70.42
 1 in 15000000000000 IL70.42
 1 in 20000000000000 IL70.42
 1 in 25000000000000 IL70.42
 1 in 30000000000000 IL70.42
 1 in 40000000000000 IL70.42
 1 in 50000000000000 IL70.42
 1 in 60000000000000 IL70.42
 1 in 80000000000000 IL70.42
 1 in 100000000000000 IL70.42
 1 in 120000000000000 IL70.42
 1 in 150000000000000 IL70.42
 1 in 200000000000000 IL70.42
 1 in 250000000000000 IL70.42
 1 in 300000000000000 IL70.42
 1 in 400000000000000 IL70.42
 1 in 500000000000000 IL70.42
 1 in 600000000000000 IL70.42
 1 in 800000000000000 IL70.42
 1 in 1000000000000000 IL70.42
 1 in 1200000000000000 IL70.42
 1 in 1500000000000000 IL70.42
 1 in 2000000000000000 IL70.42
 1 in 2500000000000000 IL70.42
 1 in 3000000000000000 IL70.42
 1 in 4000000000000000 IL70.42
 1 in 5000000000000000 IL70.42
 1 in 6000000000000000 IL70.42
 1 in 8000000000000000 IL70.42
 1 in 10000000000000000 IL70.42
 1 in 12000000000000000 IL70.42
 1 in 15000000000000000 IL70.42
 1 in 20000000000000000 IL70.42
 1 in 25000000000000000 IL70.42
 1 in 30000000000000000 IL70.42
 1 in 40000000000000000 IL70.42
 1 in 50000000000000000 IL70.42
 1 in 60000000000000000 IL70.42
 1 in 80000000000000000 IL70.42
 1 in 100000000000000000 IL70.42
 1 in 120000000000000000 IL70.42
 1 in 150000000000000000 IL70.42
 1 in 200000000000000000 IL70.42
 1 in 250000000000000000 IL70.42
 1 in 300000000000000000 IL70.42
 1 in 400000000000000000 IL70.42
 1 in 500000000000000000 IL70.42
 1 in 600000000000000000 IL70.42
 1 in 800000000000000000 IL70.42
 1 in 1000000000000000000 IL70.42
 1 in 1200000000000000000 IL70.42
 1 in 1500000000000000000 IL70.42
 1 in 2000000000000000000 IL70.42
 1 in 2500000000000000000 IL70.42
 1 in 3000000000000000000 IL70.42
 1 in 4000000000000000000 IL70.42
 1 in 5000000000000000000 IL70.42
 1 in 6000000000000000000 IL70.42
 1 in 8000000000000000000 IL70.42
 1 in 10000000000000000000 IL70.42
 1 in 12000000000000000000 IL70.42
 1 in 15000000000000000000 IL70.42
 1 in 20000000000000000000 IL70.42
 1 in 25000000000000000000 IL70.42
 1 in 30000000000000000000 IL70.42
 1 in 40000000000000000000 IL70.42
 1 in 50000000000000000000 IL70.42
 1 in 60000000000000000000 IL70.42
 1 in 80000000000000000000 IL70.42
 1 in 100000000000000000000 IL70.42
 1 in 120000000000000000000 IL70.42
 1 in 150000000000000000000 IL70.42
 1 in 200000000000000000000 IL70.42
 1 in 250000000000000000000 IL70.42
 1 in 300000000000000000000 IL70.42
 1 in 400000000000000000000 IL70.42
 1 in 500000000000000000000 IL70.42
 1 in 600000000000000000000 IL70.42
 1 in 800000000000000000000 IL70.42
 1 in 1000000000000000000000 IL70.42
 1 in 1200000000000000000000 IL70.42
 1 in 1500000000000000000000 IL70.42
 1 in 2000000000000000000000 IL70.42
 1 in 2500000000000000000000 IL70.42
 1 in 3000000000000000000000 IL70.42
 1 in 4000000000000000000000 IL70.42
 1 in 5000000000000000000000 IL70.42
 1 in 6000000000000000000000 IL70.42
 1 in 8000000000000000000000 IL70.42
 1 in 10000000000000000000000 IL70.42
 1 in 12000000000000000000000 IL70.42
 1 in 15000000000000000000000 IL70.42
 1 in 20000000000000000000000 IL70.42
 1 in 25000000000000000000000 IL70.42
 1 in 30000000000000000000000 IL70.42
 1 in 40000000000000000000000 IL70.42
 1 in 50000000000000000000000 IL70.42
 1 in 60000000000000000000000 IL70.42
 1 in 80000000000000000000000 IL70.42
 1 in 100000000000000000000000 IL70.42
 1 in 120000000000000000000000 IL70.42
 1 in 150000000000000000000000 IL70.42
 1 in 200000000000000000000000 IL70.42
 1 in 250000000000000000000000 IL70.42
 1 in 300000000000000000000000 IL70.42
 1 in 400000000000000000000000 IL70.42
 1 in 500000000000000000000000 IL70.42
 1 in 600000000000000000000000 IL70.42
 1 in 800000000000000000000000 IL70.42
 1 in 1000000000000000000000000 IL70.42
 1 in 1200000000000000000000000 IL70.42
 1 in 1500000000000000000000000 IL70.42
 1 in 2000000000000000000000000 IL70.42
 1 in 2500000000000000000000000 IL70.42
 1 in 3000000000000000000000000 IL70.42
 1 in 4000000000000000000000000 IL70.42
 1 in 5000000000000000000000000 IL70.42
 1 in 6000000000000000000000000 IL70.42
 1 in 8000000000000000000000000 IL70.42
 1 in 10000000000000000000000000 IL70.42
 1 in 12000000000000000000000000 IL70.42
 1 in 15000000000000000000000000 IL70.42
 1 in 20000000000000000000000000 IL70.42
 1 in 25000000000000000000000000 IL70.42
 1 in 30000000000000000000000000 IL70.42
 1 in 40000000000000000000000000 IL70.42
 1 in 50000000000000000000000000 IL70.42
 1 in 60000000000000000000000000 IL70.42
 1 in 80000000000000000000000000 IL70.42
 1 in 100000000000000000000000000 IL70.42
 1 in 120000000000000000000000000 IL70.42
 1 in 150000000000000000000000000 IL70.42
 1 in 200000000000000000000000000 IL70.42
 1 in