

DO NOT SCALE

- NOTES
1. ALL DIMENSIONS ARE IN METRES UNLESS OTHERWISE STATED.
  2. PAVE DIMETERS ARE IN MILLIMETRES.
  3. THIS DRAWING SHOULD BE READ IN CONJUNCTION WITH ALL OTHER RELEVANT ENGINEERING DETAILS, DRAWINGS & SPECIFICATIONS.
  4. ALL TOOL SIGNER WORKS ARE TO BE CARRIED OUT IN ACCORDANCE WITH SIGNER'S RESPONSIBILITIES AND THEIR LOCATION COORDINATES.
  5. FROM TO CONSTRUCTION WORKS COMMENCE ON SITE, THE RESPONSIBILITY FOR THE ACCURACY OF THE LOCATION OF ANY SERVICES SHOWN ON ANY DRAWINGS ARE INDICATED ONLY, IT WILL BE THE RESPONSIBILITY OF THE CONTRACTOR TO LOCATE AND MAKE THE EFFECT OF ANY SERVICES PRIOR TO COMMENCING ANY CONSTRUCTION WORKS PRIOR TO COMMENCING ANY CONSTRUCTION.
  6. ANY REVISIONS/GENERAL WORKS REQUIRED ARE TO BE COMPLETED IN ADVANCE OF THE RELEVANT STATIONING UNDERPASSES.
  7. FOR CONSTRUCTION DETAILS REFER TO THE RELEVANT APPROPRIATE DRAWINGS.
  8. THE CONTRACTOR IS TO BE RESPONSIBLE FOR THE PROTECTION OF ALL SERVICES AND UTILITIES PRIOR TO THE COMMENCEMENT OF ANY WORKS, SO THAT "AS BUILT" DRAWINGS CAN BE PREPARED UPON COMPLETION OF THE PROJECT.
  9. ALL PITS SHALL BE LID WITHIN 10 METRES OF THE ROADWAY.
  10. PITS SHALL BE LID WITHIN 10 METRES OF THE ROADWAY.
  11. ALL PITS SHALL BE LID WITHIN 10 METRES OF THE ROADWAY.
  12. ALL PITS SHALL BE LID WITHIN 10 METRES OF THE ROADWAY.
  13. ALL PITS SHALL BE LID WITHIN 10 METRES OF THE ROADWAY.
  14. ALL PITS SHALL BE LID WITHIN 10 METRES OF THE ROADWAY.
  15. ALL PITS SHALL BE LID WITHIN 10 METRES OF THE ROADWAY.
  16. ALL PITS SHALL BE LID WITHIN 10 METRES OF THE ROADWAY.
  17. ALL PITS SHALL BE LID WITHIN 10 METRES OF THE ROADWAY.
  18. ALL PITS SHALL BE LID WITHIN 10 METRES OF THE ROADWAY.
  19. ALL PITS SHALL BE LID WITHIN 10 METRES OF THE ROADWAY.
  20. ALL PITS SHALL BE LID WITHIN 10 METRES OF THE ROADWAY.

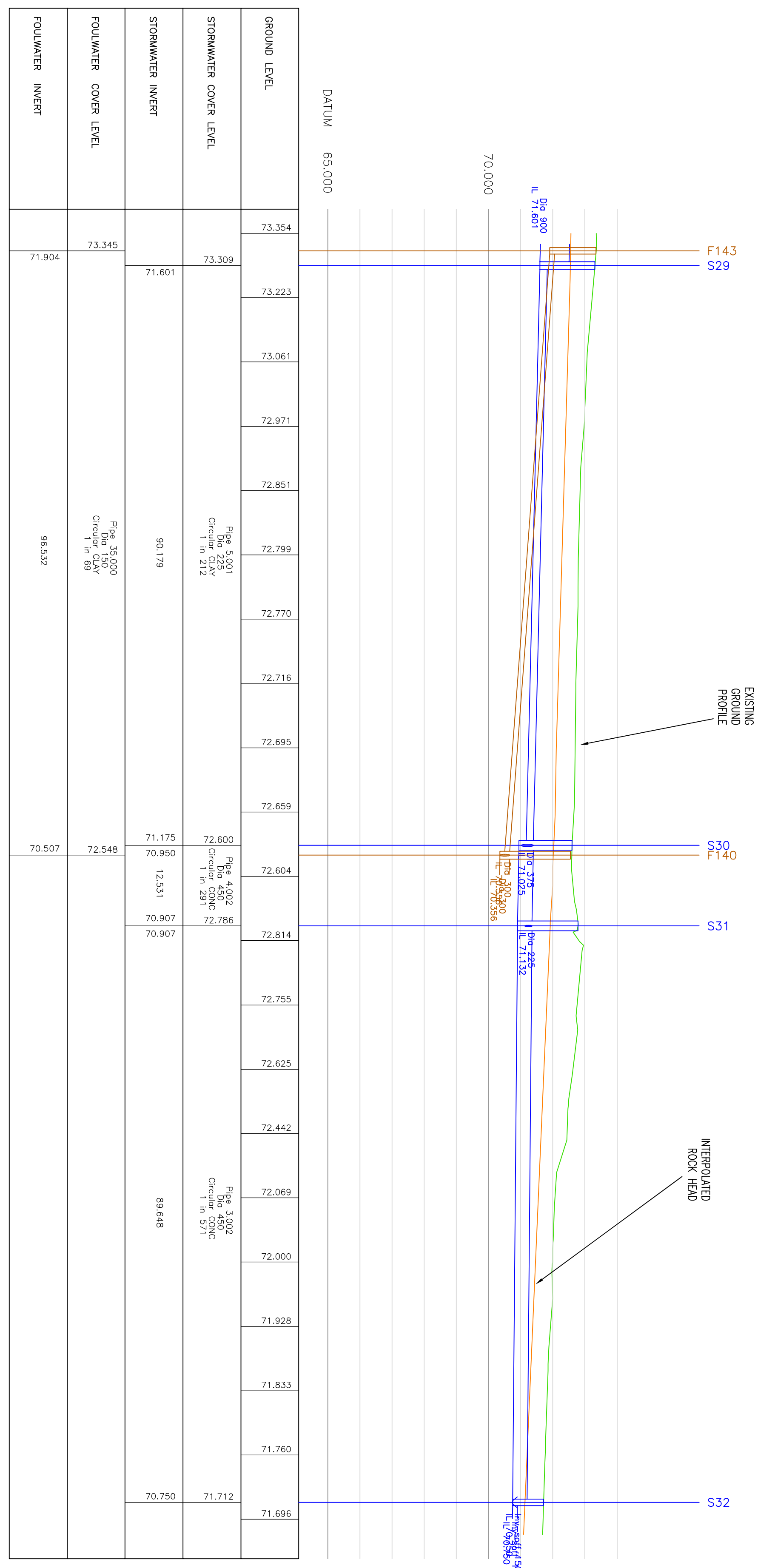
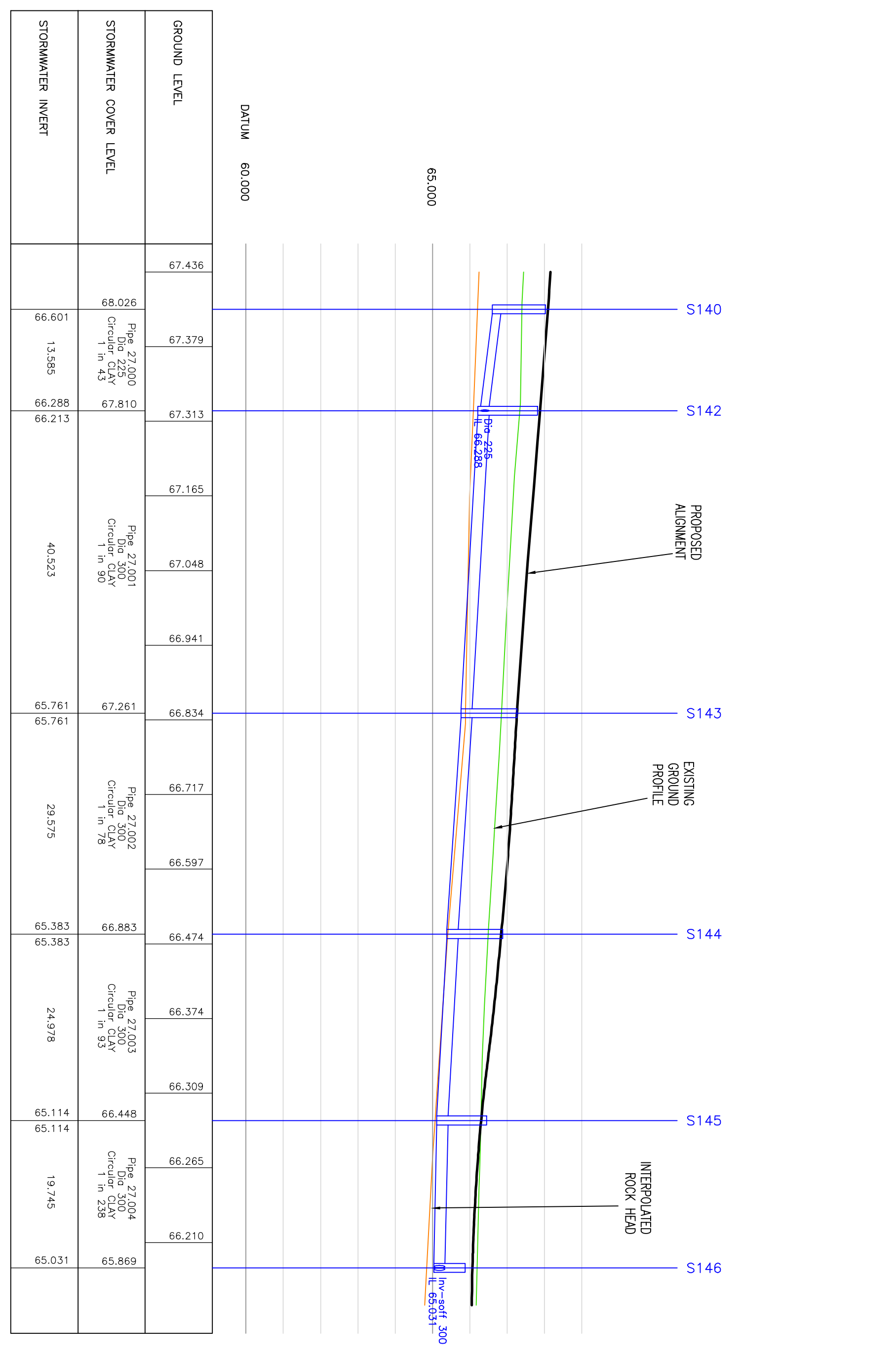

NO	DATE	BY	DESCRIPTION
1	18/02/10	AW	ISSUE FOR CONSTRUCTION
2	23/11/09	AW	ISSUE FOR CONSTRUCTION
3	02/11/09	AW	ISSUE FOR CONSTRUCTION

FOR TECHNICAL APPROVAL

WSP  
WSP Group plc  
100, The Quadrant, Bournemouth, Dorset, BH1 1GU  
Tel: +44 (0)1202 318800 Fax: +44 (0)1202 318700  
http://www.wspgroup.com

CUSTOMER: COUNTRYSIDE PROPERTIES

PROJECT: SOUTH WEST BICESTER  
BICESTER, OXFORDSHIRE

DATE: 18/02/2010

SCALE: 1:100

DATE: 18/02/2010

PROJECT: SOUTH WEST BICESTER  
BICESTER, OXFORDSHIRE

DATE: 18/02/2010

SCALE: 1:100

DATE: 18/02/2010