

THIS DRAWING IS IN THE PRELIMINARY STAGE AND SHOULD NOT BE RELIED UPON FOR CONSTRUCTION OR COST COMMITMENT PURPOSES

DO NOT SCALE

- NOTES:**
1. THIS DRAWING SHOULD BE READ IN CONJUNCTION WITH ALL PREVIOUS DRAWINGS AND SPECIFICATIONS.
 2. ALL DIMENSIONS ARE IN METRES UNLESS OTHERWISE STATED. DIMENSIONS ALIVE ABOVE DIMENSIONS ARE ALSO IN METRES.
 3. EXISTING LEVELS AND DIMENSIONS ARE TO BE CHECKED AND CORRECTED ON SITE.
 4. ANY DISCREPANCIES SHOULD BE REPORTED TO THE PROJECT/ENGINEER IMMEDIATELY. SIGNATURE OF THE PROJECT/ENGINEER IS REQUIRED FOR ANY CORRECTIONS TO BE MADE TO THIS DRAWING. ANY CORRECTIONS TO BE MADE TO THIS DRAWING MUST BE MADE IN ADVANCE OF THE RELEVANT SIGNATURES.
 5. THE LOCATION OF ANY SERVICES SHOWN ON THIS DRAWING ARE INDICATIVE ONLY. IT WILL BE THE RESPONSIBILITY OF THE CONTRACTOR TO LOCATE AND PROTECT THE EXISTING SERVICES TO BE MAINTAINED THROUGHOUT THE WORKS. THE CONTRACTOR SHALL BE RESPONSIBLE FOR THE PROTECTION OF ANY SERVICES TO BE MAINTAINED THROUGHOUT THE WORKS.
 6. ANY DISCREPANCIES SHOULD BE REPORTED TO THE PROJECT/ENGINEER IMMEDIATELY. SIGNATURE OF THE PROJECT/ENGINEER IS REQUIRED FOR ANY CORRECTIONS TO BE MADE TO THIS DRAWING. ANY CORRECTIONS TO BE MADE TO THIS DRAWING MUST BE MADE IN ADVANCE OF THE RELEVANT SIGNATURES.
 7. ANY DISCREPANCIES SHOULD BE REPORTED TO THE PROJECT/ENGINEER IMMEDIATELY. SIGNATURE OF THE PROJECT/ENGINEER IS REQUIRED FOR ANY CORRECTIONS TO BE MADE TO THIS DRAWING. ANY CORRECTIONS TO BE MADE TO THIS DRAWING MUST BE MADE IN ADVANCE OF THE RELEVANT SIGNATURES.
 8. THE LOCATION OF ANY SERVICES SHOWN ON THIS DRAWING ARE INDICATIVE ONLY. IT WILL BE THE RESPONSIBILITY OF THE CONTRACTOR TO LOCATE AND PROTECT THE EXISTING SERVICES TO BE MAINTAINED THROUGHOUT THE WORKS. THE CONTRACTOR SHALL BE RESPONSIBLE FOR THE PROTECTION OF ANY SERVICES TO BE MAINTAINED THROUGHOUT THE WORKS.
 9. STREET LIGHTING COLUMNS TO BE LOCATED AT BACK OF CURB AT 2.0m FROM KERB.
 10. REFER TO SIGN FACE DWG NO: 1903/TS/002 AND BOLLARD DWG NO: 1903/TS/210.
 11. REFER TO SIGN FACE DWG NO: 1903/TS/002 AND BOLLARD DWG NO: 1903/TS/210.
 12. STREET LIGHTING LAMP TO BE DESIGNED ON WORKSHEET LATER DATE.

LAMP SPECIFICATION

TRAFFIC SIGNS - DIMENSIONS REFER TO TSK&D DRAWING REFERENCE NO. 888

LAMP SPECIFICATION

TRAFFIC SIGNS - DIMENSIONS REFER TO TSK&D DRAWING REFERENCE NO. 888

LAMP SPECIFICATION

TRAFFIC SIGNS - DIMENSIONS REFER TO TSK&D DRAWING REFERENCE NO. 888

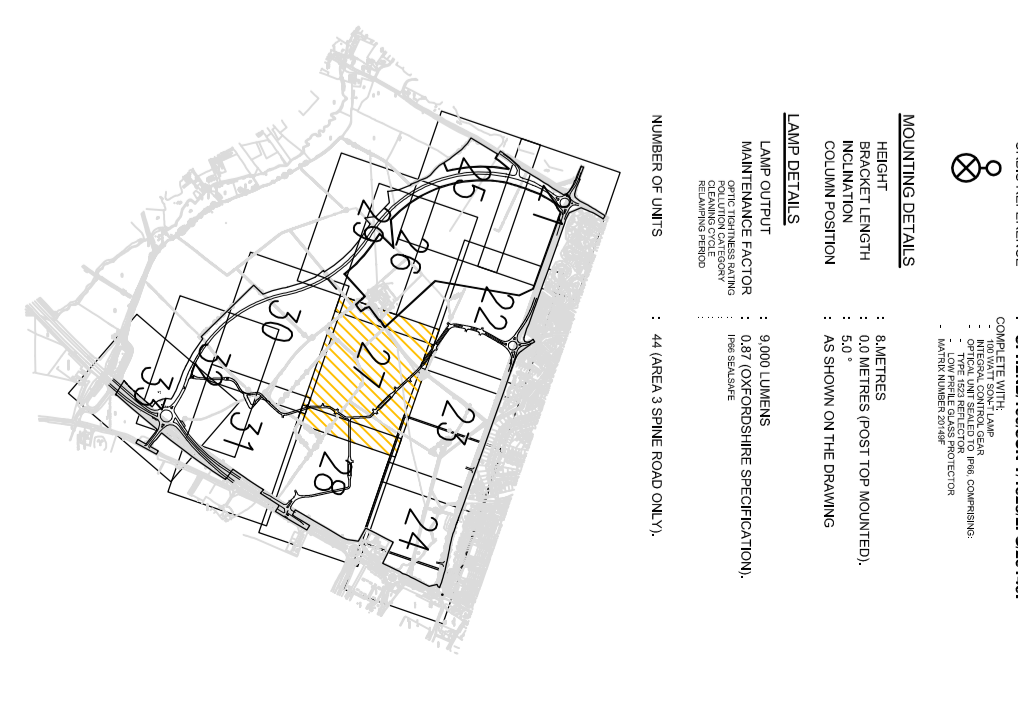

FOR TECHNICAL APPROVAL

NO.	DATE	BY	DESCRIPTION
1	18/02/10	JM	ISSUED FOR APPROVAL WITH COC COMMENTS
2	22/02/10	JP	REVISED
3	23/02/10	JP	REVISED
4	23/02/10	JP	REVISED
5	23/02/10	JP	REVISED
6	23/02/10	JP	REVISED
7	23/02/10	JP	REVISED
8	23/02/10	JP	REVISED
9	23/02/10	JP	REVISED
10	23/02/10	JP	REVISED
11	23/02/10	JP	REVISED
12	23/02/10	JP	REVISED
13	23/02/10	JP	REVISED
14	23/02/10	JP	REVISED
15	23/02/10	JP	REVISED
16	23/02/10	JP	REVISED
17	23/02/10	JP	REVISED
18	23/02/10	JP	REVISED
19	23/02/10	JP	REVISED
20	23/02/10	JP	REVISED
21	23/02/10	JP	REVISED
22	23/02/10	JP	REVISED
23	23/02/10	JP	REVISED
24	23/02/10	JP	REVISED
25	23/02/10	JP	REVISED
26	23/02/10	JP	REVISED
27	23/02/10	JP	REVISED
28	23/02/10	JP	REVISED
29	23/02/10	JP	REVISED
30	23/02/10	JP	REVISED
31	23/02/10	JP	REVISED
32	23/02/10	JP	REVISED
33	23/02/10	JP	REVISED
34	23/02/10	JP	REVISED
35	23/02/10	JP	REVISED
36	23/02/10	JP	REVISED
37	23/02/10	JP	REVISED
38	23/02/10	JP	REVISED
39	23/02/10	JP	REVISED
40	23/02/10	JP	REVISED
41	23/02/10	JP	REVISED
42	23/02/10	JP	REVISED
43	23/02/10	JP	REVISED
44	23/02/10	JP	REVISED
45	23/02/10	JP	REVISED
46	23/02/10	JP	REVISED
47	23/02/10	JP	REVISED
48	23/02/10	JP	REVISED
49	23/02/10	JP	REVISED
50	23/02/10	JP	REVISED
51	23/02/10	JP	REVISED
52	23/02/10	JP	REVISED
53	23/02/10	JP	REVISED
54	23/02/10	JP	REVISED
55	23/02/10	JP	REVISED
56	23/02/10	JP	REVISED
57	23/02/10	JP	REVISED
58	23/02/10	JP	REVISED
59	23/02/10	JP	REVISED
60	23/02/10	JP	REVISED
61	23/02/10	JP	REVISED
62	23/02/10	JP	REVISED
63	23/02/10	JP	REVISED
64	23/02/10	JP	REVISED
65	23/02/10	JP	REVISED
66	23/02/10	JP	REVISED
67	23/02/10	JP	REVISED
68	23/02/10	JP	REVISED
69	23/02/10	JP	REVISED
70	23/02/10	JP	REVISED
71	23/02/10	JP	REVISED
72	23/02/10	JP	REVISED
73	23/02/10	JP	REVISED
74	23/02/10	JP	REVISED
75	23/02/10	JP	REVISED
76	23/02/10	JP	REVISED
77	23/02/10	JP	REVISED
78	23/02/10	JP	REVISED
79	23/02/10	JP	REVISED
80	23/02/10	JP	REVISED
81	23/02/10	JP	REVISED
82	23/02/10	JP	REVISED
83	23/02/10	JP	REVISED
84	23/02/10	JP	REVISED
85	23/02/10	JP	REVISED
86	23/02/10	JP	REVISED
87	23/02/10	JP	REVISED
88	23/02/10	JP	REVISED
89	23/02/10	JP	REVISED
90	23/02/10	JP	REVISED
91	23/02/10	JP	REVISED
92	23/02/10	JP	REVISED
93	23/02/10	JP	REVISED
94	23/02/10	JP	REVISED
95	23/02/10	JP	REVISED
96	23/02/10	JP	REVISED
97	23/02/10	JP	REVISED
98	23/02/10	JP	REVISED
99	23/02/10	JP	REVISED
100	23/02/10	JP	REVISED

WSP

Whitlands (Local) (Signs) (TS) (Bicester) (Oxfordshire) (R27) (44)

Tel: +44 (0)1295 318800 Fax: +44 (0)1295 318100

http://www.wspgroup.com

COUNTRYSIDE PROPERTIES

SOUTH WEST BICESTER

BICESTER, OXFORDSHIRE

SIGNS AND LINES LAYOUT

REF: 11-01

Whitlands Farm

11011903 1903/TS/001 8

© WSP Group plc