

DO NOT SCALE

NOTES

1. ALL DIMENSIONS ARE IN METRES UNLESS OTHERWISE STATED. SIMILARLY ALL LEVELS ABOVE DATUM ARE ALSO IN METRES.
2. PIPE DIAMETERS ARE IN MILLIMETRES.
3. THIS DRAWING SHOULD BE READ IN CONJUNCTION WITH ALL OTHER RELEVANT ENGINEERING DETAILS, DRAWINGS & SPECIFICATIONS.
4. ALL FOUL WATER WORKS ARE TO BE CARRIED OUT IN ACCORDANCE WITH STANDARDS FOR ADOPTION 6TH EDITION.
5. PRIOR TO CONSTRUCTION WORKS COMMENCING ON SITE, THE LOCATION OF ANY SERVICES SHOWN ON THIS DRAWING ARE INDICATIVE ONLY. IT SHALL BE THE RESPONSIBILITY OF THE CONTRACTOR TO LOCATE AND PROBE THE EXISTING SERVICES PRIOR TO COMMENCING ANY CONSTRUCTION.
6. ANY RESPONSIBILITY FOR SERVICES SHOWN ARE TO BE ACCEPTED IN ADVANCE OF THE PROPOSED WORKS AND IN ACCORDANCE WITH THE RELEVANT STATUTORY REQUIREMENTS AND RECOMMENDATIONS.
7. THE CONTRACTOR IS TO KEEP A RECORD OF ANY UNWARRANTED DRINKING, SO THAT AS BUILT DRAWINGS CAN BE PREPARED UPON COMPLETION OF THE PROJECT.
8. ALL PIPES SHALL BE Laid SOUTH TO NORTH WITH OUTSLOPING PIPES UNLESS OTHERWISE STATED.
9. CLASS 5 BED & SURROUND TO BE USED WHERE COVER TO PIPE IS GREATER THAN 1.2M IN HEIGHTS OR 0.5M IN OPEN FLEETS UNLESS OTHERWISE STATED. ALL DIMENSIONS WILL BE REFERRED TO STANDARD DETAIL.
10. SURFACE LINE INTERPOLATED ROCK HEAD IS INDICATIVE ONLY NOT TO BE USED FOR COSTING.

PHASE 3

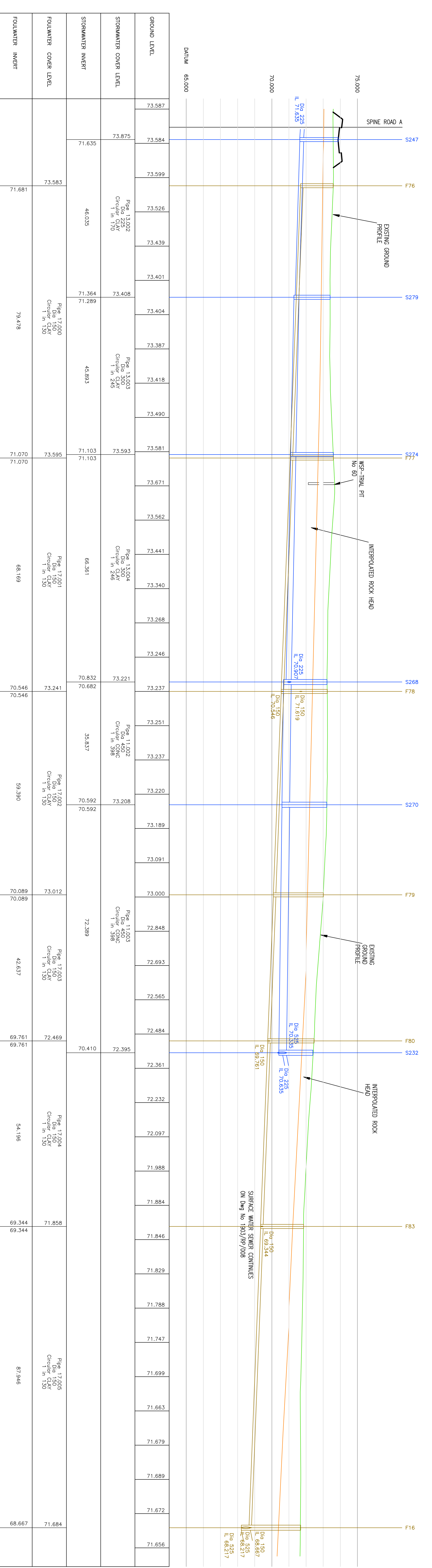

PHASE 3

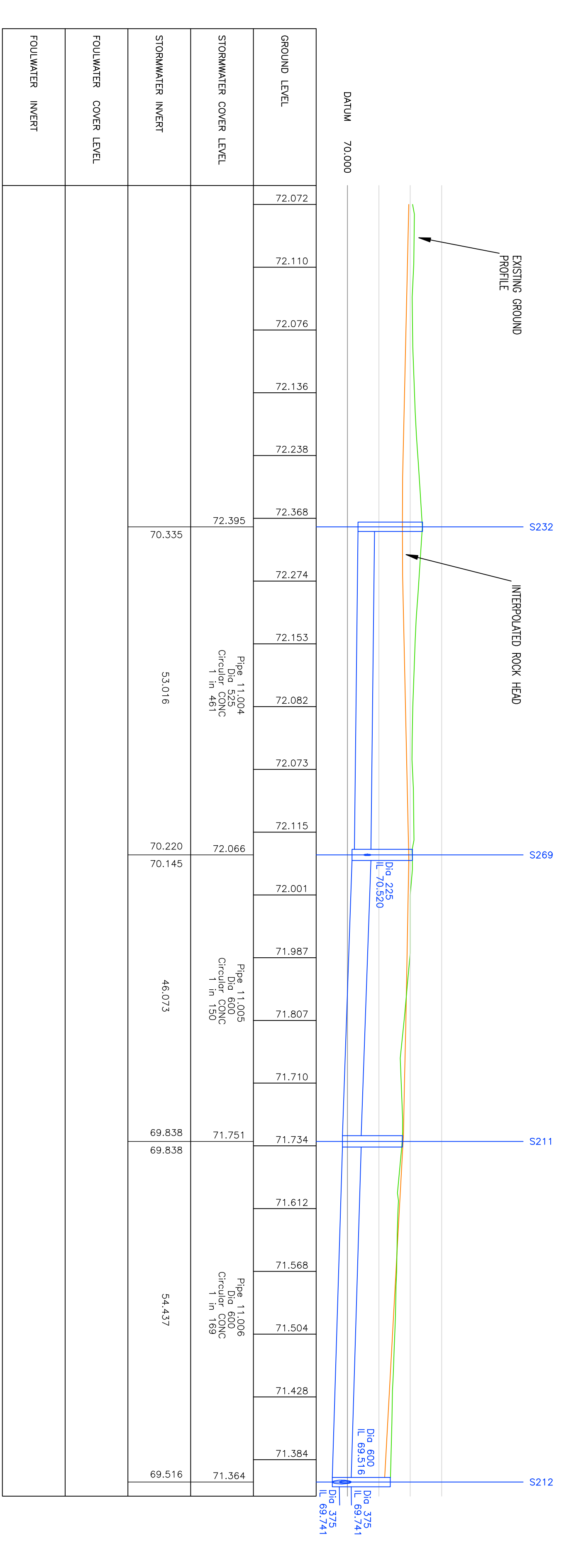

LONGITUDINAL SECTION

SCALE 1:500 HORIZONTAL
1:100 VERTICAL

FOR LAYOUT DETAILS REFER TO DWG NO 1903/07/07

FOR INFORMATION ONLY

| | | | |
|------|------------|----|-------|
| DATE | 11/09/2020 | BY | CH/ST |
| DATE | 08/09/2020 | BY | CH/ST |

WSP

Head Office: 100, South Quay, Southend-on-Sea, Essex, SSO 1JQ, UK
Tel: +44 (0)206 316000 Fax: +44 (0)206 316000
www.wspgroup.com

COUNTY/CITY PROPERTIES

SOUTH WEST ROBERTS
BRISTOL, GLOUCESTERSHIRE

FOUL AND SURFACE WATER DRAINAGE
NORTHERN CATCHMENT
LONGITUDINAL SECTION

DATE: 11/09/2020
DRAWN BY: CH/ST
CHECKED BY: CH/ST
DATE: 08/09/2020
DRAWN BY: CH/ST
CHECKED BY: CH/ST

PROJECT NO: 1903/09/012
SHEET NO: A

© WSP Group plc