

DO NOT SCALE

NOTES:

1. ALL DIMENSIONS ARE IN MILLIMETRES UNLESS OTHERWISE STATED.
2. INTERCEPTOR TO BE FITTED WITH SOLAR POWERED GSM ALARM SYSTEM, FOR DETAILS REFER TO CONDOR RECOMMENDATIONS.
3. INTERCEPTOR TO BE CONDOR FULL RETENTION TYPE CNS30S OR SIMILAR, FOR MAXIMUM CATCHMENT AREA OF 1667m².
4. INSTALLATION OF PETROL INTERCEPTORS TO BE IN ACCORDANCE WITH MANUFACTURERS RECOMMENDATIONS.
5. FOR DETAILS OF VENTING REFER TO DRAWING 1903/SD/021. VENTING REQUIREMENTS TO BE IN ACCORDANCE WITH BS8301 AND NATIONAL BUILDING SPECIFICATIONS R12/781

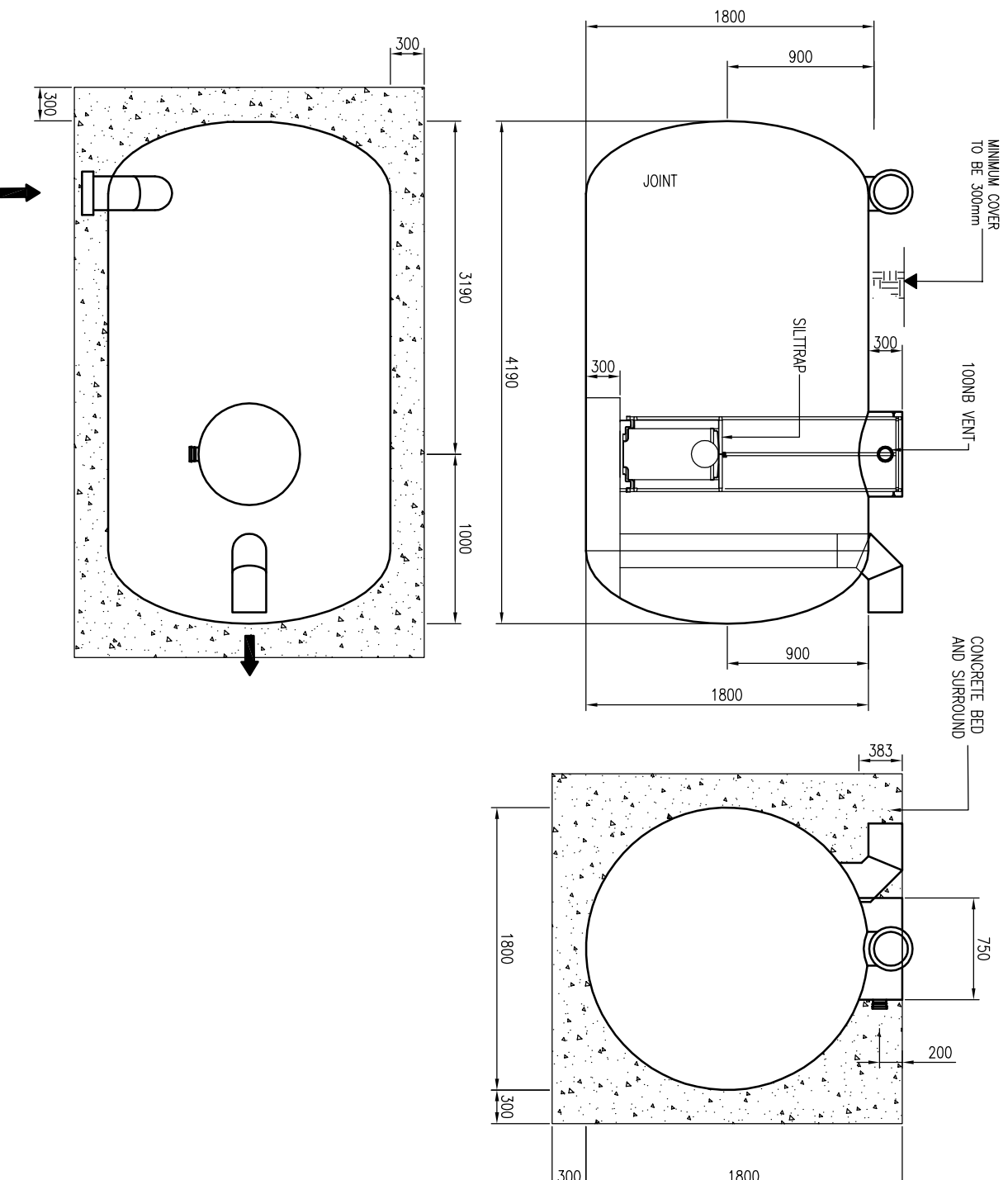

REV	DATE	BY	DESCRIPTION	CHK	APP
B	16/09/08	ACK	SIZE OF INTERCEPTOR AMENDED, TELEMETRY DETAILS ADDED	JM	JP
A	12/03/08	JH	FIRST ISSUE	JM	JP

DRAWING STATUS:
FOR INFORMATION ONLY



Mounbatten House, Basing View, Basingstoke, Hampshire RG21 4HU
Tel: +44 (0)1256 318800 Fax: +44 (0)1256 318700
<http://www.wspgroup.com>

CLIENT:
COUNTRYSIDE PROPERTIES

ARCHITECT:

PROJECT:

**SOUTH WEST BICESTER
BICESTER, OXFORDSHIRE**

TITLE:
**SECTION 278 WORKS
A41 ROUNDABOUT
PETROL INTERCEPTOR DETAIL 1**

SCALE @ A3	CHECKED:	APPROVED:
N.T.S.	JM	JDP
CAD FILE:	DESIGN/DRAWN:	DATE:
1903-SD-026.DWG	JH	March 08
PROJECT No:	DRAWING No:	REV:
11011903	1903/SD/026	B

© WSP Group plc