

SECTION A-A  
1 : 50

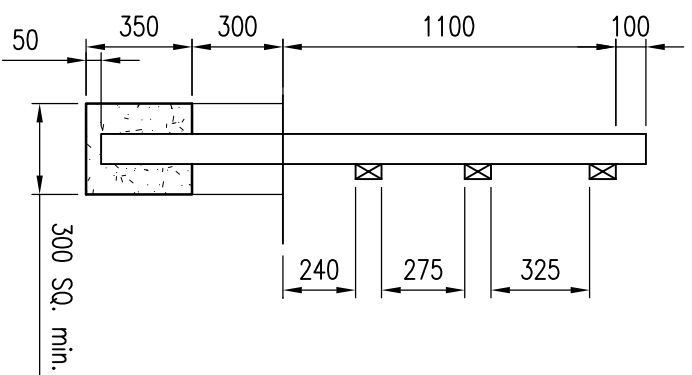

SECTION THROUGH CENTRELINE OF MAIN POSTS  
1 : 25

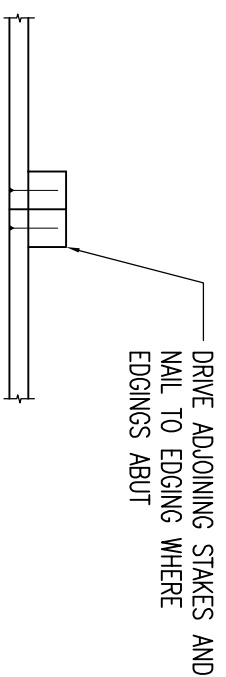

DETAIL 01 (PLAN)  
1 : 10

NOTES:

**DO NOT SCALE**

1. ALL DIMENSIONS ARE IN MILLIMETRES UNLESS STATED OTHERWISE.
2. THIS DRAWING SHOULD BE READ IN CONJUNCTION WITH ALL OTHER RELEVANT ENGINEERING DETAILS, DRAWINGS & SPECIFICATIONS.
3. ANY DISCREPANCIES SHOULD BE REPORTED TO THE SUPERVISION CONSULTANT IMMEDIATELY, SO CLARIFICATION CAN BE SOUGHT PRIOR TO THE COMMENCEMENT OF WORKS.
4. TIMBER TO BE TREATED IN ACCORDANCE WITH CLAUSE 3111.
5. RISER BOARDS & STRINGERS TO BE NAILED TO PEGS USING 2 No.4x50 NAILS GALVANISED TO B.S.729.
6. WHERE STRINGERS ARE BUTT JOINED 900x275x25 BACKSPINEPIECE TO BE PROVIDED, FIXED WITH 12 NO.75mm GALVANISED NAILS.

REV	DATE	BY	DESCRIPTION	CHK	APP
A	05/12/08	JH	FIRST ISSUE	JWM	GH

DRAWING STATUS:  
**FOR TECHNICAL APPROVAL**



Mountbatten House, Basing View, Basingstoke, Hampshire RG21 4HU  
Tel: +44 (0)1256 318800 Fax: +44 (0)1256 318700  
<http://www.wspgroup.com>

CLIENT:  
COUNTRYSIDE PROPERTIES

ARCHITECT:

PROJECT:  
SOUTH WEST BICESTER  
BICESTER, OXFORDSHIRE

TITLE:  
ON SITE WORKS  
WOODEN POST AND 3 RAIL FENCE

SCALE @ A3	N.T.S	CHECKED:	GH	APPROVED:	JAM
CAD FILE	1903-SD-119	DESIGN/DRAWN:	JH	DATE:	Dec-08
PROJECT No:	11011903	DRAWING No:	1903/SD/119	REV:	A