

OS map data reproduced by permission of Ordnance Survey on behalf of HAMS. © Crown copyright 2015. All rights reserved. Ordnance Survey license number 0100040692

SCALE 1:250
@ A1 SHEET SIZE

	PIPE-1	
	UPSTREAM	DOWNSTREAM
EASTINGS:	177002.452	176997.661
NORTHINGS:	141665.278	141646.174
EXISTING DITCH LEVELS:	70.260	70.259
PIPE INVERT:	70.260	70.217
HEADWALL:	NOTE 3	
PIPE TYPE:	300mm CARRIER PIPE	
MINIMUM COVER:	1.0m	

NOTES:

- REFER TO STANDARD DETAIL DRAWING 133735_RW-EWR-XX-XX-DR-CH-000131 FOR PIPE SURROUND AND BEDDING TYPES.
- THE EXISTING DITCH INVERT LEVELS ARE TAKEN FROM AVAILABLE TOPOGRAPHIC SURVEY INFORMATION, WHERE AVAILABLE. THE DELIVERY TEAM WILL NEED TO CONFIRM DITCH LEVELS BEFORE INSTALLING CULVERT. ANY DISCREPANCIES IN LEVEL WILL NEED TO BE DISCUSSED WITH THE DESIGNER.
- PROPOSED COMPOUND ACCESS EARTHWORKS TO EXTEND INTO THE EXISTING DITCH. CULVERT PIPE TO EXTEND A MINIMUM OF 100mm BEYOND THE TOE OF THE EARTHWORKS.

CULVERT REQUIREMENTS

SAFETY, HEALTH AND ENVIRONMENTAL INFORMATION

THE WORKS ARE TO BE UNDERTAKEN BY A COMPETENT DELIVERY TEAM, AND THEREFORE ONLY EXCEPTIONAL RISKS RELATING TO THE WORKS ASSOCIATED WITH THIS DRAWING ARE IDENTIFIED BELOW. FOR FURTHER DETAILS AND PROPOSED SAFETY MEASURES REFER 'EWR PHASE 2 HAZARD LOG WORKING COPY' EB DOC. REF: 133735-NWR-RSA-SSD-000001.

ID	HAZARD DESCRIPTION
EWR2-HAZ-02095	PRESENCE OF BURIED LV LINE

INDICATES PROJECT RISKS (EWR2-DRIS-)
 INDICATES H&S RISKS (EWR2-HAZ-)

OS map data reproduced by permission of Ordnance Survey on behalf of HAMS. © Crown copyright 2015. All rights reserved. Ordnance Survey license number 0100040692

SCALE 1:250
@ A1 SHEET SIZE

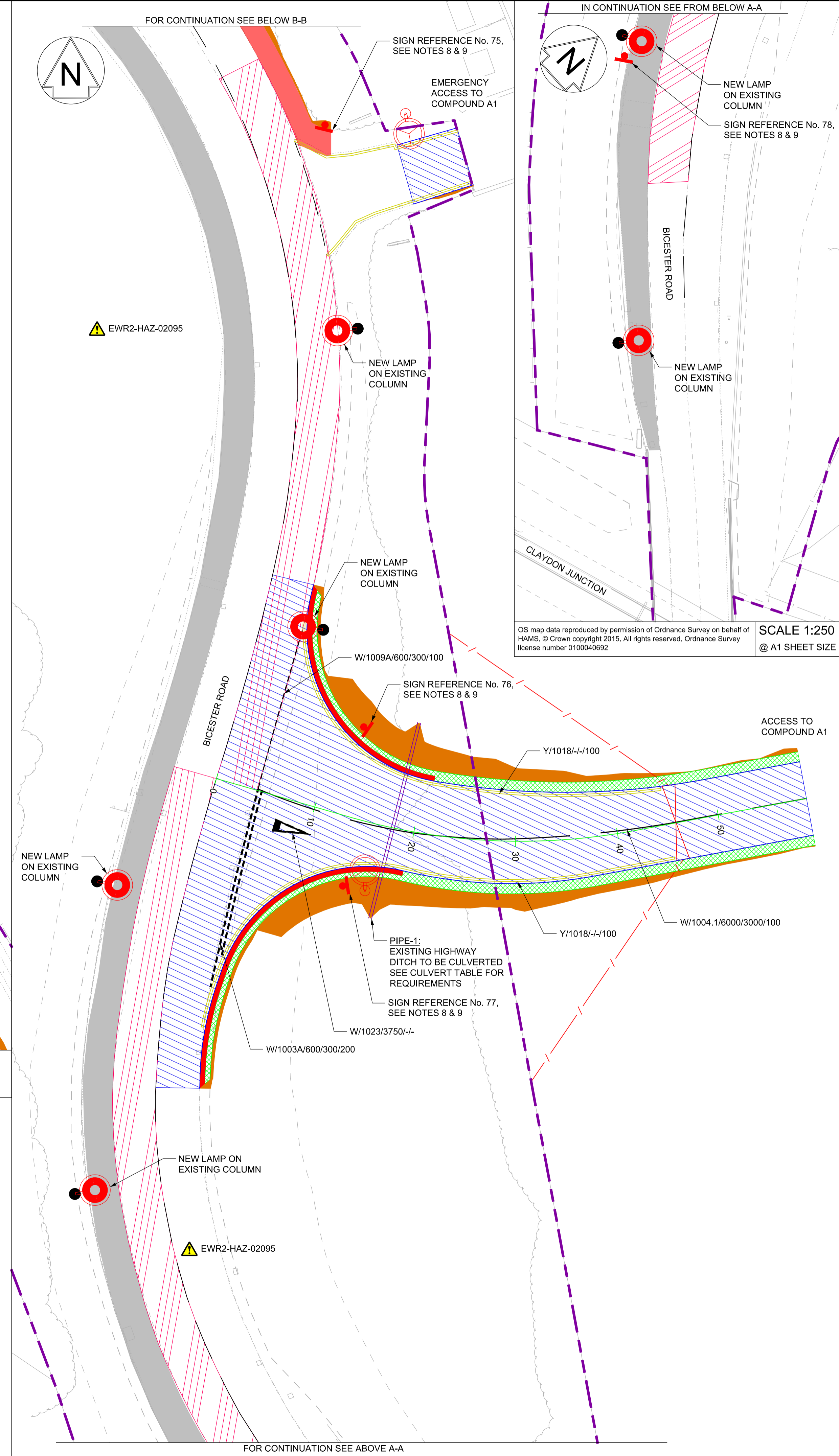

NETWORK RAIL (EAST WEST RAIL WESTERN SECTION PHASE 2)

- NOTES:**
- THIS DRAWING IS NOT TO BE SCALED.
 - ALL DIMENSIONS ARE IN METRES (m) UNLESS SHOWN OTHERWISE.
 - THIS DRAWING IS TO BE READ IN CONJUNCTION WITH THE HIGHWAY DESIGN PACKAGE OF DRAWINGS AND DOCUMENTS.
 - WHEREVER REQUIRED, ROAD MARKINGS ARE TO BE LAID IN ACCORDANCE WITH THE TRAFFIC SIGN REGULATIONS AND GENERAL DIRECTIONS 2016 & 'TRAFFIC SIGNS MANUAL CHAPTER 5 (2003)'.
 - WHERE A FENCE IS PROPOSED IT SHALL TIE-IN TO THE EXISTING HEDGEROW OR BOUNDARY TREATMENT TO PROVIDE A SECURE BOUNDARY.
 - FOR POSITIONS OF UTILITY COMPANIES APPARATUS REFER TO DRAWING No. 133735_2A-EWR-OXD-CC_A1-DR-CH-002004.
 - THIS DRAWING IS TO BE READ IN CONJUNCTION WITH STANDARD DETAILS DRAWING No.S 133735_RW-EWR-XX-XX-DR-CH-000103, 112, 114, 116, 122, 123, 215 & 218.
 - REFER TO DRAWING No.133735_2A-EWR-OXD-XX-DR-CH-010256 FOR OFFLINE HIGHWAYS SIGNAGE STRATEGY.
 - FOR DETAILS OF SIGN FACES, POSTS AND FOUNDATION, SEE SIGNAGE STRATEGY SCHEDULE DRAWINGS 133735_RW-EWR-XX-XX-DR-CH-000300 - 133735_RW-EWR-XX-XX-DR-CH-000301.

Rev	Date	Description of Revisions	Desd	Chkd	Appr
B01	19/05/20	FOR INFORMATION	N.T.	L.T.	G.J.

SHARED - for IDC Review

S3



East West Rail (Western Section) Phase 2

ACCESS TO COMPOUND A1 INITIAL GENERAL ARRANGEMENT (TO BE KEPT UNDER REVIEW)

Designed	Nagoth Thomas Ravi Kumar	Signed	N. T. R. Kumar	Date	19/05/20
Drawn	Ravikumar KN	Signed	R. KN	Date	19/04/20
Checked	Lisa Taylor	Signed	L. Taylor	Date	19/05/20
Approved	Gareth Johnston	Signed	G. Johnston	Date	19/05/20

Scale(s)	1:250	ELR - Project Chainage (Miles Yards)	OXD -
Design Package Risk Classification	Normal	Sheet	1 of 1
Alternative Reference		Revision	B01
Drawing Number	133735_2A-EWR-OXD-CC_A1-DR-CH-003001		

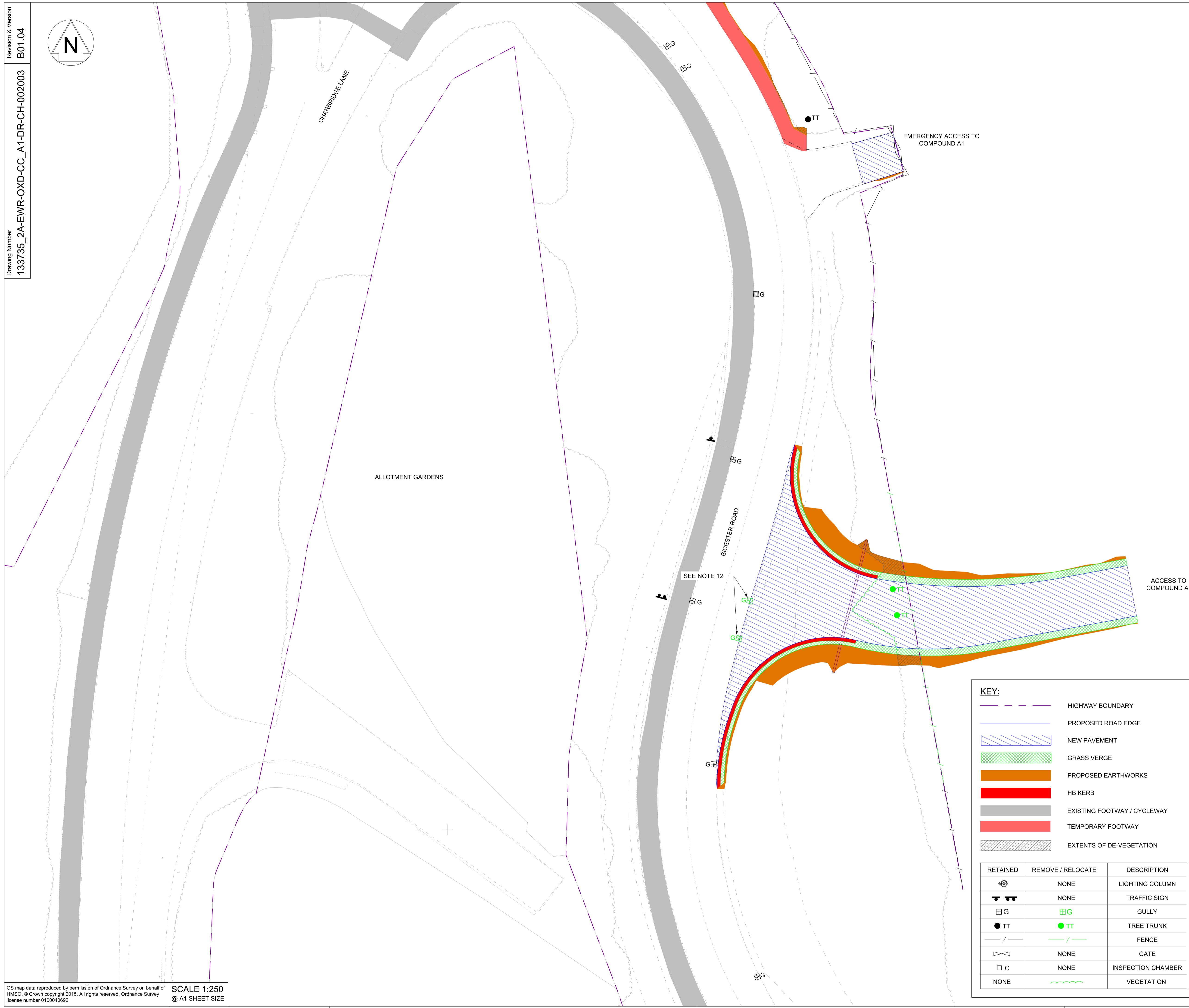
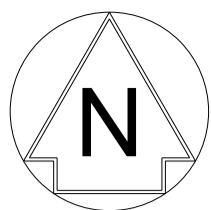

NETWORK RAIL (EAST WEST RAIL WESTERN SECTION PHASE 2)

NOTES:

- THIS DRAWING IS NOT TO BE SCALED.
- ALL DIMENSIONS ARE IN METRES (m) UNLESS SHOWN OTHERWISE.
- THIS DRAWING IS TO BE READ IN CONJUNCTION WITH THE HIGHWAY DESIGN PACKAGE OF DRAWINGS AND DOCUMENTS.
- PRIOR TO THE COMMENCEMENT OF WORKS, A SUITABLY QUALIFIED ECOLOGIST SHALL INSPECT THE SITE FOR THE PRESENCE OF PROTECTED SPECIES AND HABITAT. THE ECOLOGIST SHALL THEN ADVISE EWR ALLIANCE ON THE REQUIRED PRECAUTIONARY METHODS AND AREAS OF EXCLUSION.
- WHERE SITE CLEARANCE WORKS HAVE THE POTENTIAL TO IMPACT TREES OR HEDGES WHICH ARE TO BE RETAINED, AN ARBORICULTURIST SHALL BE PRESENT TO ADVISE ON ROOT PROTECTION ZONE EXTENTS, ROOT PRUNING AND CROWN RAISING. WORKS SHALL BE CARRIED OUT IN ACCORDANCE WITH BS3998:2010.
- SITE CLEARANCE, WHERE THERE IS PROXIMITY TO HABITAT OF PROTECTED SPECIES, SHALL BE CARRIED OUT UNDER THE SUPERVISION OF A SUITABLY QUALIFIED ECOLOGIST.
- THE EXTENTS OF ALL SITE CLEARANCE WORKS SHALL BE RECORDED IN THE AS-BUILT SITE CLEARANCE DRAWINGS AND SHALL ALSO BE RECORDED, WITH PHOTOGRAPHS OF FEATURES PRIOR TO REMOVAL, IN THE SITE CLEARANCE REGISTER. THE SITE CLEARANCE REGISTER SHALL BE MAINTAINED BY EWR ALLIANCE AND WILL INFORM REINSTATEMENT DETERMINATION.
- IN LOCATIONS WHERE EXISTING TREES OVERHANG THE PASSING PLACE CROWN LIFTING, TO GIVE 5m CLEARANCE ABOVE GROUND LEVEL, SHALL BE UNDERTAKEN TO THE BACK OF THE PROPOSED VERGE. THIS SHALL BE UNDERTAKEN UNDER THE SUPERVISION OF AN ARBORICULTURIST.
- THE VEGETATION CLEARANCE SHOWN HERE ON THE DRAWING IS INDICATIVE ONLY. THE SITE TEAM NEEDS TO ASCERTAIN THE REQUIRED CLEARANCE BASED ON THE VISIBILITY SPLAY, INTERVISIBILITY ZONE AND OR WORKS REQUIRED FOR THIS SITE.
- FOR CLARITY ONLY THE TRUNKS OF EXISTING TREES ARE SHOWN, FOR CANOPY EXTENTS THE TREE SURVEY MODEL AND MASTER SCHEDULE ARE TO BE REFERRED TO.
- FOR DETAILS OF AMENDMENTS TO STREET LIGHTING REFER TO DRAWING No. 133735_2A-EWR-OXD-CC_A1-DR-CH-002012.
- THE EXISTING GULLY AND SUMP IS TO BE REMOVED TO ALLOW INSTALLATION OF THE PAVEMENT. THE GULLY OUTLET PIPE IS TO BE RETAINED. A DRAIN TEST PLUG (OR SIMILAR AGREED METHOD) IS TO BE INSERTED INTO THE END OF THE EXPOSED PIPE TO PREVENT DEBRIS AND FILL MATERIAL FROM ENTERING THE PIPE. THE POSITION OF THE PIPE SHALL BE SURVEY AS A RECORD OF ITS POSITION TO ALLOW A NEW GULLY TO BE REINSTATED IN THE FUTURE.



Rev	Date	Description of Revisions	Desd	Chkd	Appr	Suitability
B01	18/12/19	FOR INFORMATION				S2



Project
East West Rail (Western Section) Phase 2
 Drawing Title
ACCESS TO COMPOUND A1 SITE CLEARANCE

Designed	Nagoth Thomas Ravi Kumar	Signed	N. T. R. Kumar	Date	16/12/19
Drawn	Ravikumar KN	Signed	R. KN	Date	18/12/18
Checked	Garth Johnston	Signed	G. Johnston	Date	16/12/19
Approved	Stephen Abe	Signed	S. Abe	Date	16/12/19

Scale(s)	1:250	ELR - Project Chainage (Miles Yards)	OXD - 108820	Sheet	1 of 1
Design Package Risk Classification	Normal			Revision	B01
Alternative Reference				Revision	B01

Drawing Number
 133735_2A-EWR-OXD-CC_A1-DR-CH-002003

KEY:

- HIGHWAY BOUNDARY
- PROPOSED ROAD EDGE
- NEW PAVEMENT
- GRASS VERGE
- PROPOSED EARTHWORKS
- HB KERB
- EXISTING FOOTWAY / CYCLEWAY
- TEMPORARY FOOTWAY
- EXTENTS OF DE-VEGETATION

RETAINED	REMOVE / RELOCATE	DESCRIPTION
	NONE	LIGHTING COLUMN
	NONE	TRAFFIC SIGN
		GULLY
		TREE TRUNK
		FENCE
	NONE	GATE
	NONE	INSPECTION CHAMBER
NONE		VEGETATION

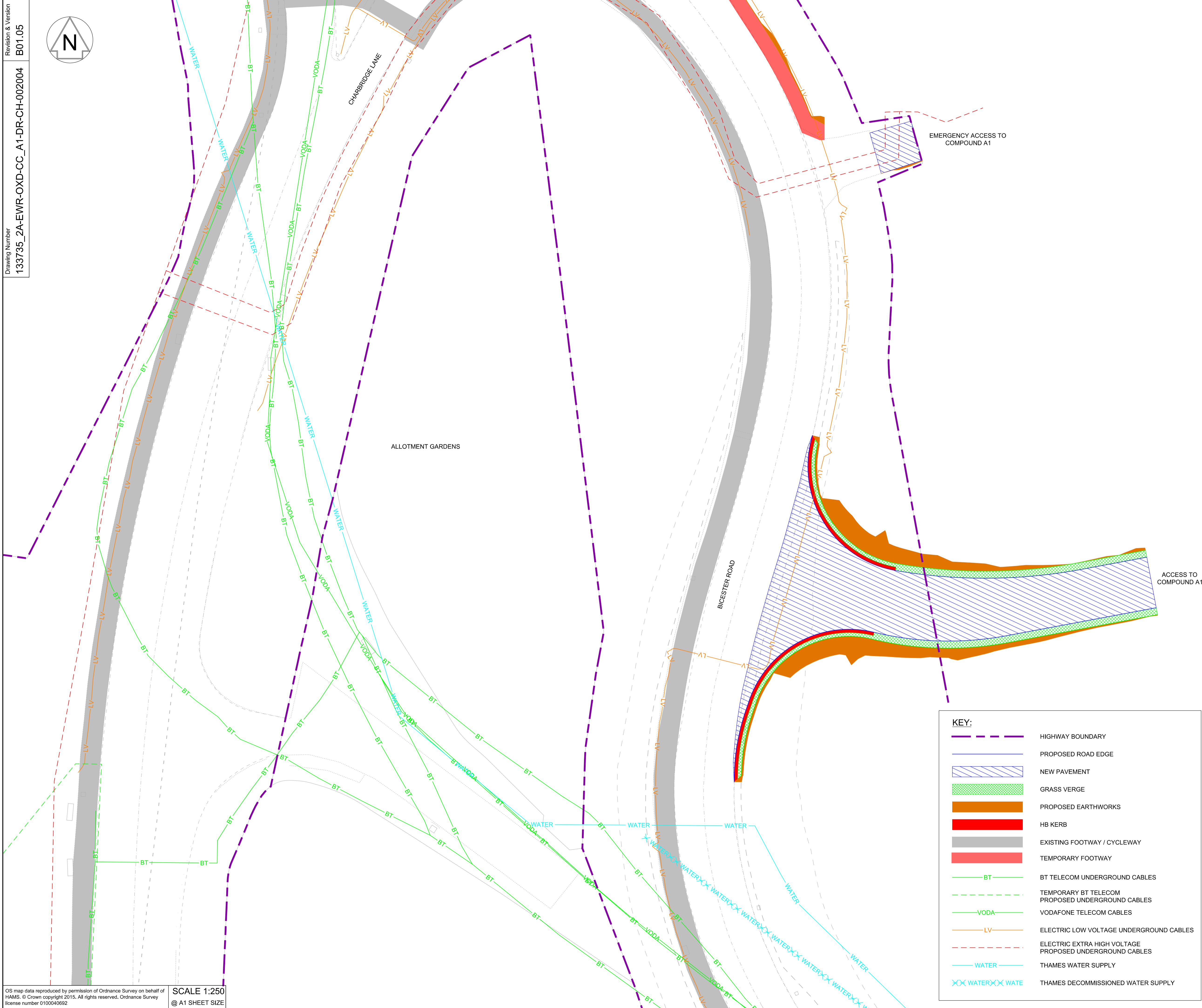
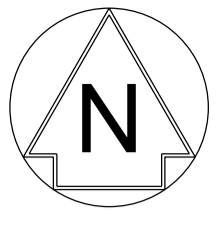

NETWORK RAIL (EAST WEST RAIL WESTERN SECTION PHASE 2)

- NOTES:**
1. THIS DRAWING IS NOT TO BE SCALED.
 2. ALL DIMENSIONS ARE IN METRES (m) UNLESS SHOWN OTHERWISE.
 3. THIS DRAWING IS TO BE READ IN CONJUNCTION WITH THE HIGHWAY DESIGN PACKAGE OF DRAWINGS AND DOCUMENTS.
 4. THE EXACT LOCATION AND EXTENT OF BURIED SERVICES SHALL BE VERIFIED ON SITE PRIOR TO COMMENCEMENT OF THE WORKS. AGREEMENT WITH PRIVATE LANDOWNERS SHALL BE OBTAINED PRIOR TO WORKS WHERE ACCESS TO PRIVATE LAND IS REQUIRED.
 5. THIS DRAWING SHOWS THE POSITION OF UTILITY COMPANIES APPARATUS KNOWN TO OPERATE IN THE AREA IMMEDIATELY ADJACENT TO AND WITHIN THE LAND TAKE BOUNDARY FOR EAST WEST RAIL.
 6. THE POSITIONS INDICATED FOR THE APPARATUS ARE BASED ON RECORDS PROVIDED BY NETWORK RAIL. THE ACCURACY OF THE RECORDS MAINTAINED BY THE UTILITY COMPANIES, THE METHODS AVAILABLE TO PROCESS / REPRODUCE THIS INFORMATION IN THE DRAWINGS AND THE AGE OF THE INFORMATION, THERE IS THE POSSIBILITY THAT APPARATUS HAS BEEN ADDED OR REMOVED SINCE THE RECORDS WERE PROVIDED.
 7. ALL SEARCHES MUST BE VERIFIED AND ESTABLISHED ON SITE BEFORE WORK COMMENCES. IT IS THE RESPONSIBILITY OF THE EWR ALLIANCE TO IDENTIFY AND LOCATE UTILITY PLANT PRIOR TO WORK GOING AHEAD.



Rev	Date	Description of Revisions	Desd	Chkd	Appr	Suitability
B01	18/12/19	FOR INFORMATION				S2



Project
East West Rail (Western Section) Phase 2

Drawing Title
ACCESS TO COMPOUND A1 EXISTING UTILITIES

Designed	Nagoth Thomas Ravi Kumar	Signed	N. T. R. Kumar	Date	16/12/19	
Drawn	Ravikumar KN	Signed	R. KN	Date	18/12/18	
Checked	Gareth Johnston	Signed	G. Johnston	Date	16/12/19	
Approved	Stephen Abe	Signed	S. Abe	Date	16/12/19	
Scale(s)	1:250 (ELR - Project Chainage (Miles Yards))					
Design Package Risk Classification	Normal					
Alternative Reference	OXD - 108820					
Drawing Number	133735_2A-EWR-OXD-CC_A1-DR-CH-002004					
Sheet	1 of 1				Revision	B01

KEY:

	HIGHWAY BOUNDARY
	PROPOSED ROAD EDGE
	NEW PAVEMENT
	GRASS VERGE
	PROPOSED EARTHWORKS
	HB KERB
	EXISTING FOOTWAY / CYCLEWAY
	TEMPORARY FOOTWAY
	BT TELECOM UNDERGROUND CABLES
	TEMPORARY BT TELECOM PROPOSED UNDERGROUND CABLES
	VODAFONE TELECOM CABLES
	ELECTRIC LOW VOLTAGE UNDERGROUND CABLES
	ELECTRIC EXTRA HIGH VOLTAGE PROPOSED UNDERGROUND CABLES
	THAMES WATER SUPPLY
	THAMES DECOMMISSIONED WATER SUPPLY

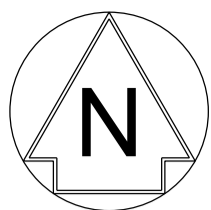

OS map data reproduced by permission of Ordnance Survey on behalf of
HAMS. © Crown copyright 2015. All rights reserved. Ordnance Survey
license number 0100040692

SCALE 1:250
@ A1 SHEET SIZE

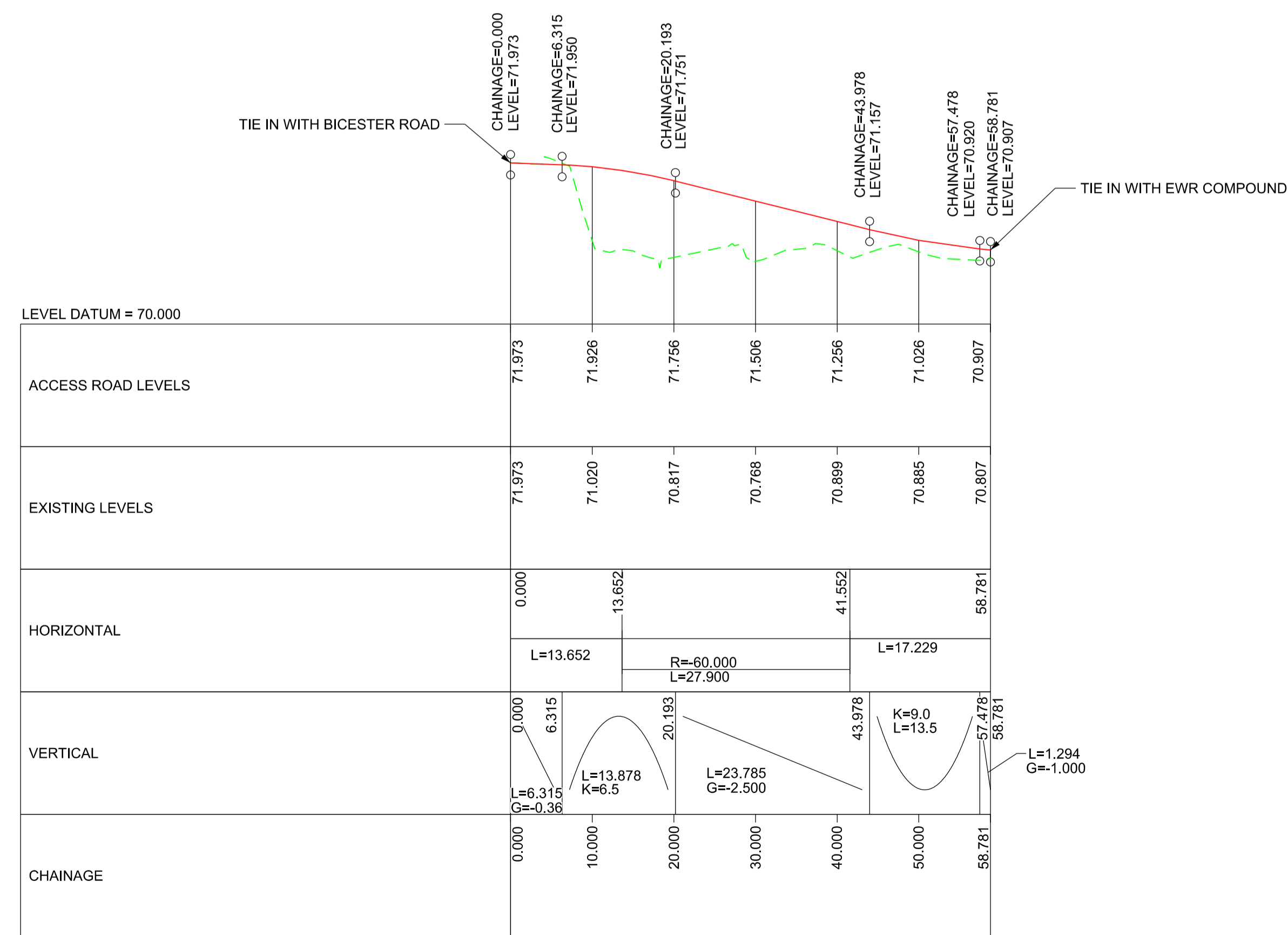
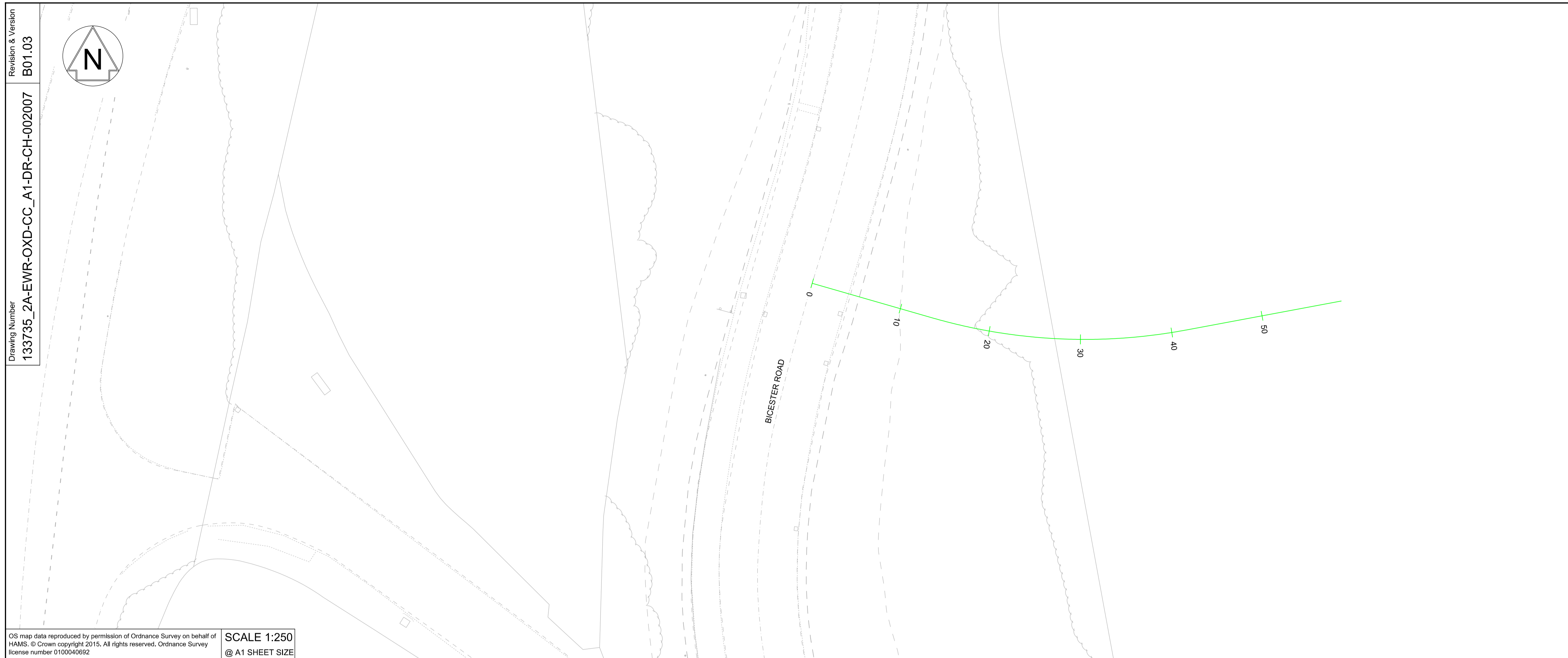

ROAD PROFILE
SCALE = H - 1:500
V - 1:50

KEY:

	NEW ROAD EDGE LEVEL
	EXISTING SURFACE LEVEL

SCALE : AS SHOWN
@ A1 SHEET SIZE

NETWORK RAIL (EAST WEST
RAIL WESTERN SECTION PHASE 2)

- NOTES:
1. THIS DRAWING IS NOT TO BE SCALED.
 2. ALL DIMENSIONS ARE IN METRES (m) UNLESS SHOWN OTHERWISE.
 3. THIS DRAWING IS TO BE READ IN CONJUNCTION WITH THE HIGHWAY DESIGN PACKAGE OF DRAWINGS AND DOCUMENTS.



Rev	Date	Description of Revisions	Desd	Chkd	Appr	Suitability
B01	18/12/19	FOR INFORMATION	N.T.	G.J.	S.A	
Status						S2



Project
**East West Rail
(Western Section)
Phase 2**

Drawing Title
**ACCESS TO COMPOUND A1
ROAD PLAN AND PROFILE**

Designed	Nagoth Thomas Ravi Kumar	Signed	N. T. R. Kumar	Date	16/12/19
Drawn	Ravikumar KN	Signed	R. KN	Date	18/12/18
Checked	Gareth Johnston	Signed	G. Johnston	Date	16/12/19
Approved	Stephen Abe	Signed	S. Abe	Date	16/12/19

Scale(s)	ELR - Project Chainage (Miles Yards)	Sheet	1 of 1
AS SHOWN	OXD - 108820	Design Package Risk Classification	Normal
Alternative Reference		Revision	B01
Drawing Number	133735_2A-EWR-OXD-CC_A1-DR-CH-002007		

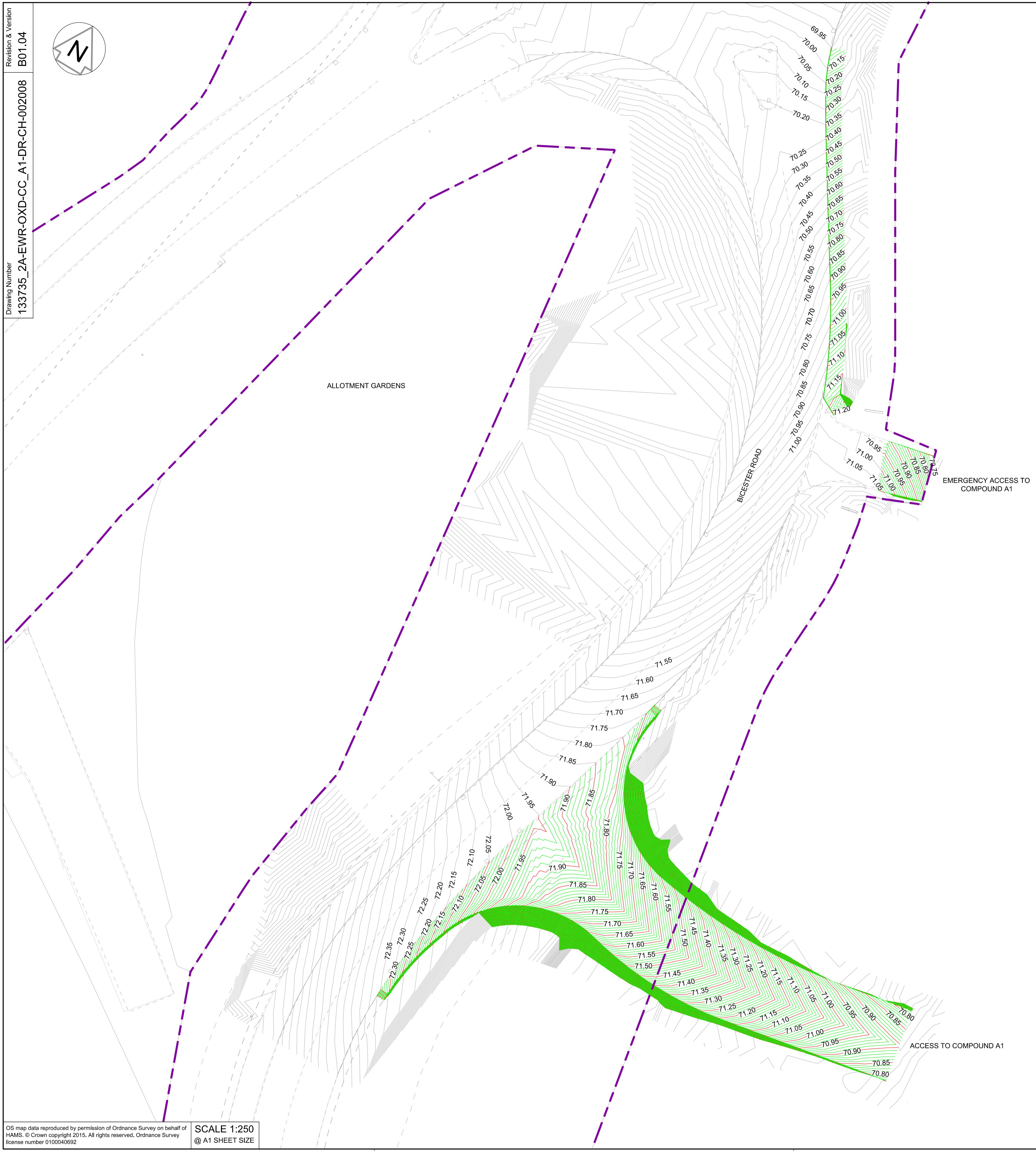
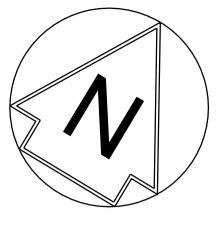

KEY:

	HIGHWAY BOUNDARY
	EXISTING CONTOUR MAJOR @ 0.05m INTERVALS
	EXISTING CONTOUR MINOR @ 0.01m INTERVALS
	PROPOSED CONTOUR MAJOR @ 0.05m INTERVALS
	PROPOSED CONTOUR MINOR @ 0.01m INTERVALS

- NETWORK RAIL (EAST WEST RAIL WESTERN SECTION PHASE 2)**
- NOTES:**
1. THIS DRAWING IS NOT TO BE SCALED.
 2. ALL DIMENSIONS ARE IN METRES (m) UNLESS SHOWN OTHERWISE.
 3. THIS DRAWING IS TO BE READ IN CONJUNCTION WITH THE HIGHWAY DESIGN PACKAGE OF DRAWINGS AND DOCUMENTS.
 4. ALL WORKS TO BE IN ACCORDANCE WITH THE MANUAL OF CONTRACT DOCUMENTS FOR HIGHWAYS WORKS VOL 1 (SPECIFICATION FOR HIGHWAY WORKS) AND STANDARD CONSTRUCTION DETAILS.
 5. THE DELIVERY TEAM IS TO VERIFY DIMENSION ON SITE AND ADVISE OF ANY INFORMATION DISCREPANCIES. TIE-IN POINTS SHOULD BE VERIFIED ON SITE WITH THE ENGINEER PRIOR TO CONSTRUCTION.



B01	18/12/19	FOR INFORMATION	N.T.	G.J.	S.A
Rev	Date	Description of Revisions	Dend	Chkd	Appr
Status		SHARED - for Information			S2



Project
**East West Rail
(Western Section)
Phase 2**

Drawing Title
**ACCESS TO COMPOUND A1
EXISTING AND PROPOSED
CONTOURS**

Designed	Nagoth Thomas Ravi Kumar	Signed	N. T. R. Kumar	Date	16/12/19
Drawn	Ravikumar KN	Signed	R. KN	Date	17/12/18
Checked	Garth Johnston	Signed	G. Johnston	Date	16/12/19
Approved	Stephen Abe	Signed	S. Abe	Date	16/12/19

Scale(s)	1:250	ELR - Project Chainage (Miles Yards)	OXD - 108820
Design Package Risk Classification	Normal		Sheet
Alternative Reference		Revision	B01

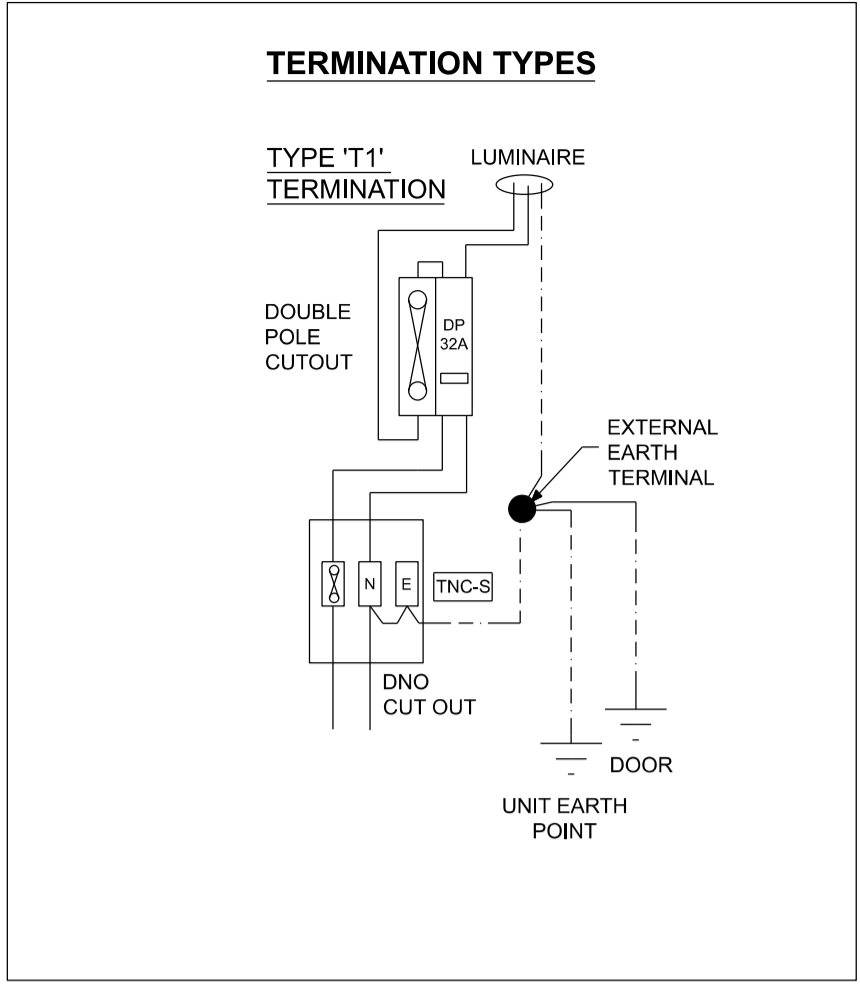
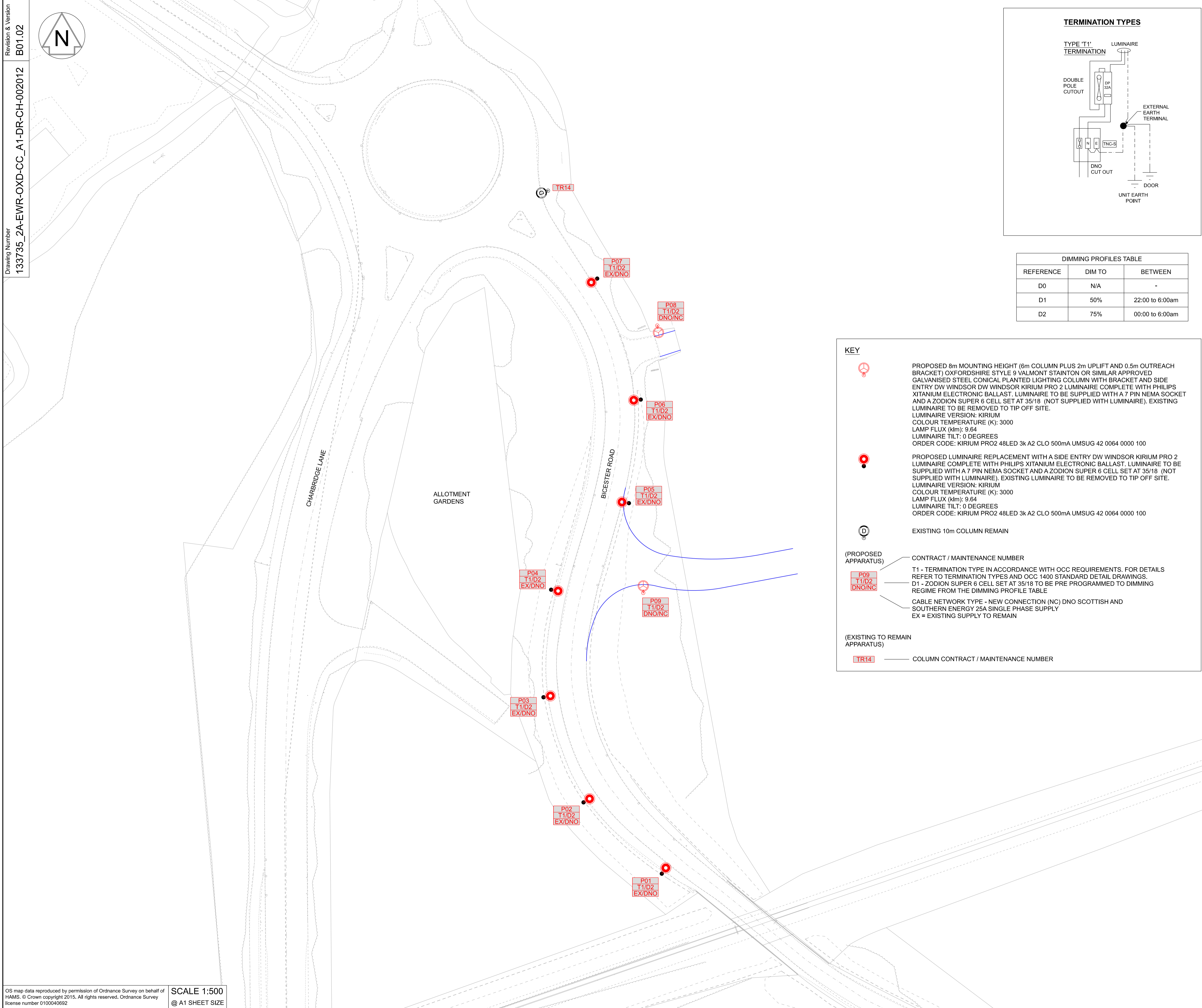
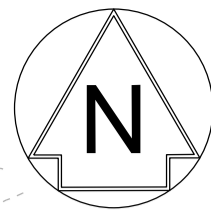

DIMMING PROFILES TABLE

REFERENCE	DIM TO	BETWEEN
D0	N/A	-
D1	50%	22:00 to 6:00am
D2	75%	00:00 to 6:00am

KEY

- PROPOSED 8m MOUNTING HEIGHT (6m COLUMN PLUS 2m UPLIFT AND 0.5m OUTREACH BRACKET) OXFORDSHIRE STYLE 9 VALMONT STANTON OR SIMILAR APPROVED GALVANISED STEEL CONICAL PLANTED LIGHTING COLUMN WITH BRACKET AND SIDE ENTRY DW WINDSOR DW WINDSOR KIRIUM PRO 2 LUMINAIRE COMPLETE WITH PHILIPS TITANIUM ELECTRONIC BALLAST. LUMINAIRE TO BE SUPPLIED WITH A 7 PIN NEMA SOCKET AND A ZODION SUPER 6 CELL SET AT 35/18 (NOT SUPPLIED WITH LUMINAIRE). EXISTING LUMINAIRE TO BE REMOVED TO TIP OFF SITE.
LUMINAIRE VERSION: KIRIUM
COLOUR TEMPERATURE (K): 3000
LAMP FLUX (klm): 9.64
LUMINAIRE TILT: 0 DEGREES
ORDER CODE: KIRIUM PRO2 48LED 3k A2 CLO 500mA UMSUG 42 0064 0000 100
- PROPOSED LUMINAIRE REPLACEMENT WITH A SIDE ENTRY DW WINDSOR KIRIUM PRO 2 LUMINAIRE COMPLETE WITH PHILIPS TITANIUM ELECTRONIC BALLAST. LUMINAIRE TO BE SUPPLIED WITH A 7 PIN NEMA SOCKET AND A ZODION SUPER 6 CELL SET AT 35/18 (NOT SUPPLIED WITH LUMINAIRE). EXISTING LUMINAIRE TO BE REMOVED TO TIP OFF SITE.
LUMINAIRE VERSION: KIRIUM
COLOUR TEMPERATURE (K): 3000
LAMP FLUX (klm): 9.64
LUMINAIRE TILT: 0 DEGREES
ORDER CODE: KIRIUM PRO2 48LED 3k A2 CLO 500mA UMSUG 42 0064 0000 100
- EXISTING 10m COLUMN REMAIN
- (PROPOSED APPARATUS) CONTRACT / MAINTENANCE NUMBER
T1 - TERMINATION TYPE IN ACCORDANCE WITH OCC REQUIREMENTS. FOR DETAILS REFER TO TERMINATION TYPES AND OCC 1400 STANDARD DETAIL DRAWINGS.
D1 - ZODION SUPER 6 CELL SET AT 35/18 TO BE PRE PROGRAMMED TO DIMMING REGIME FROM THE DIMMING PROFILE TABLE
CABLE NETWORK TYPE - NEW CONNECTION (NC) DNO SCOTTISH AND SOUTHERN ENERGY 25A SINGLE PHASE SUPPLY
EX = EXISTING SUPPLY TO REMAIN
- (EXISTING TO REMAIN APPARATUS) COLUMN CONTRACT / MAINTENANCE NUMBER

- ### NETWORK RAIL (EAST WEST) RAIL WESTERN SECTION PHASE 2
- #### NOTES:
- ALL EQUIPMENT AND INSTALLATION WORK SHALL BE IN ACCORDANCE WITH THE MOST RECENT VERSION OF THE OCC ROAD LIGHTING GENERAL SPECIFICATION DOCUMENT AND THE MOST RECENT REVISION OF STANDARD DETAIL DRAWINGS HSD-13-002, HSD-13-006, HSD-13-007, HSD-13-008, HSD-13-021, HSD-14-005, HSD-14-015, HSD-14-017.
 - ALL LIGHTING COLUMNS SHALL BE SUITABLE FOR THE FITMENT, WEIGHT AND WINDAGE OF THE LUMINAIRE SPECIFIED AND DESIGNED IN ACCORDANCE WITH THE SPECIFICATION. LIGHTING COLUMN CONSTRUCTION NUMBERS SHOWN ON THE DRAWING. MAINTENANCE NUMBERS TO BE PROVIDED ON REQUEST BY THE MAINTAINING AUTHORITY.
 - LUMINAIRES TO BE FACTORY PAINTED GREEN (RAL 6013) PRIOR TO FITTING. SEE SPECIFICATION DOCUMENT
 - BOLLARDS TO BE INSTALLED AS PER STANDARD DETAIL DRAWINGS HSD/1200/003 AND 004.
 - ALL COLUMN POSITIONS TO BE AGREED BY THE MAINTAINING AUTHORITY PRIOR TO ERECTION.
 - ELECTRICAL WORK SHALL COMPLY IN ALL RESPECTS WITH THE 18TH EDITION OF THE I.E.T WIRING REGULATIONS BS:7671 AS AMENDED.
 - ON COMPLETION AN ELECTRICAL TEST CERTIFICATE FOR EACH LIGHTING COLUMN, ASSOCIATED WITH CABLE AND SWITCH GEAR SHALL BE COMPLETED AND RETURNED BY THE CONTRACTOR.
 - THE ILP CODE OF PRACTICE FOR ELECTRICAL SAFETY IN HIGHWAY ELECTRICAL OPERATIONS TOGETHER WITH THE ILP SUPPLEMENT ENTITLED "SAFETY DURING THE INSTALLATION AND REMOVAL OF LIGHTING COLUMNS AND SIMILAR STREET FURNITURE IN PROXIMITY TO HIGH VOLTAGE OVERHEAD LINES"
 - HEALTH AND SAFETY EXECUTIVE BOOKLET HS(G)47 "AVOIDING DANGER FROM UNDERGROUND SERVICES" AND H&SE GUIDANCE NOTE GS6 "AVOIDANCE OF DANGER FROM OVERHEAD ELECTRIC LINES" AND
 - THE ELECTRICITY ASSOCIATION ENGINEERING RECOMMENDATION G39/1 SAFETY CODE OF PRACTICE E4 COVERING ELECTRICAL SAFETY AND PLANNING. INSTALLATION, COMMISSIONING AND MAINTENANCE OF PUBLIC LIGHTING AND OTHER STREET FURNITURE.
 - THE CONTRACTOR IS TO INVESTIGATE PROPOSED LIGHTING COLUMN LOCATION TO ENSURE IT'S CLEAR OF ALL UNDERGROUND INFRASTRUCTURE. IF OBSTRUCTION IS FOUND, THEN REPORT THIS TO THE ENGINEER.
 - CONTRACTOR SHALL CONFIRM LIGHTING LEVELS IF AN ALTERNATIVE LUMINAIRE IS PROPOSED.
 - FINAL LOCATIONS OF STREET LIGHTING TO BE CONFIRMED WITH FINAL LOCATION OF TREES.



Rev	Date	Description of Revisions	Desd	Chkd	Appr	Suitability
B01	13/03/20	FOR INFORMATION				



Project
**East West Rail
(Western Section)
Phase 2**

Drawing Title
**ACCESS TO COMPOUND A1
STREET LIGHTING**

Designed	Nagoth Thomas Ravi Kumar	Signed	N. T. R. Kumar	Date	11/03/20
Drawn	Nigel R Jones	Signed	N. Jones	Date	21/01/19
Checked	Lisa Taylor	Signed	L. Taylor	Date	13/03/20
Approved	Karen Wood	Signed	K. Wood	Date	13/03/20

Scale(s)	1:500	ELR - Project Chainage (Miles Yards)	OXD - 108820
Design Package Risk Classification	Normal		Sheet 1 of 1
Alternative Reference			Revision B01
Drawing Number	133735_2A-EWR-OXD-CC_A1-DR-CH-002012		

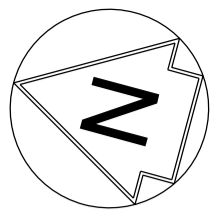

NETWORK RAIL (EAST WEST
RAIL WESTERN SECTION PHASE 2)

NOTES:

1. THIS DRAWING IS NOT TO BE SCALED.
2. ALL DIMENSIONS ARE IN METRES (m) UNLESS SHOWN OTHERWISE.
3. THIS DRAWING IS TO BE READ IN CONJUNCTION WITH THE HIGHWAY DESIGN PACKAGE OF DRAWINGS AND DOCUMENTS.
4. THIS DRAWING IS TO BE READ IN CONJUNCTION WITH DRAWING No.S 133735_RW-EWR-XX-XX-DR-CH-000147 & 215.

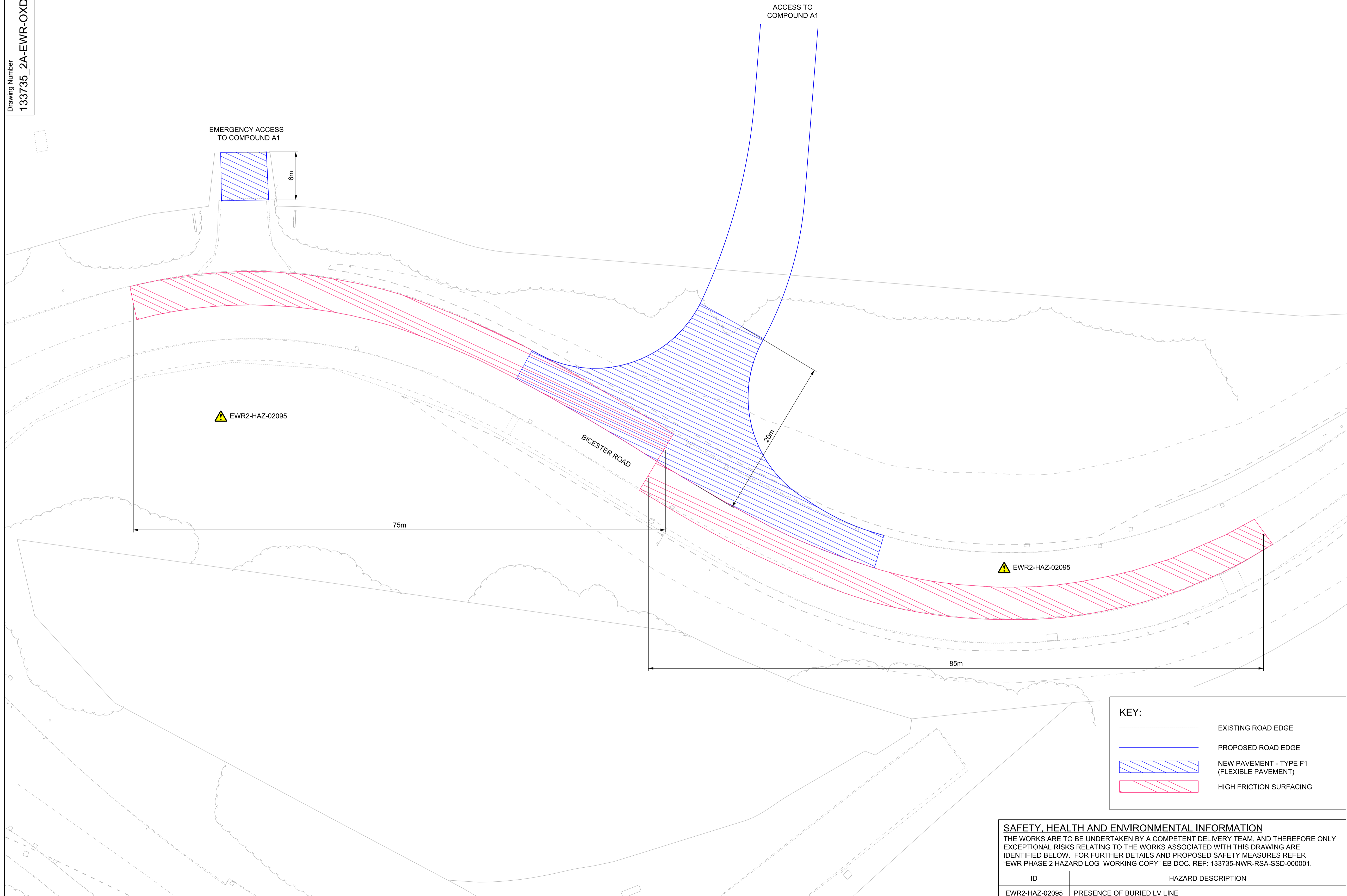

Rev	Date	Description of Revisions	Desd	Chkd	Appr
B01	07/05/20	WIP - DESIGN	--	--	--

WIP - Design S0

Project
**East West Rail
(Western Section)
Phase 2**

Drawing Title
**ACCESS TO COMPOUND A1
PAVEMENT LAYOUT**

Designed	---	Signed	---	Date	---
Drawn	Tamsin Leaman-Hewitt	Signed	T. Leaman-Hewitt	Date	22/01/20
Checked	---	Signed	---	Date	---
Approved	---	Signed	---	Date	---

Scale(s)
1:250
ELR - Project Chainage (Miles/Yards)
OXD - 108820

Design Package Risk Classification
Normal

Alternative Reference
Revision
B01

Drawing Number
133735_2A-EWR-OXD-CC_A1-DR-CH-002019

KEY:

	EXISTING ROAD EDGE
	PROPOSED ROAD EDGE
	NEW PAVEMENT - TYPE F1 (FLEXIBLE PAVEMENT)
	HIGH FRICTION SURFACING

SAFETY, HEALTH AND ENVIRONMENTAL INFORMATION
THE WORKS ARE TO BE UNDERTAKEN BY A COMPETENT DELIVERY TEAM, AND THEREFORE ONLY EXCEPTIONAL RISKS RELATING TO THE WORKS ASSOCIATED WITH THIS DRAWING ARE IDENTIFIED BELOW. FOR FURTHER DETAILS AND PROPOSED SAFETY MEASURES REFER "EWR PHASE 2 HAZARD LOG WORKING COPY" EB DOC. REF: 133735-NWR-RSA-SSD-000001.

ID	HAZARD DESCRIPTION
EWR2-HAZ-02095	PRESENCE OF BURIED LV LINE

INDICATES PROJECT RISKS (EWR2-DRIS-)
 INDICATES H&S RISKS (EWR2-HAZ-)

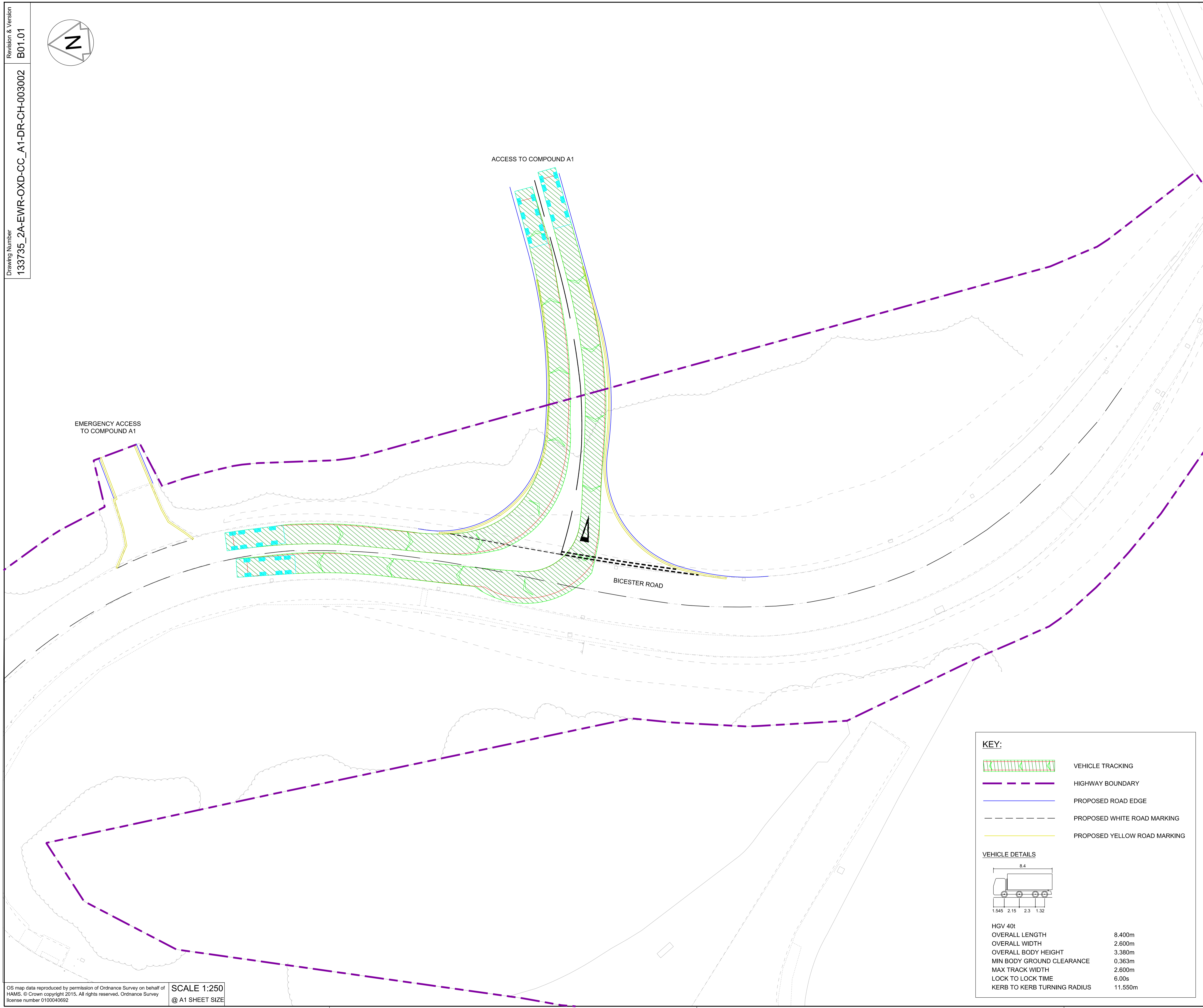
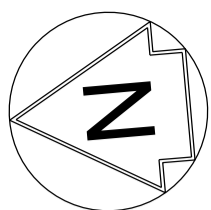

- NETWORK RAIL (EAST WEST RAIL WESTERN SECTION PHASE 2)**
- NOTES:**
1. THIS DRAWING IS NOT TO BE SCALED.
 2. ALL DIMENSIONS ARE IN METRES (m) UNLESS SHOWN OTHERWISE.
 3. VEHICLE TRACKING IS UNDERTAKEN WITH COMPUTER MODELLING SOFTWARE AND IS BASED ON IDEAL SITUATIONS WHERE REAL WORLD OBSTRUCTIONS ON THE ROAD NETWORK SUCH AS PARKING OR LOADING ACTIVITY WOULD NOT HAVE BEEN FORESEEN.
 4. THE MODELLING IS BASED IN 2D PLAN WHERE SWEEPED PATHS ARE INFLUENCED BY ANTICIPATED MOVEMENTS AND THEREFORE LEAD TO IDEAL APPROACH ANGLES, WHICH MIGHT NOT BE OBVIOUS IN REALITY.
 5. APPROACH SPEEDS, APPROACH ANGLES, ROAD SURFACE, WEATHER CONDITIONS AND TYRE WEAR ARE ALL FACTORS THAT WILL INFLUENCE VEHICLE PATHS.

EMERGENCY ACCESS TO COMPOUND A1

ACCESS TO COMPOUND A1

BICESTER ROAD

KEY:

- VEHICLE TRACKING
- HIGHWAY BOUNDARY
- PROPOSED ROAD EDGE
- PROPOSED WHITE ROAD MARKING
- PROPOSED YELLOW ROAD MARKING

VEHICLE DETAILS

HGV 40t
 OVERALL LENGTH 8.400m
 OVERALL WIDTH 2.600m
 OVERALL BODY HEIGHT 3.380m
 MIN BODY GROUND CLEARANCE 0.363m
 MAX TRACK WIDTH 2.600m
 LOCK TO LOCK TIME 6.00s
 KERB TO KERB TURNING RADIUS 11.550m

Rev	Date	Description of Revisions	Desd	Chkd	Appr	Suitability
B01	19/05/20	FOR INFORMATION				
			N.T.	L.T.	G.J.	
Status	SHARED - for IDC Review					S3

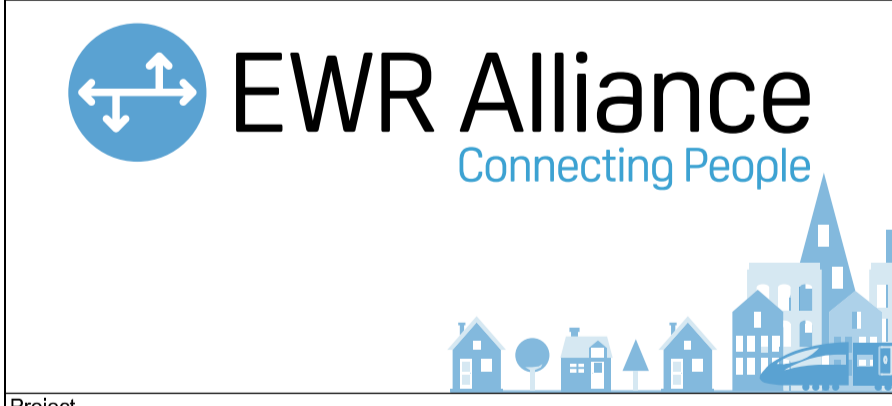

Project
East West Rail (Western Section) Phase 2

Drawing Title
ACCESS TO COMPOUND A1 INITIAL VEHICLE SWEEPED PATH ANALYSIS (TO BE KEPT UNDER REVIEW)

Designed	Nagoth Thomas Ravi Kumar	Signed	N. T. R. Kumar	Date	23/04/20
Drawn	Ravikumar KN	Signed	R. KN	Date	19/04/20
Checked	Lisa Taylor	Signed	L. Taylor	Date	24/04/20
Approved	Gareth Johnston	Signed	G. Johnston	Date	19/05/20
Scale(s)	1:250	ELR - Project Chainage (Miles Yards)	OXD -		
Design Package Risk Classification	Normal			Sheet	1 of 3
Alternative Reference				Revision	B01
Drawing Number	133735_2A-EWR-OXD-CC_A1-DR-CH-003002				

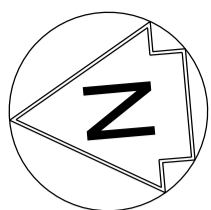

NETWORK RAIL (EAST WEST
RAIL WESTERN SECTION PHASE 2)

NOTES:

1. THIS DRAWING IS NOT TO BE SCALED.
2. ALL DIMENSIONS ARE IN METRES (m) UNLESS SHOWN OTHERWISE.
3. VEHICLE TRACKING IS UNDERTAKEN WITH COMPUTER MODELLING SOFTWARE AND IS BASED ON IDEAL SITUATIONS WHERE REAL WORLD OBSTRUCTIONS ON THE ROAD NETWORK SUCH AS PARKING OR LOADING ACTIVITY WOULD NOT HAVE BEEN FORESEEN.
4. THE MODELLING IS BASED IN 2D PLAN WHERE SWEEPED PATHS ARE INFLUENCED BY ANTICIPATED MOVEMENTS AND THEREFORE LEAD TO IDEAL APPROACH ANGLES, WHICH MIGHT NOT BE OBVIOUS IN REALITY.
5. APPROACH SPEEDS, APPROACH ANGLES, ROAD SURFACE, WEATHER CONDITIONS AND TYRE WEAR ARE ALL FACTORS THAT WILL INFLUENCE VEHICLE PATHS.

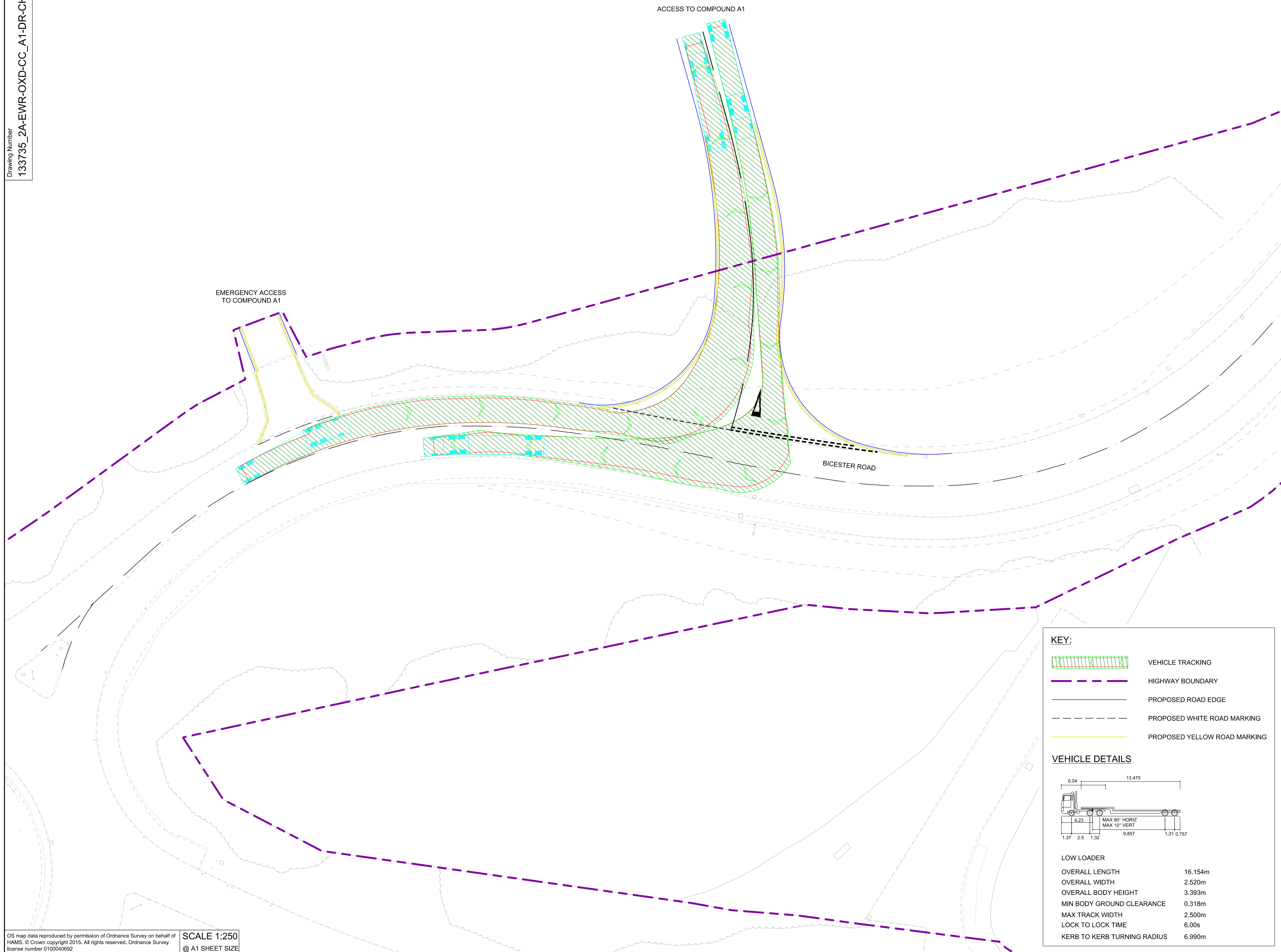

KEY:

- VEHICLE TRACKING
- HIGHWAY BOUNDARY
- PROPOSED ROAD EDGE
- PROPOSED WHITE ROAD MARKING
- PROPOSED YELLOW ROAD MARKING

VEHICLE DETAILS

LOW LOADER

OVERALL LENGTH	16.154m
OVERALL WIDTH	2.520m
OVERALL BODY HEIGHT	3.393m
MIN BODY GROUND CLEARANCE	0.318m
MAX TRACK WIDTH	2.500m
LOCK TO LOCK TIME	6.00s
KERB TO KERB TURNING RADIUS	6.990m

Rev	Date	Description of Revisions	Desd	Chkd	Appr	Suitability
B01	19/05/20	FOR INFORMATION				

SHARED - for IDC Review S3



Project
**East West Rail
(Western Section)
Phase 2**

Drawing Title
**ACCESS TO COMPOUND A1
INITIAL VEHICLE SWEEPED PATH
ANALYSIS
(TO BE KEPT UNDER REVIEW)**

Designed	Nagoth Thomas Ravi Kumar	Signed	N. T. R. Kumar	Date	23/04/20
Drawn	Ravikumar KN	Signed	R. KN	Date	19/04/20
Checked	Lisa Taylor	Signed	L. Taylor	Date	24/04/20
Approved	Gareth Johnston	Signed	G. Johnston	Date	19/05/20

Scale(s)
1:250
ELR - Project Chainage (Miles Yards)
OXD -

Design Package Risk Classification
Normal

Alternative Reference
Revision
B01

Drawing Number
133735_2A-EWR-OXD-CC_A1-DR-CH-003003

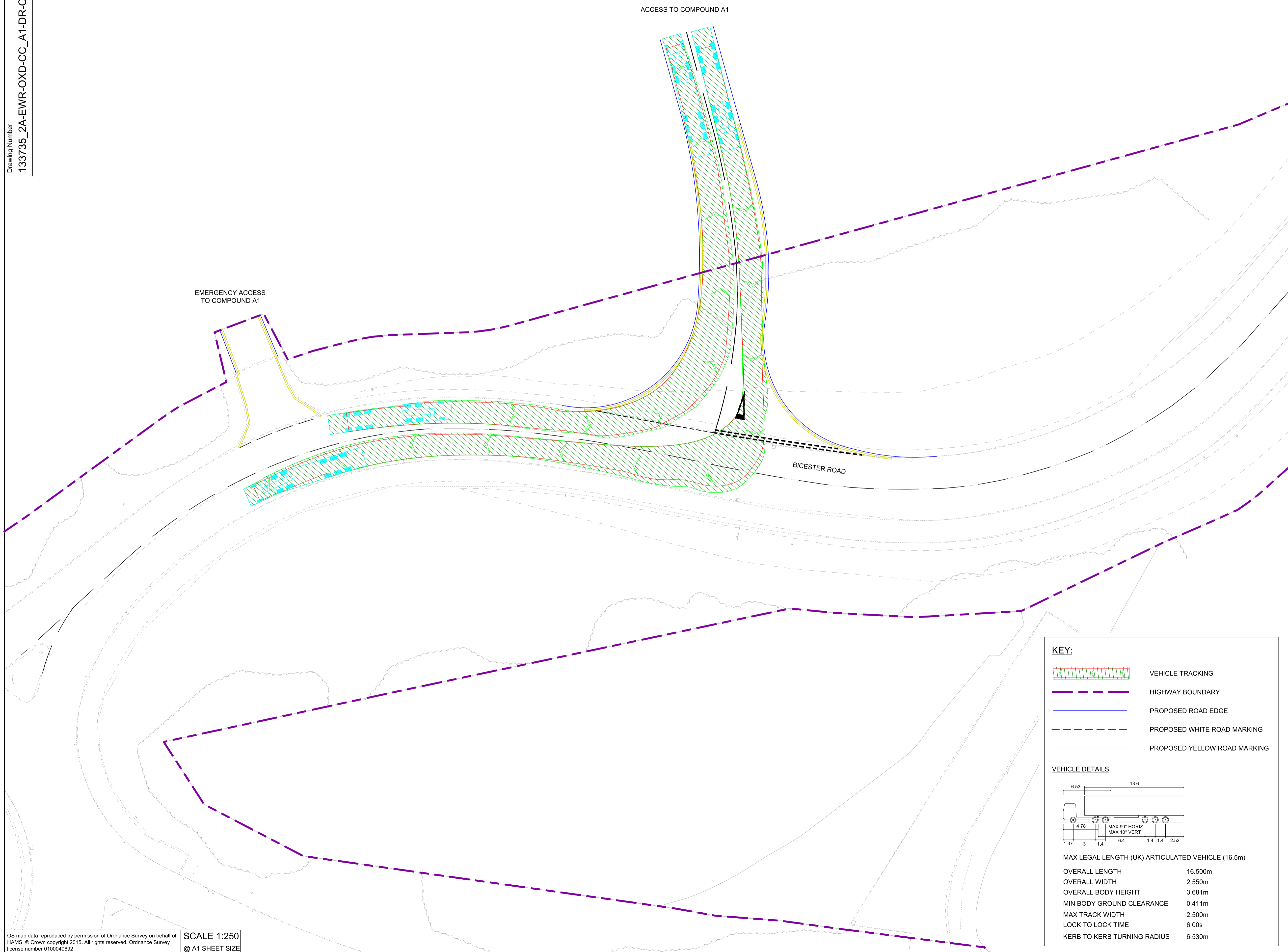
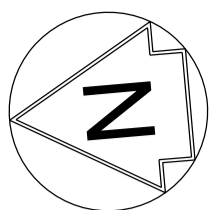

- NETWORK RAIL (EAST WEST RAIL WESTERN SECTION PHASE 2)**
- NOTES:**
1. THIS DRAWING IS NOT TO BE SCALED.
 2. ALL DIMENSIONS ARE IN METRES (m) UNLESS SHOWN OTHERWISE.
 3. VEHICLE TRACKING IS UNDERTAKEN WITH COMPUTER MODELLING SOFTWARE AND IS BASED ON IDEAL SITUATIONS WHERE REAL WORLD OBSTRUCTIONS ON THE ROAD NETWORK SUCH AS PARKING OR LOADING ACTIVITY WOULD NOT HAVE BEEN FORESEEN.
 4. THE MODELLING IS BASED IN 2D PLAN WHERE SWEEPED PATHS ARE INFLUENCED BY ANTICIPATED MOVEMENTS AND THEREFORE LEAD TO IDEAL APPROACH ANGLES, WHICH MIGHT NOT BE OBVIOUS IN REALITY.
 5. APPROACH SPEEDS, APPROACH ANGLES, ROAD SURFACE, WEATHER CONDITIONS AND TYRE WEAR ARE ALL FACTORS THAT WILL INFLUENCE VEHICLE PATHS.

Rev	Date	Description of Revisions	Desd	Chkd	Appr	
B01	19/05/20	FOR INFORMATION		N.T.	L.T.	G.J.

SHARED - for IDC Review

S3



Project
East West Rail (Western Section) Phase 2

Drawing Title
ACCESS TO COMPOUND A1 INITIAL VEHICLE SWEEPED PATH ANALYSIS (TO BE KEPT UNDER REVIEW)

Designed	Nagoth Thomas Ravi Kumar	Signed	N. T. R. Kumar	Date	23/04/20
Drawn	Ravikumar KN	Signed	R. KN	Date	19/04/20
Checked	Lisa Taylor	Signed	L. Taylor	Date	24/04/20
Approved	Gareth Johnston	Signed	G. Johnston	Date	19/05/20

Scale(s)	1:250	ELR - Project Chainage (Miles/Yards)	OXD -
Design Package Risk Classification	Normal	Sheet	3 of 3
Alternative Reference		Revision	B01
Drawing Number	133735_2A-EWR-OXD-CC_A1-DR-CH-003004		

KEY:

- VEHICLE TRACKING
- HIGHWAY BOUNDARY
- PROPOSED ROAD EDGE
- PROPOSED WHITE ROAD MARKING
- PROPOSED YELLOW ROAD MARKING

VEHICLE DETAILS

MAX LEGAL LENGTH (UK) ARTICULATED VEHICLE (16.5m)

OVERALL LENGTH	16.500m
OVERALL WIDTH	2.550m
OVERALL BODY HEIGHT	3.681m
MIN BODY GROUND CLEARANCE	0.411m
MAX TRACK WIDTH	2.500m
LOCK TO LOCK TIME	6.00s
KERB TO KERB TURNING RADIUS	6.530m