

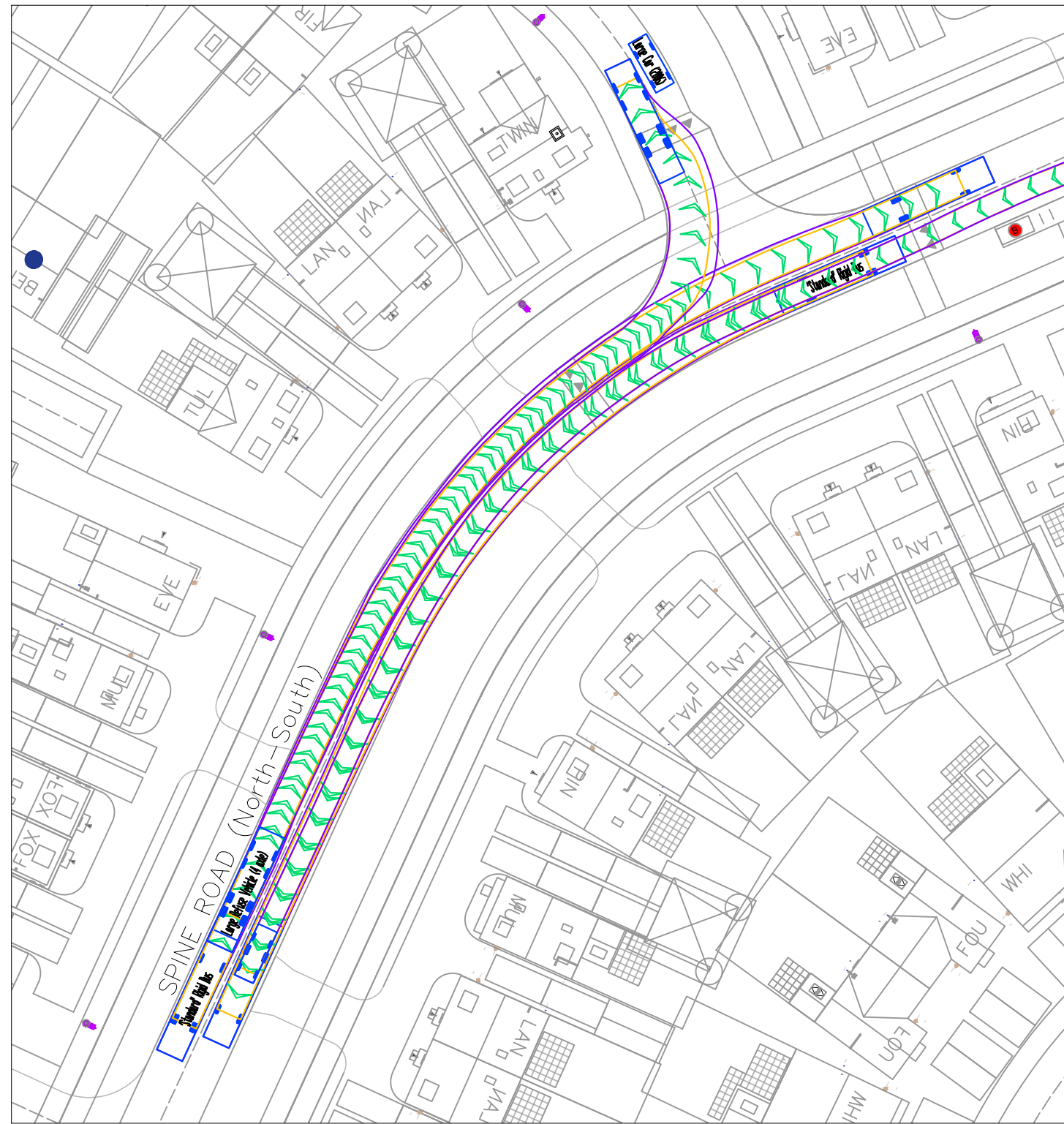

REFER TO KEY PLAN FOR EXTRACT LOCATIONS

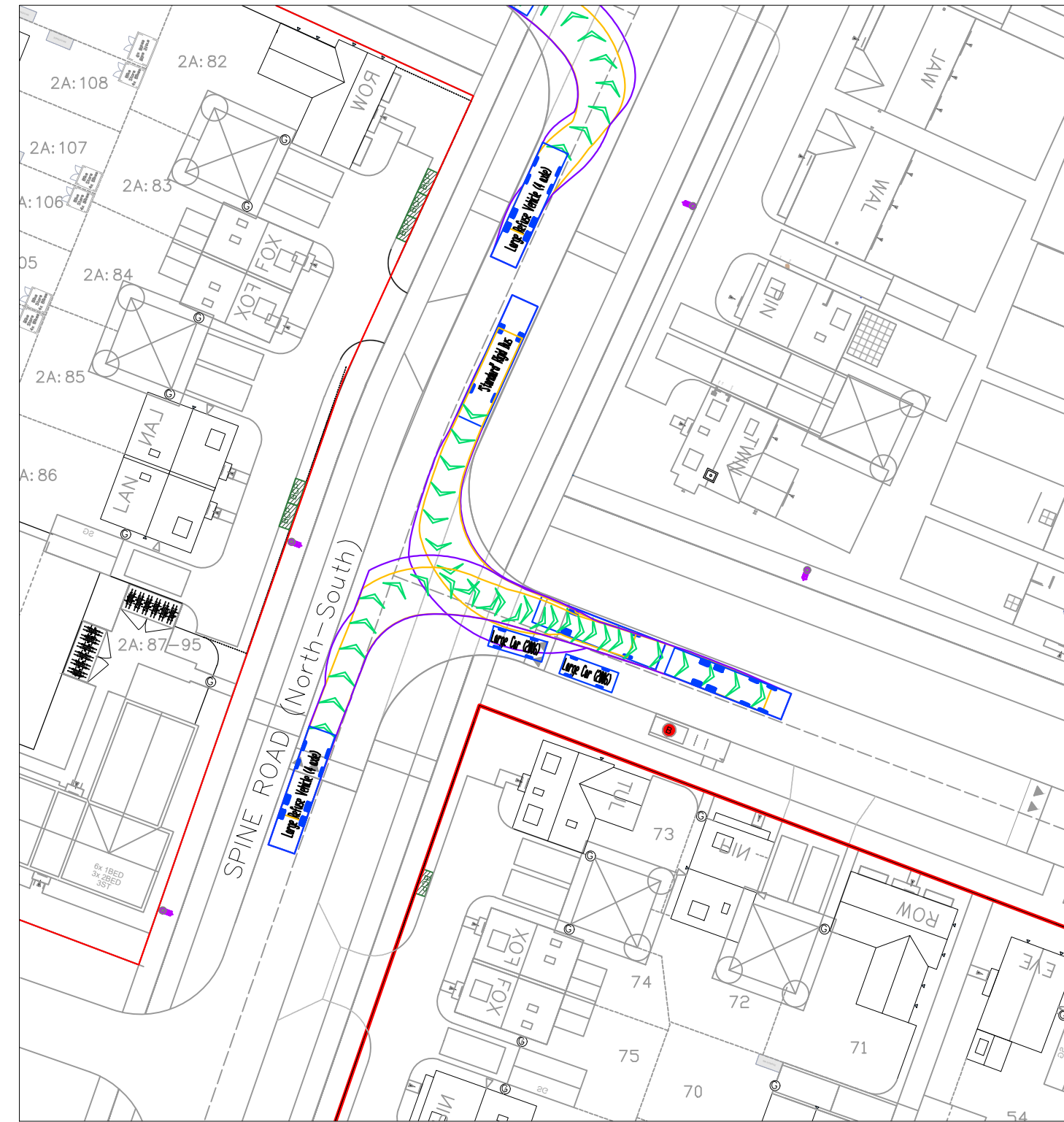

1



2

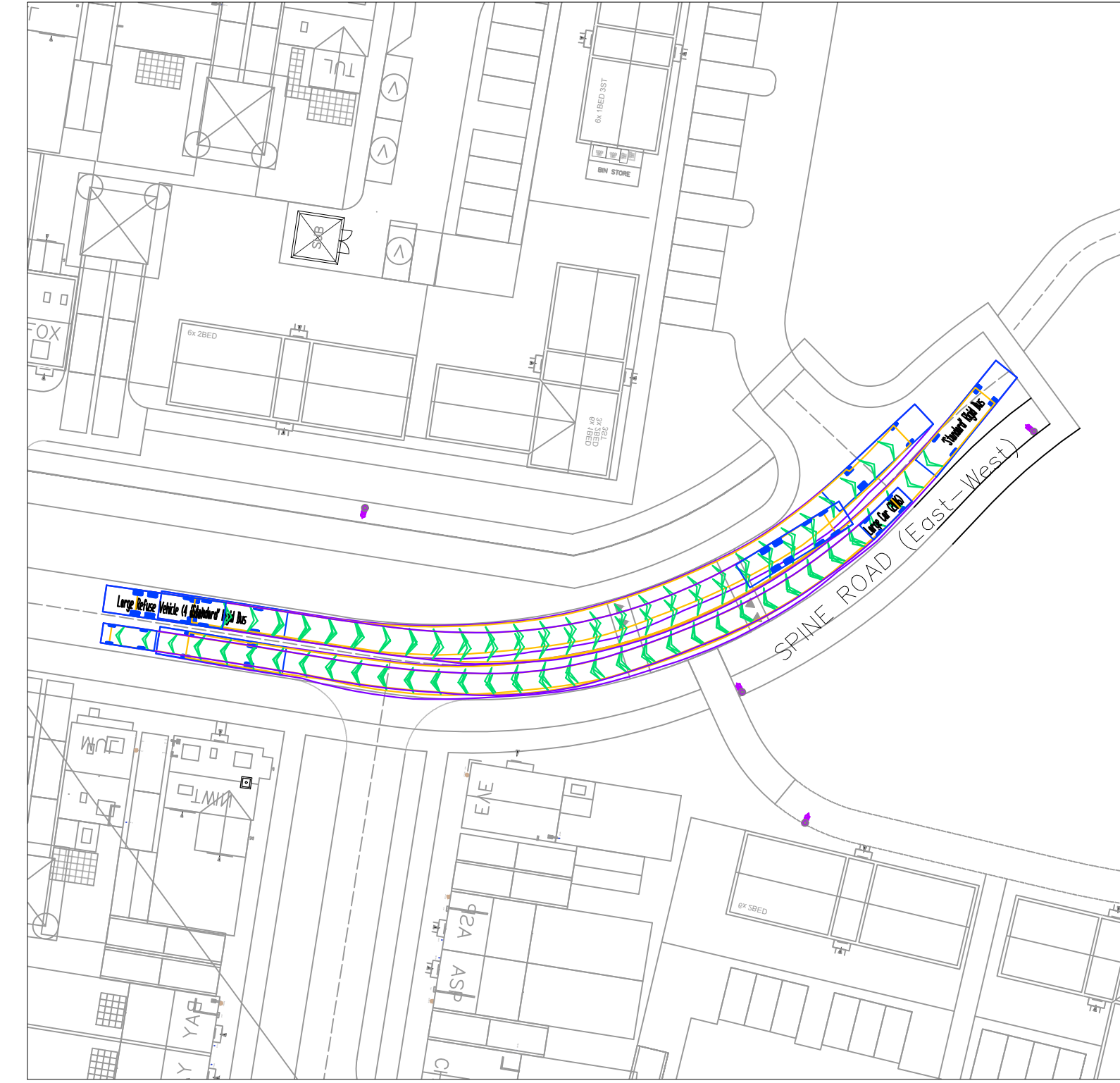

4

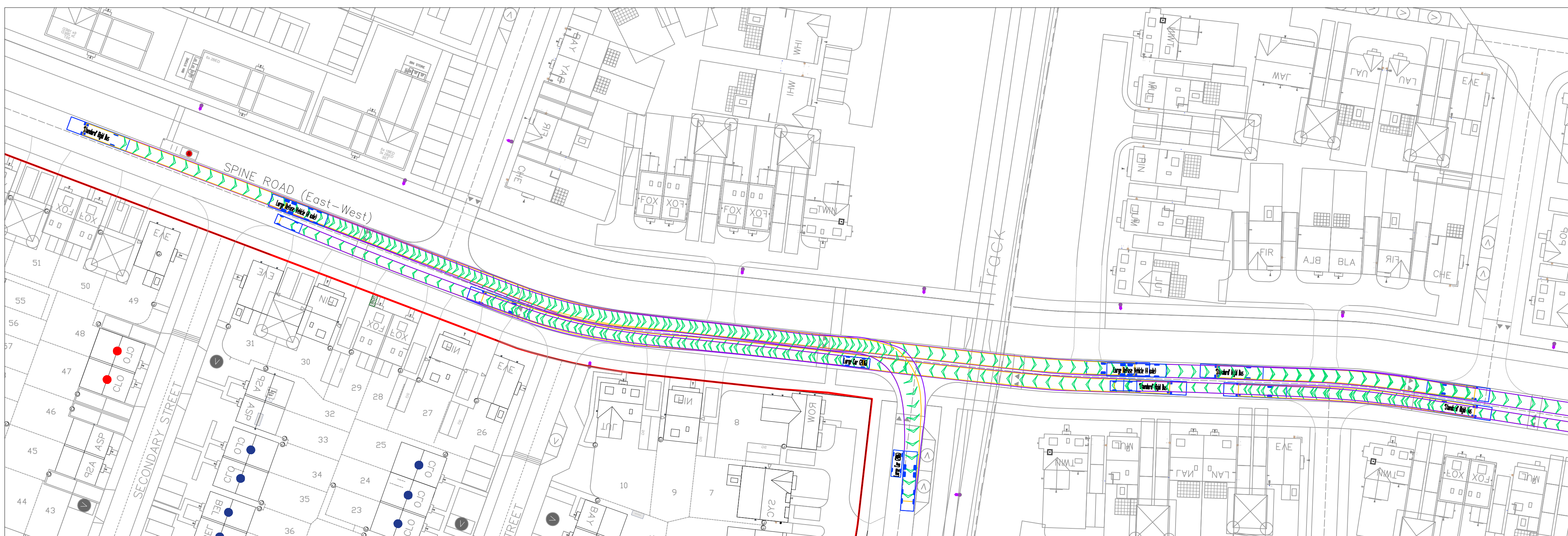

3

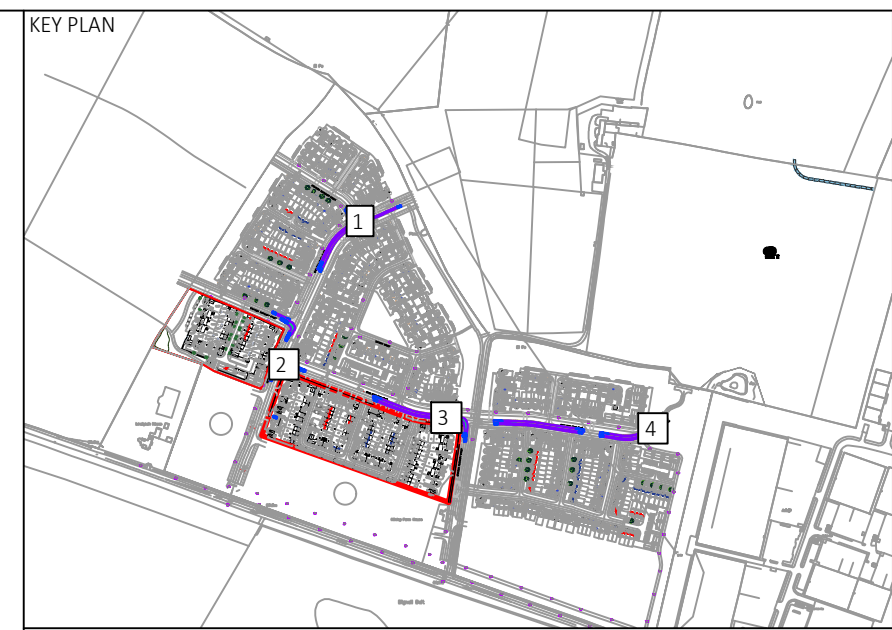

VEHICLE PROFILE

Standard Rigid Bus	12,000m
Overall Length	5,950m
Overall Body Height	3,500m
Min Body Ground Clearance	0,300m
Track Width	2,350m
Lock to lock time	2,00s
Wall to Wall Turning Radius	10,771m

Large Car (2006)	5,079m
Overall Length	1,872m
Overall Width	1,567m
Overall Body Height	1,567m
Min Body Ground Clearance	0,310m
Max Track Width	1,631m
Lock to lock time	4,00s
Kerb to Kerb Turning Radius	5,900m

P05	15/03/24	Amended to suit updated phase 2A layout.	BT	JAC	-
P04	02/02/24	Updated to latest Cala comments.	DN	BT	-
P03	17/01/24	Amended to suit updated Strategic Secondary Road arrangement	HR	BT	-
P02	05/12/23	Amended to suit updated Spine Road arrangement	BT	GH	-
P01	02/06/23	First Issue.	DN	BT	RA

Rev Date Description By Ckd App

OVER COURT BARN
OVER LANE
ALMONDSBURY
BRISTOL
BS32 4DF
T: +44 (0) 1454 619533
e: bristol@hydrock.com

CLIENT
CALA HOMES COTSWOLDS LTD

PROJECT
HIMLEY VILLAGE, BICESTER

TITLE
PHASE 1B BUS TRACKING

HYDROCK PROJECT NO. C-27141-C	SCALE @ A1 1:500	STATUS S2
STATUS DESCRIPTION INFORMATION		REVISION P05
DRAWING NO. (PROJECT CODE-ORIGINATOR-ZONE-LEVEL-TYPE-ROLE-NUMBER) 27141-HYD-XX-XX-DR-C-2600		