

Existing ditch to be remodelled forming new underdrained swales as part of proposed surface water drainage network.

Adoptable PWR pumping station with Grasscrete access track. Layout & location TBC with manufacturer and adopting authority.

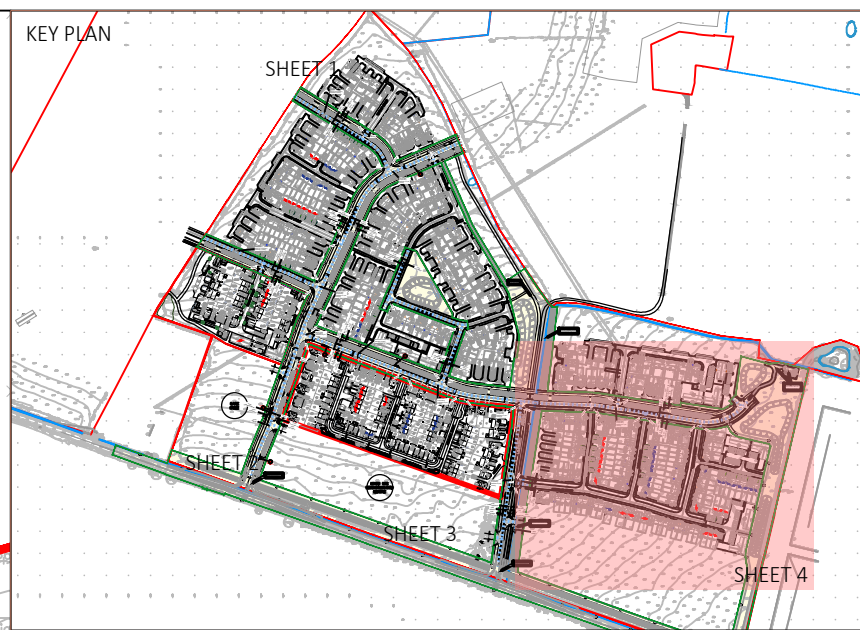

- NOTES:**
- All Works are to be constructed in accordance with Oxfordshire Council and the Highways Agency's Specification for Highway Works (SHW) March 1998 as amended published by The Stationary Office
 - All levels relate to the survey which is to Ordnance datum. Dimensions not to be scaled.
 - Street lighting, illuminated traffic signs, bollards and associated works shall comply with Oxfordshire Council 'Specification for Street Lighting'.
 - Use of this drawing does not absolve the client from his responsibilities under the Health and Safety, The Construction Design and Management Regulations 2015. The Principal Designer is required to contact Hydrock Consultants prior to permitting this drawing to be used in connection with any construction works.
 - This drawing is based on the latest Architects design layout received.
 - All works shown have been designed in accordance with Building Regs Part M.
 - All underbuild, and retaining wall heights shown are the anticipated maximum finished height required.
 - All steps shown are to have 150mm rising and 280mm going dimensions up to a maximum of 12 steps per flight.
 - All levels immediately adjacent to the rear access are assumed to be 150mm below finished floor level.
 - All works shown are designed to minimize works required adjacent to existing Trees.
 - Where external ground levels are higher than the DPC tanking will be required.

- Infrastructure Phase Boundary
- Site Boundary
- Hatched areas outside of RM application and are subject to layout changes during design development
- Indicative bus stop location (Location & layout subject to planning & Section 38 Technical Approval)
- Primary Road Contours (0.5m interval)
- Secondary Road Contours (0.1m interval)
- Embankment (Maximum Slope 1:3)
- Blister / corduroy tactile paving
- Height and location of gabion baskets (RW= represents maximum height of tanking from finished levels)
- Proposed roadside swale (max. 1:3 side slopes) for drainage of highway runoff & conveyance of drainage to existing southern ditch

NOTE: All accesses to future residential phases are shown indicatively, and subject to phase-specific Reserved Matters Applications.

NOTE: Raised Tables are shown indicatively, and will be subject to planning approval and Section 38 Technical Review. As such, road contours shown represent the primary road surface, without raised table information. Refer to OCC guidance on raised table design, however on bus routes, this will typically be 75mm maximum rise above the main carriageway at a max. 1:15 ramp gradient.

Rev	Date	Description	By	Ckd	App
P06	15/03/24	Amended to suit updated phase 2A layout.	BT	JAC	-
P05	09/02/24	Amended to suit updated layout & Cala comments	BT	RA	-
P04	19/01/24	Amended to suit updated layout	BT	JAC	RA
P03	04/12/23	Amended to suit updated Spine Road arrangement	BT	GH	-
P02	31/05/23	Issued for Planning.	JL	BT	BT
P01	06/04/23	First Issue.	BT	RA	RA

OVER COURT BARN
OVER LANE
ALMONDSBURY
BRISTOL
BS32 4DF
t: +44 (0) 1454 619533
e: bristol@hydrock.com

CLIENT
CALA HOMES COTSWOLDS LTD

PROJECT
HIMLEY VILLAGE, BICESTER

TITLE
PHASE 1B ENGINEERING LAYOUT SHEET 4 OF 4

HYDROCK PROJECT NO. C-27141-C	SCALE @ A1 1 : 500	STATUS PLANNING	STATUS S2
DRAWING NO. (PROJECT CODE-ORIGINATOR-ZONE-LEVEL-ROLE-NUMBER) 27141-HYD-1B-XX-DR-C-2203		REVISION P06	