

Schedule						
Symbol	Label	Quantity	Catalog Number	Description	Lumens Per Lamp	Wattage
	AW	8	DSX2.2.LA304.FW on Wall Bracket at 8m AFLL	D-Series 2 Luminaire	33388	282
	B1	6	1 x DSX1.2.LA224.FW on 8m Column	D-Series 1 Luminaire	24252	200
	C1	3	1 x DSX1.2.LA224.AY on 8m Column	D-Series 1 Luminaire	23558	200
	D1	15	DSX0.4.LA184.FW on 8m Column	D-Series 0 - Area luminaire	17390	130
	DW	1	DSX0.4.LA184.FW on Wall Bracket at 8m AFLL	D-Series 0 - Area luminaire	17390	130

Statistics				
Description	Symbol	Avg	Min	Min/Avg
Unit 13 Access Road - 20/0.40Uo	+	21 lux	10 lux	0.48
Unit 13 Car Park - 20/0.25Uo	+	20 lux	9 lux	0.45
Unit 13 Cycles	+	13 lux	6 lux	0.46
Unit 13 Service Yard - 500.40Uo	+	50 lux	22 lux	0.44
Unit 14 Car Park - 20/0.25Uo	+	22 lux	6 lux	0.27
Unit 14 Service Yard - 500.40Uo	+	52 lux	25 lux	0.48
Unit 14/15 Shared Access Road - 20/0.40Uo	+	20 lux	14 lux	0.70
Unit 15 Car Park - 20/0.25Uo	+	21 lux	8 lux	0.38
Unit 15 Service Yard - 500.40Uo	+	60 lux	26 lux	0.43
Access Road (Landlords) - 20/0.40Uo	+	29 lux	13 lux	0.45

© Engineering Services Consultancy Limited.
 This drawing is copyright and must not be reproduced in part or whole without prior written consent.
 Contractors must verify all dimensions on site before commencing works.
 All works shall be coordinated with all other trades.

RESIDUAL RISK REGISTER			
NO.	DESCRIPTION OF HAZARD	CONTROL MEASURES	ACTION BY
1	UNKNOWN BURIED SERVICES AND SERVICES IDENTIFIED IN WRONG LOCATION.	IDENTIFICATION OF EXISTING UNDERGROUND SERVICES USING UTILITY RECORD DRAWINGS AND CAT SCANNING OF GROUND. CAREFUL EXCAVATION USING SLOT TRENCHES AND CAT SCANNING OF GROUND.	CONTRACTOR

- NOTES**
- THIS DRAWING SHALL BE READ IN CONJUNCTION WITH ALL OTHER ENGINEERING SERVICES CONSULTANCY LIMITED DRAWINGS
 - THE EXTERNAL LIGHTING SHALL BE DESIGNED TO ENSURE THAT REQUIRED LIGHTING LEVELS ARE ACHIEVED WHILST MINIMISING GLARE AND LIGHT SPILLAGE TO THE SURROUNDING AREAS AND TO ENSURE THERE IS NO DIRECT CONTRIBUTION TO UPWARD LIGHT POLLUTION.
 - THE EXTERNAL LIGHTING SCHEME SHALL BE PROVIDED IN ACCORDANCE WITH THE LOCAL PLANNING AUTHORITIES REQUIREMENTS/RESTRICTIONS.
 - WHERE COLUMNS ARE POSITIONED NEAR TO NEIGHBOURING PROPERTIES, OR LOCATED ON THE PERIMETER OF THE SITE, THEY SHALL BE COMPLETE WITH SUITABLE BACK-SHIELDS TO PREVENT LIGHT SPILL.
 - ALL COLUMNS SHALL HAVE A FLEXIBLE DUCT PASSING INTO THE BASE, THROUGH THE CONCRETE, TO ENSURE THAT FUTURE REWIRING OF THE CIRCUITS IS POSSIBLE.
 - WHERE LUMINAIRES ARE FIXED DIRECTLY TO THE EXTERNAL BUILDING FABRIC, THE LUMINAIRES SHALL BE THE SAME RAL COLOUR AS THE CLADDING PANELS. ALL LUMINAIRE FIXING BOLTS ETC. SHALL BE THE SAME COLOUR AS THE LUMINAIRE.
 - GENERALLY, THE COLUMNS SHALL BE GALVANISED STEEL CONSTRUCTION. THE ELECTRICAL CONTRACTOR SHALL LIAISE WITH THE ARCHITECT TO ASCERTAIN THE RAL COLOUR OF THE COLUMNS. THE COLUMN HEADS SHALL MATCH THE RAL COLOUR OF THE COLUMN.
 - WHERE SERVICES NEED TO BE INSTALLED WITHIN DUCTS / TRENCHES, THE ELECTRICAL CONTRACTOR SHALL SUPPLY THE MAIN CONTRACTOR WITH DETAILS OF REQUIRED DUCT ROUTES AND DRAW PIT LOCATIONS.
 - DURING INSTALLATION OF THE EXTERNAL LIGHTING A DRAW WIRE SHALL BE PULLED THROUGH WITH THE CABLING TO PROVIDE A MEANS OF INSTALLING FUTURE SERVICES

LEGEND

EXTERNAL LIGHTING COLUMNS/BOLLARDS (REFER TO EXTERNAL LIGHTING DRAWING FOR MORE INFORMATION)

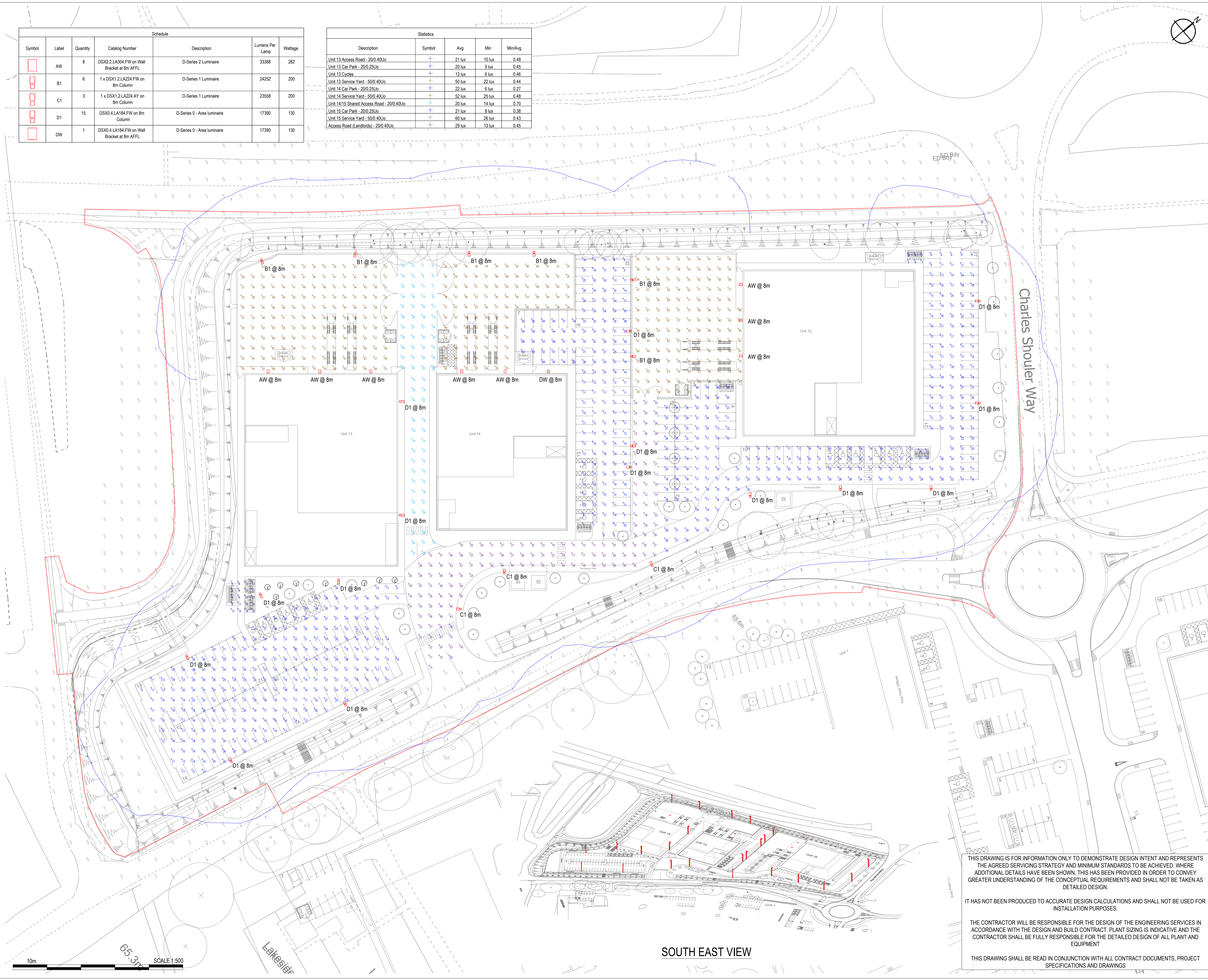

P1 10.05.24 Issued for planning CP
 Rev. Date Details Initials
 Engineering Services Consultancy Ltd
 Griffin House
 19 Ludgate Hill
 Birmingham
 B5 1DW
 T: 0121 214 8998
 F: 0121 214 8999
 W: www.escuk.com

Client
ALBION LAND

Project
Catalyst Phase 4

Drawing Title
External Lighting Layout

Purpose
PLANNING

Drawn DM	Engineer CP	Approved CP
Project No. 2102	Date May 2024	Scale @ A1 1:500
Drawing No. 2102-ESC-00-ZZ-DR-E-2100	Revision P1	

THIS DRAWING IS FOR INFORMATION ONLY TO DEMONSTRATE DESIGN INTENT AND REPRESENTS THE AGREED SERVICING STRATEGY AND MINIMUM STANDARDS TO BE ACHIEVED. WHERE ADDITIONAL DETAILS HAVE BEEN SHOWN, THIS HAS BEEN PROVIDED IN ORDER TO CONVEY GREATER UNDERSTANDING OF THE CONCEPTUAL REQUIREMENTS AND SHALL NOT BE TAKEN AS DETAILED DESIGN.

IT HAS NOT BEEN PRODUCED TO ACCURATE DESIGN CALCULATIONS AND SHALL NOT BE USED FOR INSTALLATION PURPOSES.

THE CONTRACTOR WILL BE RESPONSIBLE FOR THE DESIGN OF THE ENGINEERING SERVICES IN ACCORDANCE WITH THE DESIGN AND BUILD CONTRACT. PLANT SIZING IS INDICATIVE AND THE CONTRACTOR SHALL BE FULLY RESPONSIBLE FOR THE DETAILED DESIGN OF ALL PLANT AND EQUIPMENT

THIS DRAWING SHALL BE READ IN CONJUNCTION WITH ALL CONTRACT DOCUMENTS, PROJECT SPECIFICATIONS AND DRAWINGS

SOUTH EAST VIEW