

Revision & Version  
B01.04  
Drawing Number  
133735\_2A-EWR-OXD-CC\_A1-DR-CH-002008

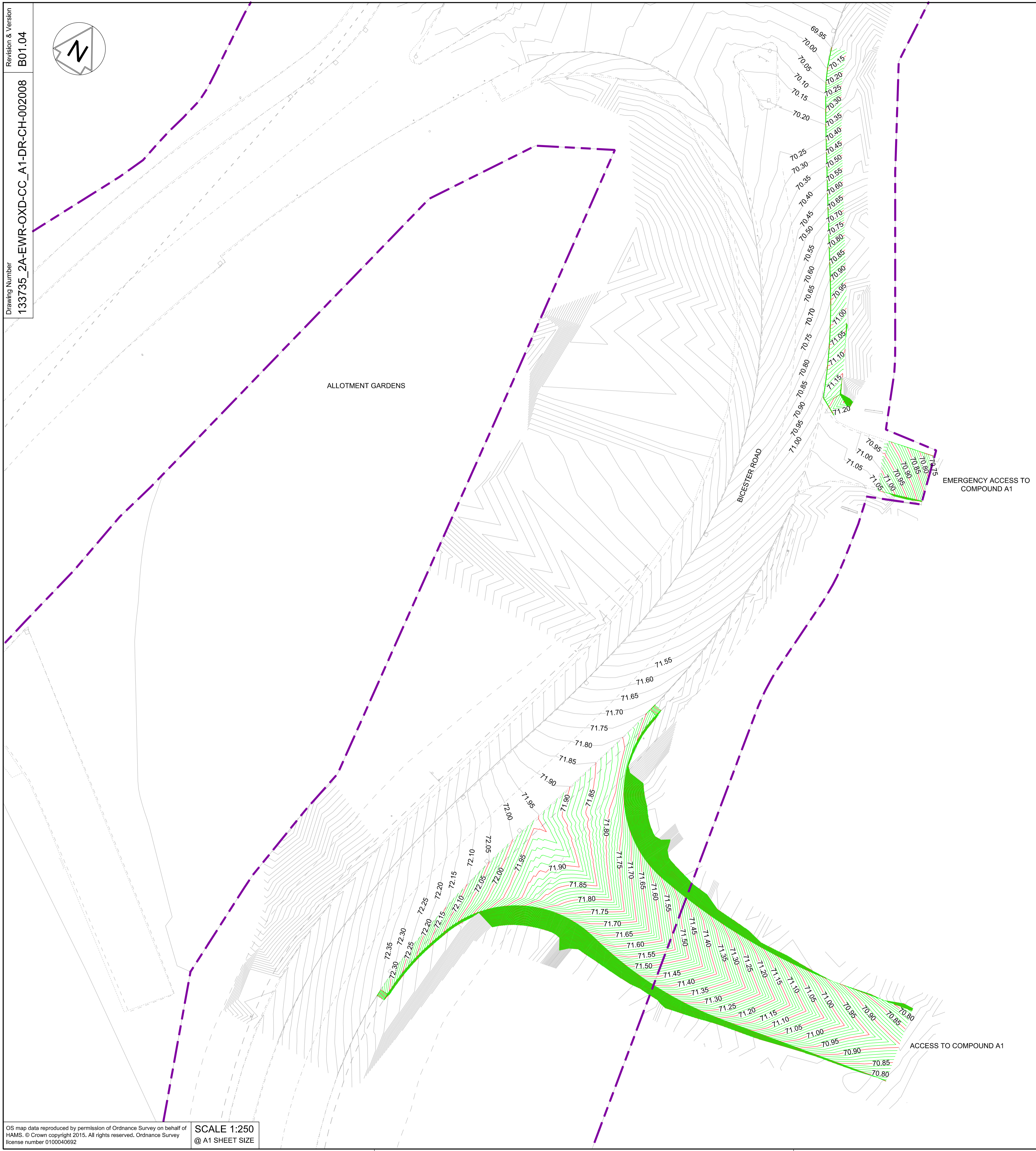
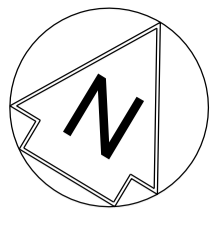

OS map data reproduced by permission of Ordnance Survey on behalf of  
HAMS. © Crown copyright 2015. All rights reserved. Ordnance Survey  
license number 010040692

SCALE 1:250  
@ A1 SHEET SIZE

**KEY:**

	HIGHWAY BOUNDARY
	EXISTING CONTOUR MAJOR @ 0.05m INTERVALS
	EXISTING CONTOUR MINOR @ 0.01m INTERVALS
	PROPOSED CONTOUR MAJOR @ 0.05m INTERVALS
	PROPOSED CONTOUR MINOR @ 0.01m INTERVALS

NETWORK RAIL (EAST WEST  
RAIL WESTERN SECTION PHASE 2)

- NOTES:**
1. THIS DRAWING IS NOT TO BE SCALED.
  2. ALL DIMENSIONS ARE IN METRES (m) UNLESS SHOWN OTHERWISE.
  3. THIS DRAWING IS TO BE READ IN CONJUNCTION WITH THE HIGHWAY DESIGN PACKAGE OF DRAWINGS AND DOCUMENTS.
  4. ALL WORKS TO BE IN ACCORDANCE WITH THE MANUAL OF CONTRACT DOCUMENTS FOR HIGHWAYS WORKS VOL 1 (SPECIFICATION FOR HIGHWAY WORKS) AND STANDARD CONSTRUCTION DETAILS.
  5. THE DELIVERY TEAM IS TO VERIFY DIMENSION ON SITE AND ADVISE OF ANY INFORMATION DISCREPANCIES. TIE-IN POINTS SHOULD BE VERIFIED ON SITE WITH THE ENGINEER PRIOR TO CONSTRUCTION.



B01	18/12/19	FOR INFORMATION		N.T.	G.J.	S.A
Rev	Date	Description of Revisions	Dend	Chkd	Appr	Suitability
SHARED - for Information						S2



Project  
**East West Rail  
(Western Section)  
Phase 2**

Drawing Title  
**ACCESS TO COMPOUND A1  
EXISTING AND PROPOSED  
CONTOURS**

Designed	Nagoth Thomas Ravi Kumar	Signed	N. T. R. Kumar	Date	16/12/19
Drawn	Ravikumar KN	Signed	R. KN	Date	17/12/18
Checked	Garth Johnston	Signed	G. Johnston	Date	16/12/19
Approved	Stephen Abe	Signed	S. Abe	Date	16/12/19

Scale(s)  
1:250  
ELR - Project Chainage (Miles Yards)  
OXD - 108820

Design Package Risk Classification  
**Normal**

Alternative Reference

Sheet  
1 of 1

Revision  
B01

Drawing Number  
133735\_2A-EWR-OXD-CC\_A1-DR-CH-002008