

FOR INFORMATION ONLY



POWER DENSITY STATISTICS		
Name	# Luminaires	Total Watts
External Lighting Load	105	10220.0 W

STATISTICS				
Description	Symbol	Avg	Min	Min/Avg
Bike Shed & Smoking Area [20/0.4]	+	24 lux	10 lux	0.42
Building Perimeter [10/0.25]	+	18 lux	5 lux	0.28
Circulation Road [50/0.4]	+	58 lux	24 lux	0.41
Entrance Road, Gatehouse, Barriers & Crossings [10/0.4]	+	105 lux	42 lux	0.40
P1 - Bike Shelter [10/0.4]	+	183 lux	146 lux	0.80
P1 - Pedestrian Crossing [10/0.4]	+	140 lux	77 lux	0.55
P1 - Pedestrian Walkway [0.25]	+	44 lux	15 lux	0.34
P1 - Van Parking [25/0.4]	+	39 lux	28 lux	0.67
Pedestrian Crossings [10/0.4]	+	127 lux	61 lux	0.48
Van Entry/Exit [10/0.4]	+	101 lux	54 lux	0.53
Van Parking [25/0.4]	+	30 lux	13 lux	0.43

LUMINAIRE SCHEDULE						
Symbol	Label	Qty	Catalog Number	Description	Lamp	Watts
J	18	THORLUX Starbeam Small 48 LED Roadway GRS	Column Mounted @ 10m 0° Tilt	1 x 17,425 Lumens 4,000K Colour Temp CR80 144 Lm/W	95	
G1.w	1	THORLUX Starbeam Small 48 LED Forward Throw GA2	Wall Mounted @ 5m 5° Bracket Tilt EXISTING LOCATION	1 x 17,435 Lumens 4,000K Colour Temp CR80 133 Lm/W	131	
J.w	5	THORLUX Starbeam Small 48 LED Roadway GRS	Wall Mounted @ 6m 0° Bracket Tilt EXISTING LOCATION	1 x 13,725 Lumens 4,000K Colour Temp CR80 144 Lm/W	95	
U.w	16	THORLUX Realta Bulkhead [TP19774]	Wall Mounted @ 6m 0° Bracket Tilt EXISTING LOCATION	1 x 2,700 Lumens 4,000K Colour Temp CR80 145 Lm/W	22	
ZZ	1	THORLUX Thorproof [TP19774]	Surface Mounted (Height TBC by Contractor)	1 x 9,895 Lumens 4,000K Colour Temp CR80 145 Lm/W	68	
G1	1	THORLUX Starbeam Small 48 LED Forward Throw GA2	Column Mounted @ 8m 5° Tilt NEW COLUMN & ELECTRICAL LOCATION	1 x 17,435 Lumens 4,000K Colour Temp CR80 133 Lm/W	131	
G2	2	THORLUX Starbeam Large 96 LED Forward Throw GA2	Column Mounted @ 8m 5° Tilt NEW COLUMN & ELECTRICAL LOCATION	1 x 27,470 Lumens 4,000K Colour Temp CR80 135 Lm/W	203	
J	10	THORLUX Starbeam Small 48 LED Roadway GRS	Column Mounted @ 8m 5° Tilt NEW COLUMN & ELECTRICAL LOCATION	1 x 13,725 Lumens 4,000K Colour Temp CR80 144 Lm/W	95	
J2	11	THORLUX Starbeam Large 96 LED Roadway GRS	Column Mounted @ 8m 0° Tilt NEW COLUMN & ELECTRICAL LOCATION	1 x 29,995 Lumens 4,000K Colour Temp CR80 137 Lm/W	203	
ZL	11	THORLUX Starbeam ZL-Lens	Column Mounted @ 4m 0° Tilt NEW COLUMN & ELECTRICAL LOCATION	1 x 10,130 lumens 5,700K Colour Temp CR80	95	
G2.w	6	THORLUX Starbeam Large 96 LED Forward Throw GA2	Wall Mounted @ 8m 5° Bracket Tilt NEW ELECTRICAL LOCATION	1 x 27,470 Lumens 4,000K Colour Temp CR80 131 Lm/W	203	
J.w	3	THORLUX Starbeam Small 48 LED Roadway GRS	Wall Mounted @ 8m 5° Bracket Tilt NEW ELECTRICAL LOCATION	1 x 13,725 Lumens 4,000K Colour Temp CR80 144 Lm/W	95	
S1.w	12	THORLUX Starfood STF120+STF173 28	Wall Mounted @ 5m 0° Bracket Tilt NEW ELECTRICAL LOCATION	1 x 4,575 lumens 4,000K Colour Temp CR80	38	
ZR	8	THORLUX Aspect 3 ZR-Lens	Column Mounted @ 4m 0° Tilt NEW COLUMN & ELECTRICAL LOCATION	1 x 10,130 lumens 5,700K Colour Temp CR80	95	

The copyright of this document is vested solely in Kelly Taylor & Associates. Reproduction of this document, in whole or in part, is prohibited other than with the express permission of the above company.

This drawing to be read in conjunction with all relevant architects, consultants, sub-contractors and specialist drawings, and should not be scaled from any way.

Revisions				
Rev.	By	Date	Description	CHK
A	CC	11.08.21	Updated to suit the latest plan.	GPH
B	JP	25.10.21	Updated to suit the latest plan.	CC
C	CC	02.11.21	Updated to suit the latest plan.	JSP
D	CC	04.11.21	Updated to suit the latest plan.	JSP

NOTE:-  
ELECTRICAL CONTRACTOR TO CONFIRM ALL LIGHTING LAYOUTS COMPLY WITH LIGHTING LEVELS AND UNIFORMITY STATED WITHIN SPECIFICATION. LUMINAIRES SHOWN FOR INFORMATION ONLY.

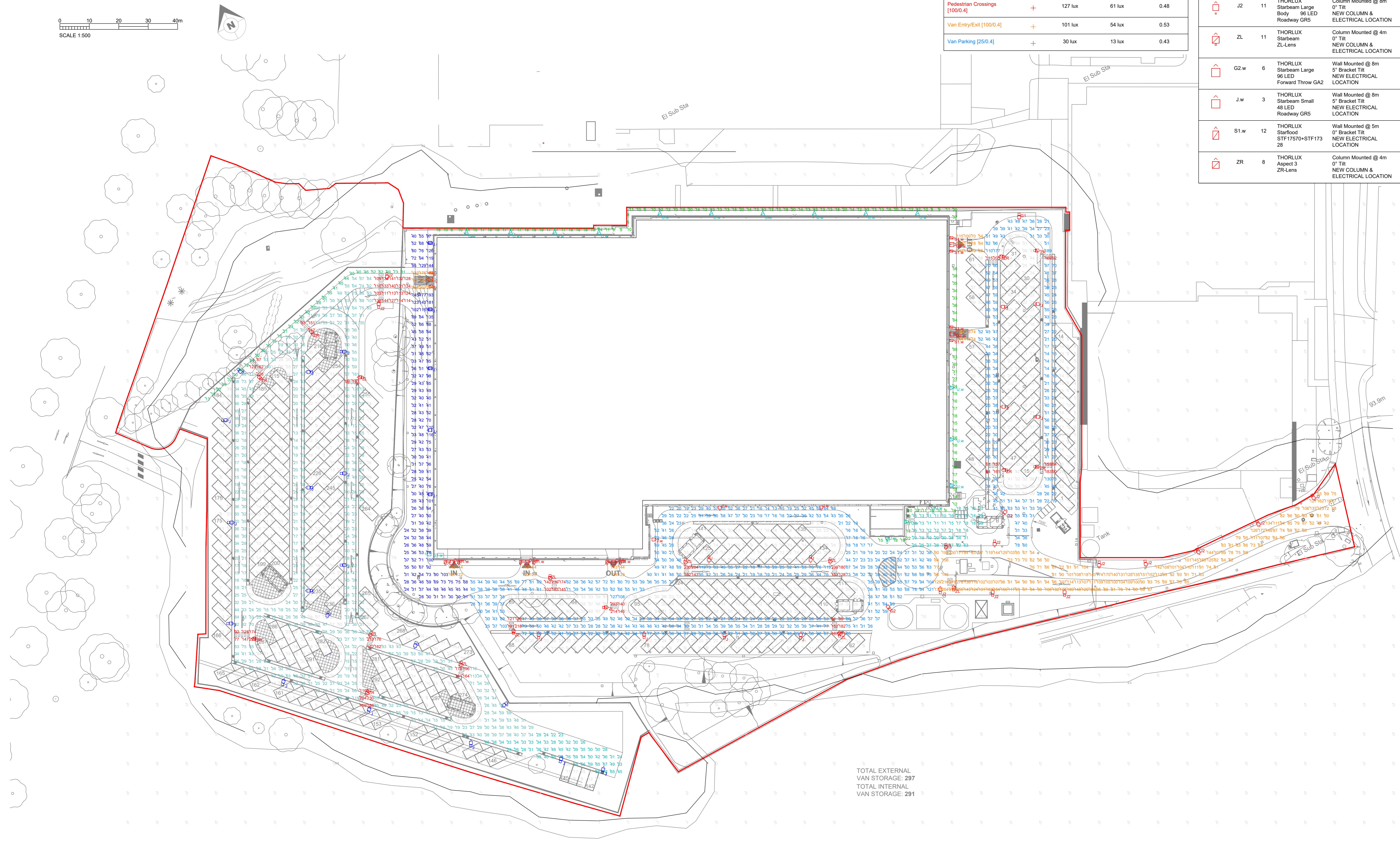
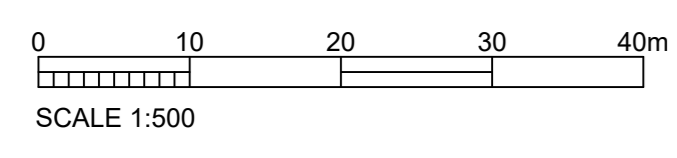

TOTAL EXTERNAL VAN STORAGE: 297  
TOTAL INTERNAL VAN STORAGE: 291

CDM DESIGNER RISK INFORMATION

In addition to the hazards/risks normally associated with the types of work detailed on this drawing NOTE THE FOLLOWING:

- CONSTRUCTION  
N/A
- MAINTENANCE/CLEANING  
N/A
- DECOMMISSIONING/DEMOLITION  
N/A

It is assumed that all works will be carried out by a contractor competent under CDM 2015 working to an approved method statement.

Client  
**LYSANDER**

Architect  
**S+SA ARCHITECTS**

Project Address  
**Banbury 200 Site,  
Southam Road,  
Banbury**

Drawing Title  
**External Lighting  
Lux Level Plot**

**KTA**  
KELLY TAYLOR & ASSOCIATES  
ENGINEERING & ENVIRONMENTAL CONSULTANTS  
1 ASHLEIGH WAY, LANGAGE BUSINESS PARK,  
PLYMOUTH, DEVON, PL7 5JX.  
TEL: +44(0)1752 332890 FAX: +44(0)1752 344282  
E-MAIL: general@kellytaylor.net

**PLANNING**

Drawn by <b>MK</b>	Checked by <b>GPH</b>	Authorised by <b>JDG</b>
Scale <b>1:500</b>	Size <b>A0</b>	Date <b>Aug '21</b>
Drawing no. <b>10336-PL-400</b>		Rev. <b>D</b>